

When recorded mail to:
1307 N Commerce Drive, Suite 200
Saratoga Springs, UT 84045



ENT 41:2018 PG 1 of 3
JEFFERY SMITH
UTAH COUNTY RECORDER
2018 Jan 02 10:20 am FEE 0.00 BY BA
RECORDED FOR SARATOGA SPRINGS CITY

RIGHT OF WAY AND EASEMENT

County Parcels Affected:

58:035:0064

Address: 524 N Redwood Rd,
Saratoga Springs, Utah

SCOTT COOPER MCLACHLAN AND JULIE ANN MCLACHLAN, Grantors, hereby GRANT AND CONVEY to the CITY OF SARATOGA SPRINGS, Grantee, for the sum of ten dollars (\$ 10.00), and other good and valuable consideration, the following described right of way and temporary construction easement together with the right of ingress and egress over Grantor's adjacent lands for construction, use, operation, inspection, repair, maintenance, and replacement or removal of a sidewalk and related facilities in Utah County, State of Utah to-wit:

A parcel of land to be used for the widening of the Redwood Road right-of-way, to allow for the extension of the existing sidewalk at Dalmore Meadows Subdivision south to the northeast corner of the intersection of Redwood Road and Pioneer Crossing. Said parcel is located in the Northeast Quarter of Section 23, Township 5 South, Range 1 West, Salt Lake Base and Meridian, being more particularly described as follows:

Beginning at a found right-of-way marker delineating the east right-of-way line of Redwood Road, said point being on the south line of Dalmore Meadows Phase 1 Amended as recorded in the office of the Utah County Recorder as Entry No. 6074:2006, said point lies South 00°13'39" East along the Center section line 866.34 feet and East 99.59 feet from the North Quarter Corner of Section 23, Township 5 South, Range 1 West, Salt Lake Base and Meridian (basis of bearing being South 00°13'39" East between the found North Quarter Corner and the found South Quarter Corner of said Section 23); and running thence East along said south line 6.99 feet; thence South 00°05'37" West 195.69 feet to said right-of-way line; thence North 01'57'05" West along said right-of-way line 195.81 feet to the point of beginning.

Containing 684 square feet.

Together with a slope and temporary construction easement adjacent to the Redwood Road right-of-way to allow access during the construction of the sidewalk from the south end of the Dalmore Meadows Subdivision to the northeast corner of the intersection of Redwood Road and Pioneer Crossing, and to allow the placement of fill material as required to bring the sidewalk to the necessary grade to match the elevation of Redwood Road. The slope and temporary construction easement is twenty-feet-wide where parallel to Redwood Road, and ten-feet-wide in the diagonal portion of the right-of-way extending from Redwood Road southeast to Pioneer Crossing. The temporary construction easement shall expire upon final completion and acceptance of the proposed City of Saratoga Springs Sidewalk project extending the sidewalk from Dalmore Meadows to the Northeast corner of the intersection of Redwood Road and Pioneer Crossing. The easement area is more particularly described as follows:

Beginning at the northeast corner of the above described parcel, said point lies South 00°13'39" East long the Center of section line 866.34 feet and East 106.58 feet from the North Quarter Corner of Section 23, Township 5 South, Range 1 West, Salt Lake Base and Meridian (basis of bearing being South 00°13'39" East between the found North Quarter Corner and the found South Quarter Corner of said Section 23); and running thence East 20.00 feet; thence South 00°05'37" West 397.56 feet; thence South 43°02'49" East 108.76 feet; thence South 46°57'11" West 10.00 feet to the found right-of-way Marker 78 delineating the right-of-way of Pioneer Crossing and Redwood Road; thence North 43°02'49" West along said right-of-way from said Marker 78 to found right-of-way Marker 77 118.22 feet; thence North 01°04'52" East from said Marker 77 to found right-of-way Marker 25 18.34 feet; thence North 01°57'05" West along said right-of-way line 183.55 feet to the south corner of the above described parcel; thence North 00°05'37" East along the east line of said parcel 195.69 feet to the point of beginning.

Containing 8,367 square feet.

Grantee will install and maintain said easement in a state of good repair so that no unreasonable damages will result to Grantor's premises from its installation of use. This agreement constitutes a covenant running with the land for the benefit of the Grantee. Grantor covenants that Grantor is the owner of the above-described lands and that said Grantor is authorized to grant this easement.

WITNESS, the hand of said Grantors, this 28 day of December, A.D. 2017.

Scott Cooper Mclachlan
SCOTT COOPER MCLACHLAN

Julie Ann Mclachlan
JULIE ANN MCLACHLAN

STATE OF UTAH)
) ss.
COUNTY OF UTAH)

12-28-17 On the date first above written personally appeared before me, SCOTT COOPER MCLACHLAN AND JULIE ANN MCLACHLAN, the signers of the within and foregoing instrument, who duly acknowledged to me that they executed the same.

Angie M. Allen
Notary Public

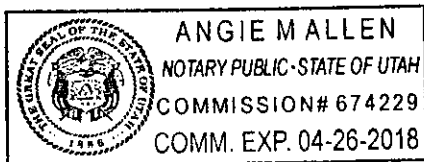

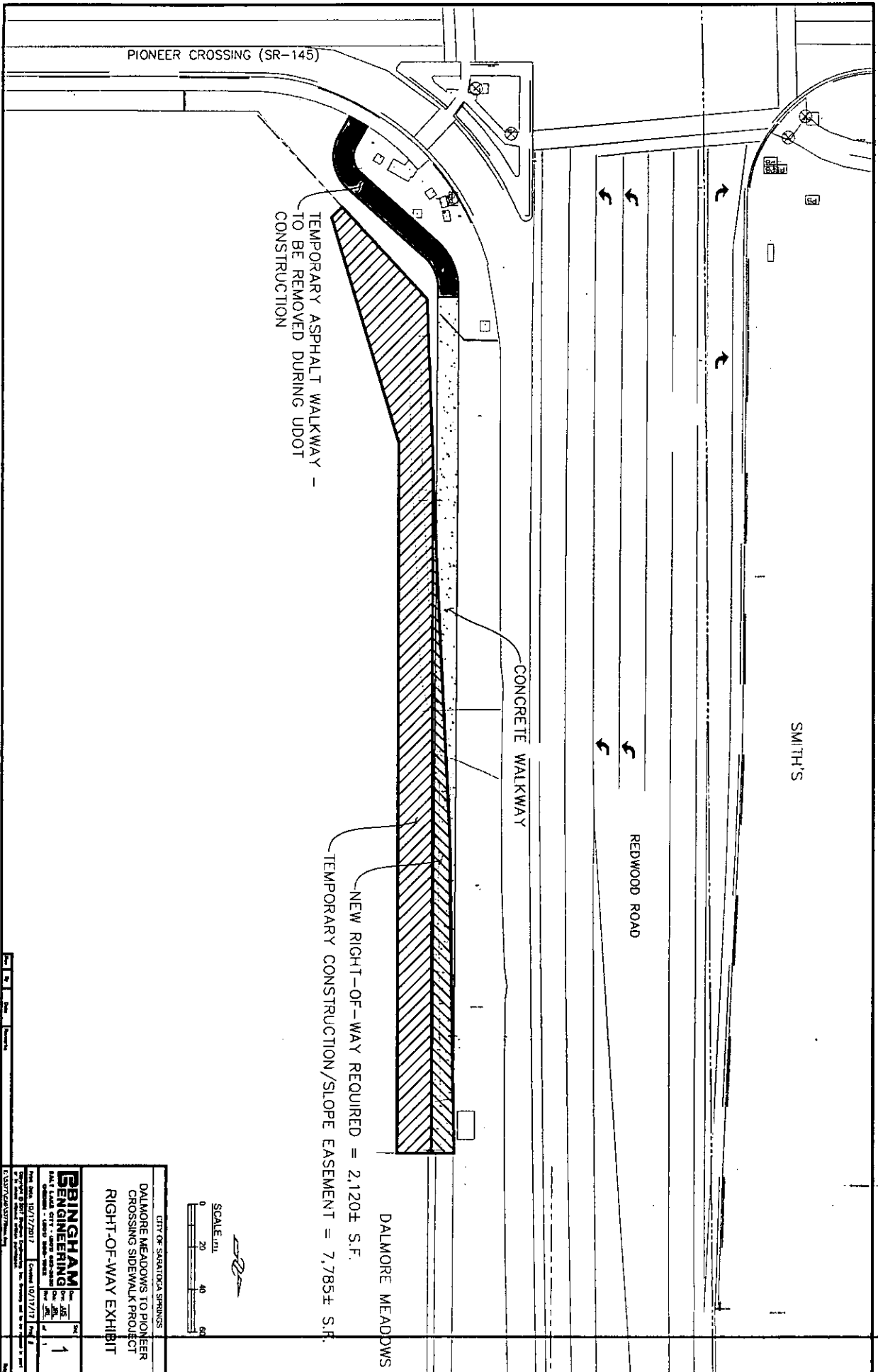

PIONEER CROSSING (SR-145)

TEMPORARY ASPHALT WALKWAY -
TO BE REMOVED DURING UDOT
CONSTRUCTION

CONCRETE WALKWAY

REDWOOD ROAD

SMITH'S

DALMORE MEADOWS
NEW RIGHT-OF-WAY REQUIRED = 2,120± S.F.
TEMPORARY CONSTRUCTION/SLOPE EASEMENT = 7,785± S.F.

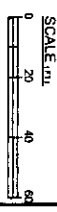

DATE	10/17/2017	SCALE	AS SHOWN
PROJECT	DALMORE MEADOWS TO PIONEER CROSSING SIDEWALK PROJECT		
EXHIBIT	RIGHT-OF-WAY EXHIBIT		
BY	[Signature]	CHECKED	[Signature]
DATE	10/17/2017	DATE	10/17/2017
PROJECT	DALMORE MEADOWS TO PIONEER CROSSING SIDEWALK PROJECT		
EXHIBIT	RIGHT-OF-WAY EXHIBIT		
NO. OF SHEETS	1	TOTAL SHEETS	1

BINGHAM ENGINEERING

1000 N. 1000 W. SALT LAKE CITY, UT 84119
 TEL: 801.487.8888 FAX: 801.487.8889
 WWW.BINGHAMENGINEERING.COM

PROJECT: DALMORE MEADOWS TO PIONEER CROSSING SIDEWALK PROJECT
 EXHIBIT: RIGHT-OF-WAY EXHIBIT
 SHEET: 1 OF 1