

7479740

When Recorded Please Return To:
Salt Lake City Public Utilities
Attn: Karryn Greenleaf
1530 South West Temple
Salt Lake City, Utah 84115

7479740
10/01/1999 10:33 AM NO FEE
NANCY WORKMAN
RECORDER, SALT LAKE COUNTY, UTAH
SL CITY PUBLIC UTILITIES
BY: ZJM, DEPUTY - WI 9 P.

RECORDED

SEP 28 1999

UTILITY PERMIT FOR CANAL CROSSINGS

CITY RECORDER

THIS AGREEMENT is made and entered into as of SEP 28 1999, by and between SALT LAKE CITY CORPORATION, a municipal corporation of the State of Utah, hereinafter "City", and Level 3 Communications, LLC, a Delaware limited liability company, whose mailing address is 1450 Infinite Drive, Louisville, Colorado 80027 hereinafter "Permittee".

WITNESSETH:

WHEREAS, City is the owner of certain real property or easement within which is located its Surplus Canal, CWA Drain 2, CWA Drain 4, Little Goggin Drain and a 20" Watermain which runs in Gladiola Street.

WHEREAS, Permittee is desirous of obtaining a permit from the City for using part of the said canal property for the installation of Telecommunication Facilities within conduits ("facilities") at the approximate RailRoad Mile Post Numbers: CWA Drain #2 at 780+6+75, CWA Drain #4 on 1400 West at 781+7+00, Little Goggin Drain at 778+20+75 and 20" Watermain at Glendale Street 778+00+00, and

WHEREAS, City is willing to grant a permit for such use:

NOW, THEREFORE, in consideration of the following mutual benefits and covenants, the parties agree as follows:

1. For the sum of three hundred and fifty (\$350.00) and other valuable consideration, the receipt of which is hereby acknowledged, City hereby grants permission and license to Permittee to install and maintain facilities within the premises described in Exhibit "A", attached hereto and by this reference made a part hereof. Said premises is located in Salt Lake County, State of Utah and this permit is SUBJECT TO the following additional conditions:

2. Prior to any installation, the Permittee's plans, specifications and timetable for installation of said facilities shall be submitted to and must be approved by the City's Director of Public Utilities ("Director") before any work thereon may commence. Permittee will make any changes in such plans, specifications or timetable as and when requested by said Director.

3. Permittee agrees not to erect any other structure other than said facilities or make any other improvements on the said City owned premises without the prior written consent of the City. Permittee agrees to perform all such installation pursuant to all applicable federal laws or regulations, City ordinances, Salt Lake County and State law. Installation and maintenance of the facilities on the premises shall be at Permittee's sole expense.

BKOR 8313PC3380

4. Permittee will, at Permittee's sole expense, and within a reasonable amount of time and as requested in writing by the City, remove, replace or alter the said facilities installed by Permittee on said premises.

5. Permittee agrees that at all times said premises is subject to any use City may desire, and City shall not be liable to Permittee for any loss of use or damage to Permittee's facilities thereon resulting from such use.

6. Permittee agrees, upon written notice from City's Director, to repair any damage caused to the premises or its Canal as a result of Permittee's its/his agents', employees', or invitees' use of this permit.

7. This permit is subject to revocation by the City for cause upon the expiration of thirty (30) days prior written notice sent to the Permittee at the Permittee's above stated address. Upon receipt of such notice, Permittee shall remove any improvements from the said premises, restoring the surface of said premises as near as possible to its condition prior to the issuance of this permit.

8. Permittee agrees to indemnify, hold harmless and defend the City, its agents and employees, from and against all claims, mechanics liens, demands, damages, actions, costs and charges, for personal injury or property damage and other liabilities, including attorney's fees, arising out of or by any reason of Permittee's use of said premises or any activities conducted thereon by Permittee, his/her/its agents, employees, invitees or trespassers.

9. This permit is not assignable; provided, however that Permittee may fully assign this permit to its corporate parent, affiliate or subsidiary.

10. Any ambiguity in this permit shall be construed in favor of the City.

11. This permit embodies the entire agreement between the parties and it cannot be changed except through a written instrument signed by both parties.

IN WITNESS WHEREOF, the parties hereto have set their hands and seals the day and year herein first above written.

SALT LAKE CITY CORPORATION

By Laoyu W. Hooton
PUBLIC UTILITIES DIRECTOR

BOOK 8313 P 3381

ATTEST:
Christina Jackson
CHIEF DEPUTY CITY RECORDER



APPROVED AS TO FORM
Salt Lake City Attorney's Office
Date 9/1/99
By [Signature]

LEVEL 3 COMMUNICATIONS, LLC

John L. Scarnò
By: John L. Scarnò
Its: Senior Director

RECORDED

SEP 28 1999

CITY RECORDER

ACKNOWLEDGMENT

STATE OF UTAH)
 : ss.
County of Salt Lake)

On SEP 28 1999, personally appeared before me LEROY W. HOOTON, JR. and Christine Meeker, who, being by me duly sworn, did say that they are the PUBLIC UTILITIES DIRECTOR and CHIEF DEPUTY CITY RECORDER, respectively, of SALT LAKE CITY CORPORATION, and said persons acknowledged to me that said corporation executed the same.

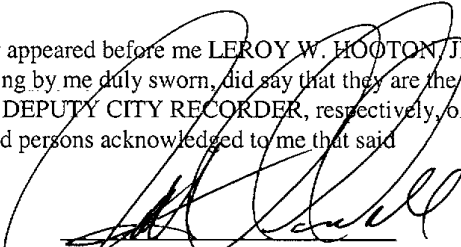

My Commission Expires 7-10-03 NOTARY PUBLIC, residing in Salt Lake County, Utah



ACKNOWLEDGMENT

STATE OF COLORADO)
 : ss.
County of Jefferson)

On the 21st day of July, 1999, personally appeared before me John L. Scarano, who, being by me duly sworn, did say that he/she is the Senior Director, respectively, of Level 3 Communications, LLC, a Delaware limited liability company, that the foregoing instrument was signed in behalf of said corporation by authority of a resolution of its board of directors; and said person acknowledged to me that said corporation executed the same.

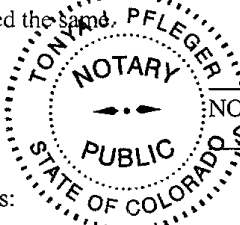

Tony P. Pfleger
NOTARY PUBLIC, residing in Summit County, CO

My Commission Expires: 5/27/2002

BOOK 8313P03382

Isor: kichwell jerry
 Date: 02 JUN 98
 File: hgsic\pkg06_mp767-mp783(pkg06)\hgsic781.dgn

As-Built Quantities	
Description	Level 3
Casing (ft)	(ft)
Manholes (ea)	(ea)
Headwalls (ea)	(ea)
Prepays (ea)	(ea)

Revision	
By	Date
CRS	17 NOV 98
CRS	20 FEB 99

Program: InterCity Network
 City Pair: Las Vegas to Salt Lake City
 Package Title: MP 7749 to MP 783
 Drawing Title: MP 39+60 to 50+01

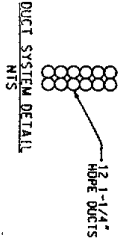

NOTE
 PRIOR TO ANY EXCAVATION IN THE STATE OF UTAH, IT IS MANDATORY TO CALL UNION PACIFIC'S RIGHT-OF-WAY LINE AT 1-800-338-9193 AT LEAST 48 HOURS IN ADVANCE OF ANY CONSTRUCTION ACTIVITY.

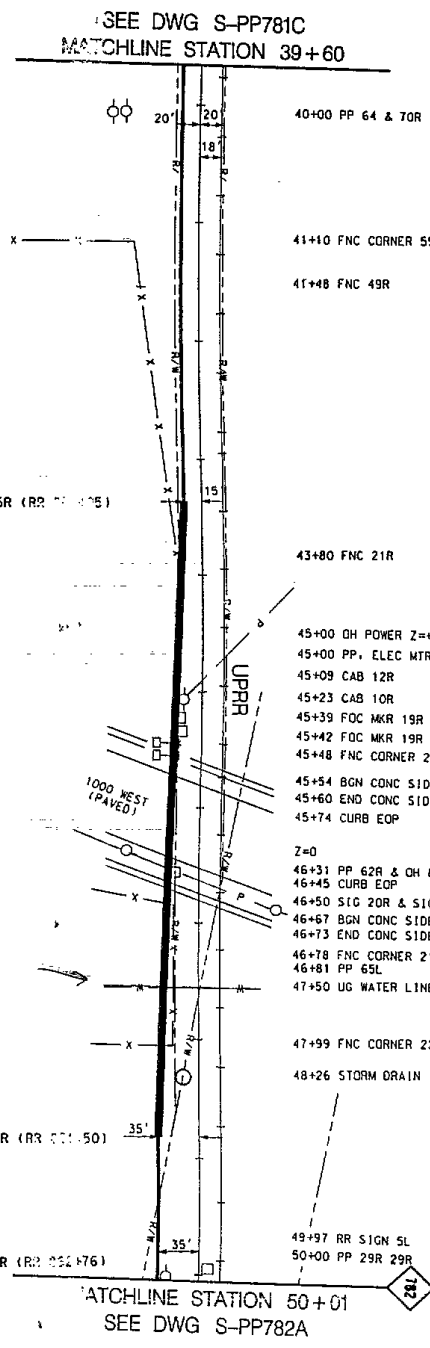
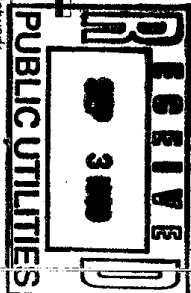
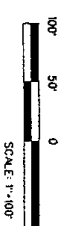

SEC 02, T1S, R1W, U1M
 SALT LAKE CITY, UT

BRN# 8313P03383



J.M.

JUN 08 1999

18-50
02 JUN 99
1:10:43

wg-slc\pkg06.mp767-mp783\pkg06b\hgslc780d.dgn

Dist	Description	Level 3	Qty	Unit	Material	Remarks
	Clearing	(ft)				
	Handhole	(ea)				
	Manhole	(ea)				

Dist	Description	Level 3	Qty	Unit	Material	Remarks
	Clearing	(ft)				
	Handhole	(ea)				
	Manhole	(ea)				

Dist	Description	Level 3	Qty	Unit	Material	Remarks
	Clearing	(ft)				
	Handhole	(ea)				
	Manhole	(ea)				

Dist	Description	Level 3	Qty	Unit	Material	Remarks
	Clearing	(ft)				
	Handhole	(ea)				
	Manhole	(ea)				

Dist	Description	Level 3	Qty	Unit	Material	Remarks
	Clearing	(ft)				
	Handhole	(ea)				
	Manhole	(ea)				

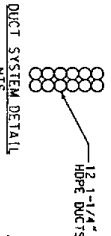

48+39 P I END BORE 50R (RR B03+57)

53+75 BGN BORE 50R (RR 808+93)

56+60 END BORE 50R (RR 811+78)

J.M.
JUN 08 1999

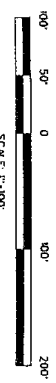

NOTE
PRIOR TO ANY EXCAVATION IN THE STATE OF UTAH, CALL THE UTILITY LOCATING SERVICE AT 1-800-332-5000 OR 1-800-562-4111 AT LEAST 48 HOURS IN ADVANCE OF ANY CONSTRUCTION ACTIVITY.

NOTE
PRIOR TO ANY EXCAVATION IN THE STATE OF UTAH, CALL THE UTILITY LOCATING SERVICE AT 1-800-332-5000 OR 1-800-562-4111 AT LEAST 48 HOURS IN ADVANCE OF ANY CONSTRUCTION ACTIVITY.

SEE DWG S-P780C
MATCHLINE STATION 43+35

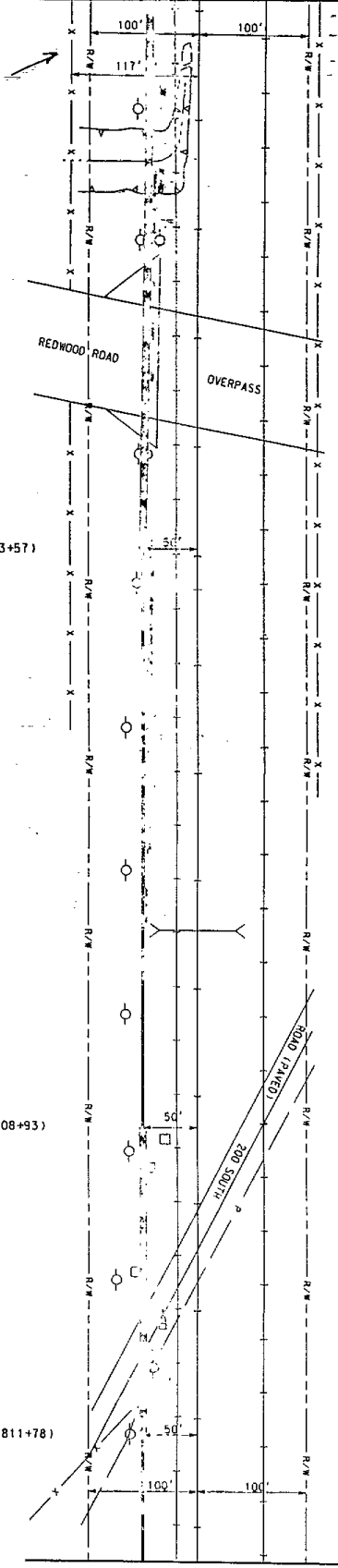

- 43+75 BGN DITCH 39R Z=-6
- 44+36 PP 55R
- 44+55 BGN HOLE 39R -113R
- Z=-10
- 45+14 END HOLE 60R - 116R
- 45+38 SIGN 30R
- 45+40 SIGN 30R
- 45+55 PP 34R, 46R, 53R
- 45+67 BGN CONC APRON 38R
- 46+25 BGN OVERPASS 75R
- Z=+21
- 47+27 END OVERPASS 75R
- 47+42 END CONC APRON 39R
- 47+52 PP 47R, 54R
- 48+70 PP 55R
- 50+03 PP 65R
- UPRR
- 51+36 PP 65R
- 51+92 40" CULV 35R (807+10)
- 52+69 PP 65R
- 53+86 SIG CAB 30R
- 53+97 PP 62R, 63R
- 54+13 RR CAB 4'x4' 44R
- 55+10 TEL BOX 57R
- 55+17 PP 61R
- 55+30 EOP 50R Z=+4
- 55+62 RR XING ARM 32R
- 55+90 EOP 50R
- 55+98 PP 40R
- 56+05 OH PWR 50R Z=+51
- 56+38 BGN FNC 54R
- 56+60 PP 61R

MATCHLINE STATION 57+77
SEE DWG S-P781A

SEC. 3, T1S, R1W, S1B, &M,
SALT LAKE CITY, UT

BOOK 8313P03384



Program: Intercity Network
City Pair: Las Vegas to Salt Lake City
Package Title: MP 7748 to MP 783
Drawing Title: MP 780: 43+35 to 57+77

kg-slct\pkg06.mp767-mp783\pkg06b\gslct780a.dgn
 02 JUN 99
 11:46:31

Level	Description	Level	Rev	Description
0	Duct	Level 3		
1	Canal	(0)		Fiber (949) (10)
2	Handhole	(0a)		Fiber (1449) (10)
3	Manhole	(0a)		Fiber () (10)
4	Manhole	(0a)		Shoes (989)
5	Manhole	(0a)		Markers (9a)

Level (3)

 COMMUNICATIONS

Program: Intercity Network
 City Pair: Las Vegas to Salt Lake City
 Package Title: MP 7748 to MP 783
 Drawing Title: MP 780: 0+00 to 14+45

Kiewit Network Services Co.

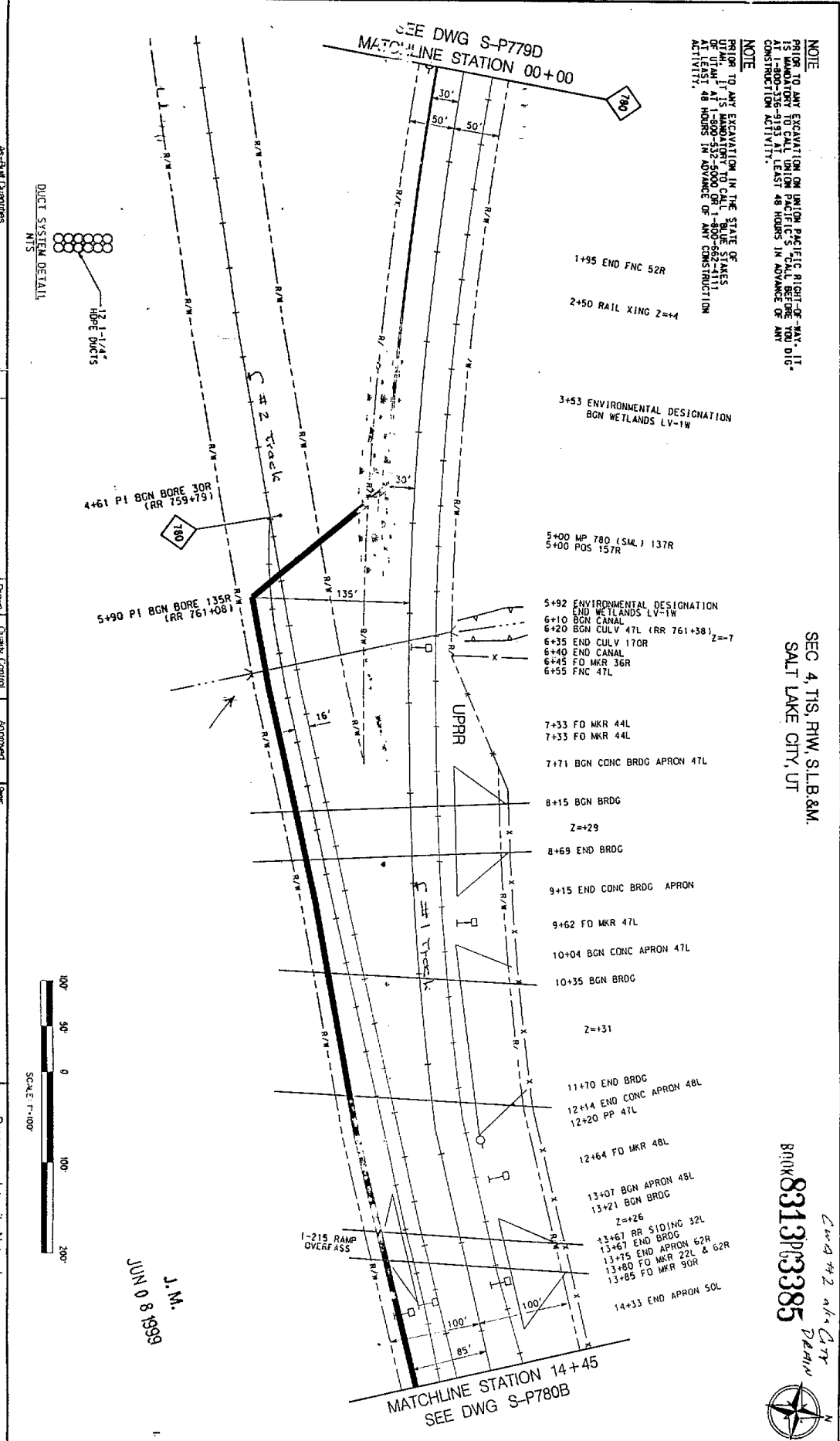

NOTE
 PRIOR TO ANY EXCAVATION ON UNION PACIFIC RIGHT-OF-WAY, IT IS MANDATORY TO CALL UNION PACIFIC'S "CALL BEFORE YOU DIG" SERVICE AT 1-800-532-5000 OR 1-800-662-3111 AT LEAST 48 HOURS IN ADVANCE OF ANY CONSTRUCTION ACTIVITY.

SEC 4, T1S, R1W, S1B, S1M
 SALT LAKE CITY, UT

BUNK
 8313PC63385



User: khwlljerry
 Date: 02 JUN 98
 File: lvgslic

vg-slc\pkg06_mp767-mp783\pkg06b\vgslc778b.dgn

As-Built Quantities	Level 3	Level 3	Rev	Description	Drawn By	Checked By	Approved By	Date
Change (0)	Fiber (987) (0)	Fiber (144) (0)		Issued for Review	ARJ	HRH		16 NOV 98
Handnote (0)	Fiber (1) (0)	Splice (0)						
Maintenance (0)	Manholes (0)	Manholes (0)						
	Products (0)	Products (0)						

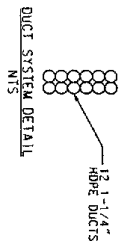

NOTE
 PRIOR TO ANY EXCAVATION IN THE STATE OF UTAH, IT IS MANDATED BY UTAH CODE 19-2-106 AT 1-900-338-9193 AT LEAST 48 HOURS IN ADVANCE OF ANY CONSTRUCTION ACTIVITY.



J.M.
 JUN 08 1999

SEE DWG S-P778A
 MATCHLINE STATION 13+80

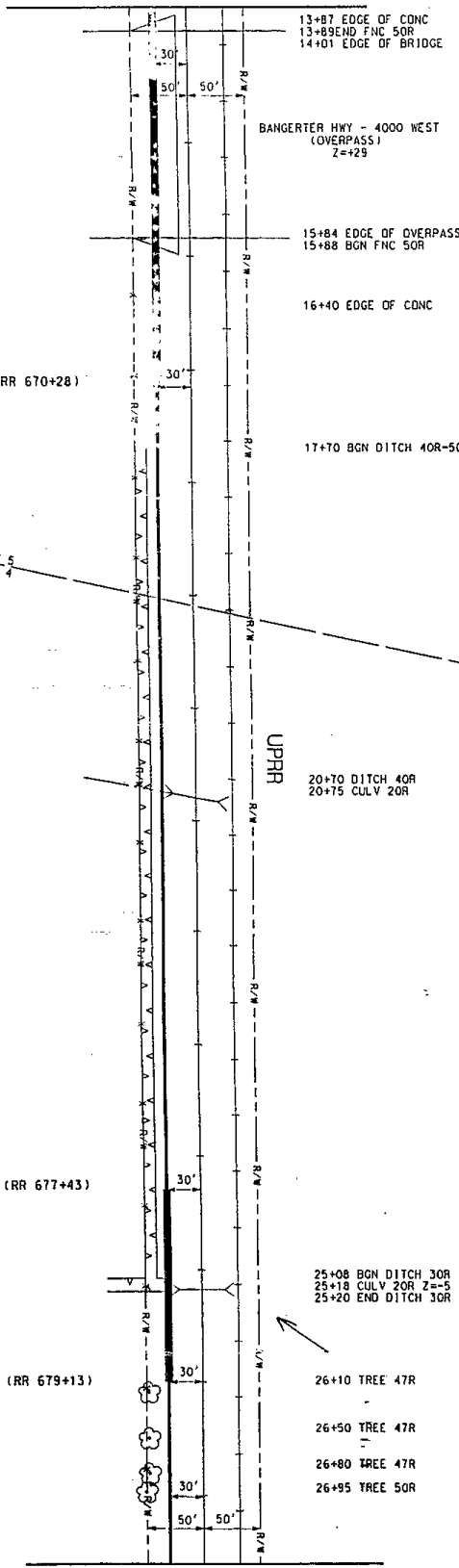

SEC 5 & 4, T1S, R1W, S1B&M.
 SALT LAKE CITY, UT

BOOK 8313P3386

Geosw DRAW



MATCHLINE STATION 27+60
 SEE DWG S-P778C

Level (3)
 Kiewit Network Services Co.
 Parsons Brinckerhoff
 Program: Intercity Network
 City Part: Las Vegas to Salt Lake City
 Package Title: MP 774B to MP 783
 Drawing Title: MP 778: 13+80 to 27+60

Sheet No.	1	Total	1
Checked By	S	Checked Date	778B
Rev	0	Rev	0
Sheet No.	of	Sheet No.	of

As-Built Quantities		Description		Quantity Control		Approved	
Direction	Layer 31	Direction	Layer 31	Drawn By	Checked By	By	Date
Change	(in)	Fiber (SFP)	(ft)	SMK	RJK	06 NOV 98	
Hardware	(in)	Fiber (L44)	(ft)				
Material	(in)	Splice	(ft)				
		Endcap	(ft)				

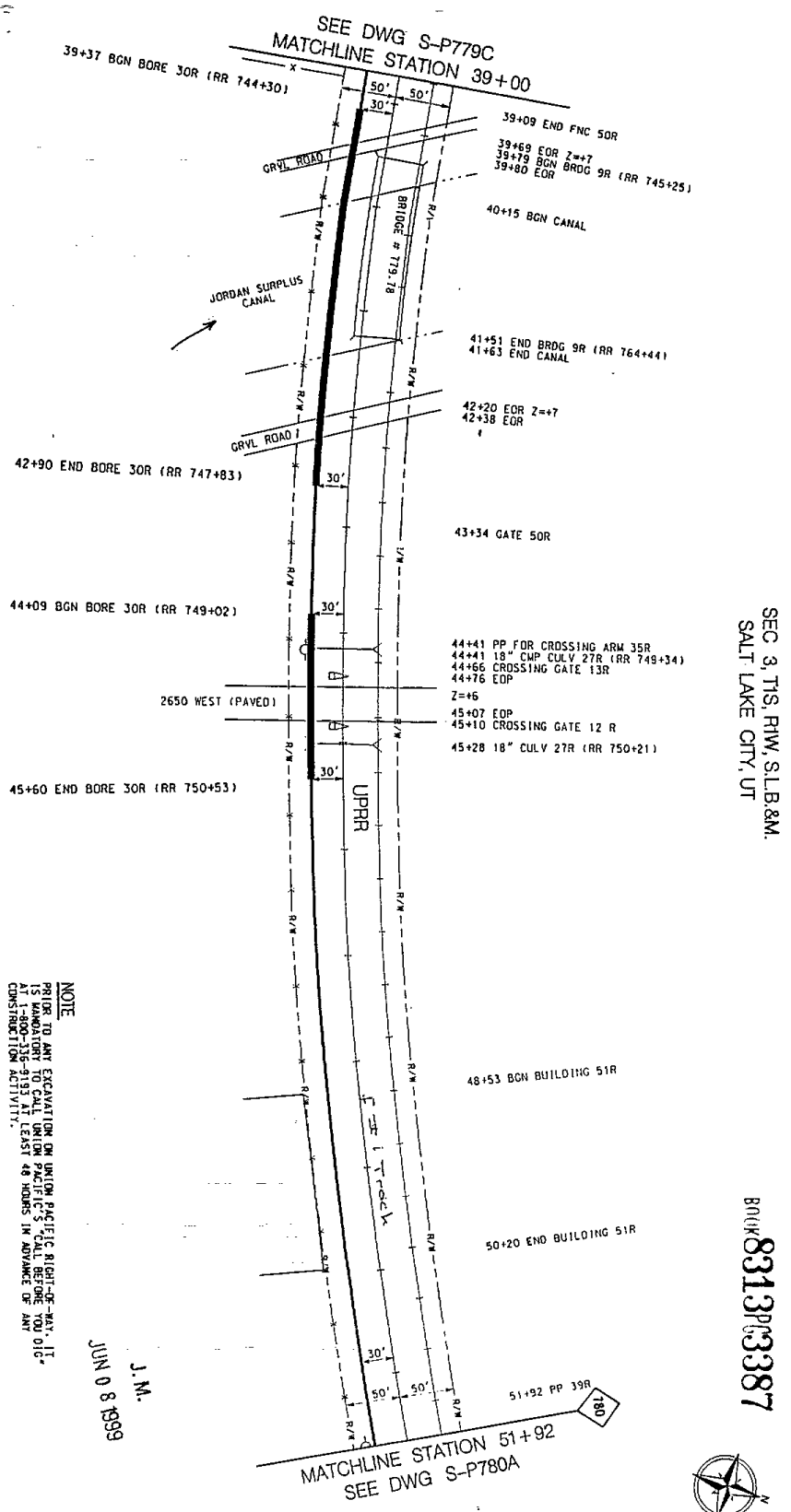
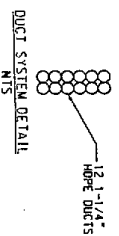

NOTE
 PRIOR TO ANY EXCAVATION ON UNION PACIFIC RIGHT-OF-WAY, IT IS MANDATORY TO CALL UNION PACIFIC'S "CALL BEFORE YOU DIG" AT 1-800-336-9193 AT LEAST 48 HOURS IN ADVANCE OF ANY CONSTRUCTION ACTIVITY.
NOTE
 PRIOR TO ANY EXCAVATION IN THE STATE OF NEVADA, IT IS MANDATORY TO CALL BLUE STAKES OR UTILITY AT 1-800-532-5000 OR 1-800-662-4111 AT LEAST 48 HOURS IN ADVANCE OF ANY CONSTRUCTION ACTIVITY.

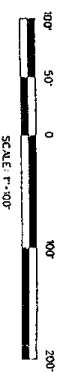

J.M.
 JUN 08 1999

SEC 3, T1S, R1W, S1B, 8M.
 SALT LAKE CITY, UT

831303387

