

WHEN RECORDED, MAIL TO:  
Utah Department of Transportation  
Right of Way, Fourth Floor  
Box 148420  
Salt Lake City, Utah 84114-8420

11986798  
2/3/2015 4:44:00 PM \$14.00  
Book - 10293 Pg - 3889-3891  
Gary W. Ott  
Recorder, Salt Lake County, UT  
OLD REPUBLIC TITLE SO JORDAN  
BY: eCASH, DEPUTY - EF 3 P.

### **COURTESY RECORDING**

No assurances are given by the company either  
Express or implied for accuracy or content.

## **Quit Claim Deed**

Salt Lake County

Tax ID No.27-36-127-007  
Parcel No. 0071:45:Z2Q  
Project No.SP-0071(12)1  
PIN:3219

The UTAH DEPARTMENT OF TRANSPORTATION, by its duly appointed Director of Right of Way, Grantor, of Salt Lake City, County of Salt Lake, State of Utah, hereby QUIT CLAIMS to BOULDER VENTURES, LLC, Grantee, at Salt Lake City, County Salt Lake, State of Utah, Zip 84106, for the sum of Ten (\$10.00) Dollars, and other good and valuable considerations, the following described tract of land in Salt Lake County, State of Utah, to-wit:

A parcel of land being an entire tract of property situate in the NW1/4 of Section 36, T. 3 S, R. 1 W, S.L.B. & M. The boundary of said parcel of land is described as follows:

Beginning at the Northeast corner of said entire tract, which point is 3595.34 ft. N. 00°12'13" W. and 543.03 ft. N. 51°33'35" E. and 86.63 ft. N. 20°02'25" W. and 1431.10 ft. N. 51°21'45" E. and S. 01°50'18" E., 62.12 ft. from the Southwest corner of said Section 36; and running thence along the easterly boundary line of said entire tract the following three courses: S. 01°50'30" E., 10.37 ft.; thence S. 09°37'33" E., 72.38 ft.; thence S. 01°49'00" E., 172.92 ft. to the south line of said entire tract; thence S. 88°11'00" W., 15.00 ft. along said south line; thence N. 01°49'00" W., 255.00 ft. along the west line of said entire tract to the northwest corner of said entire tract; thence N. 88°11'00" E., 5.16 ft. along said north line to the Point of Beginning.

The above described parcel of land contains 3,370 square ft. in area or 0.077 acres, more or less.

Signs, Billboards, outdoor Advertising structures, or advertising of any kind as defined in Title 23 United States Code, Section 131, shall not be erected, displayed, placed or maintained upon or within this tract, EXCEPT signs to advertise the sale, hire or lease of this tract or the principal activities conducted on this land.

Continued on Page 2  
COMPANY RW-05UD (12-01-03)

**Ent 11986798 BK 10293 PG 3889**



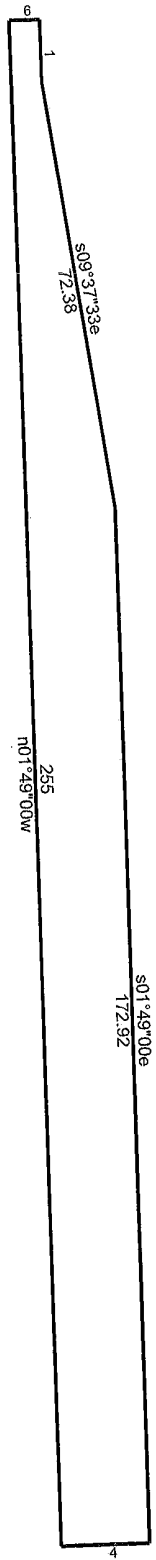

45:Z2Q

2/10/2014

Scale: 1 inch= 30 feet

File: 3219\_SP-0071(12)1\_10Q\_45\_Z2Q\_DeedPlot.ndp

Tract 1: 0.0774 Acres (3370 Sq. Feet), Closure: n00.0000e 0.00 ft. (1/344115), Perimeter=531 ft.

- 01 s01.5030e 10.37
- 02 s09.3733e 72.38
- 03 s01.4900e 172.92
- 04 s88.1100w 15
- 05 n01.4900w 255
- 06 n88.1100e 5.16