

This map is provided solely for the purpose of assisting in locating the property and Cottonwood Title Insurance Agency, Inc. assumes no liability for variation, if any, with any actual survey.

PART OF THE NE.1/4, OF SECTION 16, T.5N., R.2W., S.L.B. & M. COUNTRY MEADOWS COMMERCIAL SUBDIVISION

467

TAXING UNIT: 41

IN ROYCITY
SCALE 1" = 60'

SEE PAGE 72-1

4800 SOUTH ST

update Plat not available yet

N 0°18'08" E 5.90' S 89°38'53" E 93.44' S 89°38'53" E 135.54'

SEE PAGE 72-1

SEE PAGE 72-1

MIDLAND DRIVE
708.20' 435.44'

WEBER SCHOOL DEVELOPMENT LLC
094670004 0006
5.09 AC±

LOT 1

3500 WEST ST

MMC INVESTMENTS LLC SERIES R09
094670005 0007
4.36 AC±

LOT 2

SEE PAGE 72-1

SEE PAGE 450

10' UTILITY & DRAINAGE EASEMENTS EACH SIDE OF PROPERTY LINES AS INDICATED BY DASHED LINES EXCEPT AS OTHERWISE SHOWN.

FOR COMPLETE ENG DATA SEE ORIGINAL DEDICATION PLAT IN BOOK 50, PAGE 55 OF RECORDS.

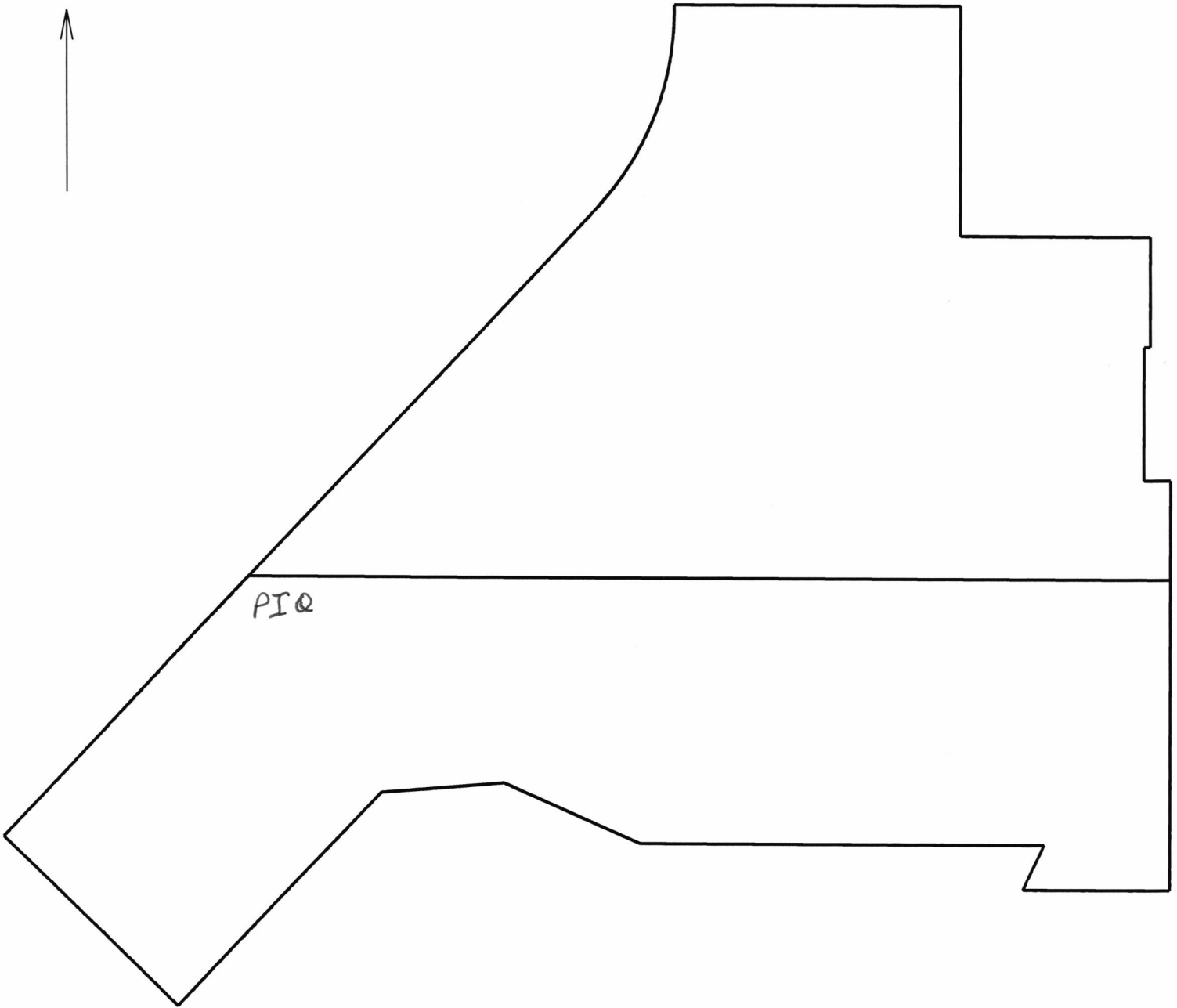

PIQ

1/8/2020

Scale: 1 inch= 124 feet

File: deedplot new.ndp

Tract 1: 9.6506 Acres (420380 Sq. Feet), Closure: s60.1014w 0.01 ft. (1/255736), Perimeter=3190 ft.
Tract 2: 5.0509 Acres (220018 Sq. Feet), Closure: s22.3857w 0.01 ft. (1/366756), Perimeter=2242 ft.
Tract 3: 4.5997 Acres (200363 Sq. Feet), Closure: s86.1138w 0.01 ft. (1/290471), Perimeter=2465 ft.