

Conditional Use Permit

Date Issued	Receipt #	Permit #
3/28/96	81653	45318

Name PacifiCorp/Utah Power Zone Ag

Address approximately 5110 West Valley View Highway Tax Number 12-032-0001

three miles west of Logan Acres portion of 325.24

Legal Description Attached

ENT 637204 Bk 692 Pg 161
 DATE 28-MAR-1996 11:17AM FEE 12.00
 MICHAEL L GLEED, RECORDER - FILED BY CH
 CACHE COUNTY, UTAH
 For PACIFICORP

Date of Action: March 4, 1996

Conditional Use Permitted: To allow the development of a recreational site with boat ramp, dock, restroom facilities, access roads, parking stalls, and a picnic shelter.

This conditional permit is subject to the following specific conditions:

1. This conditional use permit must be recorded within 5 days of issuance and proof of the recording delivered to Zoning Administrator within 30 days.
2. The applicant-landowner must sign the below agreement of acceptance
3. Compliance with any variance, special exception or specific permit issued by the Board of Adjustment.

Expiration: This conditional use permit shall expire and be null and void 1 year after the effective date unless substantial work shall have been accomplished towards its completion. If at any time any specific condition is not fully complied with, the Planning Commission may revoke the condition use permit upon a 30 day notice to the applicant/property owner and following a hearing.

Dated March 14 19 96

Lorene Greenhalgh
 Cache County Zoning Administrator

Agreement of Acceptance

I have read, understand, and agree to comply with the Land use Ordinance and the terms of this permit. I realize that in order to do any construction on the property, I will be required to obtain a building permit and that I will need to meet the standards of the County for any improvements.

I agree to reimburse Cache County for any costs of enforcement including reasonable attorney's fees, or any other costs of enforcement incurred by Cache County resulting from any failure to comply with the Land use and the terms of this condition use permit.

Dated: 3-28-96



Craig A. McKinnon
 Application/Property Owner

STATE OF UTAH
COUNTY OF CACHE

Sworn to and subscribed to before me this 28th day of March, 19 96.

Lorene Greenhalgh
 Notary Public

A tract of land to be used as a recreation area, situate in the southeast one-quarter of Section 28, Township 12 North, Range 1 West, Salt Lake Meridian described as follows:

Beginning on the west line of the said southeast one-quarter at a point North 00°58'00" West (Basis of Bearing) 1006.5 feet from a Cache County Survey Monument marking the Southwest corner of said southeast one-quarter of Section 28, Township 12 North, Range 1 West, Salt Lake Meridian, said point being on a fence marking the southerly boundary line of the recreation site, and running thence North 00°58'00" West 173.6 feet, more or less, along said west line to the southerly right-of-way line of State Route 30, said southerly right-of-way not being defined by deed but by a verbal right-of-use agreement made between Cache County and the State Road Commission of Utah for the conversion of a county road to a portion of the said State Route 30; thence easterly 1247 feet, more or less, along said southerly right-of-way line to the west bank of the Little Bear River; thence southwesterly along said west bank to the said fence marking the southerly boundary line of the recreation site; thence North 71°23'27" West 945 feet, more or less, to the point of beginning, containing 7.20 acres, more or less.

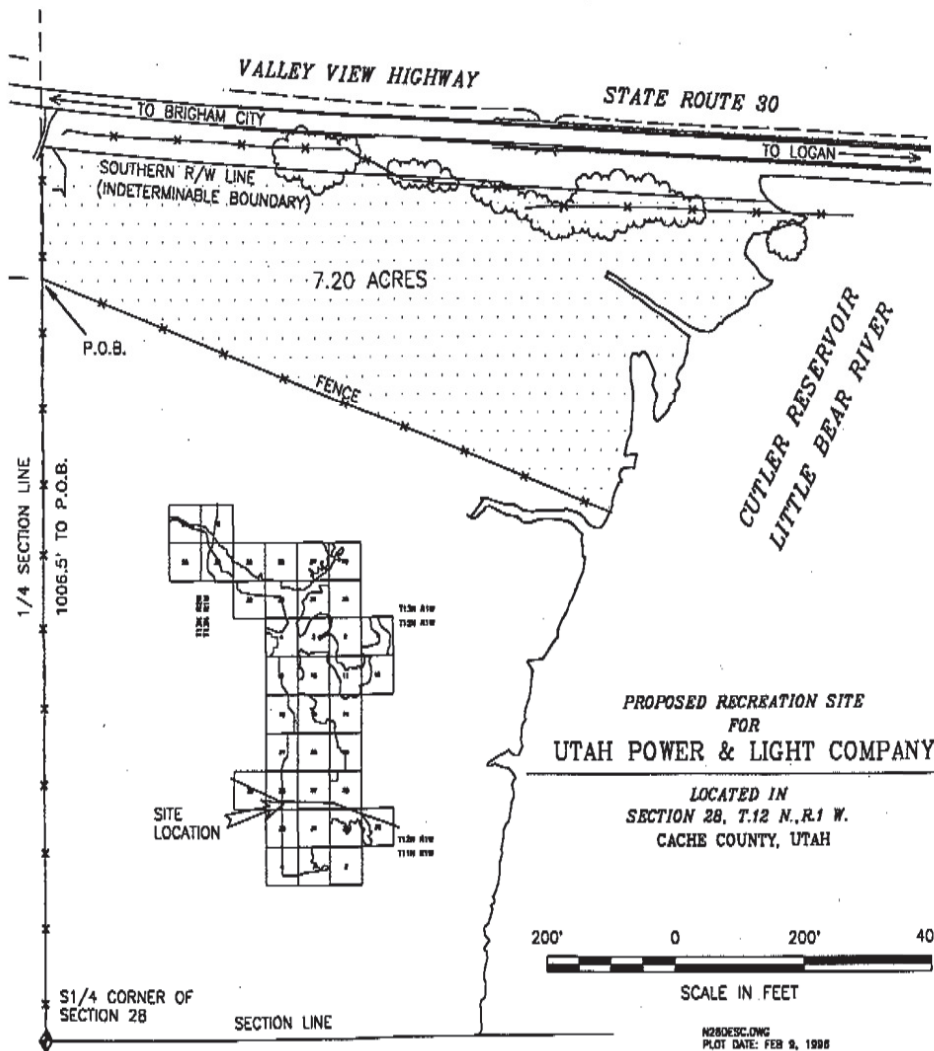

N2805CLOWG
PLOT DATE: FEB 9, 1998