

E 2333269 B 4446 P 238-245
RICHARD T. MAUGHAN
DAVIS COUNTY, UTAH RECORDER
1/10/2008 12:14:00 PM
FEE \$25.00 Pgs: 8
DEP eCASH REC'D FOR METRO NATIONAL TITLE

This instrument prepared by:

Wal-Mart Real Estate Business Trust
Sam M. Walton Development Complex
2001 S.E. 10th Street
Bentonville, AR 72716-0550
Attn: Brad Rogers, Assistant General Counsel
Telephone: (479) 204-3147

Return recorded document to:

Chicago Title Insurance Company
171 N. Clark Street, 4th Floor
Chicago, IL 60601
Attn: Sue Marchewski
MNT 06049346
12-606-0002
C # 12-606-0001

ACCESS EASEMENT

This ACCESS EASEMENT is made effective December 21, 2007, between **WAL-MART REAL ESTATE BUSINESS TRUST**, a Delaware statutory trust, with an address of 702 S.W. 8th Street, Bentonville, AR 72716 ("Wal-Mart"); and **CARL KARCHER ENTERPRISES, INC.**, a California corporation, with an address of 6307 Carpinteria Blvd. Suite A, Carpinteria CA 93013 ("Grantee").

WITNESSETH

WHEREAS, Wal-Mart is the owner of that certain tract or parcel of land situated in the City of Syracuse, County of Davis, State of Utah, identified as Tract 1 on the site plan attached hereto as Exhibit "A" ("Tract 1"); and

WHEREAS, Grantee will be by the time this instrument is recorded the owner of that 0.70 acre, more or less, tract or parcel of land in the same city, county, and state, which tract lies adjacent to Tract 1 and is identified as Tract 2 on Exhibit "A" and more fully described on Exhibit "B" ("Tract 2") which tract Wal-Mart Stores, Inc., is current owner of and intends to convey title to Grantee by deed; and

WHEREAS, Grantee has requested from Wal-Mart, and Wal-Mart is desirous of granting to Grantee, a non-exclusive easement for pedestrian and vehicular ingress and egress over and across that portion of Tract 1 identified as the Access Area on Exhibit "A" and more fully described on Exhibit "C" ("Access Area").

NOW THEREFORE, in consideration of one dollar (\$1.00) and other good and valuable consideration, Wal-Mart does hereby grant to Grantee a non-exclusive easement for vehicular and pedestrian ingress and egress over and across the Access Area for access to and from Tract 2, subject to the following terms and conditions to which the parties hereto do hereby agree:

1. **Use of Access Area.** The ingress and egress rights granted hereby may be used non-exclusively by, and are limited to, Grantee and its tenants and their respective customers and employees associated with the business operation to be located on Tract 2. Only passenger vehicles and light trucks and pedestrian traffic associated with Tract 2 may use the Access Area, but nothing herein shall be construed to limit or restrict ingress or egress associated with Tract 1 or any part thereof. Grantee shall not be allowed to use the Access Area for heavy truck traffic except as may be necessary for developing Tract 2 or delivering merchandise to the business operation to be located thereon.

2. Maintenance. (a) In the event Wal-Mart fails to maintain or repair the Access Area, Grantee may do so at its sole expense, provided Grantee uses like or similar quality and type of materials originally installed on the Access Area, and further provided Grantee does not change the grade or elevation of the Access Area without the permission of Wal-Mart. Any repair or maintenance performed within the Access Area must be preceded by a two (2) week written notice to Wal-Mart. Notwithstanding the foregoing, routine maintenance or construction shall be prohibited during the months of November and December, except for the initial construction of Grantee's improvements on Tract 2, and all work shall be completed by October 31st of the then-current year. Grantee covenants and agrees that Tract 1 will not be used as a staging area and will not be used to store equipment, trucks, dirt, supplies, etc. Grantee further covenants and agrees that no heavy trucks associated with the construction shall use the entranceways located upon Tract 1 without Wal-Mart's prior written consent, except for the initial construction of Grantee's improvements on Tract 2.

(b) Grantee shall, at its sole cost and expense pave any unpaved portion of the curb cut area from Tract 2 to the Access Area, and if, in the process of paving and developing the Access Area, Grantee encounters any irrigation equipment previously installed by Wal-Mart in the Access Area, Grantee shall disconnect and relocate any such equipment at its cost. If Grantee encounters any utility lines under the Access Area, it shall encase said lines in order to protect it. If it is necessary for Grantee to remove trees or any other type of landscaping, it shall relocate it adjacent to the Access Area in a location acceptable to Wal-Mart.

3. Damage to Access Area, or Other Improvements. If, in the process of developing Tract 2, Grantee damages, breaks, destroys, or in any way impairs the Access Area, or any other improvements of Wal-Mart, Wal-Mart in its sole discretion, may require Grantee to either: (i) restore at Grantee's sole cost and expense the Access Area, or Wal-Mart's improvements, to its original quality and condition; or (ii) Wal-Mart may restore the Access Area, or improvements, and invoice Grantee for Wal-Mart's costs incurred restoring the damaged Access Area, or improvements; whereupon Grantee agrees to reimburse Wal-Mart within thirty (30) days of receipt of an invoice for such expenses.

4. Indemnification. Grantee shall indemnify and hold harmless Wal-Mart from any damages or liability to persons or property that might arise from the use of the Access Area by Grantee, its customers, suppliers, employees, and tenants or anyone else using the Access Area for ingress and egress to and from Tract 2. Grantee further agrees that Grantee will at all times during the duration of this easement maintain and pay for comprehensive general liability insurance affording protection to Wal-Mart and Grantee naming Wal-Mart as an additional insured on the policy or policies for a combined bodily injury and property damage limit of liability not less than \$2,000,000.00 for each occurrence. Grantee further agrees, upon request to deliver to Wal-Mart a certificate or certificates from an insurance company or insurance companies satisfactory to Wal-Mart evidencing the existence of such insurance and naming Wal-Mart as an additional insured.

5. Relocation. Wal-Mart reserves the right in its sole and absolute discretion to modify or relocate the Access Area provided such modification or relocation does not materially restrict or prevent ingress and egress to and from Tract 2.

6. Compliance. Grantee hereby warrants and represents to Wal-Mart that Grantee in exercising its rights under this Agreement shall comply fully with any federal, state or local laws, regulations, ordinances, permits or other authorizations. In addition to the other representations contained herein, Grantee hereby warrants and represents to Wal-Mart that Grantee shall comply fully with any federal, state or local laws, regulations, ordinances, permits or other authorizations or approvals or other requirements relating to storm water discharges or the control of erosion or sediment discharges from construction projects, including but not limited to the Clean Water Act, 33 U.S.C. § 1251 et seq., and the Storm Water General Permit for Discharges Associated with Construction Activities (collectively the "Storm Water Requirements") (including without limitation preparing a Storm Water Pollution Prevention Plan (if applicable) to avoid negatively impacting any erosion or sediment controls during earth-disturbing activities, if any) in exercising any rights or privileges under this Agreement, Grantee recognizing and affirming Wal-Mart would not enter into this Agreement without this warranty and representation from Grantee. Furthermore, Grantee hereby warrants and represents to Wal-Mart that Grantee has a policy to (i) comply in all respects with all immigration laws, statutes, rules, codes and regulations, (ii) properly maintain all records required by the United States Citizenship and Immigration Services (the "USCIS"), including, without limitation, the

completion and maintenance of the Form I-9 for each of Grantee's employees, and (iii) respond in a timely fashion to any inspection requests related to such I-9 Forms. Grantee warrants and represents it has a policy to fully cooperate in all respects with any audit, inquiry, inspection or investigation that may be conducted by the USCIS of Grantee or any of its employees. Grantee warrants and represents to Wal-Mart it has a policy to conduct an annual audit of the I-9 Forms for its employees and has a policy to promptly correct any defects or deficiencies which are identified as a result of such audit. Grantee warrants and represents it has a policy to require all subcontractors performing any work for Grantee to comply with the covenants set forth in this Section. Grantee recognizes and affirms Wal-Mart would not enter into this Agreement if Grantee did not have such policies.

7. Public Grant. Nothing contained herein shall be used or construed as a grant of any rights to any public or governmental authority or agency.

8. Duration. The agreements contained herein and the rights granted hereby shall run with the titles to Tract 2 and the Access Area and shall bind and inure to the benefit of the parties hereto and their respective heirs, successors, and assigns.

9. Change of Ownership. In the event Grantee conveys or transfers title to Tract 2 to another party, Wal-Mart shall be notified thereof within thirty (30) days thereafter. Wal-Mart shall be provided the name and address of such transferee.

10. Effective Date. This instrument shall become effective conditioned upon and subject to the conveyance of Tract 2 by Wal-Mart Stores, Inc., to Grantee to be evidenced by the recording of a deed.

11. Headings. The headings of the paragraphs contained herein are intended for reference purposes only and shall not be used to interpret the agreements contained herein or the rights granted hereby.

12. Counterparts. This document, and any modifications, may be executed in one or more counterparts, all parties need not be signatories to the same documents, and all counterpart signed documents shall be deemed to be an original and one (1) instrument.

[Signature pages follow]

IN WITNESS WHEREOF, the parties hereto have executed this instrument the day and year first above written.

WAL-MART REAL ESTATE BUSINESS TRUST

By: [Signature]
T. Latriece Watkins
Title: Director of Land Development

ATTEST:

[Signature]
NICK GOODNER
Assistant Secretary

Approved as to legal terms only
By: [Signature]
WAL-MART LEGAL DEPARTMENT
Date: 12/11/2007



TRUST ACKNOWLEDGMENT

STATE OF ARKANSAS)
) §§
COUNTY OF BENTON)

On this 13th day of December, 2007, before me, the undersigned notary public in and for said County and State, personally appeared before me T. Latriece Watkins to me personally known, who, being by me duly sworn, did say that she is Director of Land Development of Wal-Mart Real Estate Business Trust, and that the seal affixed to the foregoing instrument is the seal of said trust, and that said instrument was signed, sealed and delivered by her on behalf of said trust by authority of its Managing Trustee, and said T. Latriece Watkins acknowledged said instrument to be the free act and deed of said trust.

WITNESS MY HAND and notarial seal subscribed and affixed in said County and State, the day and year in this certificate above written.

[Signature]
Name: SARAH FAITH CHOAT
Notary Public

My Commission Expires: 2/1/2016



WITNESS OR ATTEST:

James Robinson
Notary Public

CARL KARCHER ENTERPRISES, INC.

By: William R. Werner
William R. Werner
Title: Senior Vice President

CORPORATE ACKNOWLEDGMENT

STATE OF Missouri)
City) §§
COUNTY OF St. Louis)

On this 20th day of December, 2007, before me, the undersigned notary public in and for said County and State, personally appeared before me William R. Werner to me personally known, who, being by me duly sworn, did say that he/she is Senior Vice President of Carl Karcher Enterprises, Inc. and that the seal, if any, affixed to the foregoing instrument is the corporate seal of said corporation, and that said instrument was signed, sealed and delivered by him/her on behalf of said corporation by authority of its Board of Directors, and said William R. Werner acknowledged said instrument to be the free act and deed of said corporation.

WITNESS MY HAND and notarial seal subscribed and affixed in said County and State, the day and year in this certificate above written.

Deborah A. Petersen
Name: Deborah A. Petersen
Notary Public

My Commission Expires: 6-26-2010



EXHIBIT "A"

Site Plan

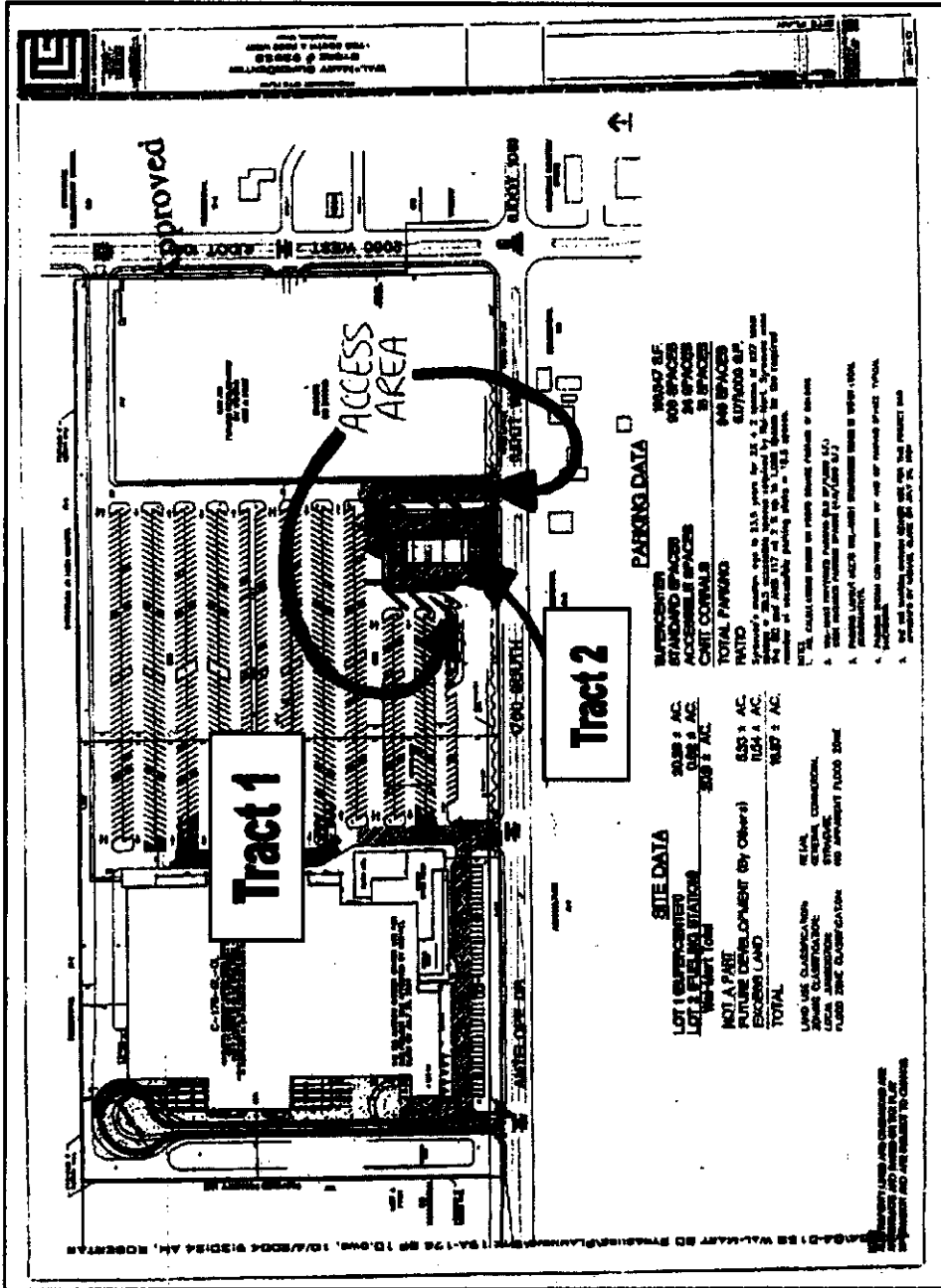

Tract 1

Tract 2

ACCESS AREA

SITE DATA		PARKING DATA	
LOT 1 (WALL-MART CENTER)	20.8 ± AC	STANDARD SPACES	1830 ± SF
LOT 2 (WALL-MART CENTER)	10.8 ± AC	ACCESSIBLE SPACES	60 ± SPACES
LOT 3 (WALL-MART CENTER)	2.0 ± AC	CHART CORNERS	24 ± SPACES
LOT 4 (WALL-MART CENTER)	2.0 ± AC	TOTAL PARKING	1854 ± SPACES
LOT 5 (WALL-MART CENTER)	2.0 ± AC		
LOT 6 (WALL-MART CENTER)	2.0 ± AC		
LOT 7 (WALL-MART CENTER)	2.0 ± AC		
LOT 8 (WALL-MART CENTER)	2.0 ± AC		
LOT 9 (WALL-MART CENTER)	2.0 ± AC		
LOT 10 (WALL-MART CENTER)	2.0 ± AC		
LOT 11 (WALL-MART CENTER)	2.0 ± AC		
LOT 12 (WALL-MART CENTER)	2.0 ± AC		
LOT 13 (WALL-MART CENTER)	2.0 ± AC		
LOT 14 (WALL-MART CENTER)	2.0 ± AC		
LOT 15 (WALL-MART CENTER)	2.0 ± AC		
LOT 16 (WALL-MART CENTER)	2.0 ± AC		
LOT 17 (WALL-MART CENTER)	2.0 ± AC		
LOT 18 (WALL-MART CENTER)	2.0 ± AC		
LOT 19 (WALL-MART CENTER)	2.0 ± AC		
LOT 20 (WALL-MART CENTER)	2.0 ± AC		
LOT 21 (WALL-MART CENTER)	2.0 ± AC		
LOT 22 (WALL-MART CENTER)	2.0 ± AC		
LOT 23 (WALL-MART CENTER)	2.0 ± AC		
LOT 24 (WALL-MART CENTER)	2.0 ± AC		
LOT 25 (WALL-MART CENTER)	2.0 ± AC		
LOT 26 (WALL-MART CENTER)	2.0 ± AC		
LOT 27 (WALL-MART CENTER)	2.0 ± AC		
LOT 28 (WALL-MART CENTER)	2.0 ± AC		
LOT 29 (WALL-MART CENTER)	2.0 ± AC		
LOT 30 (WALL-MART CENTER)	2.0 ± AC		
LOT 31 (WALL-MART CENTER)	2.0 ± AC		
LOT 32 (WALL-MART CENTER)	2.0 ± AC		
LOT 33 (WALL-MART CENTER)	2.0 ± AC		
LOT 34 (WALL-MART CENTER)	2.0 ± AC		
LOT 35 (WALL-MART CENTER)	2.0 ± AC		
LOT 36 (WALL-MART CENTER)	2.0 ± AC		
LOT 37 (WALL-MART CENTER)	2.0 ± AC		
LOT 38 (WALL-MART CENTER)	2.0 ± AC		
LOT 39 (WALL-MART CENTER)	2.0 ± AC		
LOT 40 (WALL-MART CENTER)	2.0 ± AC		
LOT 41 (WALL-MART CENTER)	2.0 ± AC		
LOT 42 (WALL-MART CENTER)	2.0 ± AC		
LOT 43 (WALL-MART CENTER)	2.0 ± AC		
LOT 44 (WALL-MART CENTER)	2.0 ± AC		
LOT 45 (WALL-MART CENTER)	2.0 ± AC		
LOT 46 (WALL-MART CENTER)	2.0 ± AC		
LOT 47 (WALL-MART CENTER)	2.0 ± AC		
LOT 48 (WALL-MART CENTER)	2.0 ± AC		
LOT 49 (WALL-MART CENTER)	2.0 ± AC		
LOT 50 (WALL-MART CENTER)	2.0 ± AC		
LOT 51 (WALL-MART CENTER)	2.0 ± AC		
LOT 52 (WALL-MART CENTER)	2.0 ± AC		
LOT 53 (WALL-MART CENTER)	2.0 ± AC		
LOT 54 (WALL-MART CENTER)	2.0 ± AC		
LOT 55 (WALL-MART CENTER)	2.0 ± AC		
LOT 56 (WALL-MART CENTER)	2.0 ± AC		
LOT 57 (WALL-MART CENTER)	2.0 ± AC		
LOT 58 (WALL-MART CENTER)	2.0 ± AC		
LOT 59 (WALL-MART CENTER)	2.0 ± AC		
LOT 60 (WALL-MART CENTER)	2.0 ± AC		
LOT 61 (WALL-MART CENTER)	2.0 ± AC		
LOT 62 (WALL-MART CENTER)	2.0 ± AC		
LOT 63 (WALL-MART CENTER)	2.0 ± AC		
LOT 64 (WALL-MART CENTER)	2.0 ± AC		
LOT 65 (WALL-MART CENTER)	2.0 ± AC		
LOT 66 (WALL-MART CENTER)	2.0 ± AC		
LOT 67 (WALL-MART CENTER)	2.0 ± AC		
LOT 68 (WALL-MART CENTER)	2.0 ± AC		
LOT 69 (WALL-MART CENTER)	2.0 ± AC		
LOT 70 (WALL-MART CENTER)	2.0 ± AC		
LOT 71 (WALL-MART CENTER)	2.0 ± AC		
LOT 72 (WALL-MART CENTER)	2.0 ± AC		
LOT 73 (WALL-MART CENTER)	2.0 ± AC		
LOT 74 (WALL-MART CENTER)	2.0 ± AC		
LOT 75 (WALL-MART CENTER)	2.0 ± AC		
LOT 76 (WALL-MART CENTER)	2.0 ± AC		
LOT 77 (WALL-MART CENTER)	2.0 ± AC		
LOT 78 (WALL-MART CENTER)	2.0 ± AC		
LOT 79 (WALL-MART CENTER)	2.0 ± AC		
LOT 80 (WALL-MART CENTER)	2.0 ± AC		
LOT 81 (WALL-MART CENTER)	2.0 ± AC		
LOT 82 (WALL-MART CENTER)	2.0 ± AC		
LOT 83 (WALL-MART CENTER)	2.0 ± AC		
LOT 84 (WALL-MART CENTER)	2.0 ± AC		
LOT 85 (WALL-MART CENTER)	2.0 ± AC		
LOT 86 (WALL-MART CENTER)	2.0 ± AC		
LOT 87 (WALL-MART CENTER)	2.0 ± AC		
LOT 88 (WALL-MART CENTER)	2.0 ± AC		
LOT 89 (WALL-MART CENTER)	2.0 ± AC		
LOT 90 (WALL-MART CENTER)	2.0 ± AC		
LOT 91 (WALL-MART CENTER)	2.0 ± AC		
LOT 92 (WALL-MART CENTER)	2.0 ± AC		
LOT 93 (WALL-MART CENTER)	2.0 ± AC		
LOT 94 (WALL-MART CENTER)	2.0 ± AC		
LOT 95 (WALL-MART CENTER)	2.0 ± AC		
LOT 96 (WALL-MART CENTER)	2.0 ± AC		
LOT 97 (WALL-MART CENTER)	2.0 ± AC		
LOT 98 (WALL-MART CENTER)	2.0 ± AC		
LOT 99 (WALL-MART CENTER)	2.0 ± AC		
LOT 100 (WALL-MART CENTER)	2.0 ± AC		

NOT A PART OF THE PROJECT. SEE THE PROJECT'S SITE PLAN FOR FURTHER INFORMATION.

EXHIBIT "B"

Tract 2

Parcel 1:

Lot 2, Syracuse Wal-Mart Subdivision, according to the official plat thereof, recorded in the office of the Davis County Recorder.

EXHIBIT "C"

Access Area

A part of Lot 1, Syracuse Wal-Mart Subdivision lying within the Southeast Corner of Section 6, Township 4 North, Range 2 West, Salt Lake Base and Meridian, U.S. Survey in Syracuse, Davis County, Utah:

Beginning at the Southwest Corner of Lot 2 of said subdivision located 35.50 feet North 0°30'16" East along the Quarter Section Line and 1927.27 feet South 89°11'12" East from the South Quarter Corner of said Section 6; and running thence North 89°11'12" West 38.00 feet along the Southerly Line of said Lot 1; thence North 0°20'41" East 252.30 feet; thence South 89°39'19" East 235.00 feet to the Easterly Line of said Lot 1; thence South 0°20'41" West 254.23 feet along said Easterly Line to the Northerly Line of Antelope Drive; thence North 89°11'12" West 46.00 feet along said Northerly Line to the Southeast Corner of said Lot 2; thence along the boundaries of the Lot Lines common to said Lots 1 and 2 the following three courses: North 0°20'41" East 203.85 feet; North 89°39'19" West 151.00 feet; and South 0°20'41" West 202.61 feet to the point of beginning.

Contains 28,829 sq. ft.