

WHEN RECORDED, MAIL TO:

Salt Lake County
2001 South State Street
Salt Lake City, Utah 84190

7652671
06/05/2000 09:00 AM NO FEE
NANCY WORKMAN
RECORDER, SALT LAKE COUNTY, UTAH
SL CO. COMMISSION CLERK
BY: RDJ, DEPUTY - WI 16 P.

7652671

EASEMENT
(LIMITED LIABILITY COMPANY)
Salt Lake County

Parcel No. 20:CE
Project No. CJ 970180

WALLNET INVESTMENTS, L.C., a Utah limited liability company, Grantor, for a good and valuable consideration, the receipt and sufficiency of which is hereby acknowledged, hereby CONVEYS and DEDICATES unto SALT LAKE COUNTY, a body politic of the State of Utah, Grantee, a permanent easement for a public highway (the "Roadway") and all incidental purposes (including, but not limited to, that of allowing utility, sewer and drainage facilities to be located, serviced, repaired and maintained within the perimeters of the dedicated easement area) on, under, over and across certain property (such property being referred to herein as the "Easement Property"), in the Southeast quarter of the Northwest quarter of Section 23, Township 2 South, Range 1 East of the Salt Lake Base and Meridian, in Salt Lake County, Utah, as more fully described on Exhibit "A" attached hereto.

The Roadway and appurtenant facilities on the Easement Property, excluding curb, gutter and any sidewalk hereafter constructed on the Easement Property, are hereinafter sometimes collectively referred to as the "Facilities". Grantee shall construct and maintain the Roadway in accordance with the specifications set forth on Exhibit "B" attached. The above Easement Property contains 17,163 square feet in area or 0.394 acre.

TO HAVE AND TO HOLD the above-described rights and easements, together with all rights reasonably necessary in connection with the construction, maintenance and repair of the Facilities over the right-of-way and easement on the Easement Property hereby granted unto Grantee. Notwithstanding the construction by Grantee of the curb, gutter and any sidewalk, the Grantee shall not be required to hereafter maintain the curb, gutter or any sidewalk. Grantee agrees to indemnify, defend and hold Grantor, and its successors and assigns, harmless from and against any and all claims, costs, damages, liabilities or losses resulting from or relating to the entry, construction and maintenance of the Facilities by the Grantee, its agents or representatives. Without limiting the foregoing, Grantee hereby assumes all liability and responsibility between Grantor and Grantee and, as may be applicable, to third parties relating to the location, construction, supervision, maintenance, condition and repair of the Roadway and Facilities, or in any way arising from any environmental contamination or defect caused by Grantee or a third party from and after the date this document is executed which may occur or be permitted to exist on the Roadway or in connection with the rights-of-way and easements hereby granted. By agreeing to indemnify Grantor, Grantee does not

BK8366PG0173

waive its right to raise any defense available to it with respect to the claims of third parties under the Utah Governmental Immunity Act (the "Act"); provided, however, that Grantor and Grantee acknowledge and agree that the Act shall not serve to limit the indemnification obligations of Grantee to Grantor hereunder.

Grantor reserves and is hereby granted the right, at Grantor's expense and in compliance with Salt Lake County Ordinances, to construct, service, repair and maintain utility pipelines, sewer and associated facilities in the Roadway and as it extends from the West side of 3000 East Street intersection to the point of connection for such facilities.

IN WITNESS WHEREOF, said Grantor has caused this instrument to be executed by its proper officers thereunto duly authorized, this 31st day of March,

1999.
2000

WALLNET INVESTMENTS, L.C., a Utah limited liability company

By: [Signature]
Lary J Mielke
Title: Manager of Cottonwood Corporate Center, L.L.C
Manager of Wallnet Investment, L.C.

APPROVED AS TO FORM

By: [Signature]
Date: 5/5/00

SALT LAKE COUNTY, a body politic of the State of Utah

By: [Signature]
Title: Acting Chair
MARY CALLAGHAN
ACTING CHAIR, BOARD OF COUNTY COMMISSIONERS

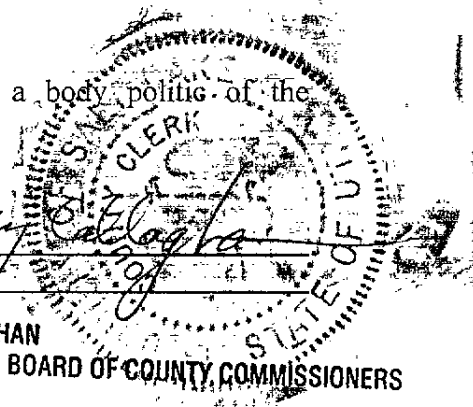

STATE OF UTAH)
 : ss.
COUNTY OF SALT LAKE)

On the date first above written personally appeared before me, Lary J. Mielke, who, being by me duly sworn, says that he is the Manager of COTTONWOOD CORPORATE CENTER, L.L.C., manager of WALLNET INVESTMENTS, L.C., a Utah limited liability company, and that the within and foregoing instrument was signed in behalf of said company by authority of its Articles of Organization, and said Lary J. Mielke acknowledged to me that said company executed the same.

WITNESS my hand and official stamp the date in this certificate first above written.

Janet G. Vise
NOTARY PUBLIC
Residing at Salt Lake County, Utah

My Commission Expires:
8/3/02

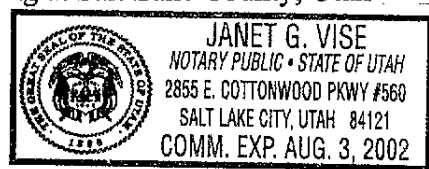

STATE OF UTAH)
 : ss.
COUNTY OF SALT LAKE)

On the date first above written personally appeared before me, Mary Callaghan, who, being by me duly sworn, says that she is the Acting Chair of SALT LAKE COUNTY, a body politic of the State of Utah, and that the within and foregoing instrument was signed in behalf of said company by authority of its Articles of Organization, and said Mary Callaghan acknowledged to me that said company executed the same.

WITNESS my hand and official stamp the date in this certificate first above written.

Linda Hiatt
NOTARY PUBLIC
Residing at Salt Lake County, Utah

My Commission Expires:
2/5/03



BK8366PG0175

EXHIBIT "A"

PROPERTY DESCRIPTION

Beginning at the Northeast corner of said entire tract, which point is 2270.98 feet South $89^{\circ}47'55''$ East and 2767.54 feet North, and 711.21 feet North $12^{\circ}27'20''$ East from the Southwest corner of said Section 23; and running thence North $89^{\circ}02'01''$ West 5.86 feet along the Northerly boundary line of said entire tract; thence Southwesterly 38.37 feet along the arc of a 29.00 foot radius curve to the right (Note: Chord to said curve bears South $64^{\circ}38'56''$ West for a distance of 35.63 feet) to a point 29.50 feet perpendicularly distant Northerly from the control line of the construction of an access road known as the "A" Line of said project at "A" Line Engineer Station 9+25.94A; thence the following three (3) courses along a line parallel to said "A" Line control line: (1) North $77^{\circ}33'41''$ West 4.76 feet; thence (2) Northwesterly 66.71 feet along the arc of a 829.50 foot radius curve to the left (Note: Chord to said curve bears North $79^{\circ}51'55''$ West for a distance of 66.69 feet); thence (3) North $82^{\circ}10'08''$ West 12.85 feet; thence North $85^{\circ}58'58''$ West 40.00 feet to the Northerly boundary line of said entire tract at a point 26.84 feet perpendicularly distant Northerly from said "A" Line control line at "A" Line Engineer Station 8+04.08A; thence North $89^{\circ}02'01''$ West 173.42 feet along said Northerly boundary line to a point 23.50 feet radially distant Southwesterly from said "A" Line control line at "A" Line Engineer Station 6+44.84A; thence Southeasterly 47.19 feet along the arc of a 130.00 foot radius curve to the left (Note: Chord to said curve bears South $45^{\circ}00'59''$ East for a distance of 46.93 feet); thence the following two (2) courses along a line parallel to said "A" Line control line: (1) Southeasterly 52.51 feet along the arc of a 132.50 foot radius curve to the left (Note: Chord to said curve bears South $70^{\circ}48'57''$ East for a distance of 52.17 feet); thence (2) South $82^{\circ}10'08''$ East 33.54 feet; thence South $84^{\circ}04'41''$ East 90.05 feet to a point 29.50 feet perpendicularly distant Southerly from said "A" Line control line at "A" Line Engineer Station 8+44.00A; thence the following three (3) courses along a line parallel to said "A" Line control line: (1) South $82^{\circ}10'08''$ East 12.85 feet; thence (2) Southeasterly 61.96 feet along the arc of a 770.50 foot radius curve to the right (Note: Chord to said curve bears South $79^{\circ}51'55''$ East for a distance of 61.94 feet); thence (3) South $77^{\circ}33'41''$ East 2.70 feet; thence Southeasterly 47.92 feet along the arc of a 29.00 foot radius curve to the right (Note: Chord to said curve bears South $34^{\circ}38'04''$ East for a distance of 42.65 feet) to a point 58.55 feet perpendicularly distant Southerly from said "A" Line control line at "A" Line Engineer Station 9+55.11A; thence South $77^{\circ}35'43''$ East 5.08 feet to the Easterly boundary line of said entire tract; thence North $12^{\circ}27'20''$ East 110.55 feet along said Easterly boundary line to the point of beginning.

BK8366P60176

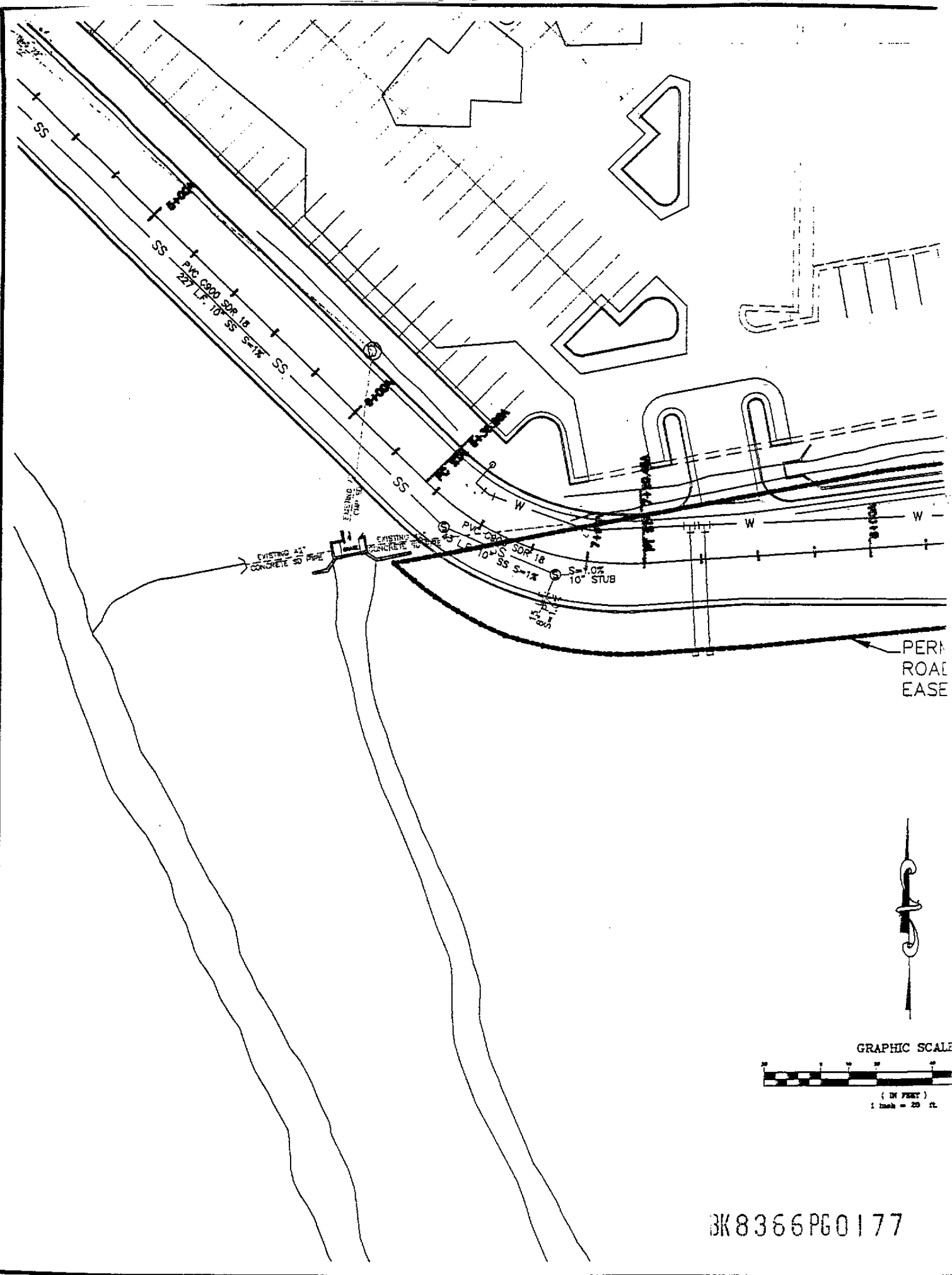

PERM
ROAD
EASE

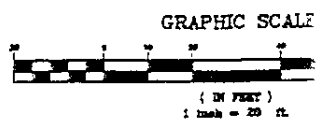

BK 8366 PG 0177

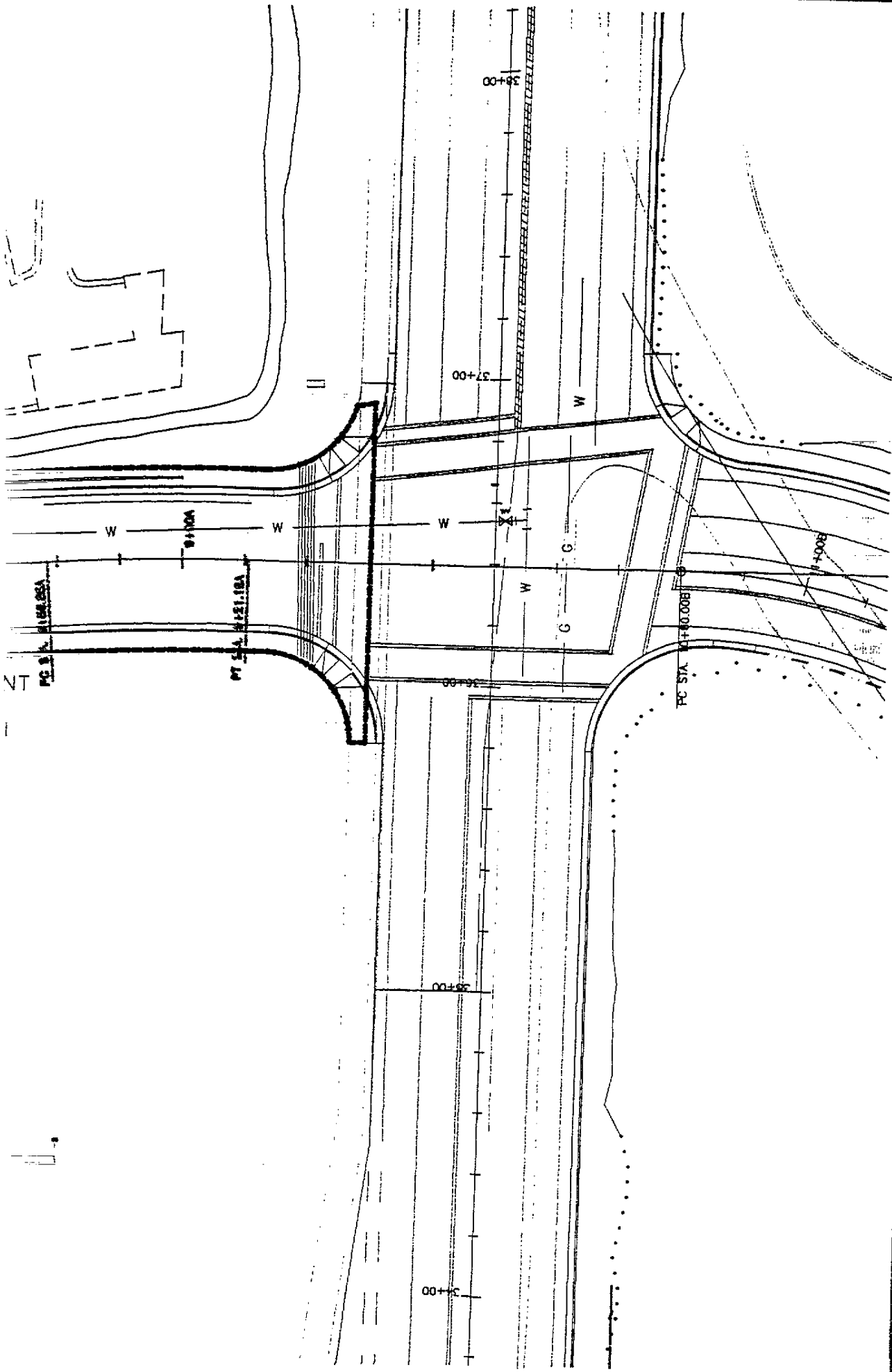

DATE 08-18-99
 PLAN NO. 08-18-99
 SCALE 1" = 20'
 DRAWN BY SCOTT D. SCOTT
 PROJECT NO. SC010109

PERMANENT ROADWAY EASEMENT
 SALT LAKE COUNTY UTAH

P S O M A S

2825 East Colterwood Parkway, Suite 120
 Salt Lake City, Utah 84121
 (801) 270-5777 (801) 270-5782 (FAX)

JUR	JUR	S/A
DATE	DATE	DATE

4 2

3K8365 PG 0178

8/18/99

UTILITY IMPROVE 3000 EAST - WES "A-LI, SALT LAKE COUNT

GENERAL NOTES

1. THIS IMPROVEMENT CONSISTS OF WORK CALLED FOR ON THIS PLAN ONLY.
2. THE CONTRACTOR SHALL FAMILIARIZE HIM/HERSELF WITH THE PLANS, THE SOILS AND/OR GEOLOGY REPORTS, AND THE SITE CONDITIONS PRIOR TO COMMENCING WORK.
3. EXISTING UTILITIES:
THE EXISTENCE, LOCATION, AND CHARACTERISTICS OF ALL UNDERGROUND UTILITIES AND STRUCTURES SHOWN ON THESE PLANS HAVE BEEN OBTAINED FROM A REVIEW OF AVAILABLE RECORD DATA. NO REPRESENTATION IS MADE AS TO THE ACCURACY OR COMPLETENESS OF SAID UTILITY INFORMATION. THE CONTRACTOR SHALL TAKE DUE PRECAUTIONARY MEASURES TO PROTECT THE FACILITIES SHOWN AND ANY OTHER FACILITIES NOT OF RECORD OR NOT SHOWN ON THESE PLANS.
CONTRACTOR SHALL CALL BLUE STAKES AT 532-5000 TWO WORKING DAYS PRIOR TO DIGGING. PRIOR TO COMMENCING CONSTRUCTION, THE CONTRACTOR SHALL UNCOVER AND VERIFY THE LOCATION AND ELEVATION OF ALL EXISTING UTILITIES TO BE JOINED, CROSSED, OR PARALLELED. ANY CONFLICT OR DISCREPANCY SHALL BE BROUGHT TO THE ATTENTION OF THE ENGINEER PRIOR TO CONSTRUCTION. OTHERWISE, CONTRACTOR ASSUMES SOLE AND COMPLETE RESPONSIBILITY FOR ANY COSTS OF REPLACEMENT, RELOCATION, OR ADDITIONAL COSTS OF CONSTRUCTION.
4. THE CONTRACTOR SHALL ASSUME SOLE AND COMPLETE RESPONSIBILITY FOR THE JOB SITE CONDITIONS, INCLUDING SAFETY OF ALL PERSONS AND PROPERTY, DURING THE COURSE OF CONSTRUCTION OF THIS PROJECT. THIS REQUIREMENT SHALL APPLY CONTINUOUSLY AND SHALL NOT BE LIMITED TO NORMAL WORKING HOURS. THE CONTRACTOR SHALL DEFEND, INDEMNIFY AND HOLD THE OWNER AND THE ENGINEER HARMLESS FROM ANY AND ALL LIABILITY, REAL OR ALLEGED, IN CONNECTION WITH PERFORMANCE OF WORK ON THIS PROJECT.
5. SHOULD CONFLICTING INFORMATION BE FOUND ON THE PLANS, THE CONTRACTOR SHALL NOTIFY THE PROJECT ENGINEER AT PSCOMAS BEFORE PROCEEDING WITH THE WORK IN QUESTION.
6. CONTRACTOR TO FIELD VERIFY LOCATION OF ALL EXISTING UTILITIES PRIOR TO CONSTRUCTION.
7. CONTRACTOR TO NOTIFY PSCOMAS 72 HOURS PRIOR TO NEED FOR ANY CONSTRUCTION STAKING.
8. CONTRACTOR TO NOTIFY THE FOLLOWING 48 HOURS PRIOR TO CONSTRUCTION:
THE SALT LAKE CITY DEPARTMENT OF PUBLIC UTILITIES @ 483-6781 TO SCHEDULE INSPECTION OF PROJECT.
THE PUBLIC SERVICES ENGINEER @ 535-8899.
THE SALT LAKE CITY SUBURBAN SANITARY DISTRICT NO. 1 @ 282-2904.
9. CONTRACTOR TO DISTRIBUTE APPROVED WRITTEN NOTICE OF CONSTRUCTION TO ALL RESIDENTS LOCATED IN THE CONSTRUCTION AREA AT LEAST 24 HOURS PRIOR TO CONSTRUCTION. WRITTEN NOTICE SHALL BE APPROVED BY THE SALT LAKE CITY DEPARTMENT OF PUBLIC UTILITIES PROJECT ENGINEER.
10. CONTRACTOR TO OBTAIN ALL NECESSARY PERMIT(S) AND COMPLY WITH ALL REQUIREMENTS.
11. CONTRACTOR TO PROVIDE PROCTOR AND/OR MARSHALL TEST DATA 24 HOURS PRIOR TO USE, CERTIFIED IN WRITING FROM A LAB RECOGNIZED AND ACCEPTED BY SALT LAKE (CITY PUBLIC SERVICES) (COUNTY PUBLIC WORKS).
12. THE CONTRACTOR SHALL FURNISH AND PLACE PERMANENT ASPHALT PER SALT LAKE (CITY STANDARD PLAN SR-02-01) (COUNTY STANDARDS). THE CONTRACTOR TO GUARANTEE THE ASPHALT RESTORATION FOR A PERIOD OF TWO YEARS.
13. IF THE CONTRACTOR CHOOSES TO WORK ON THE PROJECT WHEN HOT MIX ASPHALT IS NOT AVAILABLE, THE CONTRACTOR SHALL BE RESPONSIBLE FOR OBTAINING APPROVAL FROM THE APPROPRIATE GOVERNING AGENCY. THE CONTRACTOR SHALL FURNISH AND INSTALL TEMPORARY ASPHALT SURFACING MATERIAL. WHEN PERMANENT ASPHALT BECOMES AVAILABLE, THE CONTRACTOR WILL REMOVE THE TEMPORARY ASPHALT, FURNISH AND INSTALL THE PERMANENT ASPHALT AT NO ADDITIONAL COST TO THE OWNER.
14. TRAFFIC CONTROL TO CONFORM TO THE MOST CURRENT EDITION OF THE (SALT LAKE CITY TRAFFIC BARRICADE MANUAL) (PART 6 OF "MANUAL ON UNIFORM TRAFFIC CONTROL DEVICES" FOR SALT LAKE COUNTY AND STATE ROADS).
15. THE CONTRACTOR WILL VERIFY DEPTHS OF ALL UTILITIES IN THE FIELD BY POT HOLEING A MINIMUM OF 300 FEET AHEAD OF PIPELINE CONSTRUCTION TO AVOID CONFLICTS WITH DESIGNED PIPELINE GRADE AND ALIGNMENT. IF A CONFLICT ARISES RESULTING FROM THE CONTRACTOR NEGLECTING TO POT HOLE UTILITIES, THE CONTRACTOR WILL BE REQUIRED TO RESOLVE THE CONFLICT WITHOUT ADDITIONAL COST OR CLAIM TO THE OWNER OR ENGINEER.
16. CONTRACTOR TO NOTIFY UTILITY COMPANIES TWO (2) WEEKS IN ADVANCE OF UTILITY CONFLICTS REQUIRING RELOCATION OF MAINLINES, ONE (1) WEEK IN ADVANCE OF CONFLICTS REQUIRING RELOCATION OF SERVICE LATERALS.
17. ALL CONSTRUCTION WILL CONFORM WITH UTAH PUBLIC WORKS STANDARD SPECIFICATIONS FOR CONSTRUCTION (1991 EDITION), GENERAL CONDITIONS IN THE PROJECT MANUAL, AND STANDARD PLANS FOR PUBLIC FACILITIES CONSTRUCTION, SALT LAKE CITY CORPORATION (MARCH 1993 EDITION).
A. AMEND THE ABOVE DOCUMENTS AS FOLLOWS:
STANDARD PLAN PB-02-01 - DELETE NOTE 5 IN ITS ENTIRETY.
STANDARD PLAN PB-02-01 - IF INSTALLING FLEXIBLE PIPE, CHANGE NOTE 1 TO READ "PLACE GRADED GRANULAR BACKFILL (MAXIMUM 3/4" SIZE) IN PIPE ZONE AT OPTIMUM MOISTURE IN HORIZONTAL 8" THICK LIFTS. COMPACT TO 96% ASTM D698 DRY DENSITY WITH NO DENSITY TEST LESS THAN 92%".
STANDARD PLAN PB-02-01 - AMEND EXISTING PIPE I.D. TABLE TO READ - "LESS THAN 21" WIDTH TO BE O.D. + 2".
(STANDARD PLAN PB-02-02 - DELETE NOTE 3 IN ITS ENTIRETY).
18. USE CLASS B PIPE ZONE BACKFILL PER SALT LAKE CITY STANDARD PLAN PB-02-01 FOR BACKFILL ON ALL PUBLIC UTILITIES TRENCHES.
19. ALL ELEVATIONS ARE U.S.G.C. DATUM.
20. CONTRACTOR TO INSTALL INVERT COVERS IN ALL CEMEX MANHOLES IN THE PROJECT AREA.
21. NO GROUNDWATER OR DEBRIS TO BE ALLOWED TO ENTER THE NEW PIPE DURING CONSTRUCTION. THE OPEN END OF ALL PIPE TO BE COVERED AND EFFECTIVELY SEALED AT THE END OF EACH DAY'S WORK.

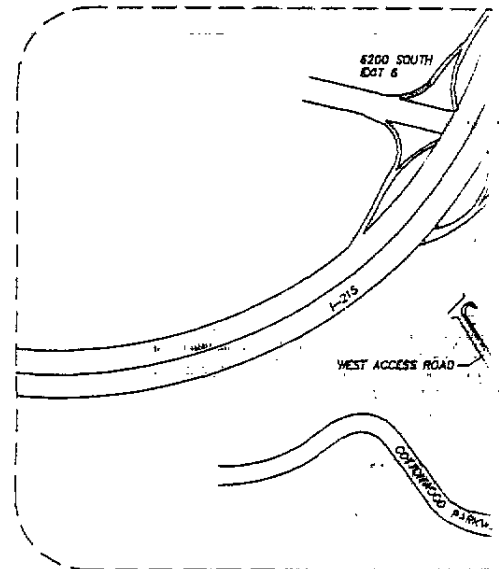

INDEX OF DRAWING

SHEET NUMBER	DESCRIPTION
1	TITLE SHEET
2	PLAN AND PROFILE
3	PLAN AND PROFILE
4	DETAIL SHEET

BK 8366PG0179

UTILITY PLANS ACCESS ROAD

UTAH

ABBREVIATIONS

AT	AT
AB	AGGREGATE BASE
AC	ASPHALT CONCRETE
CL	CENTER LINE
EL	ELEVATION
FL	FLOW LINE
G	GAS
I	INTERSTATE
IN	PIPE INVERT DRAINING INTO MANHOLE
INV	INVERT
LF	LINEAR FEET
MIN	MINIMUM DISTANCE
OUT	PIPE INVERT DRAINING FROM MANHOLE
P	POWER
PVC	POLY-VINYL CHLORIDE PIPE
R	RADIUS
RCP	REINFORCED CONCRETE PIPE
RIM	TOP MANHOLE LID ELEVATION
R/W	RIGHT OF WAY
SD	STORM DRAIN
SDR	STANDARD DIMENSIONAL RATIO
SSMH	SEWER MANHOLE
SS	SANITARY SEWER
STA	STATION
W	WATER
W/	WITH

SYMBOL LEGEND



DETAIL 2 ON SHEET 4



DETAIL SHEET W-5 SLC STANDARDS AND SPECIFICATIONS

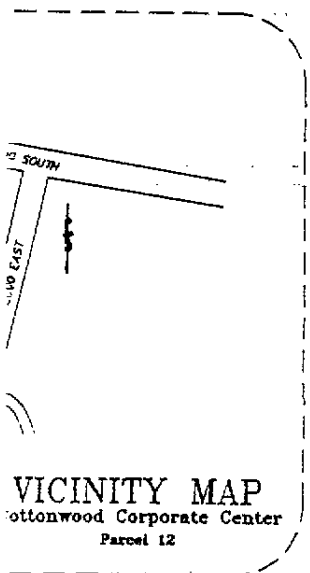

DATE	08-18-99
PLAT DATE	08-18-99
SCALE	NO SCALE
PROJECT	8C010109

UTILITY IMPROVEMENTS - WEST ACCESS ROAD
TITLE SHEET
SALT LAKE COUNTY UTAH

PSOMAS
2815 East Cottonwood Parkway, Suite 120
Salt Lake City, Utah 84121
(801) 770-5177 (901) 270-5782 (FAX)

ISSUE		
No.	Date	Description
1	108-18-99	BID SET

DESIGNED	JUR
DRAWN	JUR
CHECKED	SJA
1	
4	

318366P60180

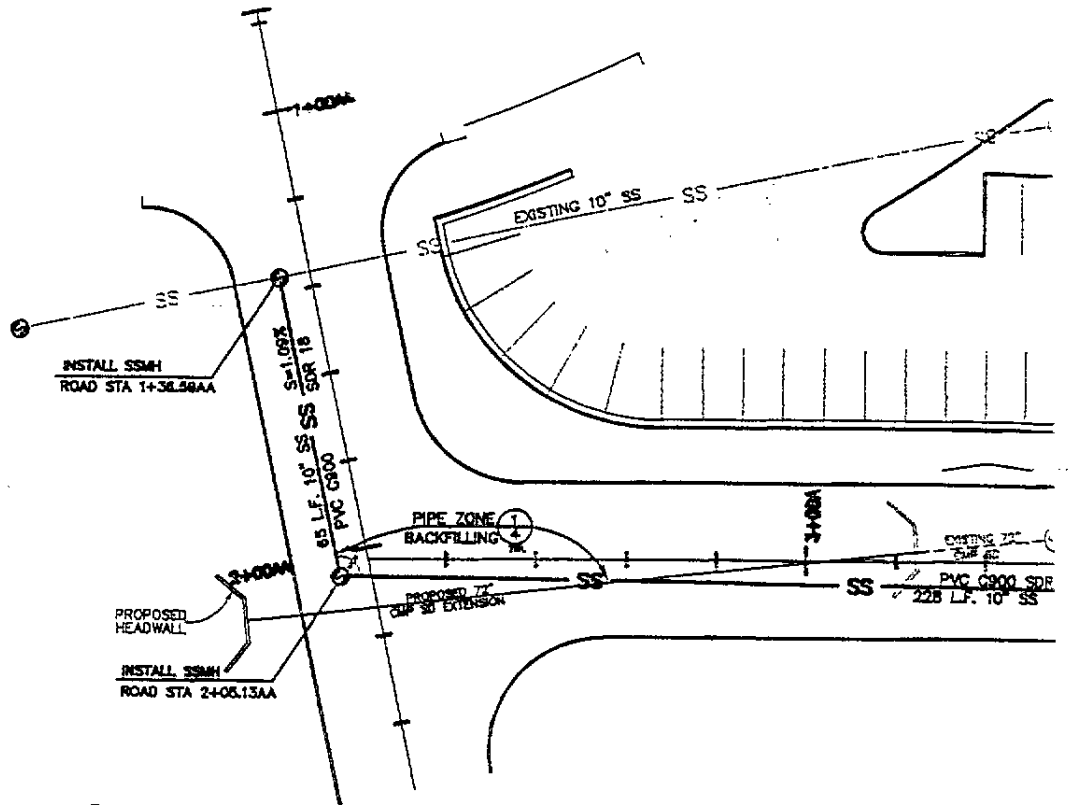

GRAPHIC SCALE



(IN FEET)
1 inch = 20 ft.

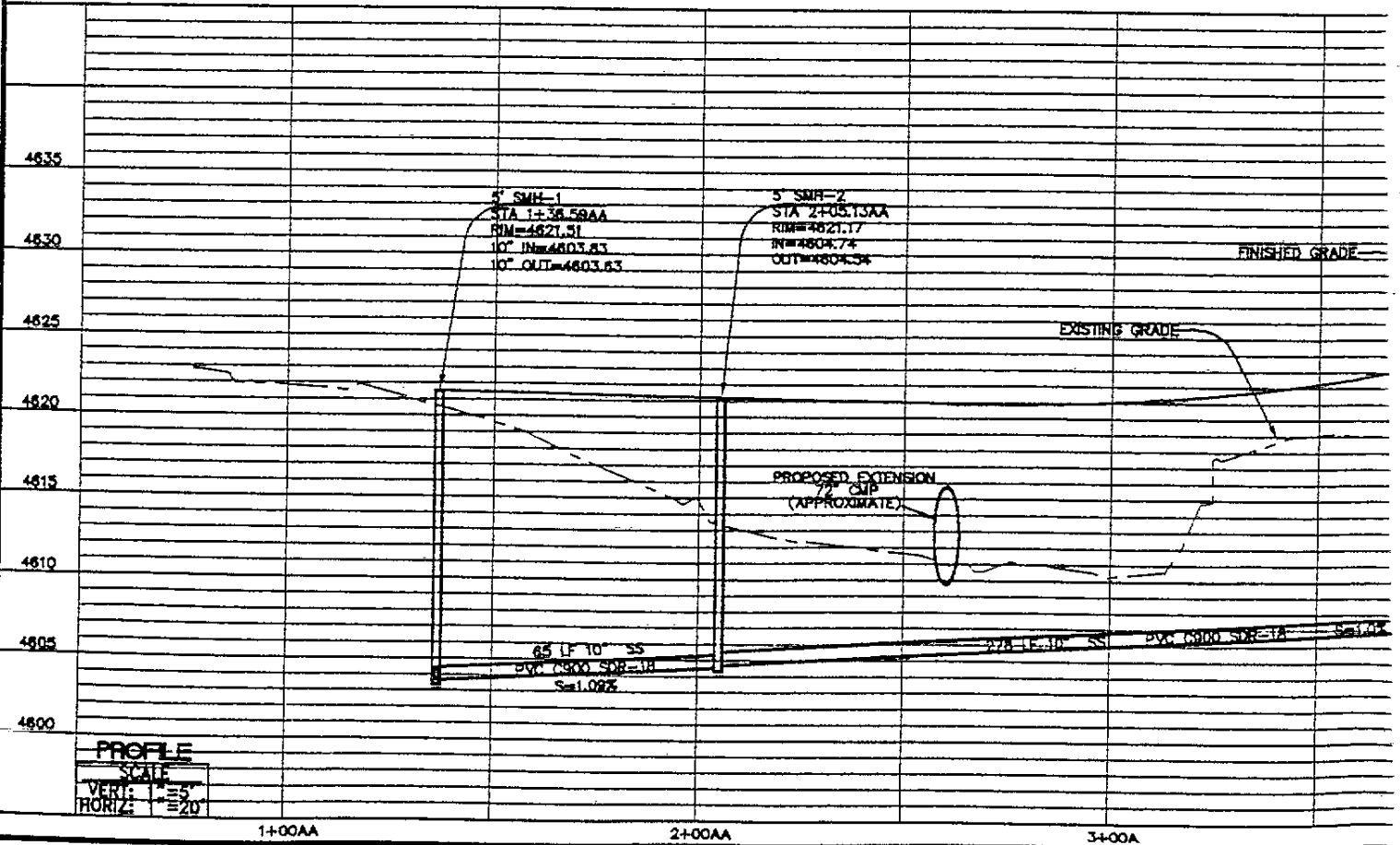

PROFILE
 SCALE
 VERT: 1" = 5'
 HORIZ: 1" = 20'

1+00AA

2+00AA

3+00AA



DATE 08-18-99
 PLAN NO. 08-18-99
 SCALE 1" = 20'
 DRAWN BY
 CHECKED BY
 PROJECT NO. 80010109

UTILITY IMPROVEMENTS - WEST ACCESS ROAD
 UTILITY PLAN & PROFILE STA 1+000A TO 6+00A
 SALT LAKE COUNTY UTAH

P S O M A S
 2825 East Cottonwood Parkway, Suite 120
 Salt Lake City, Utah 84121
 (801) 270-5777 (801) 270-5782 (FAX)

JAR
 JAR
 JAS
 2
 4

JK8366PG0182

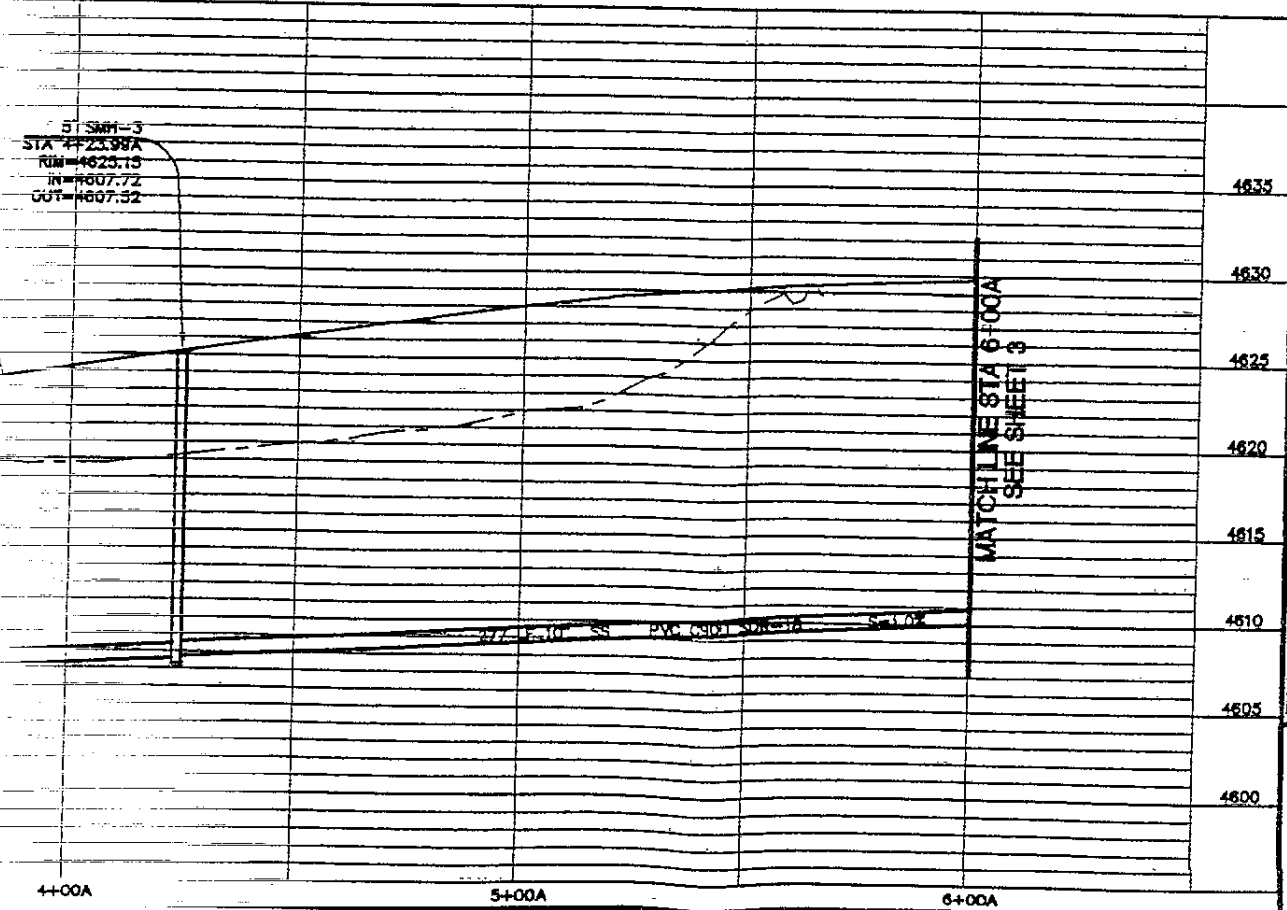
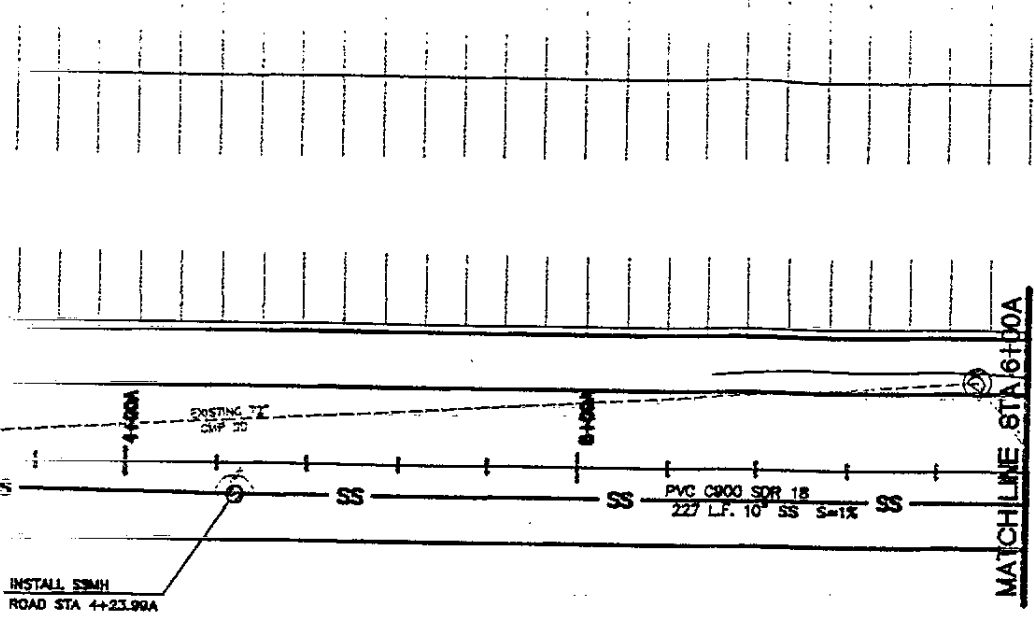

4+00A 5+00A 6+00A

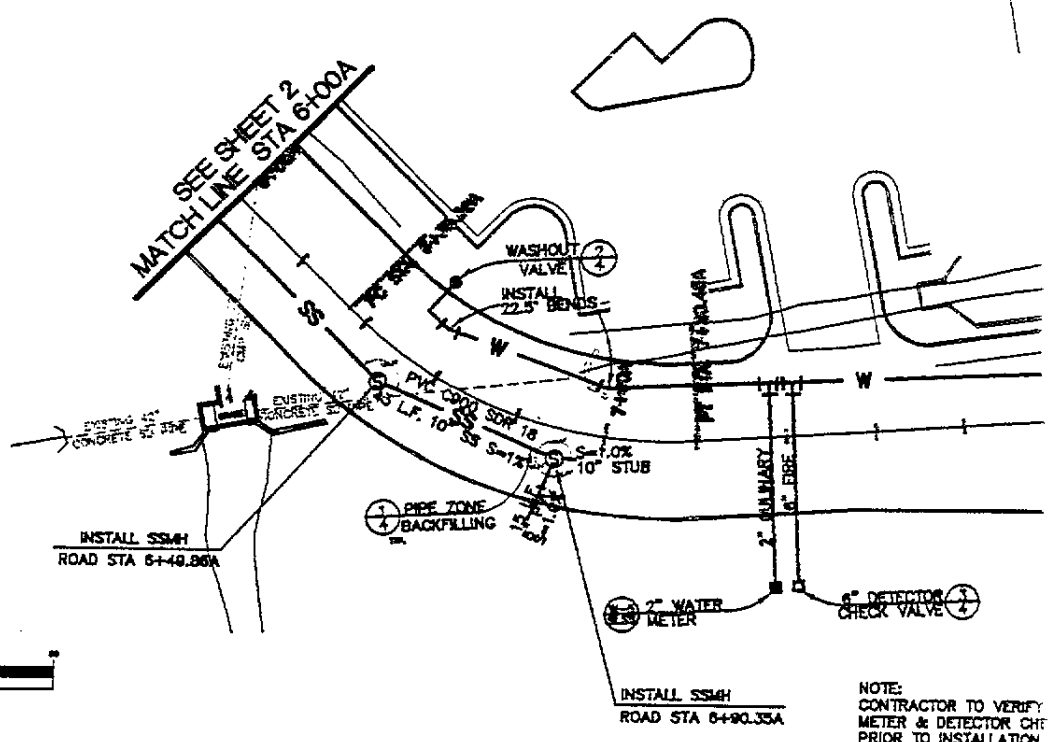

GRAPHIC SCALE

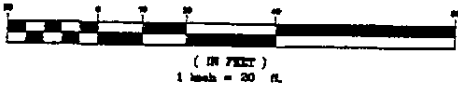

NOTE:
CONTRACTOR TO VERIFY
METER & DETECTOR CHG
PRIOR TO INSTALLATION

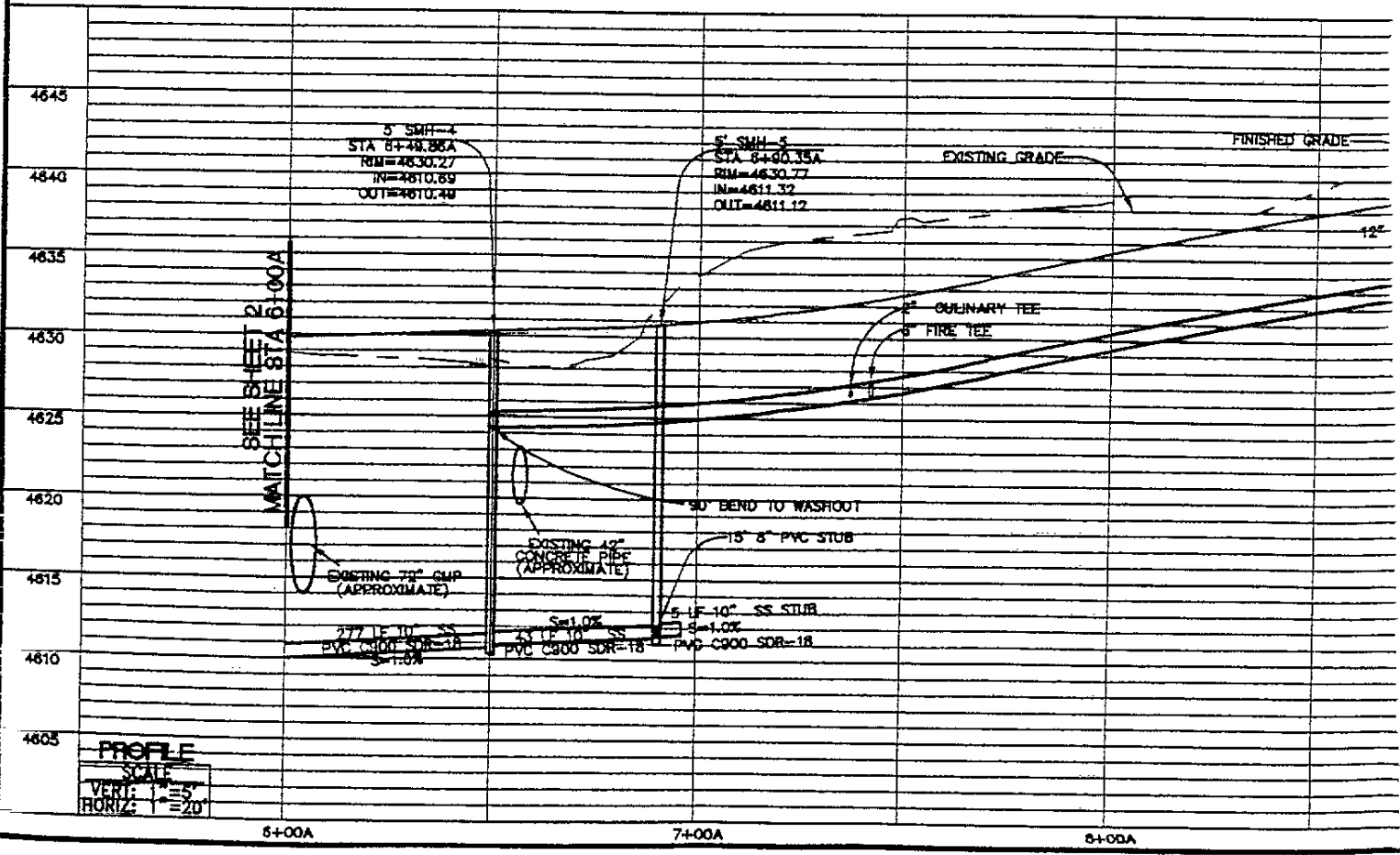

PROFILE SCALE
VERT. 1" = 5'
HORIZ. 1" = 20'

6+00A

7+00A

8+00A



DATE: 08-18-99
 PLAN NO.: 08-18-99
 SCALE: 1" = 20'
 PROJECT: 8C010109

UTILITY IMPROVEMENTS - WEST ACCESS ROAD
 UTILITY PLAN & PROFILE STA 6+00A TO 10+50A
 SALT LAKE COUNTY UTAH

PSOMAS

2825 East Cottonwood Parkway, Suite 120
 Salt Lake City, Utah 84121
 (801) 270-5177 (801) 270-5782 (FAX)

BK 8366F60184

BK 8366F60184

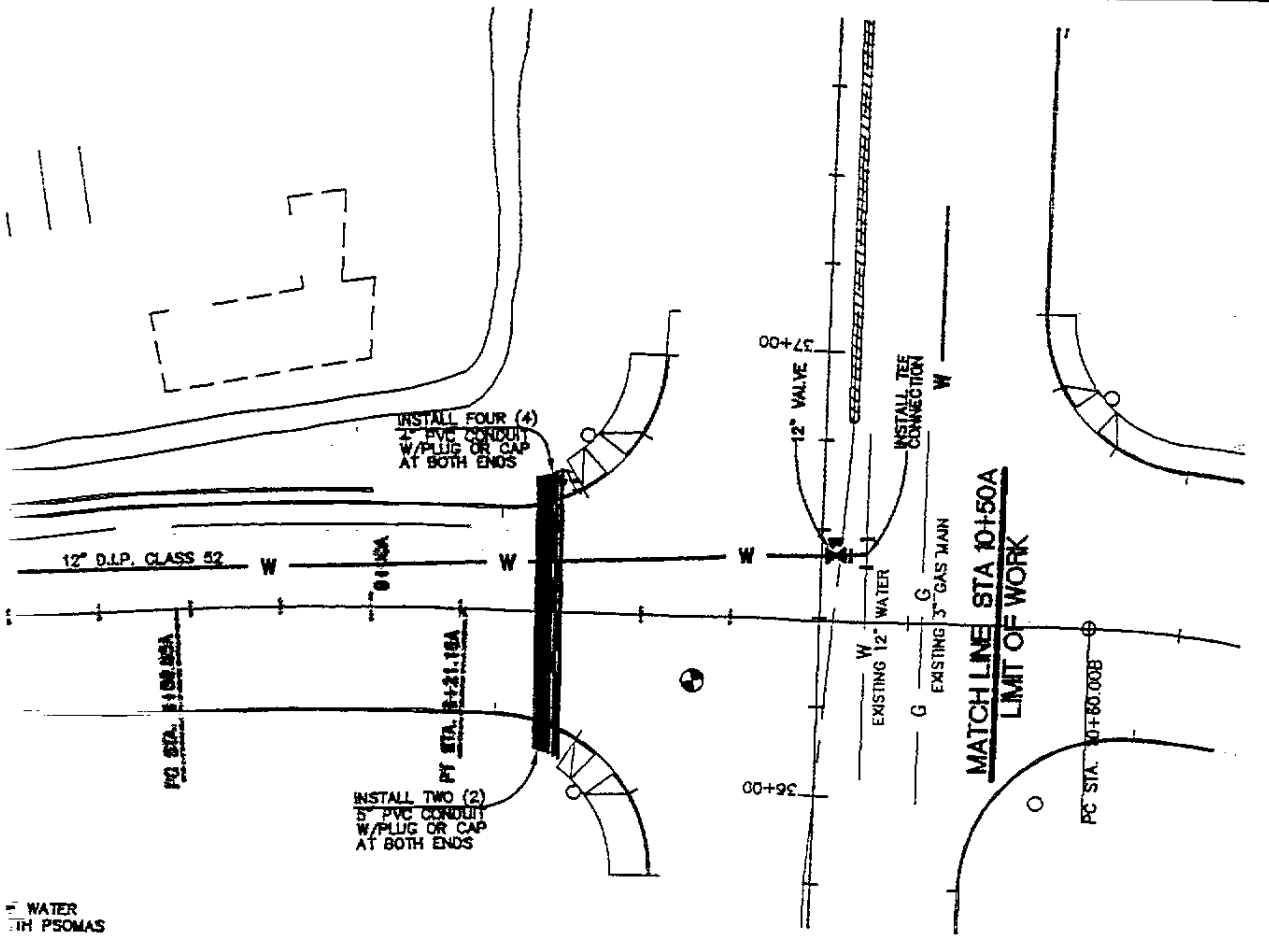

WATER
 PSOMAS

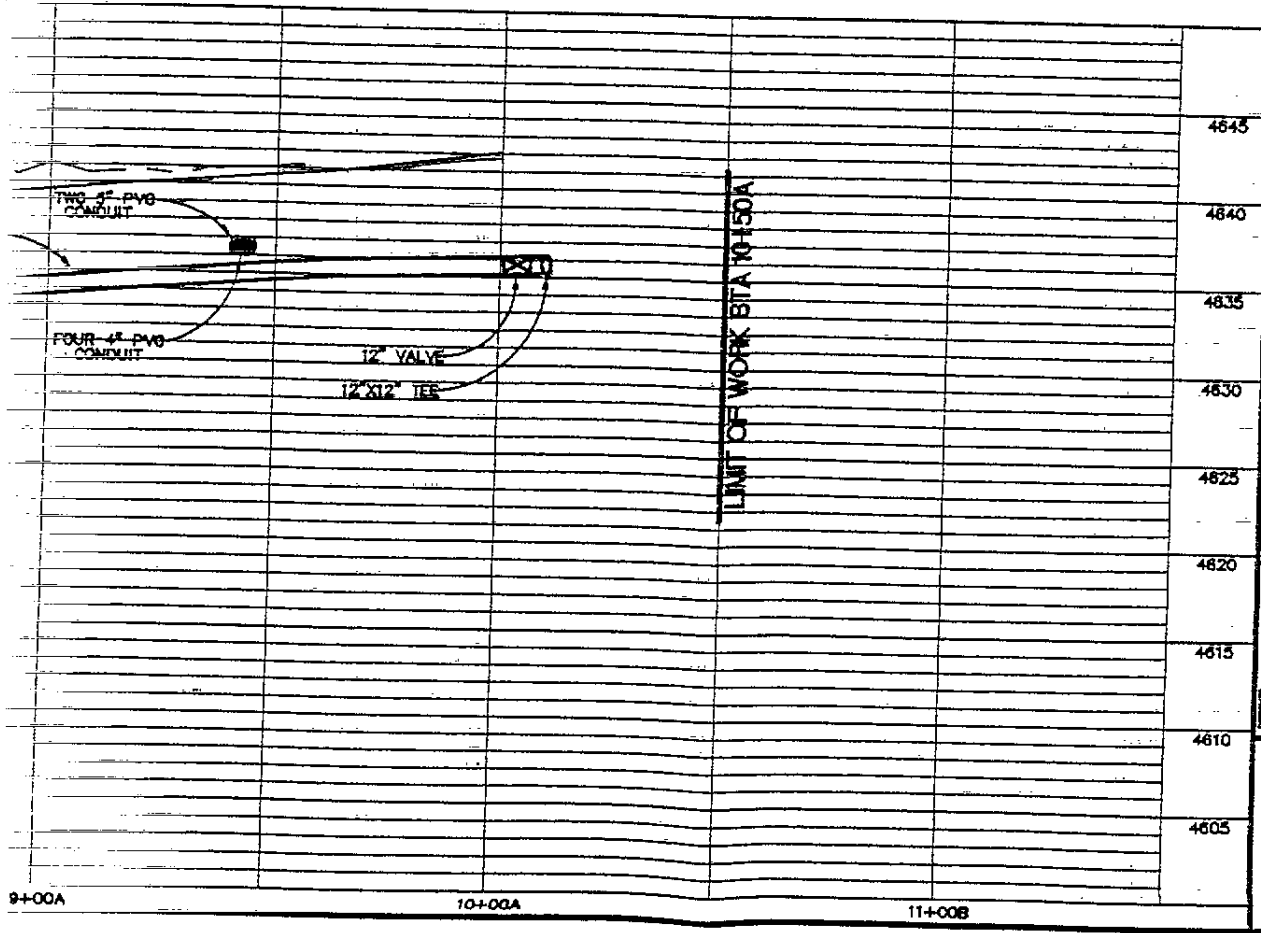

JUR
 JUN
 S/A

1
 3
 4

MINIMUM WIDTH OF TRENCH MEASURED AT THE SPRINGLINE OF THE PIPE, INCLUDING ANY NECESSARY SHEATHING:

PIPE I.D.	WIDTH
LESS THAN 21"	O.D. + 12"
21" TO 44"	O.D. + 24"
GREATER THAN 44"	O.D. + 30"

I.D. MEANS INSIDE DIAMETER OF PIPE BARREL
O.D. MEANS OUTSIDE DIAMETER OF PIPE BARREL

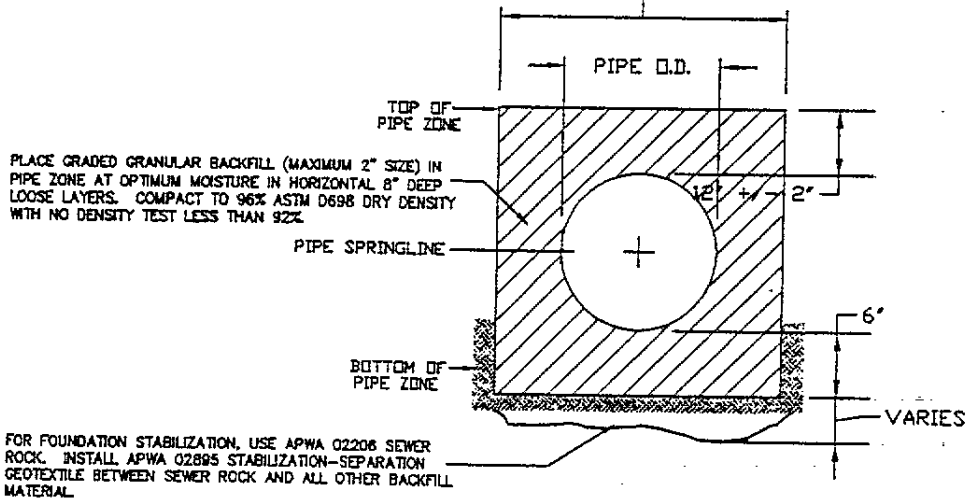

① PIPE ZONE BACKFILLING (CLASS B)

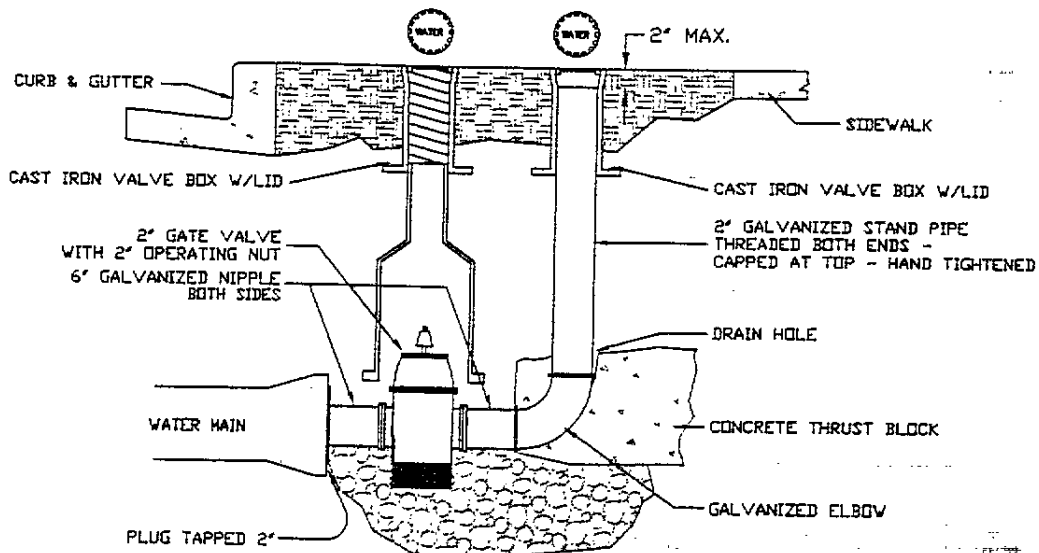

② WASHOUT VALVE

BK 8366 PG 185



DATE 08-18-99
 PLAN DATE 08-18-99
 SCALE NO SCALE
 DRAWING NO BCO10109

UTILITY IMPROVEMENTS - WEST ACCESS ROAD
 DETAIL SHEET
 SALT LAKE COUNTY UTAH

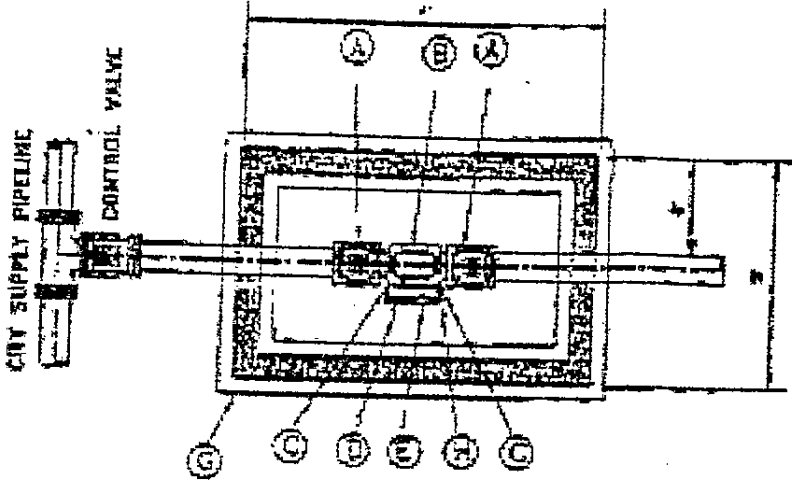

SET RING & BOX
 1/2" BELOW FINISH GRADE.

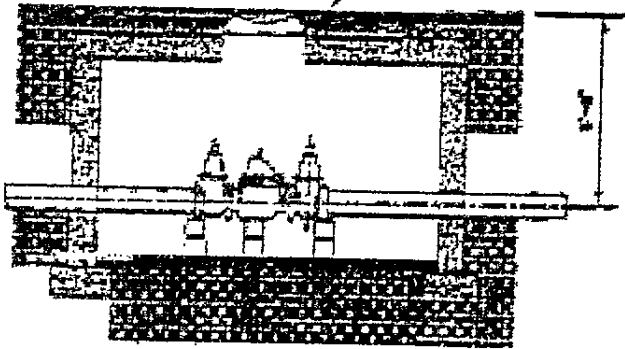

ALL WORK MUST BE PROVIDED BY THE SALT LAKE CITY
 PERMANENT UTILITY DEPARTMENT WITH THE EXCEPTED
 ALL UNDESIGNATED MATERIALS AND SUPPLIES ARE TO BE EXAMINED
 NO UNDESIGNATED MATERIALS ALLOWED.
 CONTRACTOR TO FURNISH AND INSTALL ALL PIPE AND
 FITTINGS NECESSARY TO INSTALL DETECTOR CHECK VALVE
 ASSEMBLY.
 IF BENCH MARK REQUIRED,
 BRIDGE OR CONCRETE (MARKING REQUIRED) AS SHOWN
 ALLOW 5" CLEARANCE ABOVE WATER LINE WHICH
 PASSES THROUGH CONCRETE WALLS. OPENING TO BE
 SMALLER THAN A CONCRETE MATERIAL APPROVED
 BY THE ENGINEER.
 CONNECTIONS OF THE DETECTOR CHECK VALVE ASSEMBLY
 NOT TO BE MADE.
 DETECTOR VALVE AND BOX ARE TO BE ON THE LEFT
 SUPPLY LINE.
 MANHOLE RING AND COVER TO BE INSTALLED OVER THE
 DETECTOR CHECK VALVE.
 THE VALVE IN THE BOX (ITEM B) SHALL BE THE MAIN
 MAY BE RELOCATED AT THE DISCRETION OF THE PLUMBING UTILITIES
 DEPARTMENT APPROX. 1992

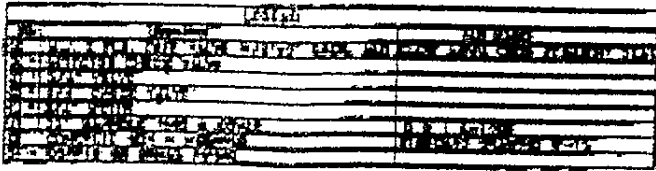

FURNISHED BY SALT LAKE CITY

3 DETECTOR CHECK VALVE

PSOMAS

2825 East Cottonwood Parkway, Suite 120
 Salt Lake City, Utah 84121
 (801) 770-5177 (801) 270-5782 (FAX)

JUR	JUR	S/A
DATE	DATE	DATE

4
4

BK 836660186

BK 836660186

P.I. STA. 6+80.64
N=13455.070
E=50040.593
R=100.00'
DELTA=48°48'00"
L=85.17'
D.O.C.=57°17'45"
T=45.36'

T.2S.
S.L.B. & M.
R.1E.

38+00

BOYSER OLDMILL

SEE SHEET 20RW
FOR PARKING TEMP.
CONSTR. EASEMENT

PT STA.
PC STA. 6+35.28A

MATCH LINE STATION 6+00A SEE SHEET 13RW
53°32'22.25" E
478.00'
1:2CE
1:CE1
1:2CE
1:2CE

STA. 7+20.45A
23.50' LT.
STA. 7+53.99A
23.50' LT.
STA. 7+80.70A
39.91' LT.
STA. 7+90.69A
41.11' LT.
8+00A
STA. 7+89.47A
25.88' LT.
STA. 8+04.08A
26.84' LT.
STA. 8+44.00A
29.50' LT.
STA. 8+56.85A
29.50' LT.

STA. 6+30.01A
42.95' RT.
STA. 6+34.57A
46.02' RT.
STA. 6+35.28A
46.50' RT.
STA. 6+40.41A
51.94' RT.
STA. 6+35.28A
23.50' RT.
STA. 6+47.73A
23.50' RT.
STA. 6+48.65A
23.50' RT.
STA. 6+77.15A
49.96' RT.

TEMP.
CONSTR.
EASEMENT

CONTROL LINE &
NEW CENTERLINE

PERP. ACCESS EASEMENT

"A-LINE"
WEST ACCESS

WALLNET INVESTMENTS

35+00

PC STA. 8+56.85A

BK 8366 PG 0187



**RB&G
ENGINEERING
INC.**

1435 WEST 820 NORTH
PROVO, UTAH 84601-1343
801 374-5771 FAX
801 521-5771 SALT LAKE CITY

NO.	AUTHORIZED BY	REVISION	MADE BY	DATE

DESIGNED BY: DAVID A. LUND
DRAWN BY: JAMES BUSBY
CHECKED BY: SCOTT A. HENDERSON
SCALE: HORIZ. 1" = 20'
VERT. 1" = 20'
DATE: MARCH 1999

**PUBLIC
ENG:
SALT**
2001
SALT

P. STR. LEMENT

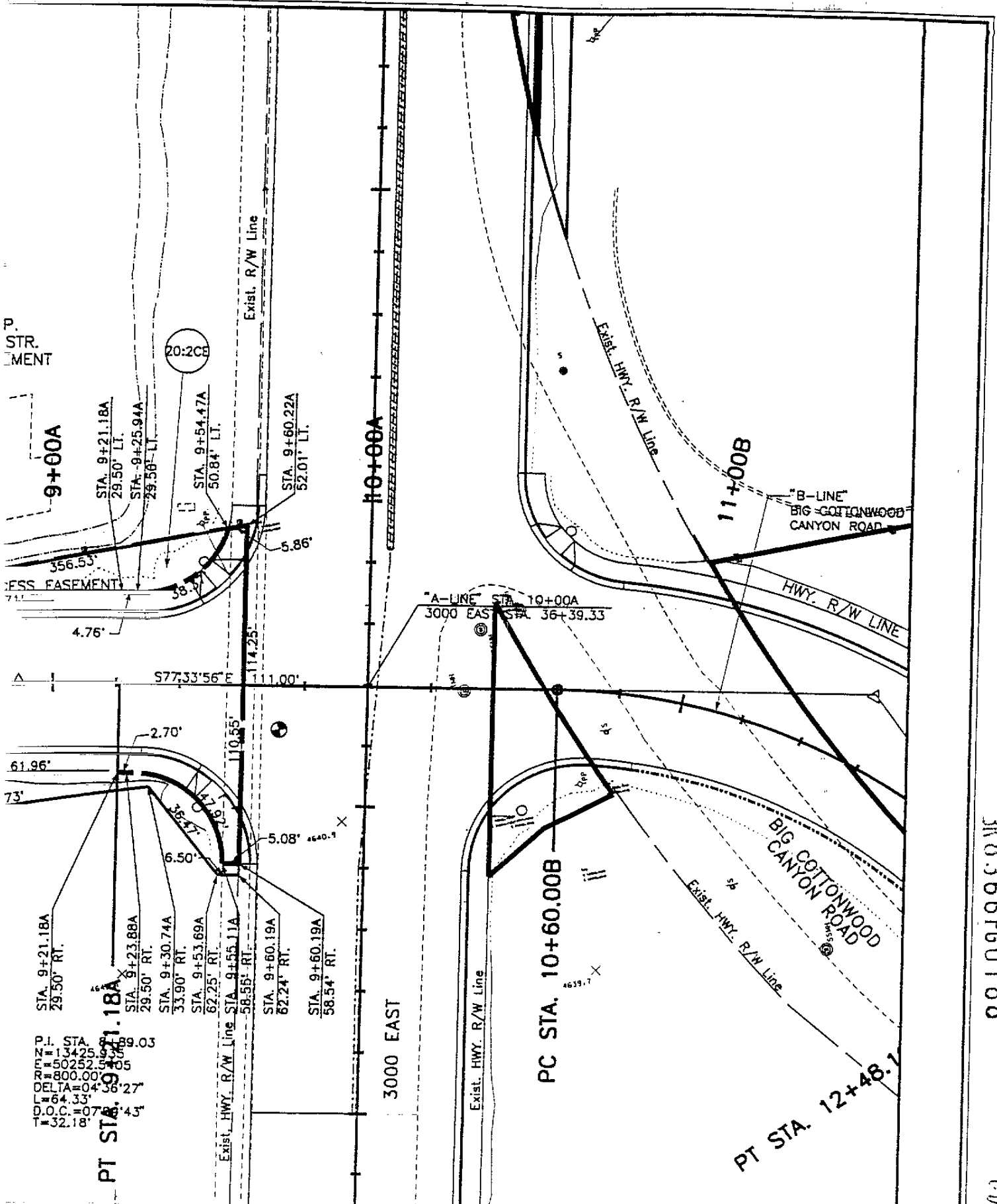

STA. 9+21.18A
 29.50' RT.
 STA. 9+23.88A
 29.50' RT.
 STA. 9+30.74A
 33.90' RT.
 STA. 9+53.69A
 62.25' RT.
 STA. 9+55.11A
 58.55' RT.
 STA. 9+60.19A
 62.24' RT.
 STA. 9+60.22A
 58.54' RT.

P.I. STA. 9+21.18A
 R.M.Z.D. # 15425
 R.M. # 50252.5
 R.M. # 800.00
 DELTA = 0.45627
 L = 64.33'
 D.O.C. = 07'
 T = 32.18'

UTAH DEPARTMENT OF TRANSPORTATION
 ENGINEERING DIVISION
 SALT LAKE COUNTY
 STATE #N3300
 FORT UNION, UTAH 84190

3000 EAST STREET
 FORT UNION BLVD. TO
 6200 SOUTH STREET

PLAN "A-LINE"
 WEST ACCESS ROAD
 RIGHT-OF-WAY
 STA. 6+00A TO STA. 10+00A

9729
 PROJECT NO.
 91600
 SHEET 14RW
 OF SHEETS

JK8366P60188

10/1/2011