



reserves and makes this Easement subject to a perpetual easement, right and privilege on the part of Grantor, its successors, lessees, licensees and assigns at any time and at all times thereafter, to discharge through the medium of the air, over, upon and across the above described real property any and all gases, particulates, dust, dirt, fumes and other substances and matter which may be released, given, thrown or blown off, emitted or discharged in the course of, by, or through the existence or operations of, any and all of the smelting plants, reduction works, mills, refineries, power plants, manufactories which are now or which may hereafter at any time be established or operated by Grantor or its successors, grantees, lessees, licensees, or assigns, or any of them. By accepting this Easement, Grantee hereby acknowledges that it has full knowledge of the proximity of the above described property to Grantor's facilities and by such acceptance hereby waives any claims it may have against Grantor, its successors or assigns, arising out of, or in any way connected with, operations now conducted, or which may be conducted in the future at such facilities by Grantor, its successors, grantees, lessees, licensees, or assigns. This reservation shall be binding upon Grantee, its successors and assigns, forever.

By accepting this Easement, Grantee hereby agrees to defend, indemnify and save Grantor, its successors and assigns, harmless against any and all loss and expense, including attorneys' fees and other legal expenses, by reason of liability imposed or claimed to be imposed by law upon Grantor for damage because of bodily injury, including death at any time resulting from this Easement, or on account of damage to property, sustained by any person or persons arising out of, or in any manner connected with, or growing out of or predicated upon the construction, maintenance, operation, existence or use of said Easement and such adjacent portions of Grantor's property as Grantee shall utilize from time to time, whether or not such bodily injuries, death, or damage to property arise or are claimed to have arisen in whole or in part out of negligence or other grounds of legal liability, including violation of any duty imposed by statute, ordinance or regulation, on the part of the Grantee, Grantor, employees or agents of either of them, or any other person or organization, but excluding any liability caused by the sole negligence or willful misconduct of Grantor.

BOOK 5727 PAGE 538

The terms, conditions and reservations of this Easement shall accrue to the benefit of and be binding upon the successors and assigns of the parties hereto.

Signed and Delivered this \_\_\_\_\_ day of \_\_\_\_\_, 198\_.

GRANTOR:

KENNECOTT CORPORATION  
(Formerly Kennecott Copper Corporation)



D. Davis  
(Title) Vice President

BY Burgess Winter 205  
ITS Vice President

STATE OF UTAH )  
: SS.  
COUNTY OF SALT LAKE)

On the 19th day of December, 1985, personally appeared before me J. Burgess Winter, who being duly sworn, did say that he is a Vice President of KENNECOTT CORPORATION, and that the foregoing instrument was signed in behalf of said corporation and said J. Burgess Winter duly acknowledged to me that said corporation executed the same.



STATE COMMISSION EXPIRES:  
May 18, 1987

Joann C. Morris  
NOTARY PUBLIC

Residing In: Salt Lake City, Utah

20907 30966  
JPC WTLR  
84125

250 Bell Plaza  
Room 510A  
JPC WTLR  
84111

Mountain Bell  
JAN 14 10 04 AM '86  
REQ OF DEP

MAIL ROOM  
RECEIVED  
SALT LAKE COUNTY,  
UTAH

44 93 700  
 44 92 500  
 820,000  
 C.Z.  
 44 91 900  
 815,000  
 C.Z.  
 44 91 300  
 810,000  
 C.Z.  
 44 90 700  
 44 90 100  
 810,000  
 C.Z.  
 44 89 300

BUDGE	DESCRIPTION
005	PUMP HOUSE - WEST MTH SHAFT
006	" " CENTRAL YARD
087	TRUCK RACK CHANGE ROOM
049	GENERATOR - ACETYLENE
036	CAR REPAIR SHOP
830	TRUCK MACHINE FOREMAN OFFICE
066	LECTURE STATION
058	PAINT & LUB. BLDG
075	STEEL STORAGE BARN
302	OIL HOUSE
111	GARAGE
116	LUMBER SHED
133	ROAD SHIFTERS
141	STEAM CLEANING SLACK
059	OXYGEN & ACET. STGE BLDG
849	TRUCK SHIFTER SHED
997	PAINT SHOP CENTRAL YARD
868	TIRE REPAIR SHOP
869	DIESEL REPAIR SHOP
050	EMPTY FORK MACHINE SHOP
877	PUMPHOUSE NO 3
057	WAREHOUSE & SHOP BLDG
892	PUMPHOUSE EAST SIDE
895	STEEL TOWER WEST MTH WELL
896	HOST HOUSE " " "
938	PUMP HOUSE
940	" " EAST SIDE
942	" " " C LEVEL
474	SECURITY STATION

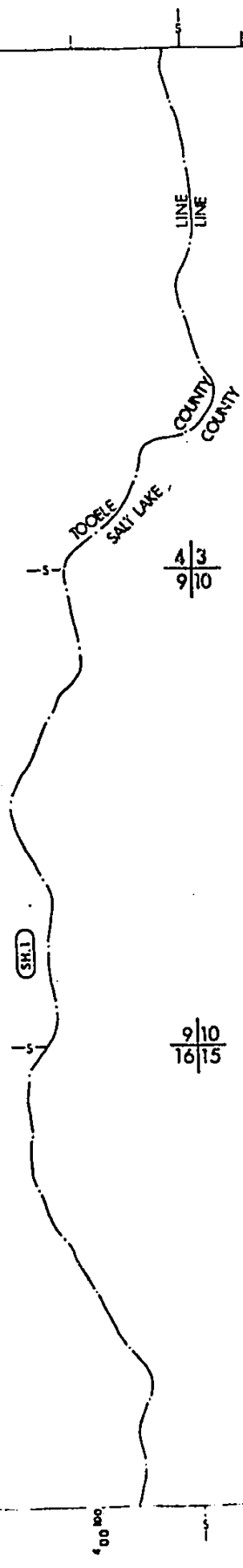

BOOK 5727 PAGE 540

TELEPHONE CABLE  
 LESS THAN  
 25 PAIR

3  
10

10  
15



**PUBLIC NOTICE:**

More detailed information concerning the easement(s) depicted on this map is available upon inquiry to the Right-of-Way Office of The Mountain States Telephone and Telegraph Company in Salt Lake City, Utah.

**NOTE TO COUNTY RECORDER:**

Property affected by this easement is approximately located in:  
Sections: 7, 8, 17 & 18  
Township: 3 South  
Range: 2 West  
Salt Lake Base and Meridian.

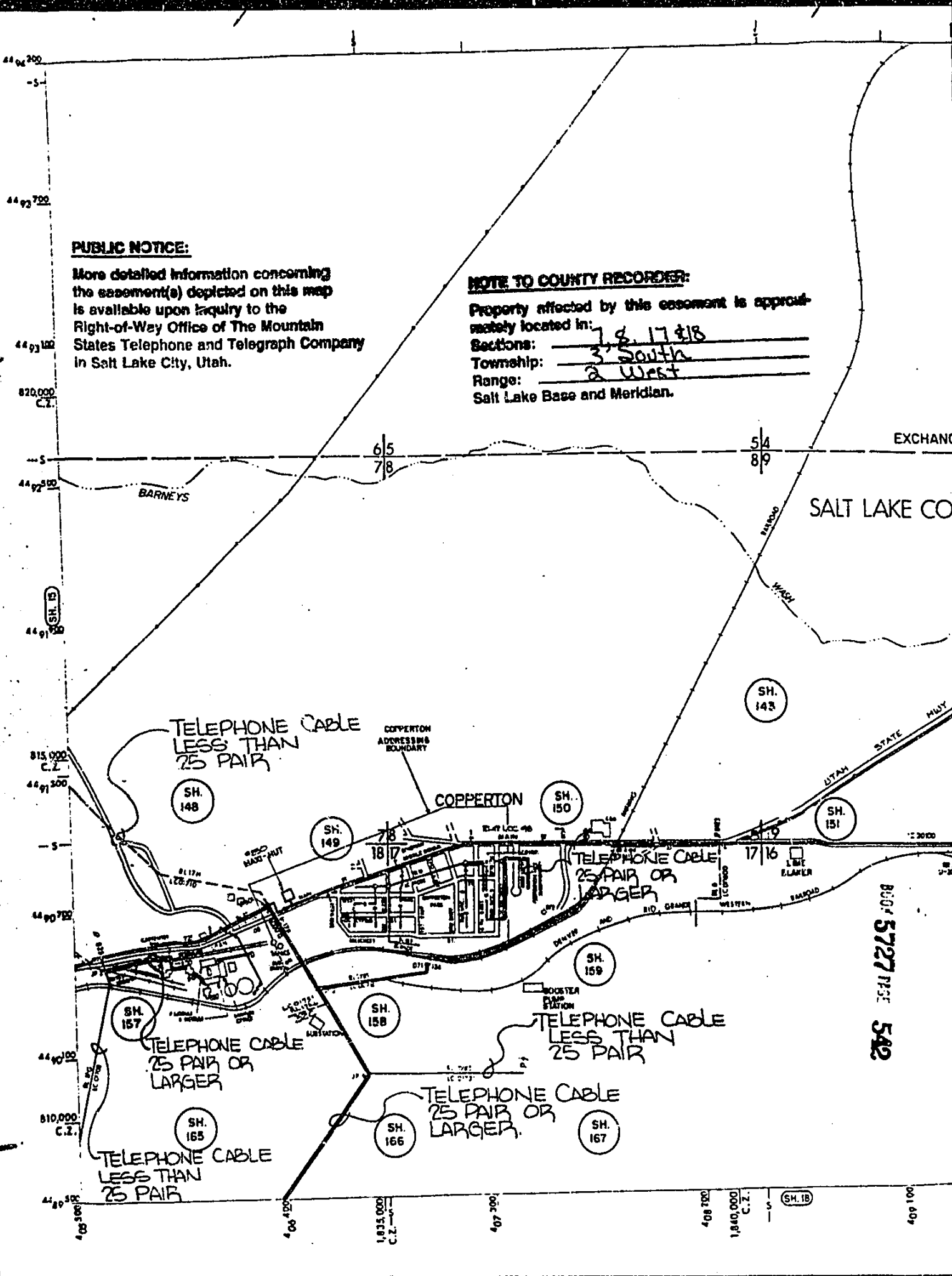

R-2-W

IN EFFECT		8-18-85	
REVISIONS			
NO.	DATE	BY	DESCRIPTION
1	11-22-84	PA	REVISED TO
2	12-21-84	PA	REVISED TO
3	01-23-85	PA	REVISED TO
4	02-21-85	PA	REVISED TO
5	03-21-85	PA	REVISED TO

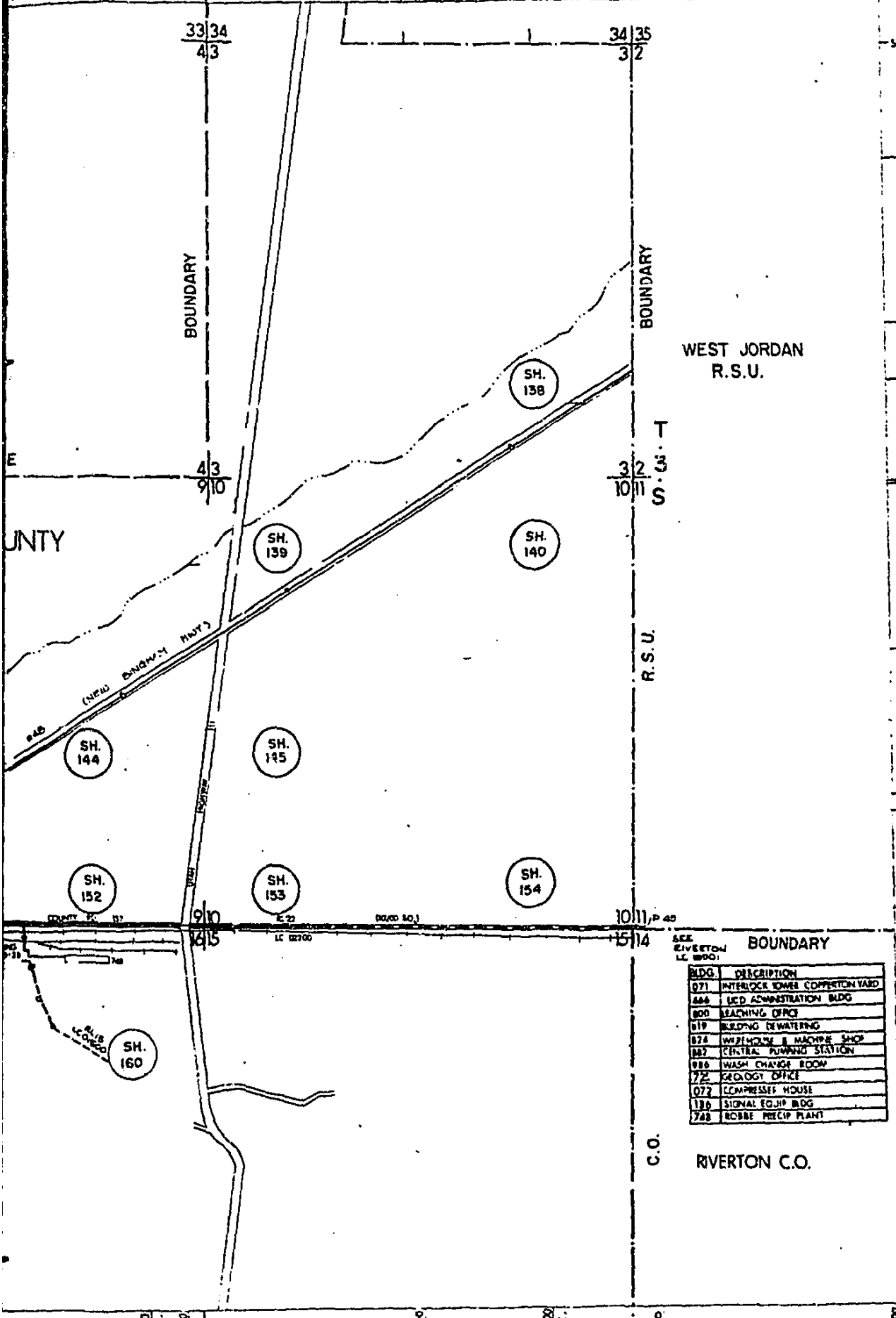

WEST JORDAN  
R.S.U.

T  
S  
R.S.U.

SEE  
RIVERTON  
LC 89001  
BOUNDARY

BLDG.	DESCRIPTION
071	INTERLOCK TOWER COPPERTON YARD
088	UCD ADMINISTRATION BLDG
090	LEACHING OFFICE
019	BUILDING DEWATERING
024	WELDING & MACHINE SHOP
082	CENTRAL PUMPING STATION
080	WASH CHANGE ROOM
072	GEOLOGY OFFICE
072	COMPRESSOR HOUSE
180	SIGNAL EQUIP BLDG
740	ROBBE PRECIP PLANT

C.O.  
RIVERTON C.O.

BOG 5727 PAGE 543

1	11-22-84	PA	REVISED TO
2	12-21-84	PA	REVISED TO
3	01-23-85	PA	REVISED TO
4	02-21-85	PA	REVISED TO
5	03-21-85	PA	REVISED TO

EXHIBIT  
'B'

MOUNTAIN BELL TELEPHONE CO.	
OPM	
ELECTRICAL CENTER/CO	
MIDVALE	
GRID REFERENCE	400 400
SCALE	1" = 800'
SHEET	
16	

600 METER TICKS VERTICALLY AND 800 METER TICKS HORIZONTALLY BASED ON THE UNIVERSAL TRANSVERSE MERCATOR GRID, UTM GRID IS SHOWING 6,000 FOOT TICKS BASED ON UTAH STATE PLANE COORDINATES. -> REPRESENTS CONTINUATION OF SECTION LINE.

**PUBLIC NOTICE:**

More detailed information concerning the easement(s) depicted on this map is available upon inquiry to the Right-of-Way Office of The Mountain States Telephone and Telegraph Company Salt Lake City, Utah.

**NOTE TO COUNTY RECORDER:**

Property affected by this easement is approximately located in:  
 Sections: 14, 23, 26, 27, 34 & 36  
 Township: 3 South  
 Range: 24 3 West  
 Salt Lake Base and Meridian.

BLDG	DESCRIPTION
835	OBSERVATION PLATFORM
836	DISPATCHERS SHED
837	COMPRESSOR HOUSE
850	FOREMAN'S SHACK SHED
084	CONVERTER STATION # 3
866	FOREMAN'S SHACK GARD
870	POST OFFICE
766	COMPRESSOR BUILDING
809	CAR SHOP
829	COMMUNICATIONS BLDG
981	SWITCH / VALVE HOUSE
011	OP. NITRATE STORAGE BIN
703	WATER SWITCH STATION
878	OPERATIONS STATION (GEN. OFF.)
880	SHOP & WAREHOUSE
883	ELECTRO-MECHANICAL
884	WAREHOUSE
885	TIRE REPAIR SHOP
071	BLDG OPERATION CONTROL
843	RECTIFIER STATION 5400
873	TRACK SHIFTER
874	FOREMAN'S SHED
875	STORAGE SHACK
876	ASSEMBLY BLDG.
831	TRACK OFFICE
895	SECURITY BLDG
901	TRUCK DISPATCHER
961	ROTARY CONVERTER # 3
817	FOREMAN'S OFFICE

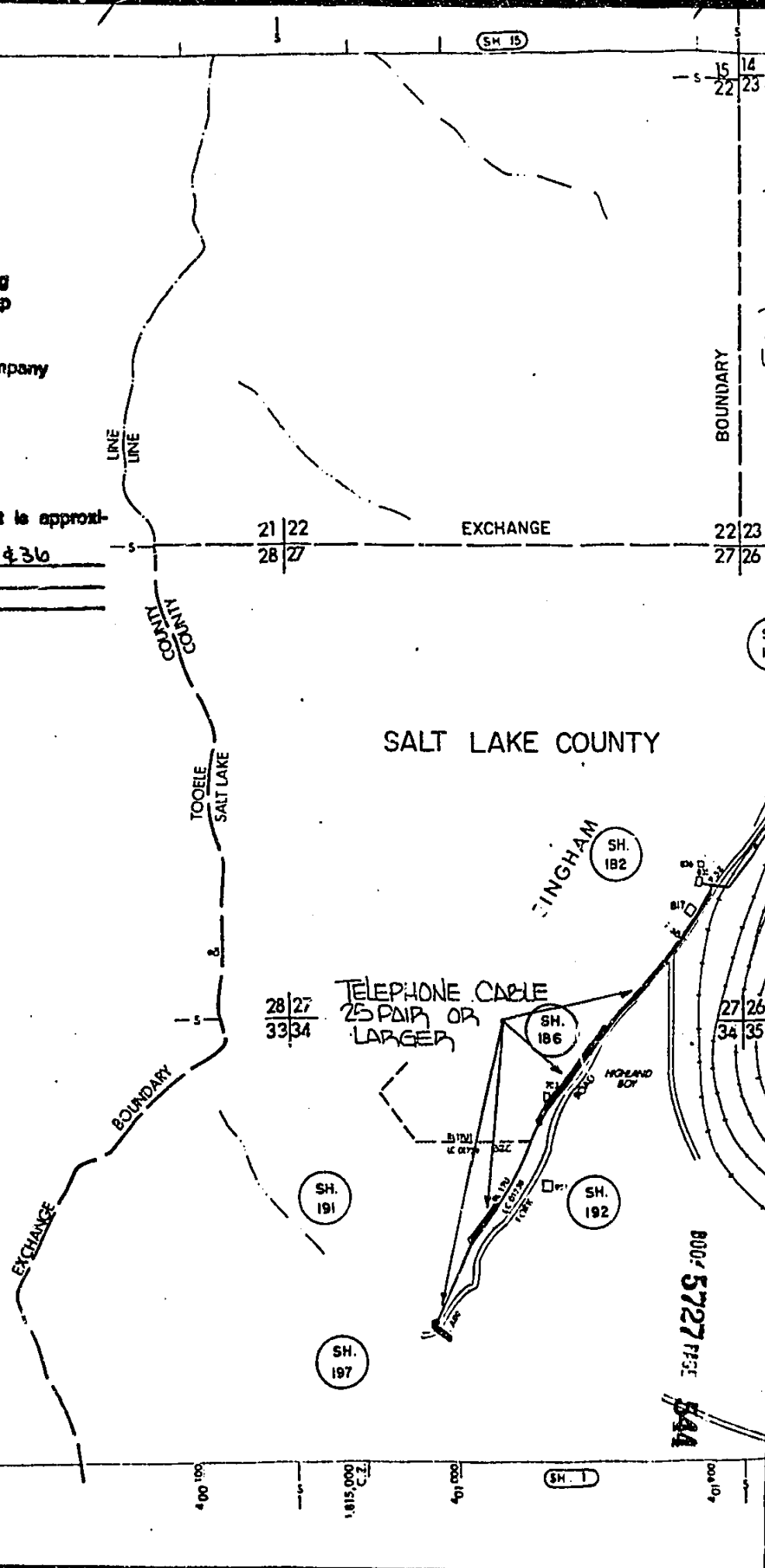

44 80 302  
 44 88 100  
 805,000  
 C. Z.  
 44 88 300  
 44 87 700  
 44 87 100  
 800,000  
 C. Z.  
 44 86 500  
 44 85 900  
 44 85 300  
 795,000  
 C. Z.  
 44 84 100  
 398,000  
 1,810,000  
 855,200  
 400,100  
 1,815,000  
 C. Z.  
 401,000  
 401,000

BOUNDARY

SALT LAKE COUNTY

INGHAM SH. 182

TELEPHONE CABLE  
 25 PAIR OR  
 LARGER

SH. 191

SH. 197

SH. 192

800 5727 FISC  
 544

SH. 1

401,000



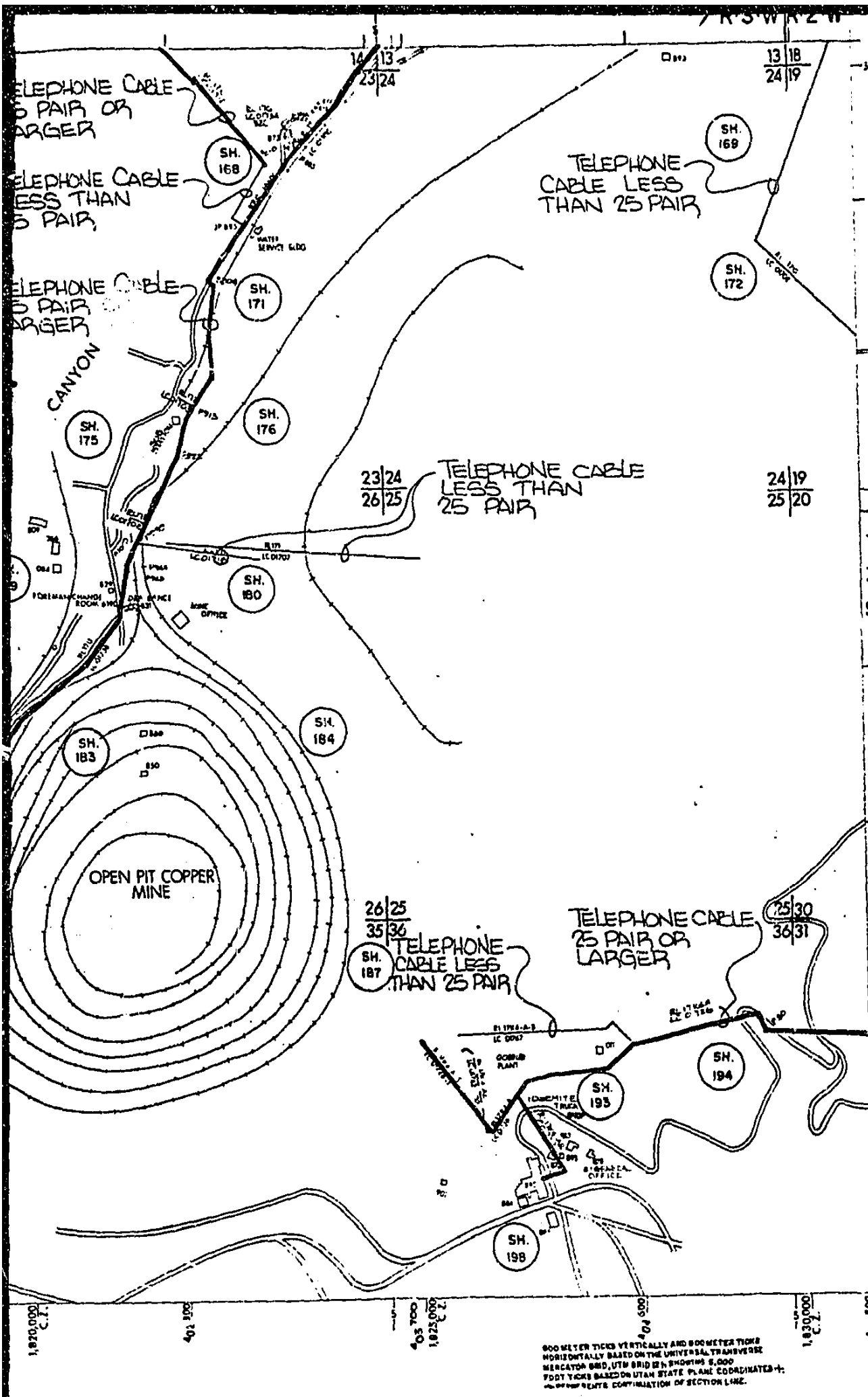

IN EFFECT 8 18 85

REVISIONS

ORDER NUMBER	DATE POSTED
1	8 18 85
2	8 18 85
3	8 18 85
4	8 18 85
5	8 18 85
6	8 18 85
7	8 18 85
8	8 18 85
9	8 18 85
10	8 18 85
11	8 18 85
12	8 18 85
13	8 18 85
14	8 18 85
15	8 18 85
16	8 18 85
17	8 18 85
18	8 18 85
19	8 18 85
20	8 18 85
21	8 18 85
22	8 18 85
23	8 18 85
24	8 18 85
25	8 18 85
26	8 18 85
27	8 18 85
28	8 18 85
29	8 18 85
30	8 18 85

BOOK 5727 PAGE 545

LEGEND

EXHIBIT 'B'

MOUNTAIN BELL TELEPHONE CO.

OPM

TECHNICAL CENTER/CENTRAL

MIDVALE

UTM REFERENCE

44 700 3 30

SCALE 1" = 800'

SHEET

17

500 METER TICKS VERTICALLY AND 800 METER TICKS HORIZONTALLY BASED ON THE UNIVERSAL TRANSVERSE MERCATOR GRID, UTM GRID IS SHOWING 8,000 FOOT TICKS BASED ON UTM STATE PLANE COORDINATES. THIS SHEET IS A CONTINUATION OF SECTION 14E.





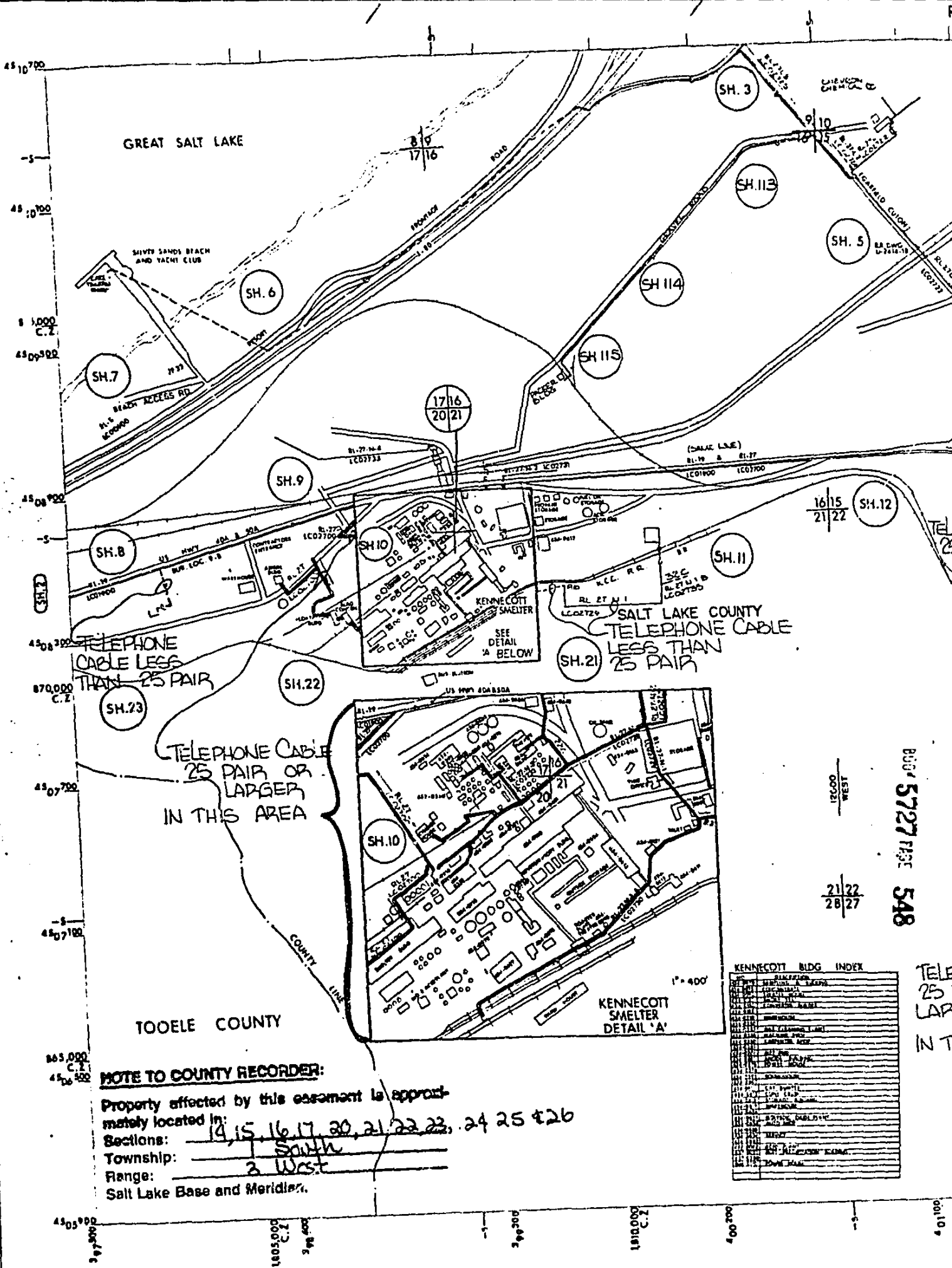

GREAT SALT LAKE

SILVER SANDS BEACH AND YACHT CLUB

SH. 7

BEACH ACCESS RD.

SH. 6

17/16

20/21

SH. 3

SH. 113

SH. 5

SH. 114

SH. 115

SH. 9

SH. 8

SH. 10

SH. 11

16/15

21/22

SH. 12

TELEPHONE CABLE LESS THAN 25 PAIR

SH. 23

SH. 22

SH. 21

TELEPHONE CABLE 25 PAIR OR LARGER IN THIS AREA

SH. 10

TOOELE COUNTY

KENNECOTT SMELTER DETAIL 'A'

**NOTE TO COUNTY RECORDER:**

Property affected by this easement is approximately located in:  
 Sections: 14, 15, 16, 17, 20, 21, 22, 23, 24, 25 & 26  
 Township: South  
 Range: 2 West  
 Salt Lake Base and Meridian.

KENNECOTT BLDG INDEX

1	BLK 1
2	BLK 2
3	BLK 3
4	BLK 4
5	BLK 5
6	BLK 6
7	BLK 7
8	BLK 8
9	BLK 9
10	BLK 10
11	BLK 11
12	BLK 12
13	BLK 13
14	BLK 14
15	BLK 15
16	BLK 16
17	BLK 17
18	BLK 18
19	BLK 19
20	BLK 20
21	BLK 21
22	BLK 22
23	BLK 23
24	BLK 24
25	BLK 25
26	BLK 26

BUG 5727 PAGE 548

TELEPHONE CABLE 25 PAIR OR LARGER IN THIS AREA

ORDER NUMBER	DATE POSTED
REPLACES OPMS FEB 1987	
2.3 & 8	11/24/81
10.25A	6/2/82 MA
10.25B	10/1/82 DD
10.25C	2/2/83 MA
10.25D	4/8/83 MA
10.25E	7/12/83 DD
10.25F	9/1/83 DD
10.25G	10/2/83 MA
PARTIAL FINAL POST	
10.25H	11/13/83 MA
10.25I	1/15/84 MA
10.25J	1/15/84 MA
10.25K	1/15/84 MA
10.25L	1/15/84 MA
10.25M	1/15/84 MA
10.25N	1/15/84 MA
10.25O	1/15/84 MA
10.25P	1/15/84 MA
10.25Q	1/15/84 MA
10.25R	1/15/84 MA
10.25S	1/15/84 MA
10.25T	1/15/84 MA
10.25U	1/15/84 MA
10.25V	1/15/84 MA
10.25W	1/15/84 MA
10.25X	1/15/84 MA
10.25Y	1/15/84 MA
10.25Z	1/15/84 MA

**PUBLIC NOTICE:**

More detailed information concerning the easement(s) depicted on this map is available upon inquiry to the Right-of-Way Office of the Mountain States Telephone and Telegraph Company in Salt Lake City, Utah.

ARTHUR CONCENTRATOR		BDG INDEX	
101	RECEPTION	101	RECEPTION
102	...	102	...
103	...	103	...
104	...	104	...
105	...	105	...
106	...	106	...
107	...	107	...
108	...	108	...
109	...	109	...
110	...	110	...
111	...	111	...
112	...	112	...
113	...	113	...
114	...	114	...
115	...	115	...
116	...	116	...
117	...	117	...
118	...	118	...
119	...	119	...
120	...	120	...
121	...	121	...
122	...	122	...
123	...	123	...
124	...	124	...
125	...	125	...
126	...	126	...
127	...	127	...
128	...	128	...
129	...	129	...
130	...	130	...
131	...	131	...
132	...	132	...
133	...	133	...
134	...	134	...
135	...	135	...
136	...	136	...
137	...	137	...
138	...	138	...
139	...	139	...
140	...	140	...
141	...	141	...
142	...	142	...
143	...	143	...
144	...	144	...
145	...	145	...
146	...	146	...
147	...	147	...
148	...	148	...
149	...	149	...
150	...	150	...
151	...	151	...
152	...	152	...
153	...	153	...
154	...	154	...
155	...	155	...
156	...	156	...
157	...	157	...
158	...	158	...
159	...	159	...
160	...	160	...
161	...	161	...
162	...	162	...
163	...	163	...
164	...	164	...
165	...	165	...
166	...	166	...
167	...	167	...
168	...	168	...
169	...	169	...
170	...	170	...
171	...	171	...
172	...	172	...
173	...	173	...
174	...	174	...
175	...	175	...
176	...	176	...
177	...	177	...
178	...	178	...
179	...	179	...
180	...	180	...
181	...	181	...
182	...	182	...
183	...	183	...
184	...	184	...
185	...	185	...
186	...	186	...
187	...	187	...
188	...	188	...
189	...	189	...
190	...	190	...
191	...	191	...
192	...	192	...
193	...	193	...
194	...	194	...
195	...	195	...
196	...	196	...
197	...	197	...
198	...	198	...
199	...	199	...
200	...	200	...

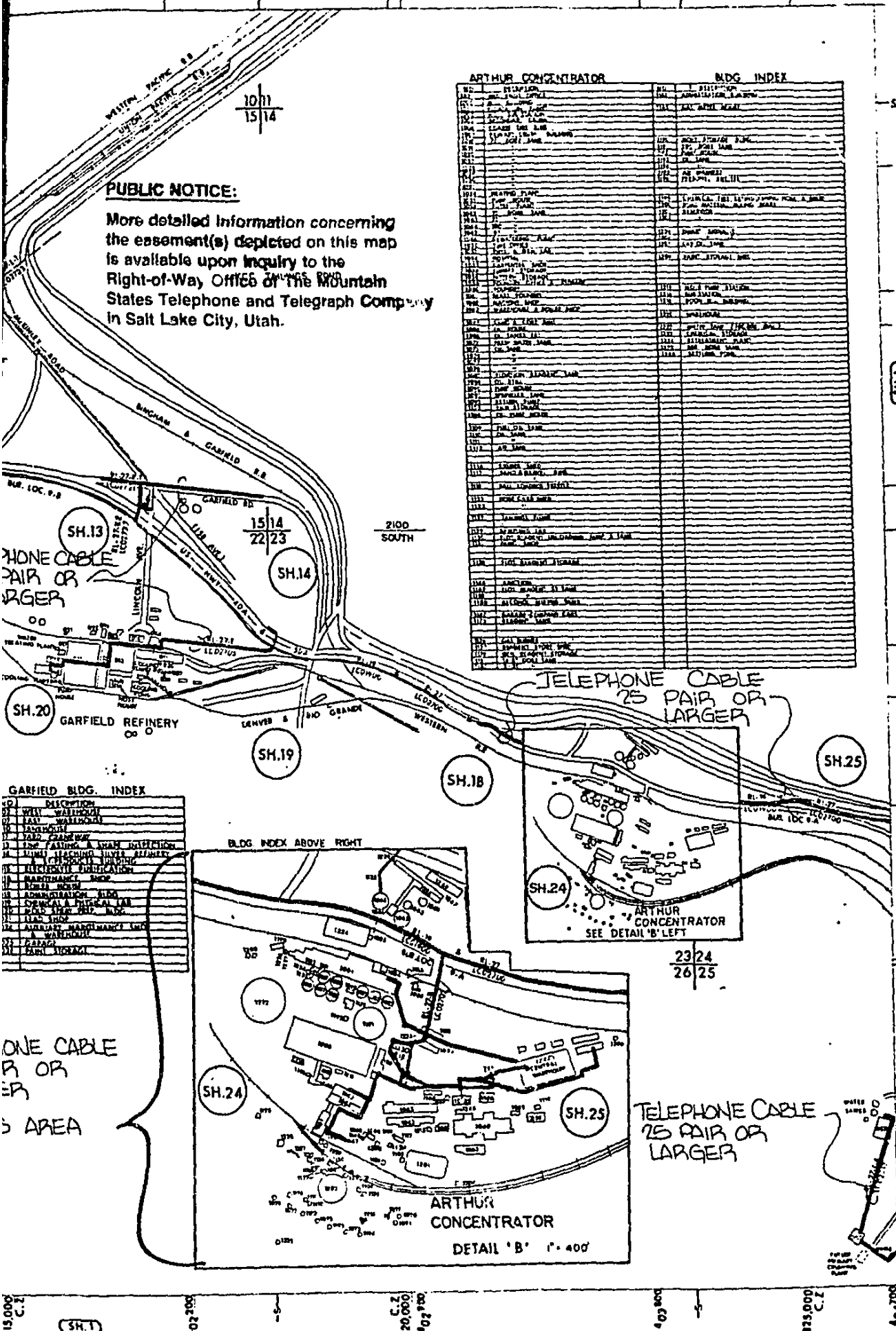





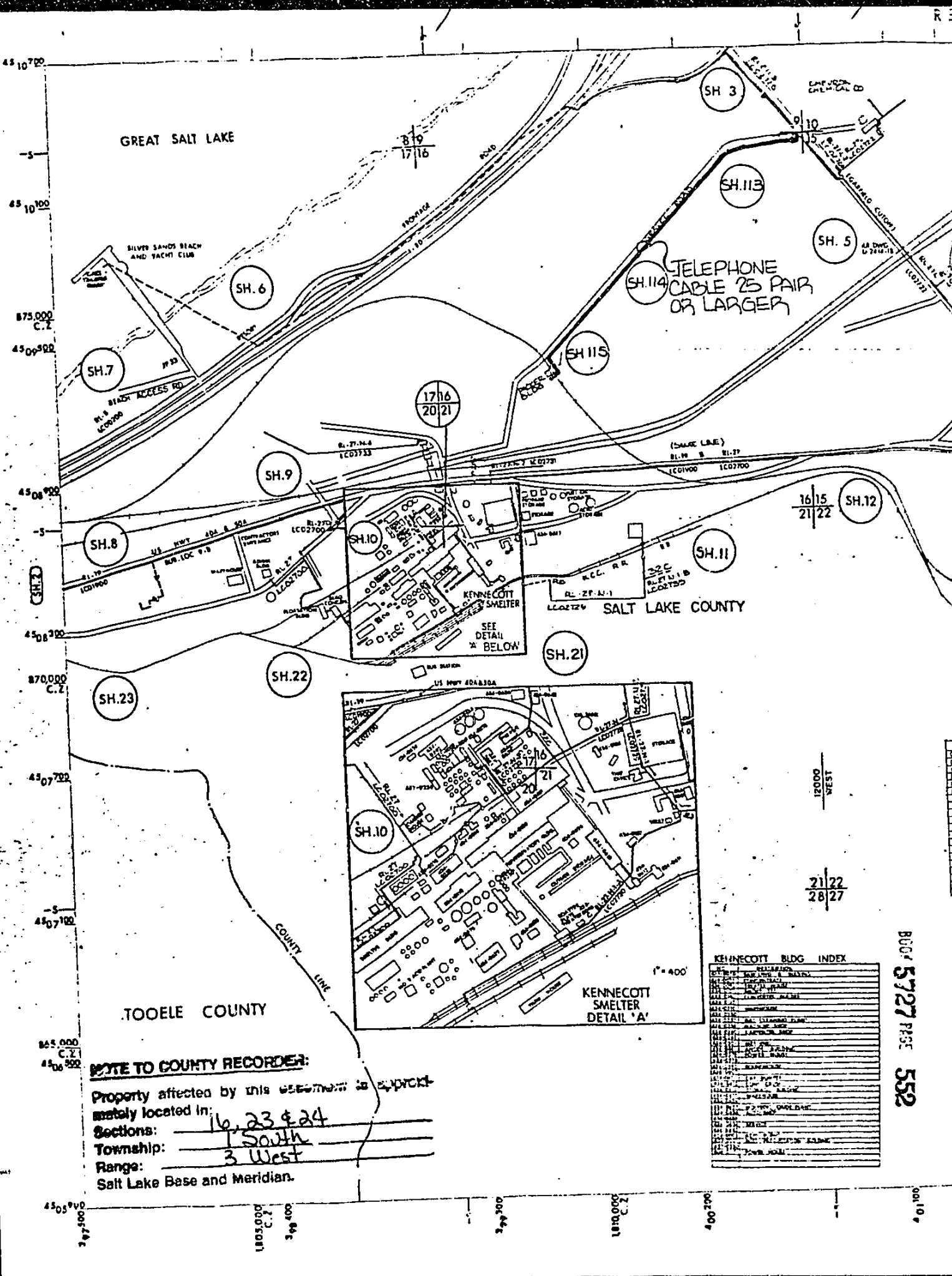

GREAT SALT LAKE

SILVER SANDS BEACH AND YACHT CLUB

TELEPHONE CABLE 25 PAIR OR LARGER

KENNECOTT SMELTER  
SEE DETAIL 'A' BELOW

SALT LAKE COUNTY

TOOELE COUNTY

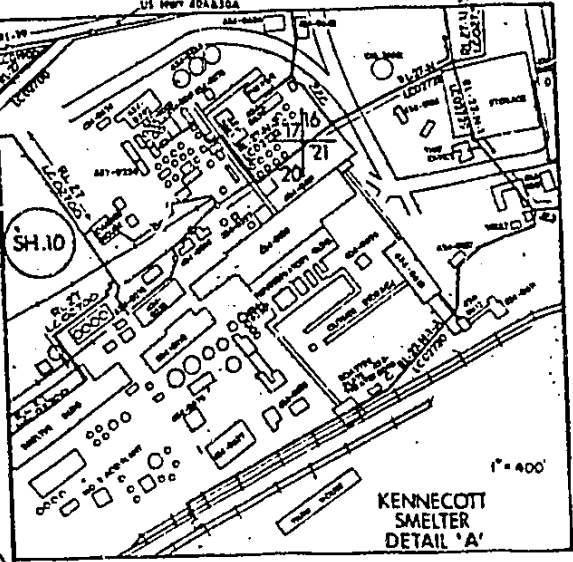

KENNECOTT SMELTER DETAIL 'A'

KENNECOTT BLDG INDEX

BLDG NO.	BLDG NAME	BLDG TYPE
101	...	...
102	...	...
103	...	...
104	...	...
105	...	...
106	...	...
107	...	...
108	...	...
109	...	...
110	...	...
111	...	...
112	...	...
113	...	...
114	...	...
115	...	...
116	...	...
117	...	...
118	...	...
119	...	...
120	...	...
121	...	...
122	...	...
123	...	...
124	...	...
125	...	...
126	...	...
127	...	...
128	...	...
129	...	...
130	...	...
131	...	...
132	...	...
133	...	...
134	...	...
135	...	...
136	...	...
137	...	...
138	...	...
139	...	...
140	...	...
141	...	...
142	...	...
143	...	...
144	...	...
145	...	...
146	...	...
147	...	...
148	...	...
149	...	...
150	...	...
151	...	...
152	...	...
153	...	...
154	...	...
155	...	...
156	...	...
157	...	...
158	...	...
159	...	...
160	...	...
161	...	...
162	...	...
163	...	...
164	...	...
165	...	...
166	...	...
167	...	...
168	...	...
169	...	...
170	...	...
171	...	...
172	...	...
173	...	...
174	...	...
175	...	...
176	...	...
177	...	...
178	...	...
179	...	...
180	...	...
181	...	...
182	...	...
183	...	...
184	...	...
185	...	...
186	...	...
187	...	...
188	...	...
189	...	...
190	...	...
191	...	...
192	...	...
193	...	...
194	...	...
195	...	...
196	...	...
197	...	...
198	...	...
199	...	...
200	...	...

**NOTE TO COUNTY RECORDER:**  
 Property affected by this easement is situated  
 mainly located in:  
 Sections: 16, 23 & 24  
 Township: 1 South  
 Range: 3 West  
 Salt Lake Base and Meridian.

BOOK 5727 PAGE 552



**PUBLIC NOTICE:**

More detailed information concerning the easement(s) depicted on this map is available upon inquiry to the Right-of-Way Office of The Mountain States Telephone and Telegraph Company in Salt Lake City, Utah.

ARTHUR CONCENTRATOR		BLDG. INDEX	
101	101	101	101
102	102	102	102
103	103	103	103
104	104	104	104
105	105	105	105
106	106	106	106
107	107	107	107
108	108	108	108
109	109	109	109
110	110	110	110
111	111	111	111
112	112	112	112
113	113	113	113
114	114	114	114
115	115	115	115
116	116	116	116
117	117	117	117
118	118	118	118
119	119	119	119
120	120	120	120
121	121	121	121
122	122	122	122
123	123	123	123
124	124	124	124
125	125	125	125
126	126	126	126
127	127	127	127
128	128	128	128
129	129	129	129
130	130	130	130
131	131	131	131
132	132	132	132
133	133	133	133
134	134	134	134
135	135	135	135
136	136	136	136
137	137	137	137
138	138	138	138
139	139	139	139
140	140	140	140
141	141	141	141
142	142	142	142
143	143	143	143
144	144	144	144
145	145	145	145
146	146	146	146
147	147	147	147
148	148	148	148
149	149	149	149
150	150	150	150
151	151	151	151
152	152	152	152
153	153	153	153
154	154	154	154
155	155	155	155
156	156	156	156
157	157	157	157
158	158	158	158
159	159	159	159
160	160	160	160
161	161	161	161
162	162	162	162
163	163	163	163
164	164	164	164
165	165	165	165
166	166	166	166
167	167	167	167
168	168	168	168
169	169	169	169
170	170	170	170
171	171	171	171
172	172	172	172
173	173	173	173
174	174	174	174
175	175	175	175
176	176	176	176
177	177	177	177
178	178	178	178
179	179	179	179
180	180	180	180
181	181	181	181
182	182	182	182
183	183	183	183
184	184	184	184
185	185	185	185
186	186	186	186
187	187	187	187
188	188	188	188
189	189	189	189
190	190	190	190
191	191	191	191
192	192	192	192
193	193	193	193
194	194	194	194
195	195	195	195
196	196	196	196
197	197	197	197
198	198	198	198
199	199	199	199
200	200	200	200

DATE	BY
12-28-52	W.S. CAS
12-29-52	W.S. CAS
12-30-52	W.S. CAS
1-1-53	W.S. CAS
1-2-53	W.S. CAS
1-3-53	W.S. CAS
1-4-53	W.S. CAS
1-5-53	W.S. CAS
1-6-53	W.S. CAS
1-7-53	W.S. CAS
1-8-53	W.S. CAS
1-9-53	W.S. CAS
1-10-53	W.S. CAS
1-11-53	W.S. CAS
1-12-53	W.S. CAS
1-13-53	W.S. CAS
1-14-53	W.S. CAS
1-15-53	W.S. CAS
1-16-53	W.S. CAS
1-17-53	W.S. CAS
1-18-53	W.S. CAS
1-19-53	W.S. CAS
1-20-53	W.S. CAS
1-21-53	W.S. CAS
1-22-53	W.S. CAS
1-23-53	W.S. CAS
1-24-53	W.S. CAS
1-25-53	W.S. CAS
1-26-53	W.S. CAS
1-27-53	W.S. CAS
1-28-53	W.S. CAS
1-29-53	W.S. CAS
1-30-53	W.S. CAS
1-31-53	W.S. CAS

BOOK 5727 PAGE 553

**GARFIELD BLDG. INDEX**

101	101
102	102
103	103
104	104
105	105
106	106
107	107
108	108
109	109
110	110
111	111
112	112
113	113
114	114
115	115
116	116
117	117
118	118
119	119
120	120
121	121
122	122
123	123
124	124
125	125
126	126
127	127
128	128
129	129
130	130
131	131
132	132
133	133
134	134
135	135
136	136
137	137
138	138
139	139
140	140
141	141
142	142
143	143
144	144
145	145
146	146
147	147
148	148
149	149
150	150
151	151
152	152
153	153
154	154
155	155
156	156
157	157
158	158
159	159
160	160
161	161
162	162
163	163
164	164
165	165
166	166
167	167
168	168
169	169
170	170
171	171
172	172
173	173
174	174
175	175
176	176
177	177
178	178
179	179
180	180
181	181
182	182
183	183
184	184
185	185
186	186
187	187
188	188
189	189
190	190
191	191
192	192
193	193
194	194
195	195
196	196
197	197
198	198
199	199
200	200

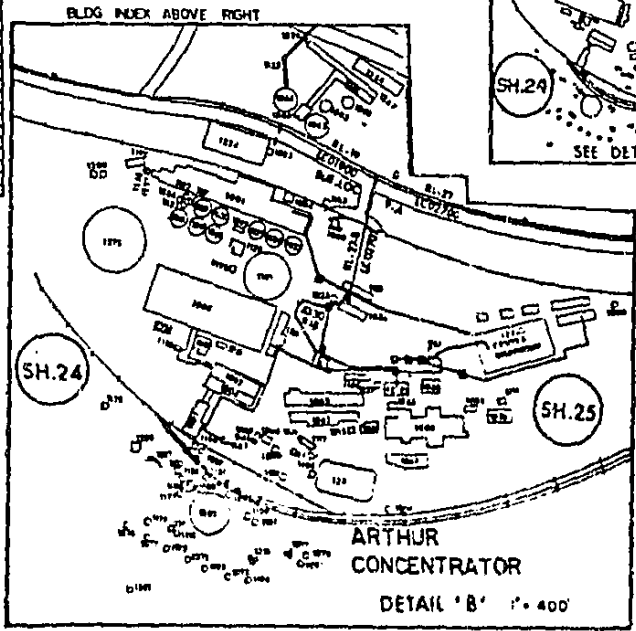

LOC SET BY THE VERTICALLY AND 800 METER TIES  
 NOT DIMENSIONED ON THE UNIVERSALS TO AN EXACT  
 MEASUREMENT BUT, UP TO 200 FT. IN DIMENSIONS 8,000  
 FOOT TIES BASED IN UTM STATE PLANE 500 FOOT TIES +  
 + DIMENSIONS CONTINUATION OF SECTION LINE

**EXHIBIT**

MOUNTAIN BELL TELEPHONE CO.

**OPM**

**MAGNA**

SCALE 1" = 800'

SHEET 3





SALT LAKE COUNTY

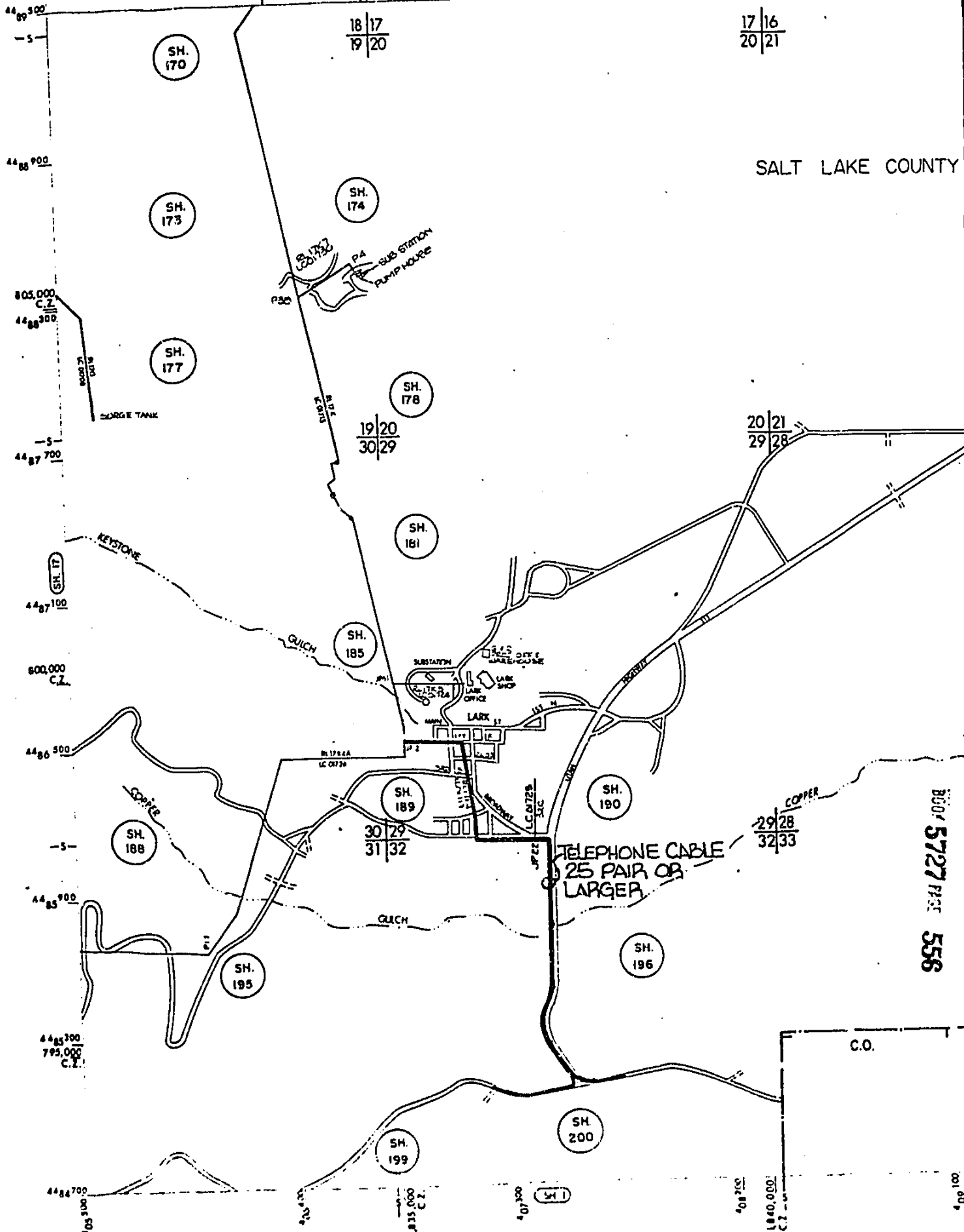

BOOK 5727 PAGE 556

