

When Recorded Return to:  
Mr. Craig L. White  
South Valley Sewer District  
P.O. Box 629  
Riverton, UT 84065

13402507  
09/23/2020 11:28 AM \$0.00  
Book - 11024 Pg - 3793-3799A  
RASHELLE HOBBS  
RECORDER, SALT LAKE COUNTY, UTAH  
SOUTH VALLEY SEWER DISTRICT  
PO BOX 629  
RIVERTON UT 84065  
BY: JLA, DEPUTY - WI P. *SP*

PARCEL I.D.# 26-22-451-001-0000  
26-22-452-001-0000  
GRANTOR: VP DAYBREAK DEVCO LLC  
(Daybreak Village 11A Plat 6)  
Page 1 of 6

## EASEMENT

A twenty (20) foot wide sanitary sewer easement located in the Southeast Quarter of Section 22, Township 3 South, Range 2 West, Salt Lake Base and Meridian, U.S. Survey.

For the sum of One Dollar (\$1.00) and other good and valuable consideration, the receipt and sufficiency of which is hereby acknowledged, the undersigned as GRANTORS hereby grant, convey, sell, and set over unto South Valley Sewer District, a body politic of the State of Utah, hereinafter referred to as GRANTEE, its successors and assigns, a perpetual right-of-way and easement to construct, maintain, operate, repair, inspect, protect, install, remove and replace sewer pipelines, valves, valve boxes and other sewer transmission and distribution structures and facilities, hereinafter called the FACILITIES, said right-of-way and easement, being situate in Salt Lake County, State of Utah, over and through a parcel(s) of the GRANTORS' land lying within a strip twenty (20) feet wide, said strip extending ten (10) feet on each side of and lying parallel and adjacent to a line of reference and projection thereof, more particularly described as follows:

See Exhibit "A" attached hereto and by this reference made a part hereof.

Contains: 35,252 square feet or 0.81 acres

TO HAVE AND HOLD the same unto the GRANTEE, its successors and assigns, with the right of ingress and egress in the GRANTEE, its officers, employees, agents and assigns to enter upon the above-described property with such equipment and vehicles as is necessary to construct, install, maintain, operate, repair, inspect, protect, remove and replace the FACILITIES. During construction periods, GRANTEE and its contractors may use such portion of GRANTORS' property along and adjacent to the right-of-way and easement as may be reasonably necessary in connection with the construction or repair of the FACILITIES. The contractor performing the work shall restore all property, through which the work traverses, to as near its original condition as is reasonably possible. GRANTORS shall have the right to use the above-described property except for the purposes for which this right-of-way and easement is granted to the GRANTEE, provided such use shall not interfere with the FACILITIES or with the discharge and conveyance of sewage



## **Exhibit 'A'**

### **DAYBREAK VILLAGE 11A PLAT 6 SEWER EASEMENTS**

#### **(Line 1)**

A twenty (20) foot wide sanitary sewer easement, located in the Southeast Quarter of Section 22, Township 3 South, Range 2 West, Salt Lake Base and Meridian, U.S. Survey, said easement extending ten (10) feet on each side of and lying parallel and adjacent to a line of reference and projection thereof, more particularly described as follows:

Beginning at a point that lies South 89°56'37" East 3114.579 feet along the Daybreak Baseline Southwest (Being South 89°56'37" East 10583.405 feet between the Southwest Corner of Section 22, T3S, R2W and the Southeast Corner of Section 23, T3S, R2W) and North 601.864 feet from the Southwest Corner of Section 22, Township 3 South, Range 2 West, Salt Lake Base and Meridian and running thence North 08°44'25" East 81.703 feet to the point of terminus.

Contains: (approx. 82 L.F.)

#### **(Line 2)**

A twenty (20) foot wide sanitary sewer easement, located in the Southeast Quarter of Section 22, Township 3 South, Range 2 West, Salt Lake Base and Meridian, U.S. Survey, said easement extending ten (10) feet on each side of and lying parallel and adjacent to a line of reference and projection thereof, more particularly described as follows:

Beginning at a point that lies South 89°56'37" East 2913.044 feet along the Daybreak Baseline Southwest (Being South 89°56'37" East 10583.405 feet between the Southwest Corner of Section 22, T3S, R2W and the Southeast Corner of Section 23, T3S, R2W) and North 653.340 feet from the Southwest Corner of Section 22, Township 3 South, Range 2 West, Salt Lake Base and Meridian and running thence South 70°20'08" East 86.841 feet; thence South 79°22'53" East 121.846 feet; thence South 79°22'53" East 289.434 feet to the point of terminus.

Contains: (approx. 498 L.F.)

#### **(Line 3)**

A twenty (20) foot wide sanitary sewer easement, located in the Southeast Quarter of Section 22, Township 3 South, Range 2 West, Salt Lake Base and Meridian, U.S. Survey, said easement extending ten (10) feet on each side of and lying parallel and adjacent to a line of reference and projection thereof, more particularly described as follows:

Beginning at a point on the North Line of Skip rock Road, said point lies South 89°56'37" East 3392.490 feet along the Daybreak Baseline Southwest (Being South 89°56'37" East 10583.405 feet between the Southwest Corner of Section 22, T3S, R2W and the Southeast Corner of Section 23, T3S, R2W) and North 380.988 feet from the Southwest Corner of Section 22, Township 3 South, Range 2 West, Salt Lake Base and Meridian and running thence North 04°18'37" West

71.865 feet; thence North 07°05'41" East 96.897 feet; thence North 13°37'27" East 151.469 feet to the point of terminus.

Contains: (approx. 320 L.F.)

**(Line 4)**

A twenty (20) foot wide sanitary sewer easement, located in the Southeast Quarter of Section 22, Township 3 South, Range 2 West, Salt Lake Base and Meridian, U.S. Survey, said easement extending ten (10) feet on each side of and lying parallel and adjacent to a line of reference and projection thereof, more particularly described as follows:

Beginning at a point on the North Line of Skip rock Road, said point lies South 89°56'37" East 3217.689 feet along the Daybreak Baseline Southwest (Being South 89°56'37" East 10583.405 feet between the Southwest Corner of Section 22, T3S, R2W and the Southeast Corner of Section 23, T3S, R2W) and North 368.666 feet from the Southwest Corner of Section 22, Township 3 South, Range 2 West, Salt Lake Base and Meridian and running thence North 02°00'20" West 111.156 feet to the point of terminus.

Contains: (approx. 111 L.F.)

**(Line 5)**

A twenty (20) foot wide sanitary sewer easement, located in the Southeast Quarter of Section 22, Township 3 South, Range 2 West, Salt Lake Base and Meridian, U.S. Survey, said easement extending ten (10) feet on each side of and lying parallel and adjacent to a line of reference and projection thereof, more particularly described as follows:

Beginning at a point on the North Line of Skip rock Road, said point lies South 89°56'37" East 2910.766 feet along the Daybreak Baseline Southwest (Being South 89°56'37" East 10583.405 feet between the Southwest Corner of Section 22, T3S, R2W and the Southeast Corner of Section 23, T3S, R2W) and North 389.046 feet from the Southwest Corner of Section 22, Township 3 South, Range 2 West, Salt Lake Base and Meridian and running thence North 12°53'12" East 182.918 feet to the point of terminus.

Contains: (approx. 183 L.F.)

**(Line 6)**

A twenty (20) foot wide sanitary sewer easement, located in the Southeast Quarter of Section 22, Township 3 South, Range 2 West, Salt Lake Base and Meridian, U.S. Survey, said easement extending ten (10) feet on each side of and lying parallel and adjacent to a line of reference and projection thereof, more particularly described as follows:

Beginning at a point that lies South 89°56'37" East 3225.877 feet along the Daybreak Baseline Southwest (Being South 89°56'37" East 10583.405 feet between the Southwest Corner of Section 22, T3S, R2W and the Southeast Corner of Section 23, T3S, R2W) and North 163.110 feet from the Southwest Corner of Section 22, Township 3 South, Range 2 West, Salt Lake Base and Meridian and running thence South 85°22'16" West 106.338 feet; thence South 14.642 feet; thence

West 116.000 feet; thence North 100.068 feet to the point of terminus.

Contains: (approx. 337 L.F.)

**(Line 7)**

A twenty (20) foot wide sanitary sewer easement, located in the Southeast Quarter of Section 22, Township 3 South, Range 2 West, Salt Lake Base and Meridian, U.S. Survey, said easement extending ten (10) feet on each side of and lying parallel and adjacent to a line of reference and projection thereof, more particularly described as follows:

Beginning at a point that lies South  $89^{\circ}56'37''$  East 3232.987 feet along the Daybreak Baseline Southwest (Being South  $89^{\circ}56'37''$  East 10583.405 feet between the Southwest Corner of Section 22, T3S, R2W and the Southeast Corner of Section 23, T3S, R2W) and North 121.998 feet from the Southwest Corner of Section 22, Township 3 South, Range 2 West, Salt Lake Base and Meridian and running thence North  $09^{\circ}48'37''$  West 41.730 feet; thence North  $02^{\circ}19'09''$  West 151.707 feet to the South Line of Skip Rock Road and the point of terminus.

Contains: (approx. 193 L.F.)

**(Line 8)**

A twenty (20) foot wide sanitary sewer easement, located in the Southeast Quarter of Section 22, Township 3 South, Range 2 West, Salt Lake Base and Meridian, U.S. Survey, said easement extending ten (10) feet on each side of and lying parallel and adjacent to a line of reference and projection thereof, more particularly described as follows:

Beginning at a point that lies South  $89^{\circ}56'37''$  East 3516.464 feet along the Daybreak Baseline Southwest (Being South  $89^{\circ}56'37''$  East 10583.405 feet between the Southwest Corner of Section 22, T3S, R2W and the Southeast Corner of Section 23, T3S, R2W) and North 297.695 feet from the Southwest Corner of Section 22, Township 3 South, Range 2 West, Salt Lake Base and Meridian and running thence North  $02^{\circ}52'17''$  West 38.509 feet to the South Line of Skip Rock Road and the point of terminus.

Contains: (approx. 39 L.F.)

XREFS:  
 \\00182 Daybreak\Cadd\Survey\Master\VT11AP6\Exhibit\_2020-08-19\_VT11AP6 sewer easements.dwg, 8/19/2020 11:43:18 AM, DWG To PDF.pc3

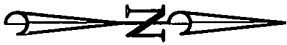
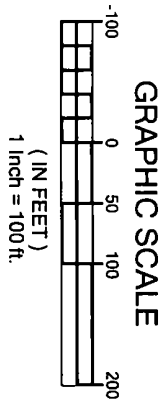
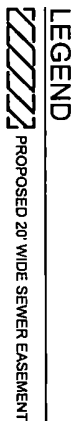
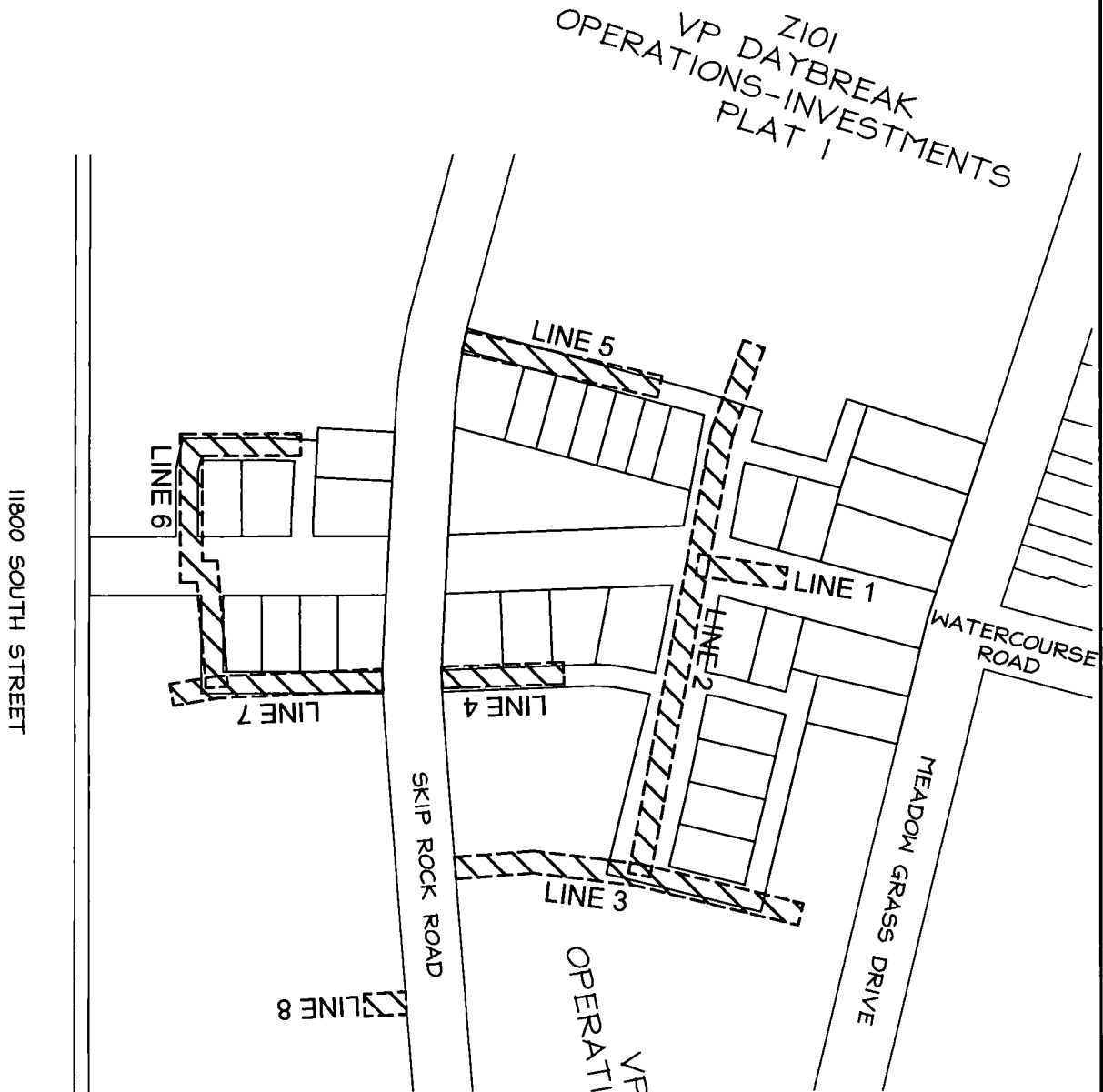

SHEET NUMBER 000000	DATE: _____ TIME: _____ NETWORK: PATH: DWG NAME: LAYOUT: DESIGNER: _____ MGR: _____	 <b>PERIGEE CONSULTING</b> CIVIL • STRUCTURAL • SURVEY <small>2620 NORTH 98th WEST, SUITE 100                  OLYMPIA WA 98512 TEL: 360.882.2222 FAX: 360.882.2223                  WEST JORDAN, UT 84086                  WWW.PERIGEECONSULTING.COM</small>	<b>EXHIBIT A</b> SEWER EASEMENTS DAYBREAK VILLAGE 11A PLAT 6	PREPARED FOR: DAYBREAK COMMUNITIES      DATE SUBMITTED: 08-19-2020
	JCB 08/19/20			

**LENDER'S CONSENT AND SUBORDINATION**

EASEMENT –PARCEL I.D. #26-22-451-001-0000, 26-22-452-001-0000  
DAYBREAK VILLAGE 11A PLAT 6  
(TO SOUTH VALLEY SEWER DISTRICT)

THE UNDERSIGNED, THE BENEFICIARY UNDER THAT CERTAIN DEED OF TRUST, DATED Dec 19, 2019, ENCUMBERING THE HEREIN DESCRIBED REAL PROPERTY (THE "DEED OF TRUST"), HEREBY EXPRESSLY CONSENTS TO AND JOINS IN THE EXECUTION AND RECORDING OF THAT CERTAIN SEWER EASEMENT, DATED AS OF SEPTEMBER 1, 2020, FROM VP DAYBREAK DEVCO LLC, A DELAWARE LIMITED LIABILITY COMPANY, TO SOUTH VALLEY SEWER DISTRICT, A BODY POLITIC OF THE STATE OF UTAH (THE "EASEMENT"), TO WHICH THIS LENDER'S CONSENT AND SUBORDINATION IS ATTACHED.

THE UNDERSIGNED LENDER HEREBY CONSENTS TO THE EASEMENT AND MAKES THE LIEN OF THE DEED OF TRUST SUBORDINATE THERETO. THIS LENDER'S CONSENT AND SUBORDINATION SHALL NOT OTHERWISE AFFECT THE PRIORITY OF MORTGAGES AND/OR LIENS AGAINST THE REAL PROPERTY DESCRIBED HEREIN, BUT SHALL SOLELY EVIDENCE THE LENDER'S INTENT TO SUBORDINATE ITS LIEN OF THE DEED OF TRUST TO THE EASEMENT. THE UNDERSIGNED REPRESENTS THAT HE OR SHE HAS FULL POWER AND AUTHORITY TO EXECUTE THIS LENDER'S CONSENT AND SUBORDINATION ON BEHALF OF THE LENDER.

**U.S. BANK NATIONAL ASSOCIATION**  
d/b/a Housing Capital Company

By: Rhonda Harold  
Name: Rhonda Harold  
Title: Vice President

[SIGNATURE MUST BE NOTARIZED]  
[Notary acknowledgement on following page]

ACKNOWLEDGMENT

A notary public or other officer completing this certificate verifies only the identity of the individual who signed the document to which this certificate is attached, and not the truthfulness, accuracy, or validity of that document.

STATE OF CALIFORNIA

COUNTY OF FRESNO

On August 31, 2020, before me, **Lori Beckman, a Notary Public**, personally appeared **Rhonda Harold** who proved to me on the basis of satisfactory evidence to be the person(s) whose name(s) is/are subscribed to the within instrument and acknowledged to me that he/she/they executed the same in his/her/their authorized capacity(ies), and that by his/her/their signature(s) on the instrument the person(s), or the entity upon behalf of which the person(s) acted, executed the instrument.

I certify under PENALTY OF PERJURY under the laws of the State of California that the foregoing paragraph is true and correct.

WITNESS my hand and official seal.

Signature 

[SEAL]

