

When Recorded Return to:
 Mr. Craig L. White
 South Valley Sewer District
 P.O. Box 908
 Draper, Utah 84020

10424955
 05/12/2008 09:47 AM \$25.00
 Book - 9605 Pg - 4418-4421
 GARY W. OTT
 RECORDER, SALT LAKE COUNTY, UTAH
 SOUTH VALLEY SEWER DISTRICT
 PO BOX 908
 DRAPER UT 84020
 BY: SLR, DEPUTY - WI 4 P.

PARCEL I.D.# 26-24-400-009, 27-19-100-006
GRANTOR: Kennecott Land Residential Development Company
 (Daybreak Apartments Venture #1)
 Page 1 of 4

EASEMENTS

Twenty (20) foot wide sanitary sewer easements located in the East half of 24, Township 3 South, Range 2 West, Salt Lake Base and Meridian, U.S. Survey.

For the sum of One Dollar (\$1.00) and other good and valuable consideration, the receipt and sufficiency of which is hereby acknowledged, the undersigned as GRANTORS hereby grant, convey, sell, and set over unto South Valley Sewer District, a body politic of the State of Utah, hereinafter referred to as GRANTEE, its successors and assigns, perpetual rights-of-way and easements to construct, maintain, operate, repair, inspect, protect, install, remove and replace sewer pipelines, valves, valve boxes and other sewer transmission and distribution structures and facilities, hereinafter called the FACILITIES, said rights-of-way and easements, being situate in Salt Lake County, State of Utah, over and through a parcel(s) of the GRANTORS' land lying within strips twenty (20) feet wide, said strips extending ten (10) feet on each side of and lying parallel and adjacent to lines of reference and projection thereof, more particularly described as follows:

(Line 1)

Commencing at the Southeast Corner of Section 24, Township 3 South, Range 2 West, Salt Lake Base & Meridian (basis of bearing being North 89°58'42" West - 2677.868 feet between the Southeast Corner and the South Quarter Corner of said Section 24) and running North 89°58'42" West along the south line of said Section 24 for 344.680 feet; thence North 00°01'18" East perpendicular to said section line for 3207.607 feet to the POINT OF BEGINNING; thence North 35°49'08" West for 143.24 feet; thence North 36°32'54" West for 378.25 feet to the END of said centerline.

(Line 2)

Also commencing at the Southeast Corner of Section 24, Township 3 South, Range 2 West, Salt Lake Base & Meridian (basis of bearing being North 89°58'42" West - 2677.868 feet between the Southeast Corner and the South Quarter Corner of said Section 24) and running North 89°58'42" West along the south line of said Section 24 for 428.550 feet; thence North 00°01'18" East perpendicular to said section line for 3323.722 feet to the POINT OF BEGINNING; thence North 53°27'06" East for 71.50 feet to the END of said centerline.

(Line 3)

Also commencing at the Southeast Corner of Section 24, Township 3 South, Range 2 West, Salt Lake Base & Meridian (basis of bearing being North 89°58'42" West – 2677.868 feet between the Southeast Corner and the South Quarter Corner of said Section 24) and running North 89°58'42" West along the south line of said Section 24 for 1289.679 feet; thence North 00°01'18" East perpendicular to said section line for 3071.810 feet to the POINT OF BEGINNING; thence North 53°27'06" East for 922.22 feet to the END of said centerline.

(Line 4)

Also commencing at the Southeast Corner of Section 24, Township 3 South, Range 2 West, Salt Lake Base & Meridian (basis of bearing being North 89°58'42" West – 2677.868 feet between the Southeast Corner and the South Quarter Corner of said Section 24) and running North 89°58'42" West along the south line of said Section 24 for 1628.448 feet; thence North 00°01'18" East perpendicular to said section line for 2820.491 feet to the POINT OF BEGINNING; thence North 53°27'06" East for 343.55 feet to the END of said centerline.

(Line 5)

Also commencing at the Southeast Corner of Section 24, Township 3 South, Range 2 West, Salt Lake Base & Meridian (basis of bearing being North 89°58'42" West – 2677.868 feet between the Southeast Corner and the South Quarter Corner of said Section 24) and running North 89°58'42" West along the south line of said Section 24 for 1207.638 feet; thence North 00°01'18" East perpendicular to said section line for 2266.683 feet to the POINT OF BEGINNING; thence North 53°27'06" East for 74.74 feet; thence North 38°41'06" West for 395.27 feet; thence North 36°32'54" West for 366.00 feet to the END of said centerline.

(Line 6)

Also commencing at the Southeast Corner of Section 24, Township 3 South, Range 2 West, Salt Lake Base & Meridian (basis of bearing being North 89°58'42" West – 2677.868 feet between the Southeast Corner and the South Quarter Corner of said Section 24) and running North 89°58'42" West along the south line of said Section 24 for 1053.037 feet; thence North 00°01'18" East perpendicular to said section line for 2381.375 feet to the POINT OF BEGINNING; thence North 53°27'06" East for 859.00 feet to the END of said centerline.

(Line 7)

Also commencing at the Southeast Corner of Section 24, Township 3 South, Range 2 West, Salt Lake Base & Meridian (basis of bearing being North 89°58'42" West – 2677.868 feet between the Southeast Corner and the South Quarter Corner of said Section 24) and running North 89°58'42" West along the south line of said Section 24 for 728.880 feet; thence North 00°01'18" East perpendicular to said section line for 2716.485 feet to the POINT OF BEGINNING; thence North 53°27'06" East for 356.87 feet to the END of said centerline.

(Line 8)

Also commencing at the Southeast Corner of Section 24, Township 3 South, Range 2 West, Salt Lake Base & Meridian (basis of bearing being North 89°58'42" West – 2677.868 feet between the Southeast Corner and the South Quarter Corner of said Section 24) and running North 89°58'42" West along the south line of said Section 24 for 683.592 feet; thence North 00°01'18" East perpendicular to said section line for 2655.452 feet to the POINT OF BEGINNING; thence North 36°33'00" West for 351.75 feet to the END of said centerline.

Contains: 1.957 acres (approx. 4262.39 l.f.)

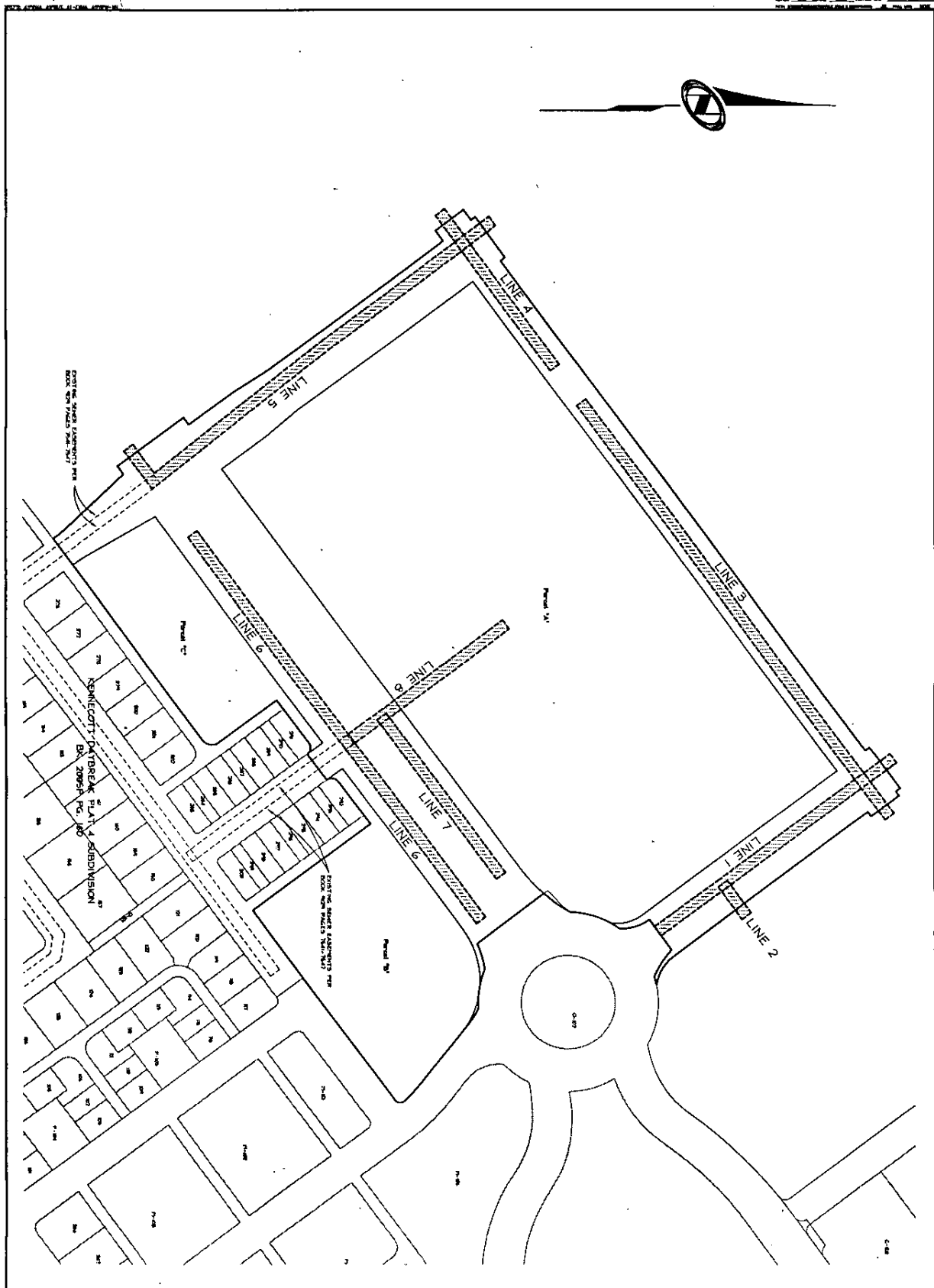

NOLTE
 BEYOND ENGINEERING
 820 SOUTH STATE STREET, SUITE 600
 BURLINGTON, VT 05401-1000 FAX 802-249-1000

EXHIBIT
 SEWER EASEMENTS
 KENNECOTT DAYBREAK APARTMENT VENTURE #1
 PREPARED FOR: KENNECOTT LAND CO. DATE SUBMITTED: MAY 2008

NO.	DATE	DESCRIPTION