

OLD BRAND EXCAVATING LLC
RETURNED BRAND EXCAVATING
SEP 13 2006

E 2201201 B 4116 P 187-189
RICHARD T. MAUGHAN
DAVIS COUNTY, UTAH RECORDER
09/13/2006 09:47 AM
FEE \$15.00 Pgs: 3
DEP RT REC'D FOR JACK D PALMER

SW 20-4N-1W

July 18, 2006

10-230-0009

10-230-0007

Drive Access Easement

TO WHOM IT MAY CONCERN:

We, Jack D. Palmer, of Old Brand Excavating, LLC, and Greg Williams, of Eagle Industrial Park, do mutually consent to the common use of the driveway to our separate properties per the attached drawing, and the attached description.

The use of this driveway for access to either of the two property shall not in anyway be a cause of any concern to either of the current owners nor to any subsequent owners at a later date.

Signed this 25 day of July, 2006.

Notary Public:

Krista Arrin Morris
My commission expires 05-03-08



Signed:

Jack D. Palmer
Jack D. Palmer, Vice President
Old Brand Excavating, LLC

Signed:

Greg Williams
Greg Williams
Eagle Enterprises



ENSIGN ENGINEERING AND LAND SURVEYING

1485 W HILL FIELD ROAD, SUITE 204

LAYTON, UT 84041

801.547.1100

801.593.6315F

DRIVE ACCESS EASEMENT

Beginning on the east line of Sugar Street, said point being North 89°53'10" East 423.24 feet along the section line and North 00°13'10" East 879.09 feet from the Southwest Corner of Section 20, Township 4 North, Range 1 West, Salt Lake Base and Meridian and running;

thence North 00°13'10" East 44.77 feet along the east line of Sugar Street;

thence North 89°54'40" East 97.79 feet;

thence South 00°13'10" West 44.77 feet;

thence South 89°54'40" West 97.79 feet to the east line of Sugar Street and the point of beginning.

Contains: 4,378 square feet. 0.10 acres.

7/12/06

L1540

RMKB

F:\L1540\docs\access easement.doc

Drive Access Easement
7/12/06 Scale 1" = 20'

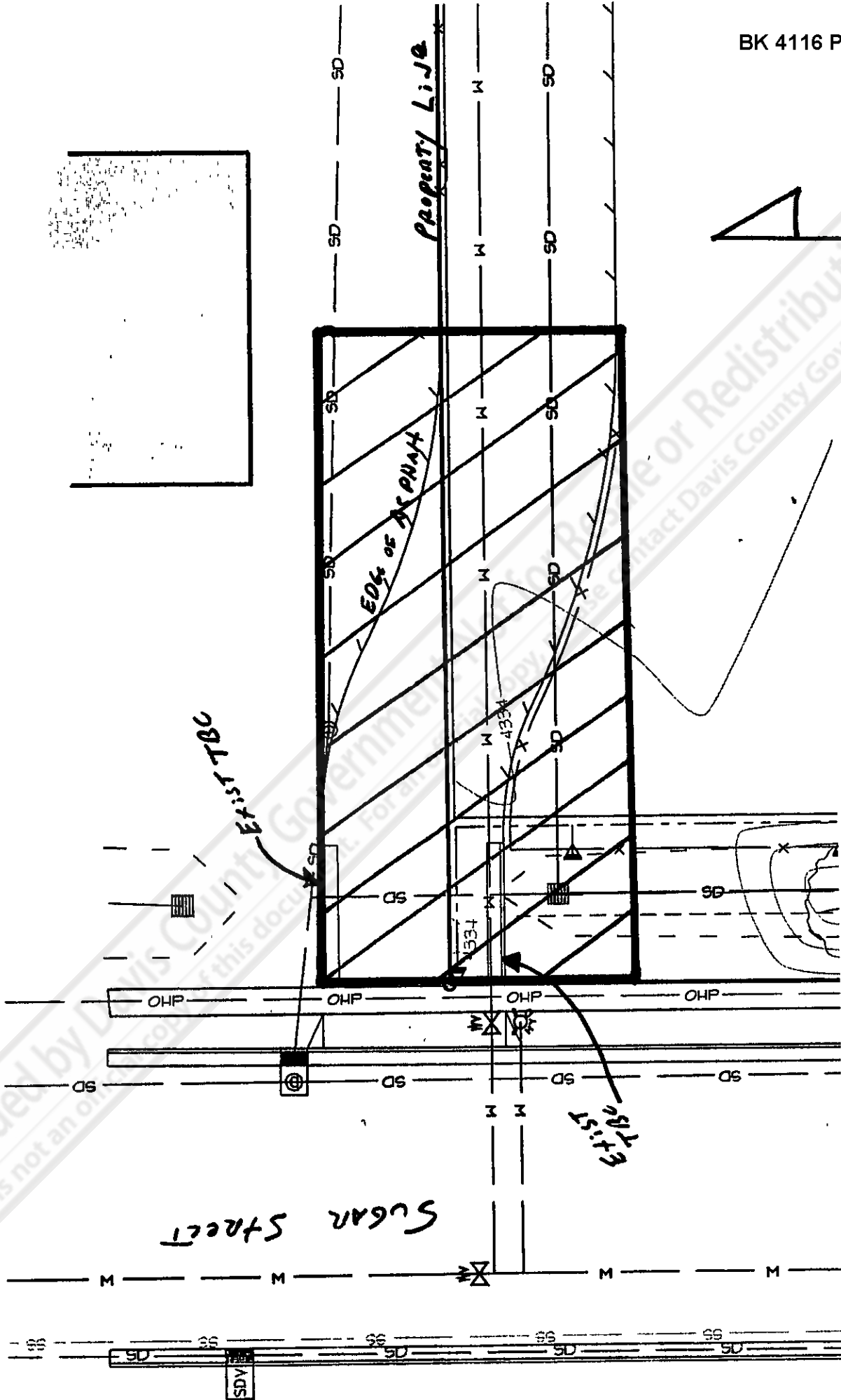

Provided by Davis County Government
 This is not an official record. For more information, please contact Davis County Government.