

When Recorded, Return to:

John N. Brems
PARSONS KINGHORN HARRIS, P.C.
111 East Broadway, 11th Floor
Salt Lake City, UT 84111

9414413
06/24/2005 03:39 PM \$0.00
Book - 9149 Pg - 8989-8992
GARY W. OTT
RECORDER, SALT LAKE COUNTY, UTAH
TAYLORSVILLE CITY
2600 TAYLORSVILLE BLVD
TAYLORSVILLE UT 84118-2208
BY: SEM, DEPUTY - WI 4 P.

Permanent/Perpetual Right-of-Way Easement

Granite School District, whose address is 340 East 3545 South, Salt Lake City 84115 (property address 5225 South Redwood Road, Taylorsville, Utah 84123), Grantors, hereby grant and convey to the **CITY OF TAYLORSVILLE**, a Utah municipality whose address is 2600 West Taylorsville Boulevard, Taylorsville, UT 84118, Grantee, for the sum of TEN DOLLARS and other good and valuable consideration, a permanent/perpetual right-of-way easement over, across, under and through the property described below for the purpose of access, construction, maintenance, repair, replacement and modification of irrigation, power and other utilities, and street improvements, sidewalks and curb and gutter as part of the improvements incidental to Redwood Road (SR 68), known as Redwood Road Mobility and Beautification Enhancement Project. The property is described as follows:

A portion of that certain parcel of land recorded as parcel number 21:10:451:003:000 at the office of the Salt Lake County Recorder, said portion being described as follows:

Beginning at a point on the east line of Redwood Road which is NORTH 291.07 feet and EAST 53.99 feet from the North quarter corner of Section 15, Township 2 South, Range 1 West, Salt Lake Base and Meridian; thence South 16°41'53" East 25.26 feet; thence South 00°00'02" West 70.35 feet; thence South 13°35'17" West 32.70 feet to the east line of Redwood Road; thence North 00°11'40" East 126.33 feet along said line to the point of beginning.

Containing 733.56 square feet more or less.

Basis of bearing: The section line between the North quarter corner of Section 15 and the Center quarter corner of said section bears South 00°11'40" West.

Subject to recorded or unrecorded easements or rights-of-way, if any, which have been established and now may exist by operation of law upon said land, or any portion thereof.

Together with the right of ingress and egress from adjacent real property of Grantor to and from said easement.

City of Taylorsville as a condition of obtaining this right-of-way shall pay damages, restore or replace in kind, Grantor's improvements in the event such are damaged by construction, maintenance, repair, or replacement of the Redwood Road Mobility and

Beautification Enhancement Project.

Grantor shall not build or construct, nor permit to be built or constructed, any building or other similar improvements over, across or under said right-of-way nor change the contour thereof.

This right-of-way shall be binding upon Grantor, his successor and assigns, and shall inure to the benefit of the City of Taylorsville, its successors and assigns, and may be assigned in whole or in part by the City of Taylorsville.

It is hereby understood that any party obtaining this right-of-way is without authority to make any representations, covenants or agreements not herein expressed.

DATED this 15 day of June, 2005.

GRANTORS:

Patricia G. Sandstrom
Patricia G. Sandstrom, President

David F. Garrett
David F. Garrett, Business Administrator/Treasurer

STATE OF UTAH)
 ss:
COUNTY OF SALT LAKE)

Personally appeared before me, the undersigned Notary Public, Patricia G. Sandstrom and David F. Garrett grantors, who signed the foregoing in my presence this 15 day of June, 2005.

My Commission Expires:
June 23, 2008

Karen K. Westover
Notary Public
Residing at: Salt Lake County

JNB\TV1017-1

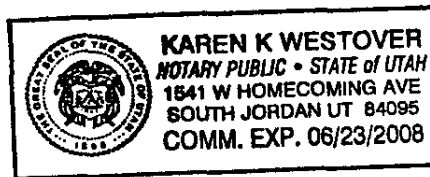
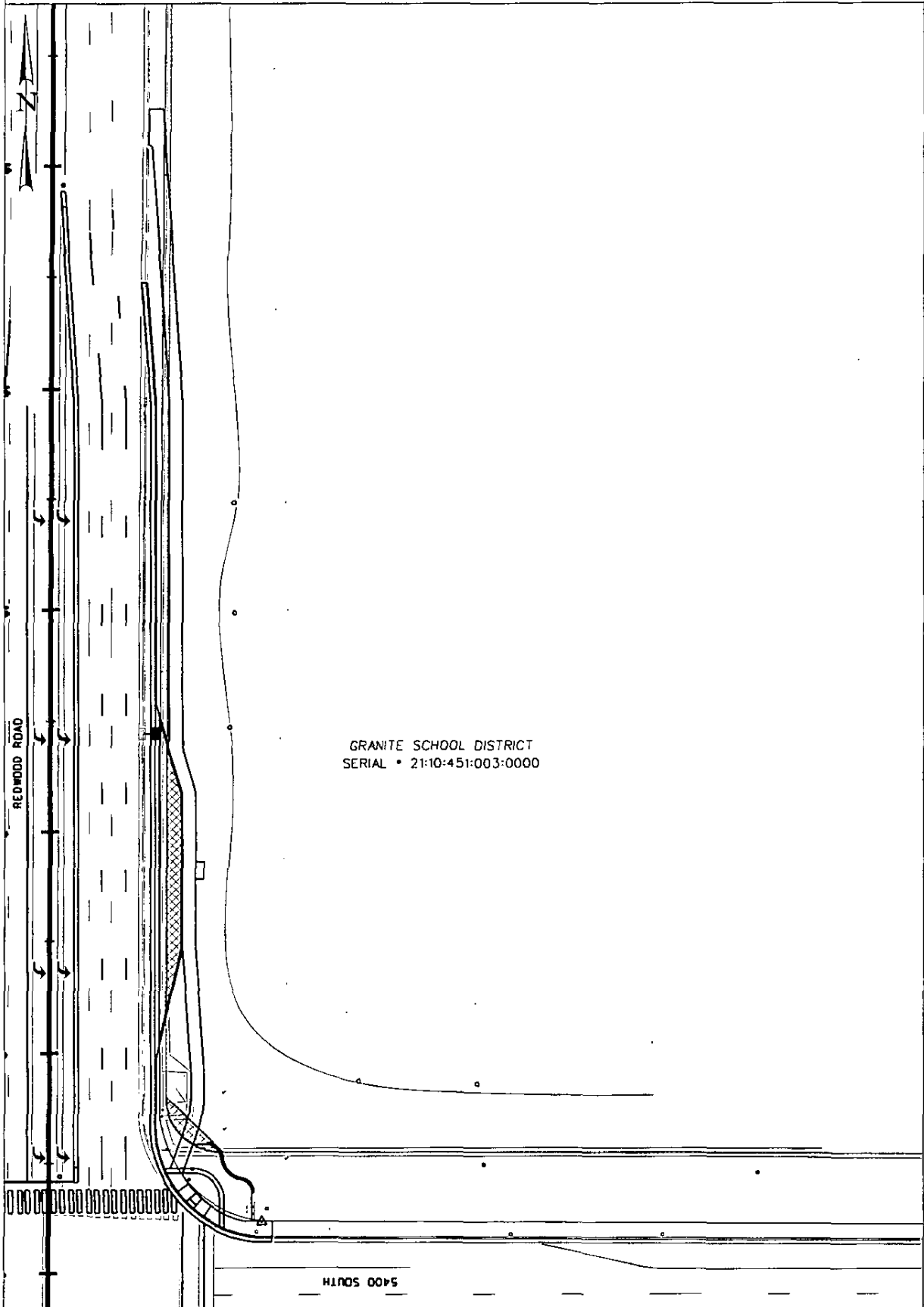

EXHIBIT D



REDWOOD ROAD BEAUTIFICATION - TAYLORSVILLE CITY

SCALE 1:60

Granite School District (right-of-way description)

A portion of that certain parcel of land recorded as parcel number 21:10:451:003:000 at the office of the Salt Lake County Recorder, said portion being described as follows:

Beginning at a point on the east line of Redwood Road which is NORTH 291.07 feet and EAST 53.99 feet from the North quarter corner of Section 15, Township 2 South, Range 1 West, Salt Lake Base and Meridian; thence South $16^{\circ}41'53''$ East 25.26 feet; thence South $00^{\circ}00'02''$ West 70.35 feet; thence South $13^{\circ}35'17''$ West 32.70 feet to the east line of Redwood Road; thence North $00^{\circ}11'40''$ East 126.33 feet along said line to the point of beginning.

Containing 733.56 square feet more or less.

Basis of bearing: The section line between the North quarter corner of Section 15 and the Center quarter corner of said section bears South $00^{\circ}11'40''$ West.

Subject to recorded or unrecorded easements or rights-of-way, if any, which have been established and now may exist by operation of law upon said land, or any portion thereof.