

ENTRY NO. 01001495

08/25/2014 03:16:34 PM B: 2254 P: 0304

Notice PAGE 1/4

MARY ANN TRUSSELL, SUMMIT COUNTY RECORDER

FEE 30.00 BY ROSS PACE



When recorded return to:

Jonathan R. Schutz
175 S. Main St., Suite 1330
Salt Lake City, UT 84111

PARCEL #: NS-551-A; NS-552-E; NS-552-F; NS-548-X; NS-565; NS567-A-1; NS-527; NS-525; NS-530-2; NS-528-A-1; NS-526-A; NS-526; SCES-A; NS-517-D; RWR-4

NOTICE OF EASEMENT

Pursuant to Utah Code Ann. section 57-13a-103, **Hoytsville Irrigation Company**, a Utah Non-profit corporation, hereby files notice that it possesses a prescriptive easement for ownership, use, operation, and maintenance of water conveyance facilities, including an access and maintenance road adjacent to the water conveyance facilities. The easement was established as provided by Utah Code Ann. Section 57-13a-102. The easement extends 20 feet to the west side and 20 feet to the east side of the centerline of the water conveyance facilities; the center line is described as follows:

SEE ATTACHED EXHIBIT A

Hoytsville Irrigation Company claims unobstructed use and occupation of the 40 feet wide easement to own, use, operate, and maintain the water conveyance facilities, including an access and maintenance road adjacent to the water conveyance facilities.

Dated this 22 day of Aug, 2014.

HOYTSVILLE IRRIGATION COMPANY

By Ross Pace

Printed Name Ross Pace

Title: President

By ~~Blaine J. Rees~~

Printed Name Blaine J. Rees

Title: Secretary

State of Utah)
) ss.
County of Summit)

The foregoing Easement was acknowledged and executed before me this 22nd day of August, 2014, by Ross Pace.

IN WITNESS WHEREOF, I have hereunto set my hand and affixed my official seal the day and year first above written.



Notary Public
Residing at: Marion UT

State of Utah)
) ss.
County of Summit)

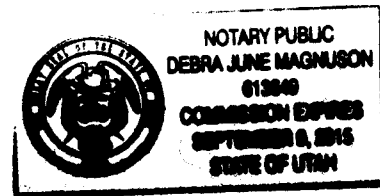

The foregoing Easement was acknowledged and executed before me this 22nd day of August, 2014, by Blaine Rees.

IN WITNESS WHEREOF, I have hereunto set my hand and affixed my official seal the day and year first above written.

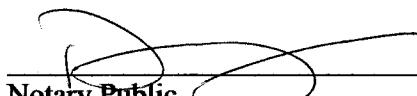

Notary Public
Residing at: Marion UT

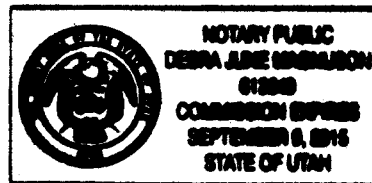

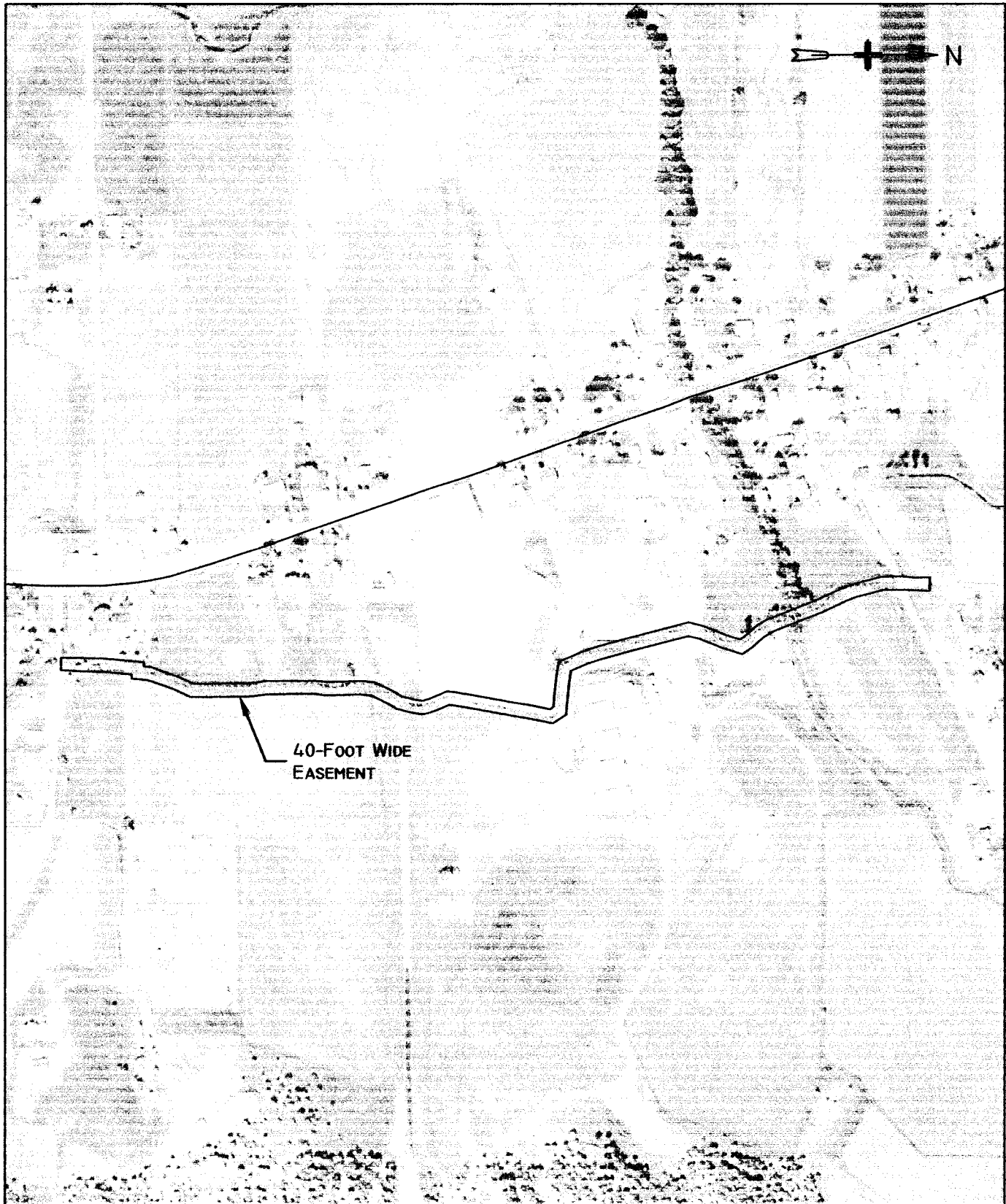

40-FOOT WIDE
EASEMENT



PROJECT LEADER: LAYNE JENSEN
 DRAFTSMAN: CONNA ROHBOCK
 DATE: FEBRUARY 4, 2013
 E Hoytsville Canal.dwg
 H:\CLIENTS\Wasatch-Weber Area\East Hoytsville\5 -
 Drawings\Canal CL Easements
 LAYOUT: E Hoytsville Canal Easement

NORTH SUMMIT PRESSURIZED IRRIGATION COMPANY
 NORTH SUMMIT
 PRESSURIZED IRRIGATION SYSTEM

EXHIBIT A
 EAST HOYTSVILLE
 CANAL EASEMENT

Exhibit A

Canal Centerline Easement – East Hoytsville Canal

Legal Description along the East Hoytsville Canal Centerline for a 40-foot wide easement. Said easement being 20 feet from each side of canal centerline. Said canal crosses Parcels: NS-551-A; NS-552-E; NS-552-F; NS-548-X; NS-565; NS567-A-1; NS-527; NS-525; NS-530-2; NS-528-A-1; NS-526-A; NS-526; SCES-A; NS-517-D; RWR-4

Said centerline more particularly described as follows:

Beginning at a point located 1074.11 feet North and 492.52 feet East from the southeast corner of Section 28, Township 2 North, Range 5 East, Salt Lake Base & Meridian; thence N 11° 55' 37" E 83.92 feet; thence N 05° 02' 47" E 249.13 feet; thence N 17° 42' 16" 222.20 feet; thence N 01° 47' 41" E 206.87 feet; thence N 05° 49' 10" W 198.10 feet; thence N 04° 42' 34" E 133.46 feet; thence N 07° 52' 50" W 86.59 feet; thence N 23° 28' 28" E 158.16 feet; thence N 08° 08' 20" E 96.77 feet; thence N 11° 46' 29" W 102.98 feet; thence N 10° 35' 05" E 372.98 feet; thence N 35° 01' 08" W 44.56 feet; thence N 81° 19' 42" W 175.49 feet; thence N 27° 47' 49" W 115.52 feet; thence N 06° 17' 53" W 133.10 feet; thence N 14° 16' 59" W 229.96 feet; thence N 10° 25' 33" E 95.03 feet; thence N 19° 13' 43" E 105.32 feet; thence N 32° 54' 06" W 126.06 feet; thence N 22° 31' 50" W 228.77 feet; thence N 41° 35' 41" W 75.64 feet; thence N 08° 31' 16" W 154.07 feet; thence N 17° 23' 04" W 87.27 feet to end of East Hoytsville Canal Centerline.