

Please return to: **9844866**
Dianne H. Aubrey, MMC
Sandy City Recorder
10000 Centennial Parkway
Sandy, Utah 84070

9844866
09/14/2006 02:07 PM \$0.00
Book - 9350 Pg - 9559-9562
GARY W. OTT
RECORDER, SALT LAKE COUNTY, UTAH
SANDY CITY
10000 CENTENNIAL PARKWAY
SANDY UT 84070
BY: NEH, DEPUTY - MA 4 P.
10000 Centennial Parkway

STREET CLOSURE - UNION PARK AVENUE

ORDINANCE #06-26

AN ORDINANCE MODIFYING THE OFFICIAL STREET MAP OF SANDY CITY BY CLOSING A PORTION OF THE EAST SIDE OF UNION PARK AVENUE, BUT NOT CLOSING/VACATING ANY UTILITY EASEMENTS, RIGHTS-OF-WAY OR DEDICATIONS BY USE LOCATED THEREIN; ALSO ESTABLISHING AN EFFECTIVE DATE.

BE IT KNOWN AND REMEMBERED that the City Council of Sandy City, State of Utah finds and determines as follows:

WHEREAS, the City Council has been granted specific authority to regulate, plan and establish public streets within Sandy City and may amend such regulations and plans or close/vacate a street according to the provisions of Sections 10-8-8, 10-8-8.5 and 10-9a-607 through 10-9a-611, Utah Code Annotated 1953; and

WHEREAS, a modification to the official street map has been proposed to close a portion of the east side of Union Park Avenue; and

WHEREAS, the Planning Commission of Sandy City held a public hearing on April 6, 2006 at which it considered said proposal, which meeting was preceded by notice posted in Sandy City Hall, Sandy Parks & Recreation, Sandy Library and Salt Lake Community College on February 21, 2006 and published in the Salt Lake Tribune on March 8, 15, 22 and 29, 2006; and

WHEREAS, the Planning Commission of Sandy City held an additional public hearing on May 18, 2006 at which it further considered said proposal, which meeting was preceded by notice posted in Sandy City Hall, Sandy Parks & Recreation, Sandy Library and Salt Lake Community College on April 13, 2006 and published in the Salt Lake Tribune on April 19 and 26, May 3 and May 10, 2006; and

WHEREAS, the City Council held a public hearing on August 8, 2006 to consider said proposal; and

WHEREAS, the hearing was preceded by public notice, posted in Sandy City Hall, Sandy Parks & Recreation, Sandy Library and Salt Lake Community College on June 28, 2006 and published in the Salt Lake Tribune on July 3, 10, 17 and 24, 2006; and

WHEREAS, the closure of a portion of the east side of Union Park Avenue is in the best interest of the health, safety and welfare of the City's residents; and

WHEREAS, the City Council has determined that there is good cause for closure of said street and that such closure will not be detrimental to the general interest.

NOW, THEREFORE, BE IT ORDAINED by the City Council of Sandy, State of Utah, that the Official Street Map of Sandy City is hereby modified by closing a portion of the east side of Union Park Avenue, but not closing/vacating any utility easements, rights-of-way or dedications by use located therein. Such closure is described in Exhibit A and shown on Exhibit B, which exhibits are attached hereto and by this reference made a part hereof.

Section 2: All former ordinances or parts thereof conflicting or inconsistent with the provisions of this ordinance hereby adopted are hereby repealed.

Section 3. The provisions of this ordinance shall be severable; and if any provision thereof, or the application of such provision under any circumstances is held invalid, it shall not affect any other provision of this ordinance, or the application in a different circumstance.

Section 4. This ordinance shall become effective upon its publication of a summary thereof.

PASSED AND APPROVED by the Sandy City Council this 5th day of September, 2006.

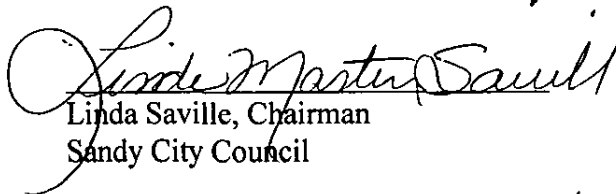
Linda Saville, Chairman
Sandy City Council

PRESENTED to the Mayor of Sandy City for his approval this 6 day of September, 2006.

APPROVED by the Mayor of Sandy City this 7 day of September, 2006.

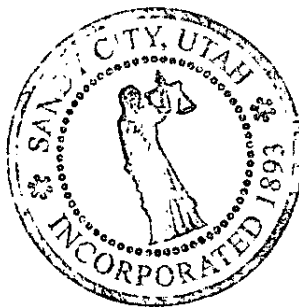

Thomas M. Dolan

ATTEST:

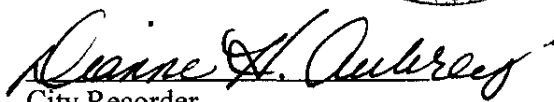

City Recorder

RECORDED this 7 day of September 2006.

SUMMARY PUBLISHED this 12 day of September 2006.

DESCRIPTION OF A PORTION OF UNION PARK AVENUE PROPOSED TO BE CLOSED BY SANDY CITY CONTAINING 0.397 ACRE

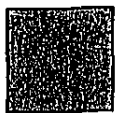
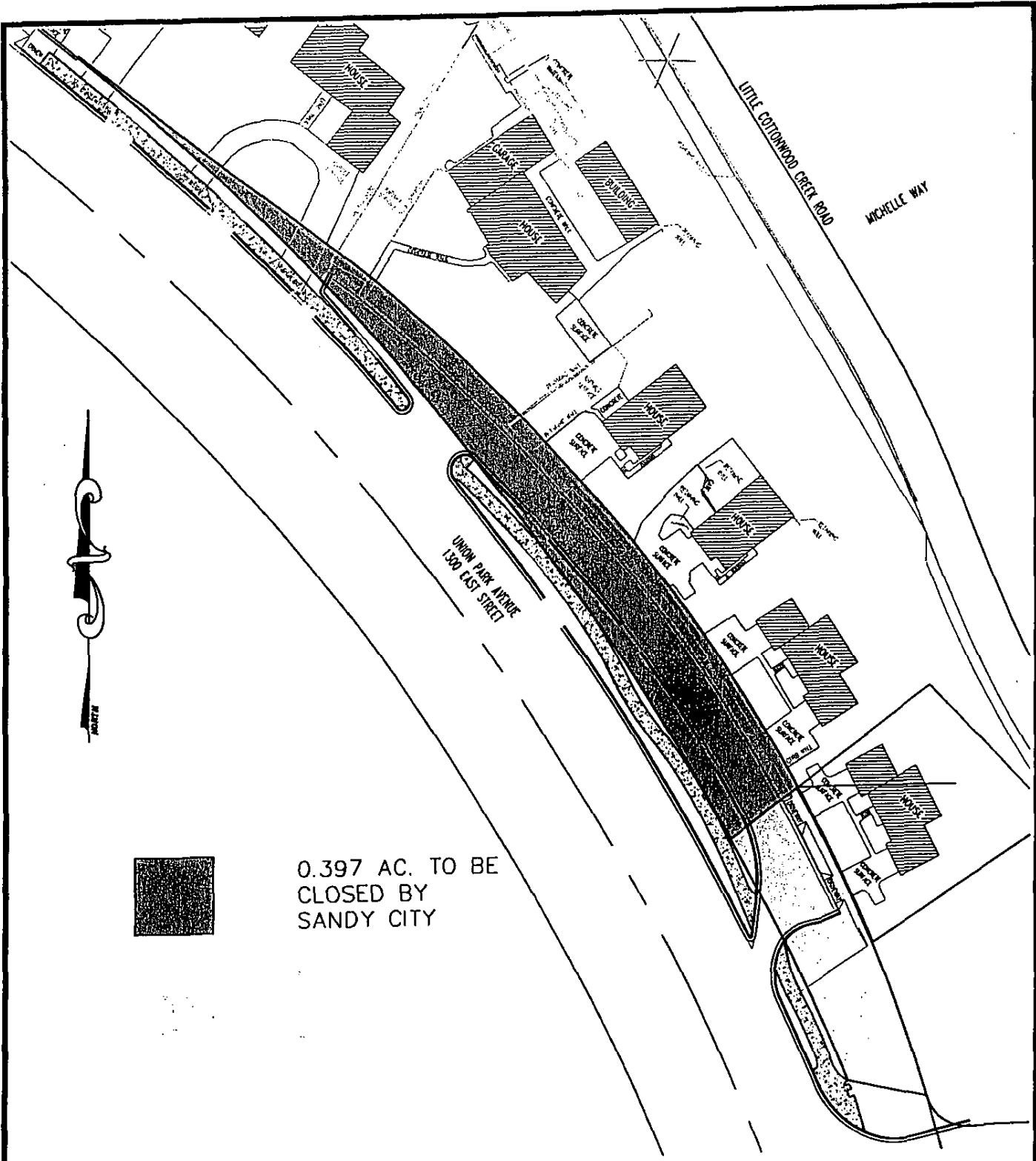
Beginning at a point on the current northeasterly right-of-way line of Union Park Avenue (1300 East Street), an existing public street, as determined by that certain survey performed by McNeil Engineering and Land Surveying, dated July 15, 2004, found as file number S2004121006 in the office of the Salt Lake County Surveyor, said point being on the arc of a 988.363 foot radius curve the center of which bears South 61°30'29" West, said point also lies North 0°07'04" East 598.013 feet along the section line and West 91.481 feet from the Southeast Corner of Section 29, Township 2 South, Range 1 East, Salt Lake Base and Meridian; thence South 53°16'07" West 48.733 feet to the proposed new northeasterly line of said Union Park Avenue; thence along said proposed new northeasterly line, Northwesterly 595.676 feet along the arc of a curve to the left whose center bears South 61°20'38" West 1543.94 feet, has a central angle of 22°06'20" and a chord bearing and length of North 39°42'32" West 591.988 feet; thence North 36°22'04" East 1.077 feet, more or less, to intersect the current northeasterly line of Union Park Avenue as determined by said survey; thence along said northeasterly line the following four (4) courses: (1) South 51°39'56" East 92.650 feet; (2) South 53°25'43" East 97.220 feet; (3) Southeasterly 143.516 feet along the arc of a curve to the right whose center bears South 37°34'00" West 987.930 feet, has a central angle of 8°19'24" and a chord bearing and length of South 48°16'18" East 143.390 feet; (4) Southeasterly 269.209 feet along the arc of a curve to the right whose center bears South 45°54'07" West 988.363 feet, has a central angle of 15°36'22" and a chord bearing and length of South 36°17'42" East 268.377 feet to intersect a northerly line of The Property Trust property according to the description contained in that certain Quit-Claim Deed found as Entry No. 6183656 in Book 7243 at Page 1097 in the office of the Salt Lake County Recorder (the bearings of said description have been rotated 0°02'10" clockwise to the bearing base of this description), and the point of beginning. The above described parcel of land contains 17,299 square feet in area or 0.397 acre.



0.397 AC. TO BE
CLOSED BY
SANDY CITY

PREPARED BY:
NOLAN C. HATHCOCK
SANDY CITY SURVEYOR
8775 S. 700 W.
SANDY, UTAH 84070
PHONE: 801-568-2965
JANUARY 4, 2006
REVISED APRIL 17, 2006

AREAS OF UNION PARK AVENUE
PROPOSED FOR CLOSURE BY
SANDY CITY