

MORGAN COUNTY REINVESTMENT AND RENEWAL AGENCY BOUNDARY PLAT

ORDINANCE NO. CO-17-15
MORGAN COUNTY, UTAH
MARCH 2017

UTAH COUNTY RECORDERS
MORGAN COUNTY RECORDERS
MOUNTAIN VIEW RECORDERS
SALT LAKE COUNTY RECORDERS
ST. GEORGE RECORDERS
TAYLOR RECORDERS
WASATCH RECORDERS
WINTERS RECORDERS



SCALE: 1" = 10,000'

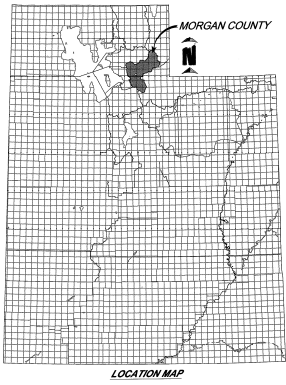
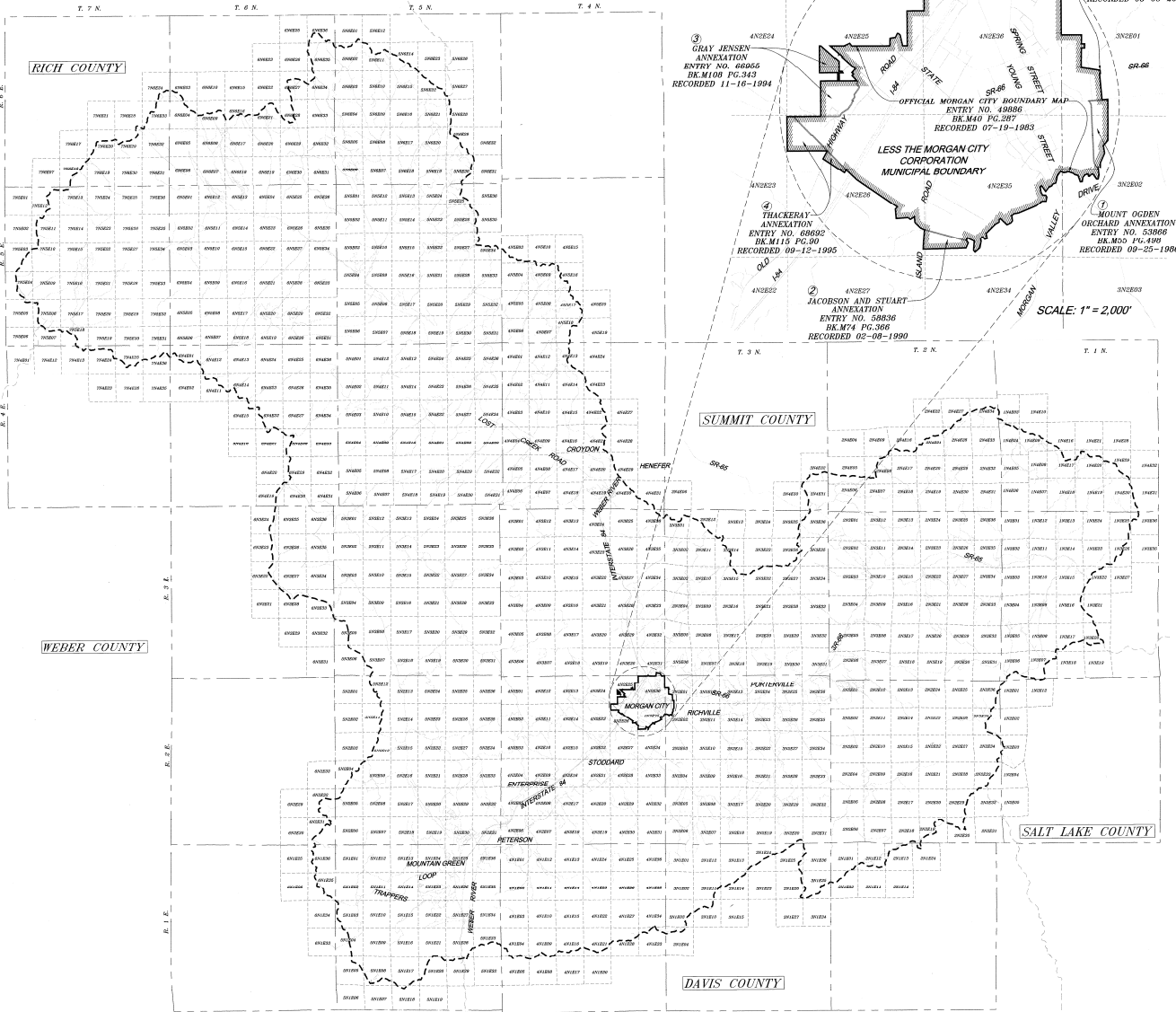

LOCATION MAP

SCALE: 1" = 2,000'

MORGAN COUNTY REINVESTMENT AND RENEWAL AGENCY BOUNDARY DESCRIPTION

THE GEOGRAPHIC BOUNDARIES OF MORGAN COUNTY ARE DESCRIBED AS FOLLOWS:
BEGINNING AT THE POINT ON THE SUMMIT OF THE WASATCH RANGE OF MOUNTAINS NEAREST TO THE EASTERN HEADWATERS OF THE OGDEN RIVER, THENCE SOUTHWESTERLY ALONG THE SUMMIT OF SAID RANGE PASSING SOUTH AROUND THE HEADWATERS OF THE OGDEN RIVER TO THE SUMMIT OF THE MAIN WASATCH RANGE SOUTHWEST OF OGDEN CITY, THENCE SOUTHERLY ALONG THE SUMMIT OF SAID RANGE CROSSING THE WEBER CANYON AND RIVER TO THE SUMMIT OF THE CROSS RANGE THROUGH WHICH THE UPPER CANYON OF EAST CANYON CREEK RUNS; THENCE EASTERLY ALONG THE SUMMIT OF SAID LAST MENTIONED RANGE TO, AND THENCE NORTHERLY ALONG THE SUMMIT OF THE RANGE BETWEEN EAST CANYON CREEK AND THE WEBER RIVER TO THE WEBER RIVER, THENCE NORTHEASTERLY ACROSS SAID RIVER AND ALONG THE SUMMIT OF THE HIGH LAND BETWEEN LOST AND ECHO CANYON CREEKS TO THE SUMMIT OF THE WASHCUT RANGE SEPARATING THE VALLEY OF THE BEAR RIVER FROM THE VALLEY OF THE WEBER RIVER, THENCE NORTHWESTERLY ALONG THE LAST MENTIONED SUMMIT TO THE POINT OF BEGINNING.

LESS THE MORGAN CITY CORPORATION MUNICIPAL BOUNDARY FOR WHICH THE OFFICIAL CITY BOUNDARY MAP WAS RECORDED JULY 19, 1983 AS ENTRY NO. 49886 IN BOOK M40 AT PAGE 287 IN THE MORGAN COUNTY RECORDERS OFFICE, ADDITIONALLY SIX (6) AREAS HAVE BEEN ANNEXED TO THE CORPORATE LIMITS OF MORGAN CITY AND RECORDED IN THE MORGAN COUNTY RECORDERS OFFICE AS FOLLOWS: (1) MOUNT OGDEN ORCHARD ANNEXATION RECORDED SEPTEMBER 25, 1986 AS ENTRY NO. 53886 IN BOOK M00 AT PAGE 498; (2) JACOBSON AND STUART ANNEXATION RECORDED FEBRUARY 8, 1990 AS ENTRY NO. 58683 IN BOOK M74 AT PAGE 366; (3) GRAY JENSEN ANNEXATION RECORDED NOVEMBER 16, 1994 AS ENTRY NO. 88865 IN BOOK M115 AT PAGE 83; (4) THACKERAY ANNEXATION RECORDED SEPTEMBER 12, 1995 AS ENTRY NO. 68692 IN BOOK M115 AT PAGE 90; (5) "RUSSELL ANNEXATION" RECORDED AUGUST 8, 2007 AS ENTRY NO. 85783 IN BOOK M172 AT PAGE 322; (6) GRAY JENSEN ANNEXATION" RECORDED DECEMBER 3, 2007 AS ENTRY NO. 110282 IN BOOK 257 AT PAGE 59.

MORGAN COUNTY BOUNDARY DESCRIPTION AS PER LEUTENANT GOVERNOR'S OFFICE

THE GEOGRAPHIC BOUNDARIES OF MORGAN COUNTY ARE DESCRIBED AS FOLLOWS:
BEGINNING AT THE POINT ON THE SUMMIT OF THE WASATCH RANGE OF MOUNTAINS NEAREST TO THE EASTERN HEADWATERS OF THE OGDEN RIVER, THENCE SOUTHWESTERLY ALONG THE SUMMIT OF SAID RANGE PASSING SOUTH AROUND THE HEADWATERS OF THE OGDEN RIVER TO THE SUMMIT OF THE MAIN WASATCH RANGE SOUTHWEST OF OGDEN CITY, THENCE SOUTHERLY ALONG THE SUMMIT OF SAID RANGE CROSSING THE WEBER CANYON AND RIVER TO THE SUMMIT OF THE CROSS RANGE THROUGH WHICH THE UPPER CANYON OF EAST CANYON CREEK RUNS; THENCE EASTERLY ALONG THE SUMMIT OF SAID LAST MENTIONED RANGE TO, AND THENCE NORTHERLY ALONG THE SUMMIT OF THE RANGE BETWEEN EAST CANYON CREEK AND THE WEBER RIVER TO THE WEBER RIVER, THENCE NORTHEASTERLY ACROSS SAID RIVER AND ALONG THE SUMMIT OF THE HIGH LAND BETWEEN LOST AND ECHO CANYON CREEKS TO THE SUMMIT OF THE WASHCUT RANGE SEPARATING THE VALLEY OF THE BEAR RIVER FROM THE VALLEY OF THE WEBER RIVER, THENCE NORTHWESTERLY ALONG THE LAST MENTIONED SUMMIT TO THE POINT OF BEGINNING.

SURVEYORS CERTIFICATE

I, MATTHEW ABRAM MURKOOK, A LICENSED PROFESSIONAL LAND SURVEYOR AS PRESCRIBED BY THE LAWS OF THE STATE OF UTAH IN ACCORDANCE WITH TITLE 88, CHAPTER 25 AND TITLE 88, CHAPTER 25B AND 88A103, DO HEREBY CERTIFY THAT THIS MAP OF THE MORGAN COUNTY REINVESTMENT AND RENEWAL AGENCY BOUNDARY PLAT WAS MADE UNDER MY DIRECTION AND IN ACCORDANCE WITH SECTION 17-23-30 AND HAS BEEN CORRECTLY SHOWN TO THE RESPECTED SCALE AND IS A TRUE AND CORRECT REPRESENTATION OF THE FOLLOWING DESCRIPTION OF LANDS INCLUDED IN SAID BOUNDARY PLAT. DATA OBTAINED FROM THE RECORDS OF THE MORGAN COUNTY RECORDERS OFFICE AND GEOGRAPHIC BOUNDARIES AS DESCRIBED IN THE OFFICIAL COUNTY BOUNDARY RECORDS MAINTAINED BY THE OFFICE OF THE LEUTENANT GOVERNOR.
SIGNED THIS 10th DAY OF MARCH, 2017.

MATTHEW ABRAM MURKOOK, P.L.S.
MORGAN COUNTY SURVEYOR
STATE OF UTAH
MARCH 10, 2017

- LEGEND**
- MORGAN COUNTY BOUNDARY
 - MORGAN CITY BOUNDARY
 - UTAH AGRC TOWNSHIP LINES
 - UTAH AGRC SECTION LINE
 - TOWNSHIP, RANGE, SECTION

COUNTY SURVEYORS APPROVAL
THIS PLAT IS HEREBY APPROVED AS A FINAL PLAT OF LOCAL ENTITY BOUNDARY ACTION AS REQUIRED BY UTAH CODE 17-23-30.
APPROVED THIS 13th DAY OF MARCH, 2017.
MORGAN COUNTY SURVEYORS
STATE OF UTAH
MARCH 13, 2017

ACCEPTANCE BY LEGISLATIVE BODY
THIS IS TO CERTIFY THAT WE, THE MORGAN COUNTY COUNCIL OF MORGAN COUNTY, UTAH APPROVES THIS LOCAL ENTITY PLAT FOR THE CREATION OF THE MORGAN COUNTY REINVESTMENT AND RENEWAL AGENCY WHICH WILL BE ENTITLED MORGAN COUNTY REINVESTMENT AGENCY.
APPROVED THIS 13th DAY OF MARCH, 2017.
MORGAN COUNTY COUNCIL
STATE OF UTAH
MARCH 13, 2017

NARRATIVE
A MAP OF THE SUBJECT PROPERTY WAS REQUESTED BY STEPHEN LYON AS ACTING ECONOMIC DEVELOPMENT DIRECTOR FOR MORGAN COUNTY TO FACILITATE THE CREATION OF THE MORGAN COUNTY REINVESTMENT AGENCY IN ACCORDANCE WITH THE PROVISIONS OF TITLE 17C OF THE UTAH CODE ANNOTATED.
THE DOCUMENTATION OBTAINED AS A PART OF THE SURVEY INCLUDES THESE ITEMS SHOWN HEREIN REFERRED TO BELOW. THE BOUNDARIES SHOWN HEREIN ARE A REPRESENTATION OF PARCELS TO BE INCLUDED AND PARCELS TO BE EXCLUDED WITHIN THE PROPOSED BOUNDARY OF "MORGAN COUNTY REINVESTMENT AND RENEWAL AGENCY BOUNDARY", WHERE AS IT IS DESIRED TO INCLUDE ALL LANDS WITHIN THE MORGAN COUNTY BOUNDARY AND EXCLUDE THE ACCORDANT BOUNDARY OF MORGAN CITY FROM THIS PROPOSED BOUNDARY.

REFERENCES
MORGAN COUNTY BOUNDARY MAP AND DESCRIPTION AS SHOWN AND RECORDED WITH THE OFFICE OF THE LEUTENANT GOVERNOR. [HTTPS://MUNCIRECRT.UTAH.GOV](https://muncirecrt.utah.gov)
MORGAN CITY ANNEXATION MAPS RECORDED AS ENTRY NO. 49886, NO. 53886, NO. 58683, NO. 68692, NO. 85783, AND NO. 110282 IN THE MORGAN COUNTY RECORDERS OFFICE AND AS SHOWN ON THIS MAP.

SURVEYOR'S NOTES

- AT NO TIME WAS A SURVEY ON THE GROUND PERFORMED TO VERIFY THE ACCURACY OF THE BEARINGS AND DISTANCES NOR WERE ANY TIES TO EXISTING RECORDS OF SURVEYS, PLATS, SECTION CORNERS, AND THE SPCS 15 LON/LAT/UTM. THIS BOUNDARY PLAT IS TO SERVE AS A BOUNDARY LINE TO ESTABLISH THE "MORGAN COUNTY REINVESTMENT AGENCY" FOR INFORMATION PURPOSES ONLY.
- THE LINE WORK FOR THE COUNTY BOUNDARIES, PLUS SECTIONS, PLUS TOWNSHIPS AND ROADWAYS WAS ACQUIRED FROM INFORMATION AVAILABLE IN THE UTAH AUTOMATED GEOGRAPHIC REFERENCE CENTER (UTAH AGRC) HTTPS://AGRS.UTAH.GOV
- THIS MORGAN COUNTY BOUNDARY DOES NOT INCLUDE THE DETERMINATION OF THE TRUE LOCATION OF A COUNTY BOUNDARY AND ITS GEOGRAPHIC BOUNDARIES ARE AS DESCRIBED IN THE OFFICIAL COUNTY BOUNDARY RECORDS MAINTAINED BY THE OFFICE OF THE LEUTENANT GOVERNOR. DISTRICT BEARINGS AND DISTANCES IN ACCORDANCE WITH SECTION 17-50-105 OF THE UTAH CODE ANNOTATED.
- IN RESEARCHING THESE RECORDS WE FOUND TWO BOUNDARY ADJUSTMENTS MADE AND/OR ADJUSTED THE LOCATION OF THE MORGAN COUNTY AND SUMMIT COUNTY LINES. THE ADJUSTMENTS TO THE COUNTY LINE ARE RECORDED AS ENTRY NO. 10708 AND ENTRY NO. 12628 IN THE MORGAN COUNTY RECORDERS OFFICE.

COUNTY RECORDER
ENTRY NO. 1511016, FEE PAID \$30, FILED FOR RECORD AND RECORDED ON MAR 14 2017 AT 1:55 PM IN BOOK OF OFFICIAL RECORDS 1511016-1511019 FOR Morgan County.
PREPARED BY: *Debra D. Hesse*, MORGAN COUNTY RECORDER

WASATCH CIVIL
Consulting Engineering
1150 SOUTH DEPOT DRIVE, SUITE 225
OGDEN, UTAH 84404 (801) 775-9191