

This map is provided solely for the purpose of assisting in locating the property and Cottonwood Trail and is not to be used as a legal instrument. It is intended for orientation, if any, with any actual survey.

SIDEWALK EASEMENTS

BEING THE PROPOSED SIDEWALK EASEMENTS FOR A HANDICAP RAMP TO BE INSTALLED IN SOUTH JORDAN CITY

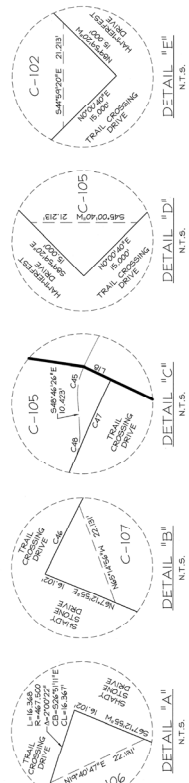

| Line # | Length | Bearing | Chord Bearing | Chord Length |
|--------|---------|----------|---------------|--------------|
| L1 | 46.500 | S073107N | S073107N | 36.442 |
| L2 | 54.654 | S007002E | S007002E | 47.656 |
| L3 | 41.163 | N895084E | N895084E | 48.862 |
| L4 | 8.900 | S007002E | S007002E | 123.84 |
| L5 | 85.000 | N027023E | N027023E | 198.808 |
| L6 | 197.000 | N895084E | N895084E | 28.976 |
| L7 | 85.000 | S007002E | S007002E | 28.846 |
| L8 | 48.976 | N895084E | N895084E | 148.784 |
| L9 | 2.711 | S072219N | S072219N | 49.775 |
| L10 | 27.662 | S073107E | S073107E | 390.125 |
| L11 | 233.469 | N072219N | N072219N | 200.479 |
| L12 | 144.838 | N072219N | N072219N | 174.194 |
| L13 | 262.029 | N872193E | N872193E | 24.748 |
| L14 | 92.383 | N895084E | N895084E | 29.477 |
| L15 | 76.386 | N895084E | N895084E | 79.056 |
| L16 | 91.224 | N895084E | N895084E | 47.625 |
| L17 | 84.600 | N027023E | N027023E | 258.388 |
| L18 | 91.500 | S007002E | S007002E | 151.058 |
| L19 | 34.823 | S007002E | S007002E | 86.529 |
| L20 | 34.520 | N027023E | N027023E | 43.125 |

| Curve # | Length | Bearing | Delta | Chord Bearing | Chord Length |
|---------|---------|------------|-------------|---------------|--------------|
| C1 | 36.442 | 089°30'04" | 0°19'30"44" | N073107N | 67.864 |
| C2 | 47.656 | 002°00'00" | 002°00'00" | S007002E | 68.862 |
| C3 | 48.862 | 007°09'51" | 007°09'51" | N895084E | 123.84 |
| C4 | 123.84 | 007°09'51" | 007°09'51" | N67°32'07E | 198.808 |
| C5 | 198.808 | 002°00'00" | 002°00'00" | N11°09'47E | 28.976 |
| C6 | 28.976 | 002°00'00" | 002°00'00" | N89°50'47E | 28.846 |
| C7 | 28.846 | 007°09'51" | 007°09'51" | N07°23'04N | 148.784 |
| C8 | 148.784 | 007°09'51" | 007°09'51" | N07°23'04N | 49.775 |
| C9 | 49.775 | 007°09'51" | 007°09'51" | N07°23'04N | 390.125 |
| C10 | 390.125 | 002°00'00" | 002°00'00" | N89°50'47E | 200.479 |
| C11 | 200.479 | 002°00'00" | 002°00'00" | N89°50'47E | 174.194 |
| C12 | 174.194 | 007°09'51" | 007°09'51" | N87°21'07E | 24.748 |
| C13 | 24.748 | 007°09'51" | 007°09'51" | N87°21'07E | 29.477 |
| C14 | 29.477 | 002°00'00" | 002°00'00" | N89°50'47E | 79.056 |
| C15 | 79.056 | 002°00'00" | 002°00'00" | N89°50'47E | 47.625 |
| C16 | 47.625 | 007°09'51" | 007°09'51" | N07°23'04N | 258.388 |
| C17 | 258.388 | 007°09'51" | 007°09'51" | N07°23'04N | 151.058 |
| C18 | 151.058 | 002°00'00" | 002°00'00" | N89°50'47E | 86.529 |
| C19 | 86.529 | 002°00'00" | 002°00'00" | N89°50'47E | 43.125 |
| C20 | 43.125 | 007°09'51" | 007°09'51" | N07°23'04N | 43.125 |

| Curve # | Length | Bearing | Delta | Chord Bearing | Chord Length |
|---------|---------|------------|-------------|---------------|--------------|
| C21 | 138.478 | 171.500 | 045°10'41" | N02°42'29"E | 93.883 |
| C22 | 101.025 | 109.100 | 000°39'38" | S42°09'54"E | 91.099 |
| C23 | 109.100 | 228.500 | 002°14'27" | S09°25'26"E | 68.811 |
| C24 | 68.811 | 42.023 | 044°50'00" | N09°16'07"E | 8.922 |
| C25 | 8.922 | 044°50'00" | 044°50'00" | N09°16'07"E | 293.460 |
| C26 | 293.460 | 446.346 | 049°45'32" | N74°19'03"E | 49.462 |
| C27 | 49.462 | 446.346 | 049°45'32" | N74°19'03"E | 38.466 |
| C28 | 38.466 | 183.300 | 037°31'47" | N06°41'33"E | 271.721 |
| C29 | 271.721 | 183.300 | 037°31'47" | N06°41'33"E | 244.371 |
| C30 | 244.371 | 495.500 | 000°16'51" | N02°09'26"E | 271.202 |
| C31 | 271.202 | 495.500 | 000°16'51" | N02°09'26"E | 193.297 |
| C32 | 193.297 | 0174.500 | 0174°50'41" | N48°32'58"E | 192.344 |
| C33 | 192.344 | 0174.500 | 0174°50'41" | N48°32'58"E | 16.444 |
| C34 | 16.444 | 467.500 | 045°05'28" | N02°51'04"E | 384.767 |
| C35 | 384.767 | 533.500 | 024°21'48" | N02°41'09"E | 279.121 |
| C36 | 279.121 | 533.500 | 024°21'48" | N02°41'09"E | 62.871 |
| C37 | 62.871 | 487.500 | 007°03'48" | N03°52'47"E | 64.641 |
| C38 | 64.641 | 487.500 | 007°03'48" | N03°52'47"E | 86.529 |
| C39 | 86.529 | 004°45'04" | 004°45'04" | N72°12'31"E | 20.495 |

| Curve # | Length | Bearing | Delta | Chord Bearing | Chord Length |
|---------|---------|---------|------------|---------------|--------------|
| C41 | 64.808 | 231.642 | 019°39'04" | N07°19'58"E | 64.607 |
| C42 | 71.430 | 242.592 | 019°39'04" | N07°19'58"E | 71.408 |
| C43 | 121.004 | 493.492 | 019°39'04" | N07°20'58"E | 101.444 |
| C44 | 101.444 | 564.500 | 005°44'30" | S03°47'34"E | 56.544 |
| C45 | 56.544 | 20.000 | 007°09'24" | S03°46'59"E | 16.367 |
| C46 | 16.367 | 20.000 | 007°09'24" | S03°46'59"E | 271.801 |
| C47 | 271.801 | 533.500 | 002°59'38" | N02°52'49"E | 9.133 |
| C48 | 9.133 | 20.000 | 002°59'38" | S03°52'49"E | 9.133 |

THIS MAP WAS PREPARED BY PERIGEE CONSULTANTS, INC. FOR THE PROJECT OF THE PROPOSED SIDEWALK EASEMENTS FOR A HANDICAP RAMP TO BE INSTALLED IN SOUTH JORDAN CITY. THIS MAP IS PROVIDED SOLELY FOR THE PURPOSE OF ASSISTING IN LOCATING THE PROPERTY AND COTTONWOOD TRAIL AND IS NOT TO BE USED AS A LEGAL INSTRUMENT. IT IS INTENDED FOR ORIENTATION, IF ANY, WITH ANY ACTUAL SURVEY.

DATE OF SURVEY: 11/20/2020
 DRAWN BY: J. HARRIS
 CHECKED BY: J. HARRIS
 PERIGEE CONSULTANTS, INC.
 1000 N. 1000 E., SUITE 100
 SALT LAKE CITY, UT 84143
 (801) 488-2222



