

MORGAN COUNTY REINVESTMENT AND RENEWAL AGENCY BOUNDARY PLAT

ORDINANCE NO. CO-17-15
MORGAN COUNTY, UTAH
MARCH 2017

UTAH COUNTY RECORDERS
MORGAN COUNTY RECORDERS
MOUNTAIN VIEW RECORDERS
SALT LAKE COUNTY RECORDERS
ST. GEORGE RECORDERS
TAYLOR RECORDERS
WASATCH COUNTY RECORDERS
WENDENBERRY RECORDERS
WINTERS RECORDERS

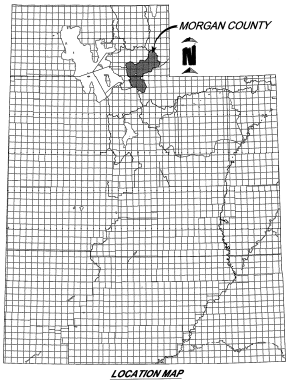
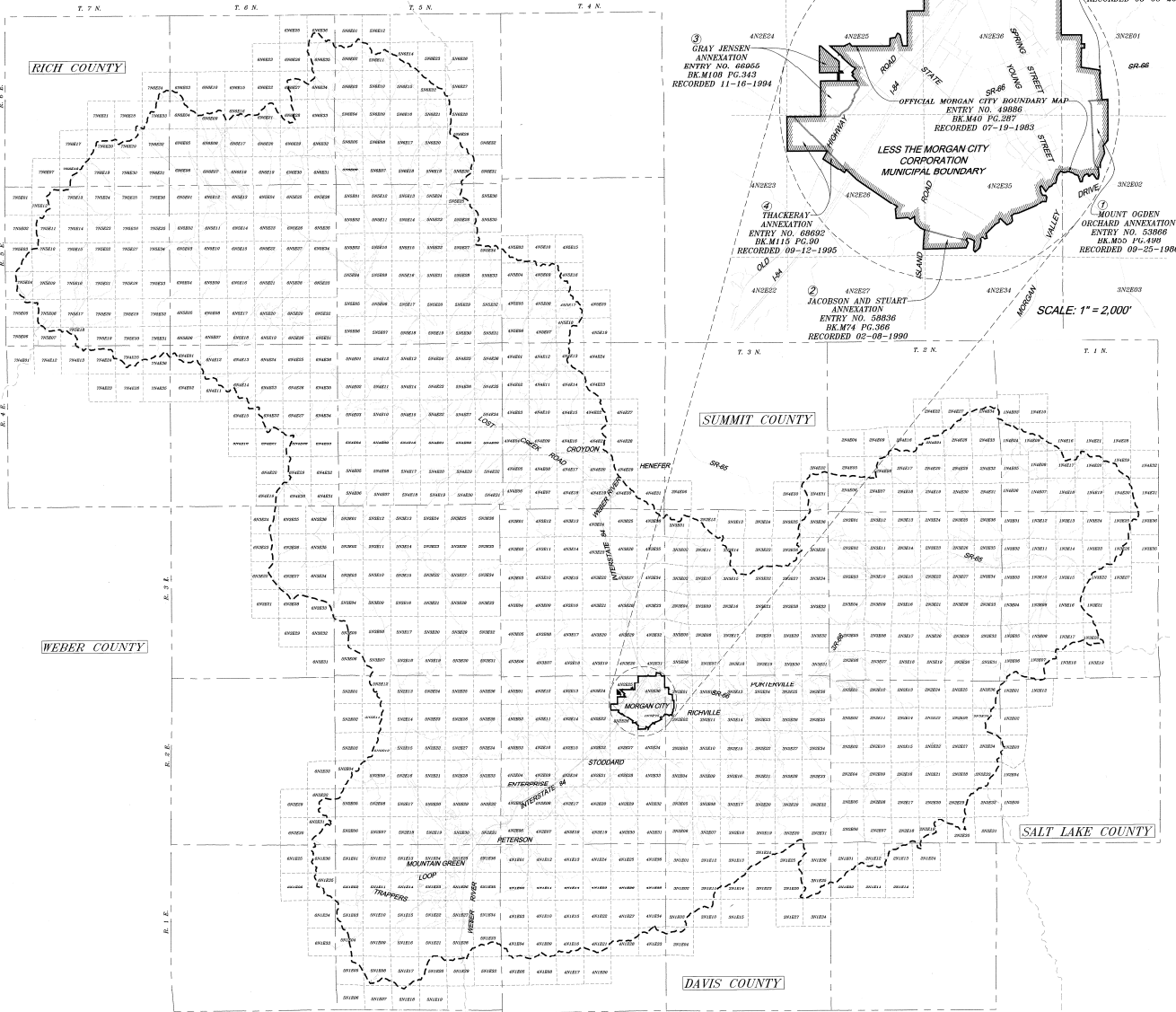

SURVEYORS CERTIFICATE

I, MATTHEW ABRAM MURKOO, A LICENSED PROFESSIONAL LAND SURVEYOR AS PRESCRIBED BY THE LAWS OF THE STATE OF UTAH IN ACCORDANCE WITH TITLE 18, CHAPTER 25 AND TITLE 19, CHAPTER 2 AND 184100, DO HEREBY CERTIFY THAT THIS MAP OF THE MORGAN COUNTY BOUNDARY AND RENEWAL AGENCY BOUNDARY PLAT WAS MADE UNDER MY DIRECTION AND IN ACCORDANCE WITH SECTION 17-23-30 AND HAS BEEN CORRECTLY SHOWN TO THE DESIGNATED SCALE AND IS A TRUE AND CORRECT REPRESENTATION OF THE FOLLOWING DESCRIPTION OF LANDS INCLUDED IN SAID BOUNDARY AND RENEWAL AGENCY PLAT FROM THE RECORDS OF THE MORGAN COUNTY RECORDERS OFFICE AND GEOGRAPHIC BOUNDARIES AS DESCRIBED IN THE OFFICIAL COUNTY BOUNDARY RECORDS MAINTAINED BY THE OFFICE OF THE LIEUTENANT GOVERNOR.

SIGNED THIS 10th DAY OF MARCH, 2017.

MATTHEW ABRAM MURKOO, P.L.S.

 MATTHEW ABRAM MURKOO
 LICENSE NO. 5245
 STATE OF UTAH

LEGEND

- MORGAN COUNTY BOUNDARY
- MORGAN CITY BOUNDARY
- UTAH AGRC TOWNSHIP LINES
- UTAH AGRC SECTION LINE
- TOWNSHIP, RANGE, SECTION

COUNTY SURVEYORS APPROVAL

THIS PLAT IS HEREBY APPROVED AS A FINAL PLAT OF LOCAL ENTITY BOUNDARY ACTION AS REQUIRED BY UTAH CODE 17-23-30.

APPROVED THIS 13th DAY OF MARCH, 2017.

MORGAN COUNTY SURVEYORS

 TIMOTHY CANNON
 LICENSE NO. 5135
 STATE OF UTAH

ACCEPTANCE BY LEGISLATIVE BODY

THIS IS TO CERTIFY THAT WE, THE MORGAN COUNTY COUNCIL OF MORGAN COUNTY, UTAH APPROVES THIS LOCAL ENTITY PLAT FOR THE CREATION OF THE MORGAN COUNTY REINVESTMENT AND RENEWAL AGENCY WHICH WILL BE ENTITLED MORGAN COUNTY REINVESTMENT AGENCY.

APPROVED THIS 13th DAY OF MARCH, 2017.

TRINA CANNON
 COUNCIL CHAIR, MORGAN COUNTY COUNCIL

STACY RAY CLARK
 CLERK, MORGAN COUNTY COUNCIL

MORGAN COUNTY REINVESTMENT AND RENEWAL AGENCY BOUNDARY DESCRIPTION

THE GEOGRAPHIC BOUNDARIES OF MORGAN COUNTY ARE DESCRIBED AS FOLLOWS:
 BEGINNING AT THE POINT ON THE SUMMIT OF THE WASATCH RANGE OF MOUNTAINS NEAREST TO THE EASTERN HEADWATERS OF THE OGDEN RIVER; THENCE SOUTHWESTERLY ALONG THE SUMMIT OF SAID RANGE PASSING SOUTH AROUND THE HEADWATERS OF THE OGDEN RIVER TO THE SUMMIT OF THE MAIN WASATCH RANGE SOUTHWEST OF OGDEN CITY; THENCE SOUTHERLY ALONG THE SUMMIT OF SAID RANGE CROSSING THE WEBER CANYON AND RIVER TO THE SUMMIT OF THE CROSS RANGE THROUGH WHICH THE UPPER CANYON OF EAST CANYON CREEK RUNS; THENCE EASTERLY ALONG THE SUMMIT OF SAID LAST MENTIONED RANGE TO AND THENCE NORTHERLY ALONG THE SUMMIT OF THE RANGE BETWEEN EAST CANYON CREEK AND THE WEBER RIVER TO THE WEBER RIVER; THENCE NORTHEASTERLY ACROSS SAID RIVER AND ALONG THE SUMMIT OF THE HIGH LAND BETWEEN LOST AND ECHO CANYON CREEKS TO THE SUMMIT OF THE WASHATCH RANGE SEPARATING THE VALLEY OF THE BEAR RIVER FROM THE VALLEY OF THE WEBER RIVER; THENCE NORTHWESTERLY ALONG THE LAST MENTIONED SUMMIT TO THE POINT OF BEGINNING.

LESS THE MORGAN CITY CORPORATION MUNICIPAL BOUNDARY FOR WHICH THE OFFICIAL CITY BOUNDARY MAP WAS RECORDED JULY 19, 1988 AS ENTRY NO. 49888 IN BOOK 1845 AT PAGE 287 IN THE MORGAN COUNTY RECORDERS OFFICE. ADDITIONALLY SIX (6) AREAS HAVE BEEN ANNEXED TO THE CORPORATE LIMITS OF MORGAN CITY AND RECORDED IN THE MORGAN COUNTY RECORDERS OFFICE AS FOLLOWS: (1) MOUNT OGDEN ORCHARD ANNEXATION RECORDED SEPTEMBER 25, 1988 AS ENTRY NO. 50888 IN BOOK 1885 AT PAGE 488; (2) JACOBSON AND STUART ANNEXATION RECORDED FEBRUARY 8, 1990 AS ENTRY NO. 58888 IN BOOK 1874 AT PAGE 386; (3) GRAY JENSEN ANNEXATION RECORDED NOVEMBER 16, 1983 AS ENTRY NO. 68888 IN BOOK 1108 AT PAGE 342; (4) THACKERAY ANNEXATION RECORDED SEPTEMBER 12, 1985 AS ENTRY NO. 68882 IN BOOK 1115 AT PAGE 90; (5) "RUSSELL ANNEXATION" RECORDED AUGUST 15, 2007 AS ENTRY NO. 85783 IN BOOK 1172 AT PAGE 322; (6) GRAY JENSEN ANNEXATION" RECORDED DECEMBER 3, 2007 AS ENTRY NO. 110282 IN BOOK 257 AT PAGE 58.

MORGAN COUNTY BOUNDARY DESCRIPTION AS PER LIEUTENANT GOVERNOR'S OFFICE

THE GEOGRAPHIC BOUNDARIES OF MORGAN COUNTY ARE DESCRIBED AS FOLLOWS:
 BEGINNING AT THE POINT ON THE SUMMIT OF THE WASATCH RANGE OF MOUNTAINS NEAREST TO THE EASTERN HEADWATERS OF THE OGDEN RIVER; THENCE SOUTHWESTERLY ALONG THE SUMMIT OF SAID RANGE PASSING SOUTH AROUND THE HEADWATERS OF THE OGDEN RIVER TO THE SUMMIT OF THE MAIN WASATCH RANGE SOUTHWEST OF OGDEN CITY; THENCE SOUTHERLY ALONG THE SUMMIT OF SAID RANGE CROSSING THE WEBER CANYON AND RIVER TO THE SUMMIT OF THE CROSS RANGE THROUGH WHICH THE UPPER CANYON OF EAST CANYON CREEK RUNS; THENCE EASTERLY ALONG THE SUMMIT OF SAID LAST MENTIONED RANGE TO AND THENCE NORTHERLY ALONG THE SUMMIT OF THE RANGE BETWEEN EAST CANYON CREEK AND THE WEBER RIVER TO THE WEBER RIVER; THENCE NORTHEASTERLY ACROSS SAID RIVER AND ALONG THE SUMMIT OF THE HIGH LAND BETWEEN LOST AND ECHO CANYON CREEKS TO THE SUMMIT OF THE WASHATCH RANGE SEPARATING THE VALLEY OF THE BEAR RIVER FROM THE VALLEY OF THE WEBER RIVER; THENCE NORTHWESTERLY ALONG THE LAST MENTIONED SUMMIT TO THE POINT OF BEGINNING.

NARRATIVE

A MAP OF THE SUBJECT PROPERTY WAS REQUESTED BY STEPHEN LYON AS ACTING ECONOMIC DEVELOPMENT DIRECTOR FOR MORGAN COUNTY TO FACILITATE THE CREATION OF THE MORGAN COUNTY REINVESTMENT AGENCY IN ACCORDANCE WITH THE PROVISIONS OF TITLE 17C OF THE UTAH CODE ANNOTATED.

THE DOCUMENTATION OBTAINED AS A PART OF THE SURVEY INCLUDES THESE ITEMS SHOWN HEREIN REFERRED TO BELOW: THE BOUNDARIES SHOWN HEREIN ARE A REPRESENTATION OF PARCELS TO BE INCLUDED AND PARCELS TO BE EXCLUDED WITHIN THE PROPOSED BOUNDARY OF "MORGAN COUNTY REINVESTMENT AND RENEWAL AGENCY BOUNDARY", WHERE AS IT IS DESIRED TO INCLUDE ALL LANDS WITHIN THE MORGAN COUNTY BOUNDARY AND EXCLUDE THE ACCORDANT BOUNDARY OF MORGAN CITY FROM THIS PROPOSED BOUNDARY.

REFERENCES

MORGAN COUNTY BOUNDARY MAP AND DESCRIPTION AS SHOWN AND RECORDED WITH THE OFFICE OF THE LIEUTENANT GOVERNOR: [HTTPS://UMCCERT.UTAH.GOV](https://umccert.utah.gov)

MORGAN CITY ANNEXATION MAPS RECORDED AS ENTRY NO. 49888 IN BOOK 1886 NO. 68888 NO. 68885 NO. 68882 NO. 85783 AND NO. 110282 IN THE MORGAN COUNTY RECORDERS OFFICE AND AS SHOWN ON THIS MAP.

SURVEYOR'S NOTES

- AT NO TIME WAS A SURVEY ON THE GROUND PERFORMED TO VERIFY THE ACCURACY OF THE BEARINGS AND DISTANCES NOR WERE ANY TIES TO EXISTING RECORDS OF SURVEYS, PLATS, SECTION CORNERS, AND THE SPCS 15 LON/LAT; THIS BOUNDARY PLAT IS TO SERVE AS A BOUNDARY LINE TO ESTABLISH THE "MORGAN COUNTY REINVESTMENT AGENCY" FOR INFORMATION PURPOSES ONLY.
- THE LINE WORK FOR THE COUNTY BOUNDARIES, PLUS SECTIONS, PLUS TOWNSHIPS AND RANGELINES WAS ACQUIRED FROM INFORMATION AVAILABLE IN THE UTAH AUTOMATED GEOGRAPHIC REFERENCE CENTER (UTAH AGRC) [HTTPS://GISG.UTAH.GOV](https://gisg.utah.gov)
- THIS MORGAN COUNTY BOUNDARY DOES NOT INCLUDE THE DETERMINATION OF THE TRUE LOCATION OF A COUNTY BOUNDARY AND ITS GEOGRAPHIC BOUNDARIES ARE AS DESCRIBED IN THE OFFICIAL COUNTY BOUNDARY RECORDS MAINTAINED BY THE OFFICE OF THE LIEUTENANT GOVERNOR. DISTURBED BEARINGS SHALL BE REVISED IN ACCORDANCE WITH SECTION 17-50-105 OF THE UTAH CODE ANNOTATED.
- IN RESEARCHING THESE RECORDS WE FOUND TWO BOUNDARY ADJUSTMENTS MADE AND/OR ADJUSTED THE LOCATION OF THE MORGAN COUNTY AND SUMMIT COUNTY LINES. THE ADJUSTMENTS TO THE COUNTY LINE ARE RECORDED AS ENTRY NO. 107088 AND ENTRY NO. 126078 IN THE MORGAN COUNTY RECORDERS OFFICE.

COUNTY RECORDER

ENTRY NO. 151016, FEE PAID \$30
 RECORDED AND FILED FOR RECORD AND INDEXED ON MAR 14 2017 AT 1:55 PM IN BOOK 151016 OF OFFICIAL RECORDS FOR Morgan County

PREPARED BY:

 Doreen D. Hines
 MORGAN COUNTY RECORDER

WASATCH CIVIL
 Consulting Engineering
 1150 SOUTH DEPOT DRIVE, SUITE 225
 OGDEN, UTAH 84404 (801) 775-9191