

3546750

BRIGHTON-NORTH POINT IRRIGATION CO.  
c/o George M. Loertscher, Secretary-Treasurer  
1018 Montgomery Street, Salt Lake City, Utah 84104

RESOLUTION

Telephone 973-8260

Be it resolved that the center-line description of the Brighton-North Point Canal prepared by Bingham Engineering under date of July 1980, and revision January 1981, be adopted as the legal description of the Brighton-North Point Canal and it is further resolved that the President may be, and is hereby, authorized and directed to take any and all action necessary to record said legal description in the office of the Salt Lake County Recorder. Dated this twenty-seventh day of February 1981.

*George M. Loertscher*  
Secretary-Treasurer

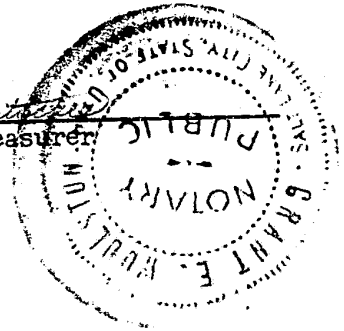

STATE OF UTAH )  
COUNTY OF SALT LAKE ) ss

On the 20th day of March 1981, personally appeared before me George M. Loertscher who duly acknowledged that he is the Secretary-Treasurer of the Brighton-North Point Irrigation Company, and that the foregoing Resolution was duly adopted by the Board of Directors on the twenty-seventh day of February 1981.

My Commission expires: 5 Aug 82

*Grant E. Kullback*  
NOTARY PUBLIC  
Residing in Salt Lake County, Utah

4400  
Brighton + North Point  
REC'D  
DEP  
KATIE L. DIXON  
RECORDER  
SALT LAKE COUNTY,  
UTAH  
MAR 24 6 52 AM '81

NON 5227 PAGE 1403

CENTERLINE DESCRIPTIONS  
OF THE  
BRIGHTON NORTH POINT CANAL

for

Brighton North Point Canal Company  
Floyd Thompson, President

prepared by

Bingham Engineering  
165 Wright Brothers Drive  
Salt Lake City, Utah 84116

July 1980

Revised January 1981

INDEX

	FEET	MILES
Main	21,2+40.76	4.02
East Branch	18,2+58.34	3.46
Middle Branch	9,3+15.43	1.76
West Branch	38,2+03.71	7.24
Winkle-Kotter Ditch	<u>2,3+78</u>	<u>0.45</u>
	89,3+96.24	16.93

CENTERLINE DESCRIPTION  
 OF THE  
 MAIN BRIGHTON NORTH POINT CANAL  
 (58' right-of-Way - 29' on Either Side of Centerline)

Section 1, T2S, R1W

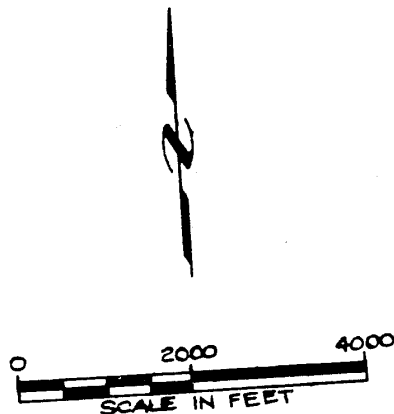

Beginning at Engineer's Station 0+00 which is a point in the Jordan River 25 feet more or less southerly or upstream from a diversion structure, said point being also 1147 feet more or less South and 763 feet more or less East from the west quarter corner of Section 1, Township 2 South, Range 1 West, SLB & M, and thence  $N53^{\circ}14'30''W$ , 39.00 feet; thence northwesterly 170.17 feet along the arc of a 200 foot radius curve to the right (long chord bears  $N29^{\circ}14'30''W$ ); thence  $N4^{\circ}29'30''W$ , 130.00 feet; thence  $N32^{\circ}57'30''W$ , 245.00 feet; thence northwesterly 177.59 feet along the arc of a 500 foot radius curve to the right (long chord bears  $N23^{\circ}12'30''W$ ); thence northwesterly 278.03 feet along the arc of a 360 foot radius curve to the left (long chord bears  $N36^{\circ}12'30''W$ ); thence  $N58^{\circ}12'30''W$ , 288.00 feet; thence northwesterly 33.60 feet along the arc of a 100 foot radius curve to the right (long chord bears  $N48^{\circ}35'W$ ); and thence  $N39^{\circ}02'30''W$ , 9.00 feet more or less to Engineer's Station 13+70.39 which is a point on the west line of Section 1, said point being 85 feet more or less south of the W 1/4 corner of said Section 1, T2S, R1W.

Rev. 1-81

CENTERLINE DESCRIPTION  
OF THE  
MAIN BRIGHTON NORTH POINT CANAL  
(continued)  
(58' Right-of-way - 29' Either Side of Centerline)

Section 2, T2S, R1W

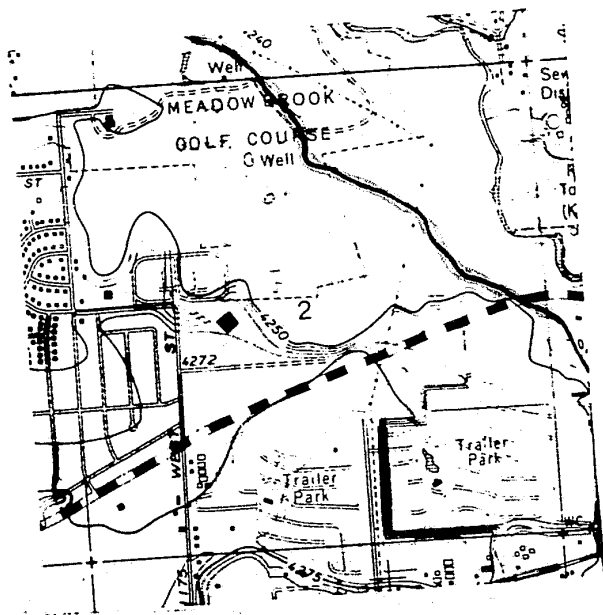

Beginning at Engineer's Station 13+70.39 which is a point on the east line of Section 2, Township 2 South, Range 1 West, SLB & M, said point being 85 feet more or less south of the east 1/4 corner of Section 2, T2S, R1W, and thence N39°02'30"W, 169.00 feet through a culvert beneath 4700 South Expressway; thence N68°50'30"W, 85.00 feet; thence northwesterly 42.09 feet along the arc of a 100 foot radius curve to the right (long chord bears N89°55'30"W); thence S87°02'30"W, 33.00 feet; thence northwesterly 110.39 feet along the arc of a 150 foot radius curve to the right (long chord bears N71°52'30"W); thence northwesterly 226.02 feet along the arc of a 350 foot radius curve to the left (long chord bears N79°17'30"W); thence northwesterly 149.66 feet along the arc of a 150 foot radius curve to the right (long chord bears N59°12'30"W); thence northwesterly 379.22 feet along the arc of a 1280 foot radius curve to the left (long chord bears N36°29"W); thence northeasterly 247.31 feet along the arc of a 300 foot radius curve to the right (long chord bears N23°59'W); thence northwesterly 92.78 feet along the arc of a 120 foot radius curve to the left (long chord bears N22°31'W); thence N44°40'W, 240.00 feet; thence northwesterly 77.23 feet along the arc of a 300 foot radius curve to the left (long chord bears N36°37'30"W); thence N59°25'W, 910.00 feet; thence northwesterly 118.86 feet along the arc of a 360 foot radius curve to the left (long chord bears N68°57'30"W); thence N78°25'W, 82.00 feet; thence northwesterly 215.20 feet along the arc of a 120 foot radius curve to the right

Section 2, T2S, R1W (continued)

(long chord bears  $N27^{\circ}02'30''W$ ); thence  $N24^{\circ}20'E$ , 40.00 feet; thence northwesterly 281.43 feet along the arc of a 250 foot radius curve to the left (long chord bears  $N7^{\circ}55'W$ ); thence  $N40^{\circ}10'W$ , 225.00 feet; thence northwesterly 159.64 feet along the arc of a 980 foot radius curve to the right (long chord bears  $N35^{\circ}30'W$ ); thence northwesterly 159.99 feet along the arc of a 1000 foot radius curve to the left (long chord bears  $N35^{\circ}42'05''W$ ); thence northwesterly 128.72 feet along the arc of a 300 foot radius curve to the right (long chord bears  $N27^{\circ}59'37''W$ ); and thence  $N15^{\circ}42'07''W$ , 50.00 feet more or less to Engineer's Station 55+92.93 which is a point on the north line of Section 2, said point being 350 feet more or less west of the north quarter corner of said Section 2, T2S, R1W.

rev. 1-81

BOOK 5227 PAGE 1408

CENTERLINE DESCRIPTION  
OF THE  
MAIN BRIGHTON NORTH POINT CANAL  
(continued)  
(58' right-of-way - 29' either side of centerline)

Section 35, T1S, R1W

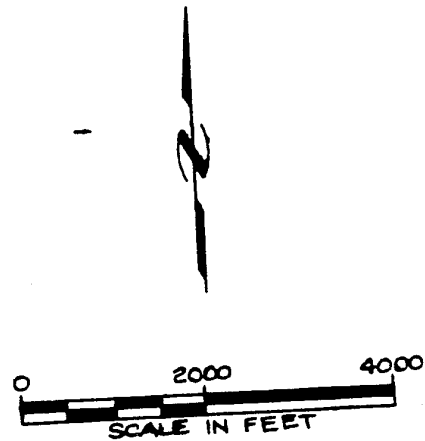
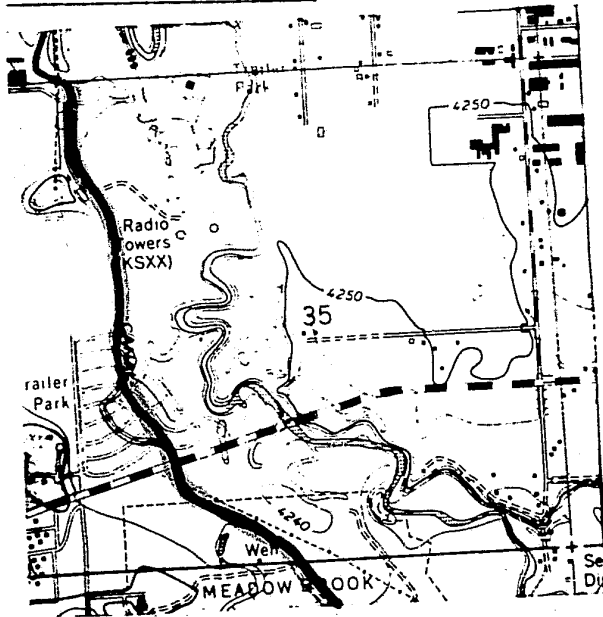

Beginning at Engineer's Station 55+92.93 which is a point on the south line of Section 35, T1S, R1W, said point being 350 feet more or less west from the south 1/4 corner of said Section 35 and thence northwesterly 87.83 feet along the arc of a 165 foot radius curve to the left (long chord bears N30°57'07"W); thence N47°12'07"W, 338.00 feet; thence northwesterly 328.12 feet along the arc of a 705 foot radius curve to the left (long chord bears N60°32'07"W); thence N73°52'07"W, 95.00 feet; thence northwesterly 206.12 feet along the arc of a 400 foot radius curve to the right (long chord bears N59°06'23"W); thence N44°00'38"W, 60.00 feet; thence northwesterly 103.85 feet along the arc of a 150 foot radius curve to the left (long chord bears N63°50'38"W); thence northwesterly 312.20 feet along the arc of 225 foot radius curve to the right (long chord bears N43°55'38"W); thence N4°10'38"W, 200.00 feet to Engineer's P.I. Station 73+24.05; thence N14°55'38"W, 185.00 feet through a culvert beneath 3900 South Expressway; thence N12°34'22"E, 260.00 feet; thence northwesterly 50.66 feet along the arc of a 45 foot radius curve to the left (long chord bears N19°40'38"W); thence northwesterly 54.98 feet along the arc of a 150 foot radius curve to the right (long chord bears N41°25'38"W); thence N30°55'38"W, 250.00 feet; thence northwesterly 218.88 feet along the arc of a 505 foot radius curve to the left (long chord bears N43°20'38"W); thence N34°14'22"W, 79.00

Section 35, T1S, R1W (continued)

feet; thence northwesterly 86.18 feet along the arc of a 50 foot radius curve to the right (long chord bears N6°23'08"W); thence northwesterly 416.84 feet along the arc of a 200 foot radius curve to the left (long chord bears N16°43'08"W); thence northwesterly 213.95 feet along the arc of a 100 foot radius curve to the right (long chord bears N15°08'08"W); thence northeasterly 174.53 feet along the arc of a 200 foot radius curve to the left (long chord bears N21°09'22"E); thence N3°50'38"W, 675.00 feet; thence northeasterly 95.99 feet along the arc of a 200 foot radius curve to the right (long chord bears N9°54'22"E); thence N23°39'22"E, 35.00 feet; thence northeasterly 106.47 feet along the arc of a 150 foot radius curve to the left (long chord bears N3°19'22"E); thence N17°00'38"W, 368.00 feet; thence northwesterly 132.86 feet along the arc of a 350 foot radius curve to the left (long chord bears N27°53'08"W); thence N38°45'38"W, 320.00 feet; thence northwesterly 111.05 feet along the arc of a 150 foot radius curve to the left (long chord bears N17°33'08"W); thence N3°39'22"E, 427.00 feet; thence northeasterly 211.87 feet along the arc of an 1800 foot radius curve to the right (long chord bears N7°01'41"E); and thence northwesterly 129.02 feet more or less along the arc of a 150 foot radius curve to the left (long chord bears N14°14'28"W); to Engineer's POC Station 119+26.33 which is a point on the north line of Section 35, T1S, R1W, said point also being 24 feet more or less east of the northwest corner of said Section 35.

rev. 1-81

BOOK 5227  
PAGE 1410



CENTERLINE DESCRIPTION  
 OF THE  
 MAIN BRIGHTON NORTH POINT CANAL  
 (continued)  
 (55' right-of-way - 27.5' either side of centerline)

Section 26, T1S, R1W

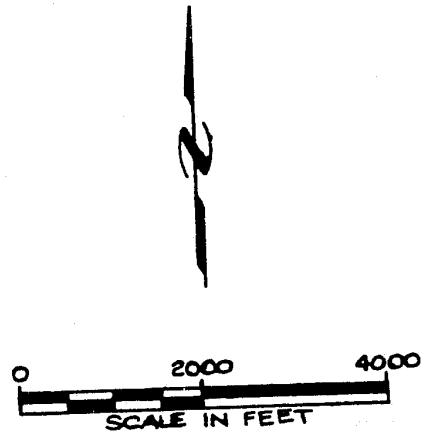
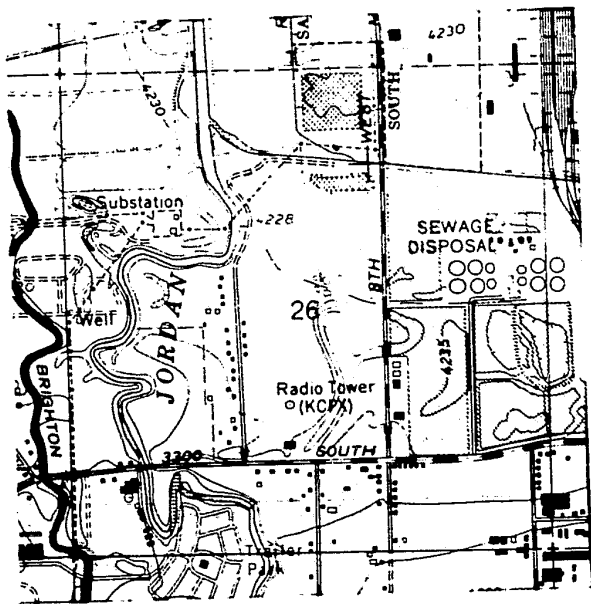

Beginning at Engineer's POC Station 119+26.33 which is a point on the south line of Section 26, T1S, R1W, SLB & M, said point being 24 feet more or less east of the southwest corner of said Section 26 and thence northwesterly 35.00 feet along the arc of a 150 foot radius curve to the left (long chord bears N45°34'12"W) to Engineer's POC Station 119+61.33 which is a point on the west line of said Section 26, said point also being 23.5 feet more or less north of the southwest corner of said Section 26, T1S, R1W, SLB & M.

rev. 1-81

BOOK 5227 PAGE 1411

CENTERLINE DESCRIPTION  
OF THE  
MAIN BRIGHTON NORTH POINT CANAL  
(continued)

(55' right-of-way - 27.5' either side of centerline)

Section 27, T1S, R1W

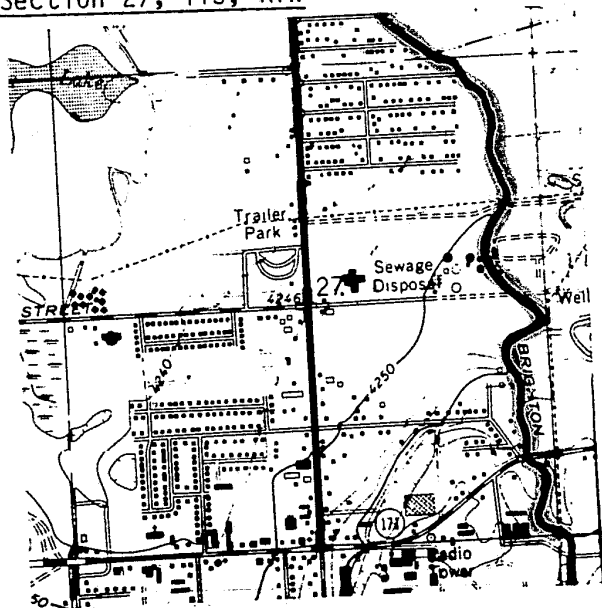

Beginning at Engineer's POC Station 119+61.33 which is a point on the east line of Section 27, T1S, R1W, SLB & M, said point being 23.5 feet more or less north of the southeast corner of said Section 27 and thence northwesterly 50.00 feet along the arc of a 150 foot radius curve to the left (long chord bears N61°48'36"W); thence N71°21'W, 210.00 feet; thence northwesterly 173.66 feet along the arc of a 150 foot radius curve to the right (long chord bears N38°11'W); thence N5°01'W, 485.00 feet; thence northwesterly 80.85 feet along the arc of a 361 foot radius curve to the left (long chord bears N11°26'W); thence N17°51'W, 140.00 feet through a culvert beneath 3300 South Expressway to Engineer's PC Station 131+00.84; thence northeasterly 145.14 feet along the arc of a 176 foot radius curve to the right (long chord bears N5°46'30"E); thence N29°24'E, 25.00 feet; thence northwesterly 216.77 feet along the arc of a 180 foot radius curve to the left (long chord bears N5°06'W); thence N39°36'W, 55.00 feet; thence northwesterly 181.83 feet along the arc of a 140 foot radius curve to the right (long chord Bears N2°23'30"W); thence northwesterly 433.54 feet along the arc of a 276 foot radius curve to the left (long chord bears N10°11'W); thence northwesterly 120.42 feet along the arc of a 120 foot radius curve to the right (long chord bears N26°26'W); thence N2°19'E, 138.00 feet; thence northeasterly 84.19 feet along the arc of a 72 foot radius curve to the right (long chord bears N35°49'E); thence N69°19'E, 301.00 feet; thence northeasterly 139.26 feet along the arc of a 125 foot radius curve to the left (long chord

Section 27, T1S, R1W (continued)

bears N37°24'E); thence N5°29'E, 53.00 feet; thence northwesterly 104.93 feet along the arc of a 75 foot radius curve to the left (long chord bears N34°36'W); thence N74°41'W, 59.00 feet; thence northwesterly 166.97 feet along the arc of a 200 foot radius curve to the right (long chord bears N50°46'W); thence N26°51'W, 18.00 feet; thence northwesterly 95.99 feet along the arc of a 200 foot radius curve to the left (long chord bears N40°36'W); thence N54°21'W, 160.00 feet; thence northwesterly 119.15 feet along the arc of a 222 foot radius curve to the right (long chord bears N38°58'30"W); thence N23°36'W, 129.00 feet; thence northeasterly 320.54 feet along the arc of a 355 foot radius curve to the right (long chord bears N2°16'E); thence N28°08'E, 205.00 feet; thence northeasterly 117.81 feet along the arc of a 200 foot radius curve to the right (long chord bears N45°00'30"E); thence N61°53'E, 41.00 feet; thence northeasterly 145.88 feet along the arc of a 100 foot radius curve to the left (long chord bears N20°05'30"E); thence N21°41'W, 340.00 feet; thence northwesterly 137.95 feet along the arc of a 350 foot radius curve to the right (long chord bears N10°24'30"W); thence N0°53'E, 463.00 feet; thence northwesterly 421.35 feet along the arc of a 352 foot radius curve to the left (long chord bears N33°24'30"W); thence northwesterly 140.72 feet along the arc of a 150 foot radius curve to the right (long chord bears N40°49'30"W); thence N13°57'W, 170.00 feet; thence northwesterly 74.18 feet along the arc of a 50 foot radius curve to the left (long chord bears N56°27'W); thence S81°03'W, 145.00 feet; thence northwesterly 40.43 feet along the arc of a 50 foot radius curve to the right (long chord bears N75°47'W); thence N52°37'W, 110.00 feet more or less to Engineer's POT Station 187+19.85 which point is on the north line of Section 27, which point lies 776 feet more or less west of the NE corner of Section 27, T1S, R1W, SLB & M.

rev. 1-81

BOOK 5227 PAGE 1413

CENTERLINE DESCRIPTION  
OF THE  
MAIN BRIGHTON NORTH POINT CANAL  
(continued)  
(55' right-of-way - 27.5' either side of centerline)

Section 22, T1S, R1W

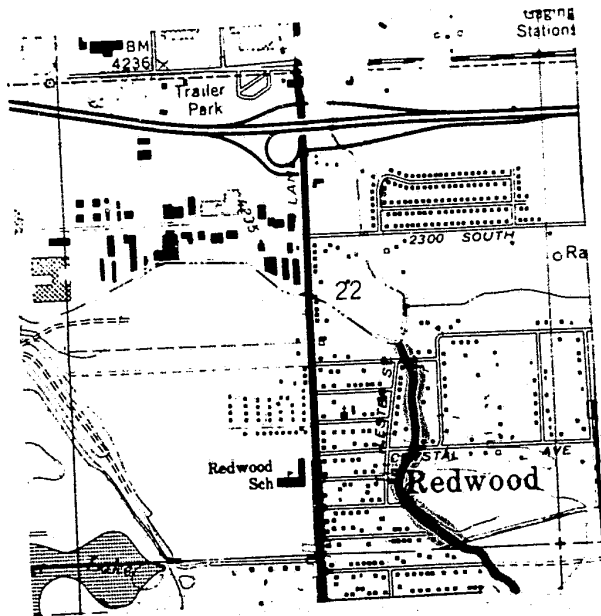

Beginning at Engineer's POT Station 187+19.85 which is a point on the south line of Section 22, T1S, R1W, SLB & M, said point being 776 feet more or less west of the southeast corner of said Section 22 and thence N52°37'W, 379.00 feet; thence northwesterly 339.00 feet along the arc of a 1793 foot radius curve to the right (long chord bears N46°14'30"W); thence northeasterly 431.97 feet along the arc of a 275 foot radius curve to the right (long chord bears N5°08'E); thence N50°08'E, 125.00 feet; thence northeasterly 68.75 feet along the arc of a 76 foot radius curve (long chord bears N23°43'E); thence N1°42'W, 268.00 feet; thence northwesterly 42.32 feet along the arc of a 300 foot radius curve to the left (long chord bears N5°44'30"W); thence N9°47'W, 269.00 feet; thence northeasterly 131.77 feet along the arc of a 302 foot radius curve to the right (long chord bears N2°43'E); thence N15°13'E, 132.00 feet; thence northwesterly 102.10 feet along the arc of a 100 foot radius curve to the left (long chord bears N14°20'30"W); thence N43°54'W, 102.00 feet; thence N24°24'W, 72.00 feet more or less through a culvert to Engineer's PI Station 212+40.76 which is a point on the north right-of-way line of 2495 South Street, said point also being a point of bifurcation which is the end of the Main Canal and the beginning of the East Branch and the West Branch, said point lies 500 feet more or less south and 985 feet more or less east of the monument at the center of Section 22, T1S, R1W, SLB & M.

CENTERLINE DESCRIPTION  
OF THE  
EAST BRANCH OF THE BRIGHTON NORTH POINT CANAL  
(50-foot Right-of-Way, 25 feet on Either Side of Centerline)

Section 22, T1S, R1W

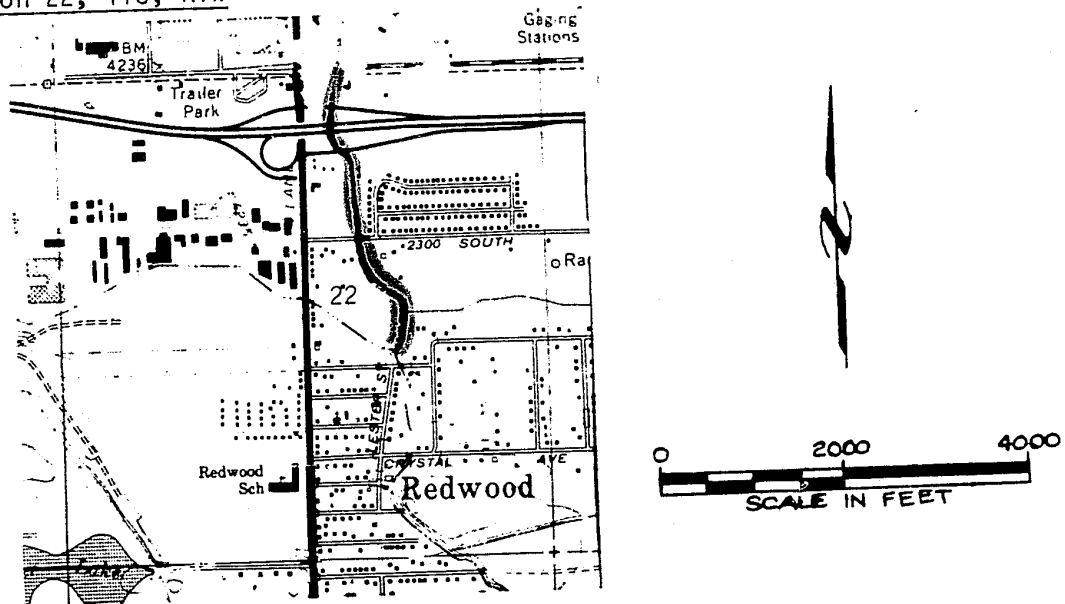

Beginning at Engineer's Station 0+00 which is the beginning of the East Branch of the Brighton North Point Canal as well as the beginning of the West Branch and the end of the Main Canal said point being 500 feet more or less South and 985 feet more or less East of the monument at the center of Section 22, T1S, R1W, SLB & M and thence following the centerline of the East Branch  $N2^{\circ}24'W$ , 148.00 feet; thence Northeasterly 350.81 feet along the arc of a 1608 foot radius curve to the right (long chord bears  $N3^{\circ}51'W$ ); thence Northeasterly 43.63 feet along the arc of a 200 foot radius curve to the left (long chord bears  $N1^{\circ}51'E$ ); thence  $N2^{\circ}24'W$ , 151.00 feet; thence Northwesterly 69.45 feet along the arc of a 50 foot radius curve to the left (long chord bears  $N42^{\circ}11'30''W$ ); thence Northwesterly 318.87 feet along the arc of a 360 foot radius curve to the right (long chord bears  $N57^{\circ}36'30''W$ ); thence  $N31^{\circ}14'W$ , 100.00 feet; thence Northwesterly 331.51 feet along the arc of a 625 foot radius curve to the right (long chord bears  $N16^{\circ}02'17''W$ ); thence  $N0^{\circ}50'33''W$ , 832.00 feet; thence Northwesterly 146.49 feet along the arc of a 200 foot radius curve to the left (long chord bears  $N21^{\circ}49'33''W$ ); thence  $N42^{\circ}48'33''W$ , 207.00 feet; thence Northwesterly 36.51 feet along the arc of a 50 foot radius curve to the left (long chord bears  $N21^{\circ}53'33''W$ ); thence  $N0^{\circ}58'33''W$ , 237.00 feet through a culvert beneath the 2100 South Expressway; thence  $N4^{\circ}16'27''E$ , 530.00 feet more or less to Engineer's POT Station 34+65.14 which is a point on the North line of Section 22; which point is 402 feet east of north 1/4 corner of Section 22, T1S, R1W, SLB & M.

BOOK 5227 PAGE 1445

CENTERLINE DESCRIPTION  
OF THE  
EAST BRANCH OF THE BRIGHTON NORTH POINT CANAL

Section 15, T1S, R1W

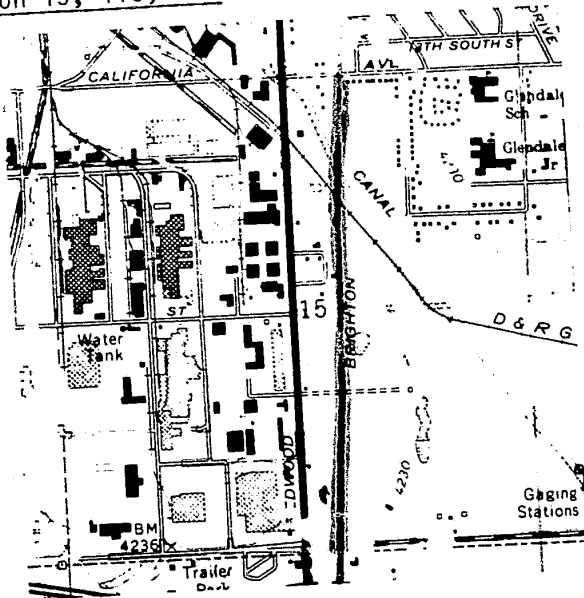

Beginning at Engineer's POT Station 34+65.14 which is a point on the south line of Section 15, T1S, R1W, SLB & M, said point lies 402 feet more or less East of the South quarter corner of said Section 15, and thence  $N4^{\circ}16'27''E$ , 70.00 feet; thence  $N3^{\circ}41'27''E$ , 2520.00 feet; thence  $N0^{\circ}03'33''W$ , 100.00 feet through a culvert beneath 1700 South Street; thence  $N2^{\circ}47'14''E$ , 1310.00 feet; thence  $N2^{\circ}47'14''E$ , 382.00 feet through a flume across the Jordan River; thence  $N2^{\circ}47'14''E$ , 925.00 feet more or less to Engineer's POT Station 87+43.14, which point is on the North line of Section 15, said point also being in the centerline of California Avenue, said point being 651 feet more or less East of the North quarter corner of Section 15, T1S, R1W, SLB & M.

BOOK 5227 PAGE 1416

CENTERLINE DESCRIPTION  
OF THE  
EAST BRANCH OF THE BRIGHTON NORTH POINT CANAL

Section 10, T1S, R1W

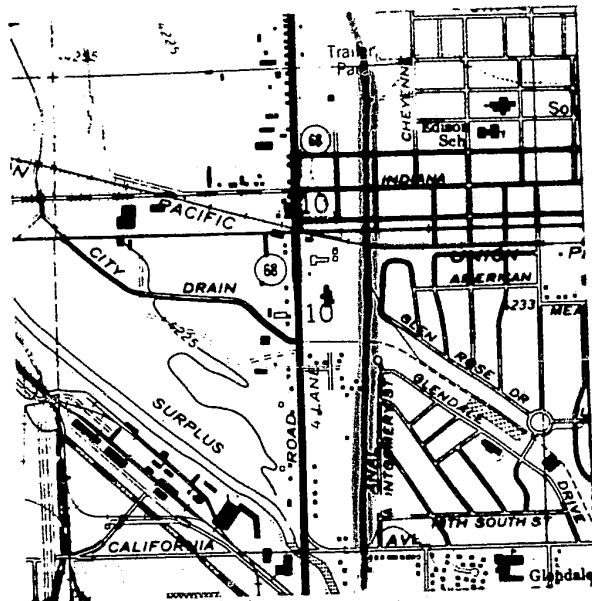

Beginning at Engineer's POT Station 87+43.14 which is a point on the South line of Section 10, T1S, R1W, SLB & M, said point being in the centerline of California Avenue and situated 651 feet more or less East of the South quarter corner of said Section 10, and running thence  $N2^{\circ}47'14''E$ , 3215.00 feet to Engineer's POT Station 119+87.14 which is the inlet end of a culvert under a double track of the Union Pacific Railroad; thence  $N0^{\circ}37'14''E$ , 42.00 feet through a culvert under said Railroad; thence  $N0^{\circ}37'14''E$ , 190.00 feet to the south right-of-way line of 900 South Street; thence  $N10^{\circ}52'17''E$ , 76.00 feet through a culvert under said 900 South Street; thence  $N0^{\circ}22'43''W$ , 1653.00 feet to Engineer's POT Station 139+48.14 which is a point on the North line of Section 10, T1S, R1W, SLB & M, which point lies 470 feet more or less East of the north quarter corner of said Section 10.

CENTERLINE DESCRIPTION  
OF THE  
EAST BRANCH OF THE BRIGHTON NORTH POINT CANAL

Section 3, T1S, R1W

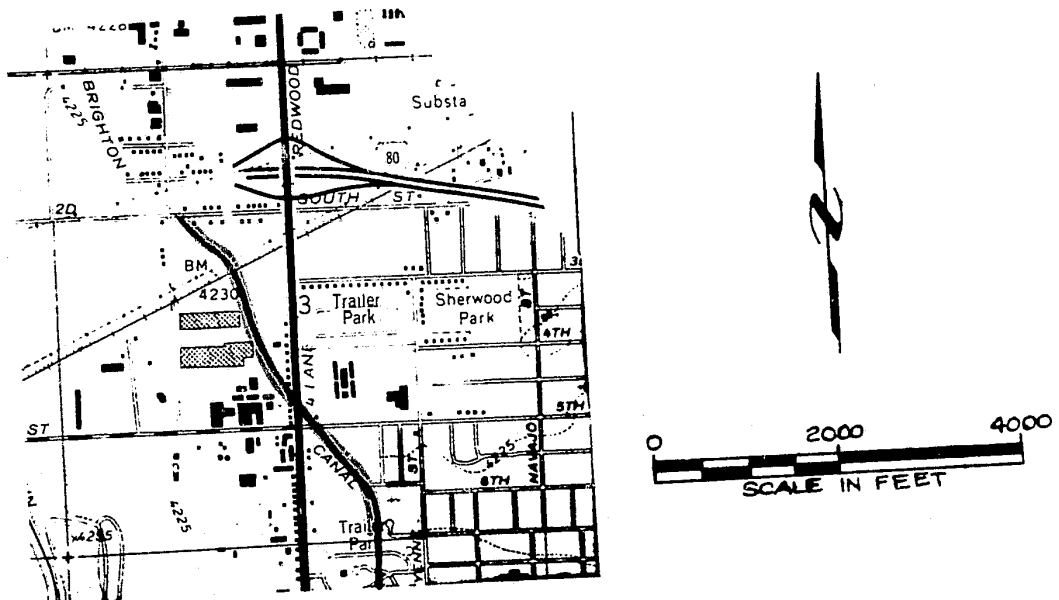

Beginning at Engineer's POT Station 139+48.14 which is a point on the south line of Section 3, T1S, R1W, SLB & M, and said point lies 470 feet more or less East of the south quarter corner of said Section 3, and running thence  $N0^{\circ}22'43''W$ , 447.00 feet; thence Northwestery 47.70 feet along the arc of a 77 foot radius curve to the left (long chord bears  $N18^{\circ}07'32''W$ ); thence  $N35^{\circ}52'20''W$ , 307.00 feet; thence northwesterly 65.89 feet along the arc of a 302 foot radius curve to the left (long chord bears  $N42^{\circ}07'20''W$ ); thence  $N48^{\circ}22'20''W$ , 214.00 feet to Engineer's PI Station 150+29.73; thence  $N36^{\circ}07'20''W$ , 710.00 feet through a culvert beneath 500 South Street and Redwood Road to Engineer's PI Station 157+39.73; thence  $N28^{\circ}37'20''W$ , 417.00 feet; thence  $N30^{\circ}52'20''W$ , 306.00 feet; thence Northwestery 378.80 feet along the arc of a 1378 foot radius curve to the right (long chord bears  $N22^{\circ}59'50''W$ ); thence  $N15^{\circ}07'20''W$ , 194.00 feet; thence Northwestery 47.56 feet along the arc of a 300 foot radius curve to the left (long chord bears  $N19^{\circ}39'50''W$ ); thence  $N24^{\circ}12'20''W$ , 250.00 feet to Engineer's POT Station 173+35.09 which point is the inlet end of a culvert under a double track of the Union Pacific Railroad; thence  $N24^{\circ}12'20''W$ , 56.00 feet through said culvert; thence  $N24^{\circ}12'20''W$ , 50.00 feet; thence Northwestery along the arc of a 300 foot radius curve to the left (long chord bears  $N33^{\circ}12'20''W$ ); thence  $N42^{\circ}12'20''W$ , 723.00 feet to a point on the north line of 200 South Street, which is the end of the East Branch, Station 182+58.34 which point lies 1330 feet more or less East and 800 feet more or less South from the Northwest corner of Section 3, T1S, R1W.



CENTERLINE DESCRIPTION OF THE MIDDLE BRANCH  
 OF THE BRIGHTON NORTHPOINT CANAL  
 (Being a branch of West Branch of the Brighton  
 North Point Canal)

50 foot right-of-way 25 feet either side of centerline

Sections 8 and 9, T1S, R1W

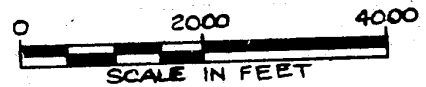
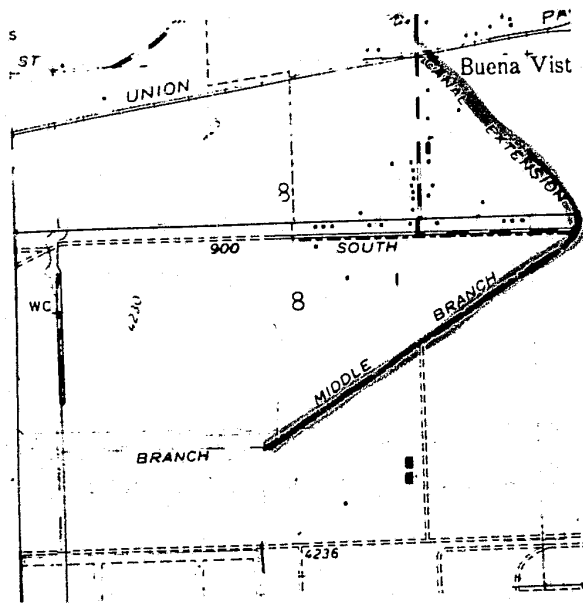

Beginning at Engineer's Station 0+00 which is the beginning of the Middle Branch, said point also being in the centerline of the West Branch of the Brighton North Point Canal; said point being 1070 feet more or less north and 405 feet more or less east of the south quarter corner of Section 8, T1S, R1W, SLB & M, and running thence  $N56^{\circ}40'06''E$ , 3617 feet more or less to Engineer's Station 36+17, a point on the east line of Section 8; thence into Section 9,  $N22^{\circ}39'54''W$ , 45 feet more or less to the centerline of 900 South Street; thence  $N56^{\circ}40'06''W$ , 668 feet; thence  $N22^{\circ}39'54''W$ , 437.00 feet; thence northwesterly 100.43 feet along the arc of a 252 foot radius curve to the left (long chord bears  $N34^{\circ}04'54''W$ ) 503 feet more or less to Engineer's Station 53+47.43 which point is on the west line of Section 9; thence into Section 8,  $N42^{\circ}57'54''W$ , 1525 feet more or less to Engineer's Station 68+65.43 which point is on the north line of Section 8 said point being 1000.00 feet more or less west of the northeast corner of said Section 8, T1S, R1W, SLB & M.

CENTERLINE DESCRIPTION  
 OF THE MIDDLE BRANCH OF THE BRIGHTON  
 NORTH POINT CANAL  
 (Being a branch of the West Branch of the Brighton  
 North Point Canal)  
 (continued)

Section 5, T1S, R1W

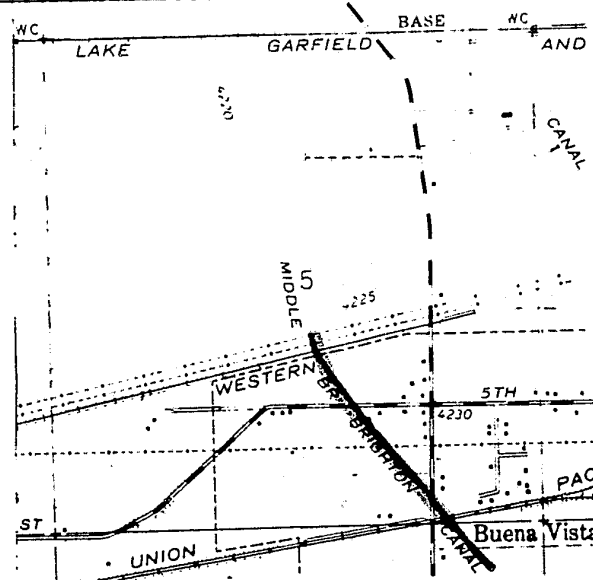

Beginning at Engineer's Station 68+65.43 which point is on the south line of Section 5, T1S, R1W, SLB & M, said point being 1000.00 feet more or less west of the southeast corner of said Section 5 and running thence  $N41^{\circ}57'54''W$ , 908 feet; thence  $N34^{\circ}32'54''W$ , 412 feet; thence  $N39^{\circ}07'54''W$ , 360 feet; thence  $N36^{\circ}37'54''W$ , 510 feet; thence north-westerly 293.06 feet along the arc of a 665 foot radius curve to the right (long chord bears  $N24^{\circ}00'24''W$ ) to Engineer's Station 93+15.43 which is the end of the Middle Branch, said end point being 2040 feet more or less north and 2490 feet more or less west of the southeast corner of Section 5, T1S, R1W, SLB & M.

CENTERLINE DESCRIPTION  
OF THE  
WEST BRANCH OF THE BRIGHTON NORTH POINT CANAL  
(55' right-of-way, 27.5' on either side of centerline)

Section 22, T1S, R1W

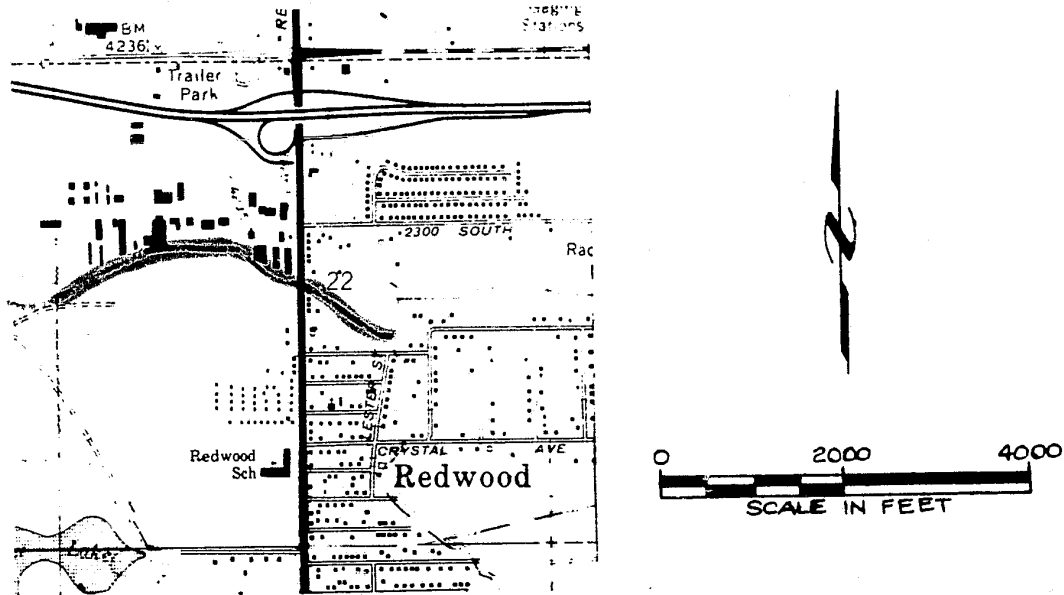

Beginning at Engineer's Station 0+00 which is the beginning of the West Branch of the Brighton North Point Canal as well as the beginning of the East Branch and the end of the Main Canal, said point being on the North side of 2495 South Street, said point also being 500 feet more or less South and 985 feet more or less East of the monument at the center of Section 22, T1S, R1W, SLB & M, and thence following the centerline of the West Branch N24°24'W, 75.00 feet; thence northwesterly 118.44 feet along the arc of a 170 foot radius curve to the left (long chord bears N44°21'30"W); thence N64°19'W, 237.00 feet; thence northwesterly 111.23 feet along the arc of a 665 foot radius curve to the right (long chord bears N59°31'30"W); thence N54°44'W, 445.00 feet; thence N56°39'W, 126.00 feet; thence northwesterly 81.43 feet along the arc of a 136 foot radius curve to the left (long chord bears N73°48'12"W); thence N89°57'25"W, 105.00 feet through a culvert beneath Redwood Road; thence N56°32'25"W, 218.00 feet; thence northwesterly 66.99 feet along the arc of a 456 foot radius curve to the left (long chord bears N60°44'55"W); thence N64°57'25"W, 170.00 feet; thence northwesterly 113.90 feet along the arc of a 231 foot radius curve to the right (long chord bears N50°49'55"W); thence N36°42'25"W, 80.00 feet; thence northwesterly 165.97 feet along the arc of a 182 foot radius curve to the left (long chord bears N62°49'55"W); thence N88°57'25"W, 853.00 feet; thence southwesterly 93.48 feet along the arc of a 208 foot radius curve to the left (long chord bears S78°10'05"W); thence S65°17'35"W, 1129.00 feet more or less to Engineer's Station 41+89.44 which point is on the west line of Section 22, said point being 102 feet more or less North of the W 1/4 corner, Section 22, T1S, R1W.

BOOK 5227 PAGE 1421

CENTERLINE DESCRIPTION  
OF THE  
WEST BRANCH OF THE BRIGHTON NORTH POINT CANAL  
(continued)  
(55' right-of-way, 27.5' either side of centerline)

Section 21, T1S, R1W

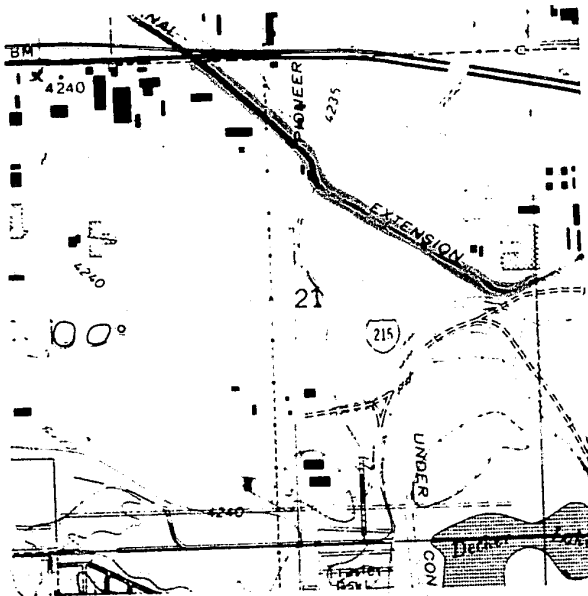

Beginning at Engineer's Station 41+89.44 which point is on the East line of Section 21, said point being 102 feet more or less north of the W 1/4 corner, Section 22, T1S, R1W, SLB & M and running thence S65°17'35"W, 33.00 feet; thence southwesterly 139.73 feet along the arc of a 397 foot radius curve to the right (long chord bears S75°22'35"W); thence S85°27'35"W, 108.00 feet; thence northwesterly 148.33 feet along the arc of a 238 foot radius curve to the right (long chord bears N76°41'09"W); thence N58°49'54"W, 775.00 feet more or less to the east right-of-way line of I-215; thence N58°49'54"W, 1274.00 feet; thence northwesterly 255.25 feet along the arc of a 250 foot radius curve to the right (long chord bears N29°34'54"W); thence northwesterly 35.33 feet along the arc of a 48 foot radius curve to the left (long chord bears N21°54'54"W); thence N42°29'54"W, 380.00 feet more or less to Engineer's Station 73+38.08, said point being on the centerline of 2700 West Street; thence N42°29'54"W, 752.00 feet; thence northwesterly 199.30 feet along the arc of a 1015 foot radius curve to the left (long chord bears N48°37'24"W); thence N54°14'54"W, 450.00 feet more or less to Engineer's Station 87+39.38, which point is on the centerline of 2100 South Expressway; said point also being on the north line of Section 21, said point being 1017 feet more or less west of the north quarter corner of said Section 21, T1S, R1W, SLB & M.

rev. 1-81

CENTERLINE DESCRIPTION  
OF THE  
WEST BRANCH OF THE BRIGHTON NORTH POINT CANAL  
(continued)  
(55' right-of-way, 27.5' either side of centerline)

Section 16, T1S, R1W

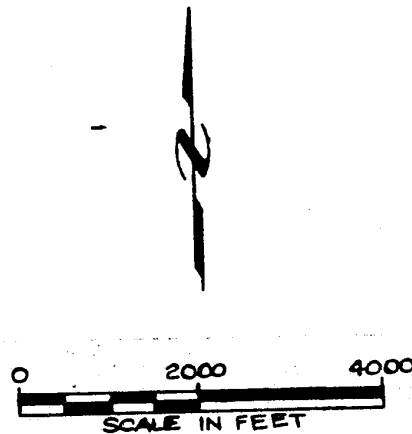
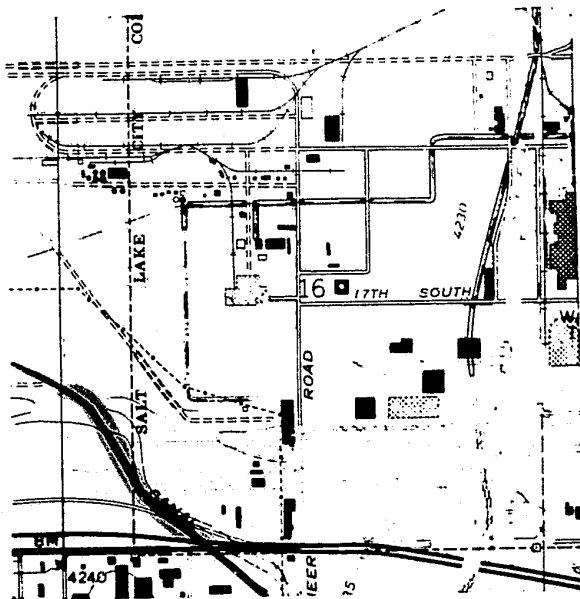

Beginning at Engineer's Station 87+39.38, which point is on the centerline of 2100 South Expressway and also being on the south line of Section 16, said point being 1017 feet more or less west of the south quarter corner of said Section 16, T1S, R1W, SLB & M and running thence  $N54^{\circ}14'54''W$ , 760.00 feet; thence northwesterly 519.24 feet along the arc of a 1000 foot radius curve to the right (long chord bears  $N39^{\circ}22'24''W$ ); thence  $N24^{\circ}29'54''W$ , 760.00 feet; thence northwesterly 200.52 feet along the arc of a 303 foot radius curve to the left (long chord bears  $N43^{\circ}27'24''W$ ); thence  $N62^{\circ}24'54''W$ , 350.00 feet more or less to Engineer's Station 112+53.62, which is a point on the west line of Section 16, said point being 1788 feet more or less north of the southwest corner of said Section 16, T1S, R1W, SLB & M.

rev. 1-81

CENTERLINE DESCRIPTION  
OF THE  
WEST BRANCH OF THE BRIGHTON NORTH POINT CANAL  
(continued)  
(60' right-of-way, 30' either side of centerline)

Section 17, T1S, R1W

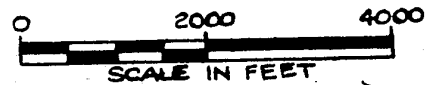
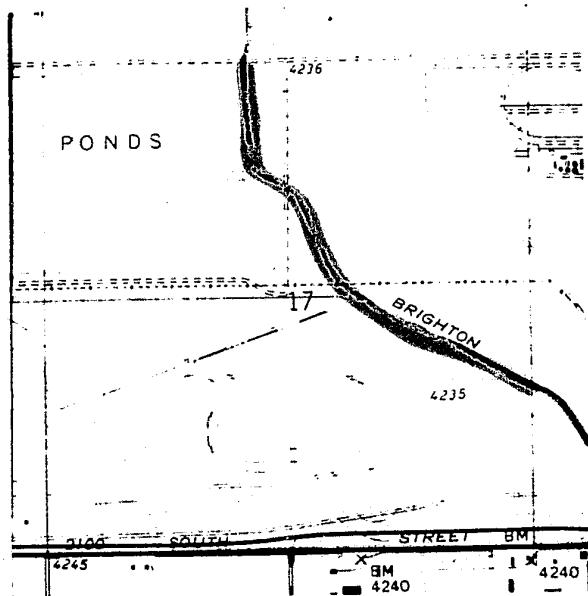

Beginning at Engineer's Station 112+53.62 which is a point on the east line of Section 17, said point being 1788 feet more or less north of the southeast corner of said Section 17, T1S, R1W, SLB & M and running thence  $N62^{\circ}24'54''W$ , 1081.00 feet; thence northwesterly 617.85 feet along the arc of an 800 foot radius curve to the right (long chord bears  $N40^{\circ}17'24''W$ ); thence  $N18^{\circ}09'54''W$ , 312.00 feet; thence northwesterly 608.21 feet along the arc of a 792 foot radius curve to the left (long chord bears  $N40^{\circ}09'54''W$ ); thence  $N62^{\circ}09'54''W$ , 302.00 feet; thence northwesterly 129.95 feet along the arc of a 128 foot radius curve to the right (long chord bears  $N33^{\circ}04'54''W$ ); thence  $N3^{\circ}59'54''W$ , 1104.00 feet; thence northeasterly 20.00 feet along the arc of a 200 foot radius curve to the right (long chord bears  $N1^{\circ}08'01''W$ ) to Engineer's POC Station 164+99.63 which point is a point on the north line of Section 17, said point being 415 feet more or less west of the north 1/4 corner of said Section 17, T1S, R1W, SLB & M.

rev. 1-81

CENTERLINE DESCRIPTION  
OF THE  
WEST BRANCH OF THE BRIGHTON NORTH POINT CANAL  
(continued)  
(55' right-of-way, 27.5 either side of centerline)

Section 8, T1S, R1W

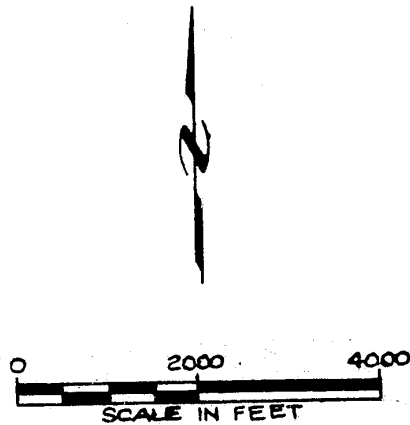
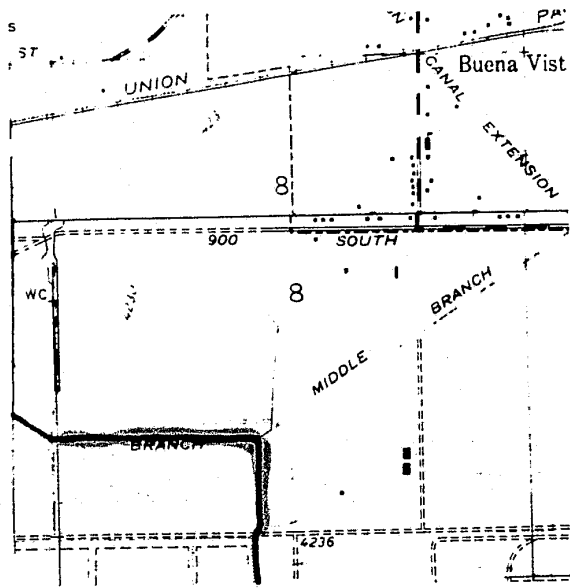

Beginning at Engineer's POC Station 164+99.63 which point is on the south line of Section 8, said point being 415 feet more or less west of the south 1/4 corner of said Section 8, T1S, R1W and running thence northeasterly 65.23 feet along the arc of a 200 foot radius curve to the right (long chord bears N11°04'36"E); thence N20°25'06"E, 44.00 feet; thence northeasterly 73.05 feet along the arc of a 205 foot radius curve to the left (long chord bears N10°12'36"E); thence N0°00'06"E, 900.00 feet to the point of beginning of the Middle Branch of the Brighton North Point Canal; thence N0°00'06"E, 45 feet; thence N89°45'W, 2217.00 feet more or less to Engineer's Station 198+43.91 which point is on the west line of Section 8, which point lies 1132 more or less feet north of southwest corner of said Section 8, T1S, R1W, SLB & M.

rev. 1-81

CENTERLINE DESCRIPTION  
OF THE  
WEST BRANCH OF THE BRIGHTON NORTH POINT CANAL  
(continued)  
(53' right-of-way, 26.5' either side of centerline)

Section 7, T1S, R1W

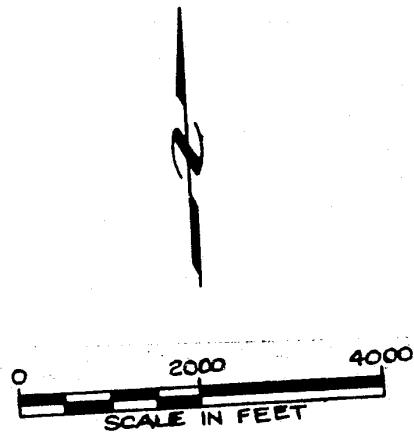
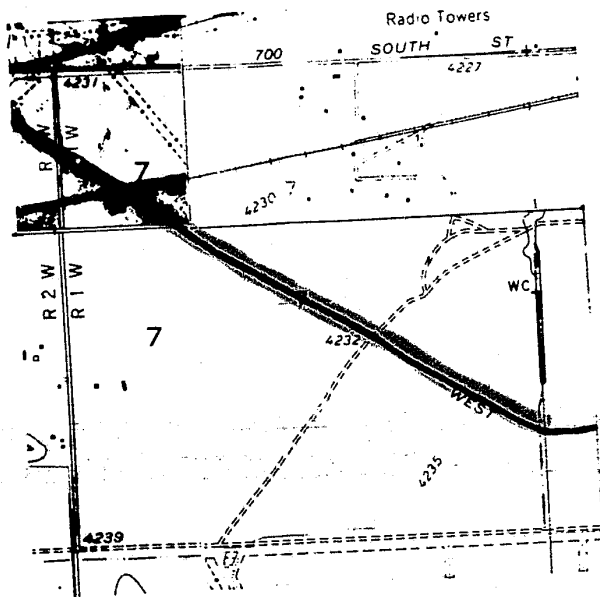

Beginning at Engineer's Station 198+43.91, which point is on the east line of Section 7, said point being 1132 feet north more or less of the southeast corner of said Section 7, T1S, R1W, SLB & M and running thence N89°45'W, 100 feet; thence northwesterly 55.56 feet along the arc of a 100 foot radius curve to the right (long chord bears N73°50'W); thence N57°55'W, 5300.53 feet to Engineer's Station 253+00 which point is the centerline of the Union Pacific Railroad; thence N57°55'W, 850.47 feet to Engineer's Station 261+50.47, which point is on the west line of Section 7, said point being 900 feet more or less south of the NW corner of said Section 7, T1S, R1W, SLB & M.

rev. 1-81



CENTERLINE DESCRIPTION  
OF THE  
WEST BRANCH OF THE BRIGHTON NORTH POINT CANAL  
(continued)  
(53' right-of-way, 26.5' either side of centerline)

Section 12, T1S, R2W

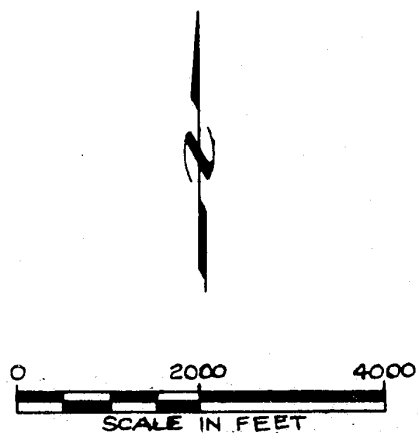
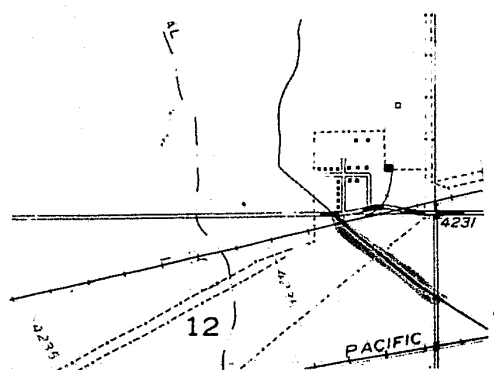

Beginning at Engineer's Station 261+50.47, which point is on the east line of Section 12, said point being 900 feet, more or less south of the NE corner of said Section 12, T1S, R2W, SLB & M and running thence N57°55'W, 128 feet; thence northwesterly 140.50 feet along the arc of a 805 foot radius curve to the right (long chord bears N52°55'W); thence N547°55'W, 1185 feet more or less to Engineer's Station 276+05.97 which point is on the North line of Section 12, said point also being in the centerline of 700 South Street, said point being 1090 feet more or less west of the northeast corner of said Section 12, T1S, R2W, SLB & M.

rev. 1-81

CENTERLINE DESCRIPTION  
OF THE  
WEST BRANCH OF THE BRIGHTON NORTH POINT CANAL  
(continued)  
(53' right-of-way, 26.5' either side of centerline)

Section 1, T1S, R1W

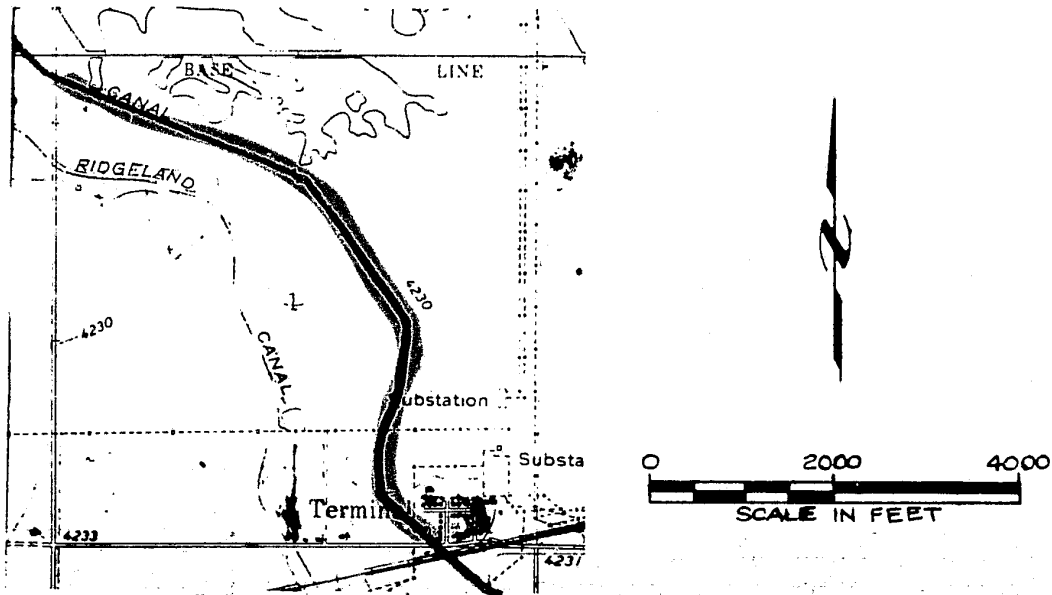

Beginning at Engineer's Station 276+05.97 which point is on the south line of Section 1, said point also being on the centerline of 700 South Street, said point being 1090 feet more or less west of the southeast corner of said Section 1, T1S, R2W, SLB & M and running thence  $N47^{\circ}55'W$ , 880.00 feet; thence  $N3^{\circ}05'E$ , 706.00 feet; thence northeasterly 138.73 feet along the arc of a 253.00 foot radius curve to the right (long chord bears  $N32^{\circ}57'30"E$ ); thence  $N34^{\circ}30'E$ , 192.00 feet; thence northeasterly 116.08 feet along the arc of a 232 foot radius curve to the left (long chord bears  $N20^{\circ}10'E$ ); thence  $N5^{\circ}50'E$ , 153.00 feet; thence northwesterly 88.24 feet along the arc of a 256 foot radius curve to the left (long chord bears  $N4^{\circ}02'38"W$ ); thence northeasterly 43.65 feet along the arc of an 88 foot radius curve to the right (long chord bears  $N0^{\circ}17'30"E$ ); thence  $N14^{\circ}30'E$ , 325.00 feet; thence northwesterly 300.85 feet along the arc of a 350 foot radius curve to the left (long chord bears  $N10^{\circ}07'30"W$ ); thence  $N34^{\circ}45'W$ , 1713.00 feet; thence northwesterly 114.26 feet along the arc of a 203 foot radius curve to the left (long chord bears  $N50^{\circ}52'30"W$ ); thence  $N67^{\circ}W$ , 2717.00 feet; thence  $N39^{\circ}15'W$ , 55.00 feet; thence  $N88^{\circ}55'W$ , 195.00 feet more or less to Engineer's Station 353+43.78 which point is on the west line of Section 1, said point being 273 feet more or less south of the northwest corner of said Section 1, T1S, R2W, SLB & M.

rev. 1-81

CENTERLINE DESCRIPTION  
 OF THE  
 WEST BRANCH OF THE BRIGHTON NORTH POINT CANAL  
 (continued)  
 (50' right-of-way, 25' either side of centerline)

Section 2, T1S, R2W

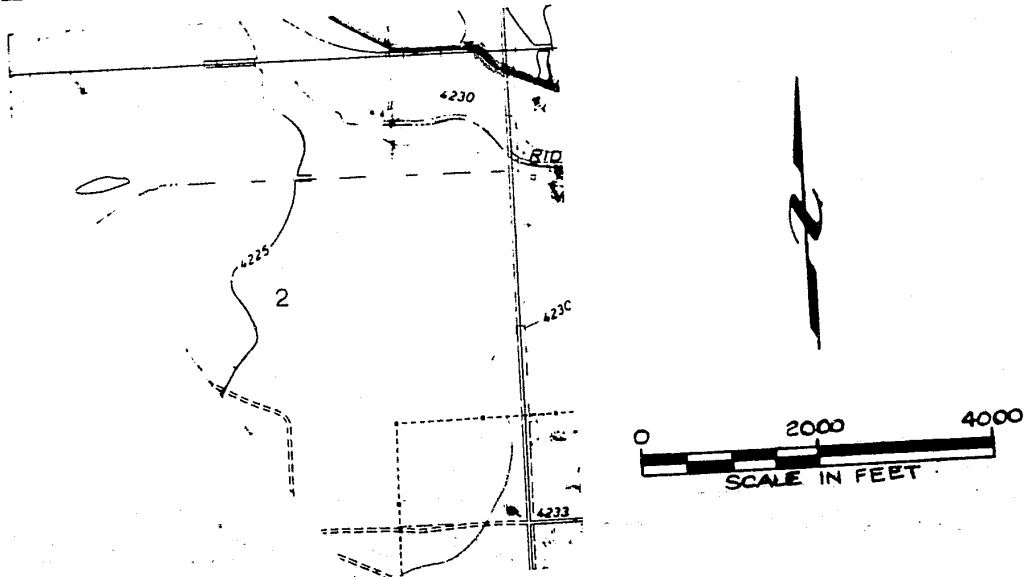

Beginning at Engineer's Station 353+43.78 which point is on the east line of Section 2, said point being 273 feet more or less south of the northeast corner of said Section 2, T1S, R2W, SLB & M, and running thence N88°55'W, 145 feet; thence N58°20'W, 104 feet; thence N87°20'W, 93.00 feet; thence N76°20'W, 230.00 feet; thence N66°15'W, 200.00 feet; thence N62°08'W, 200.00 feet more or less to Engineer's Station 363+15.78 which point is on the north line of Section 2, said point being 902 feet, more or less west of the northeast corner of said Section 2, T1S, R2W, SLB & M.

rev. 1-81

BOOK 5227 PAGE 1429

CENTERLINE DESCRIPTION  
OF THE  
WEST BRANCH OF THE BRIGHTON NORTH POINT CANAL  
(continued)  
(50' right-of-way, 25' either side of centerline)

Section 35, T1N, R2W

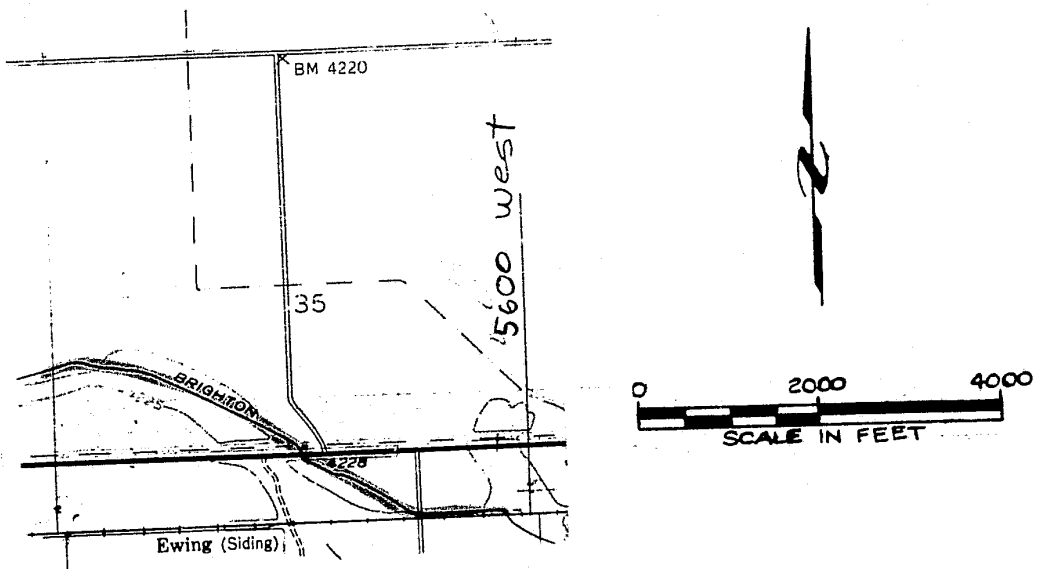

Beginning at Engineer's Station 363+15.78, which point is on the south line of Section 35, said point being 851 feet more or less west of the southeast corner of said Section 35, T1N, R2W, SLB & M and running thence N62°15'W, 155.00 feet; thence N89°18'W, 210.00 feet; thence northwesterly 27.21 feet along the arc of a 50 foot radius curve to the right (long chord bears N73°25'30"W); thence N57°38'W, 650.00 feet; thence northwesterly 83.24 feet along the arc of a 151 foot radius curve to the left (long chord bears N73°25'30"W); thence N89°13'W, 540.00 feet; thence northwesterly 75.48 feet along the arc of a 48 foot radius curve to the right (long chord bears N44°13'W); thence N0°47'E, 147.00 feet to Engineer's Station 382+03.71 which point is on the south right-of-way line of North Temple Street.

rev. 1-81

CENTERLINE DESCRIPTION  
OF THE  
WINKLE-KOTTER DITCH

(Being a branch of the Middle Branch of the Brighton  
North Point Canal)

30 foot right-of-way 15 feet either side of centerline

Section 8, T1S, R1W

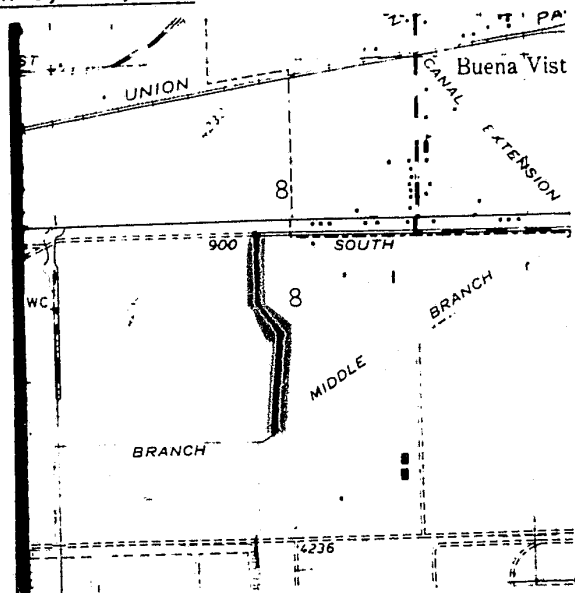

Beginning at Engineer's Station 0+00 which point lies 1185 feet more or less north and 220 feet more or less west of the south 1/4 corner of Section 8, T1S, R1W, SLB & M, said point being on the Middle Branch of the Brighton North Point Canal; thence  $N4^{\circ}25'E$ , 1137 feet; thence  $N38^{\circ}35'W$ , 465 feet; thence  $N0^{\circ}25'E$ , 776 feet to Engineer's Station 23+78 which is a point on the north right-of-way line of 900 South Street, said point being 3458 feet more or less north and 417 feet more or less west of said south 1/4 corner of Section 8.