

Return To:
LaVar Christensen
11681 S 700 E, Ste 200
Draper, UT 84020

ACCOMMODATION
RECORDING

Exhibit C
to
Declaration of Covenants, Conditions & Restrictions (“CCR”)
for the
Lexington Green Subdivision
Saratoga Springs, Utah

The City of Saratoga Springs, Utah has established a list of approved trees for the public streets within approved subdivisions. As provided therein and the Lexington Green CCR, the street tree plan as illustrated in Exhibit C attached hereto is adopted and established at Lexington Green. It applies to all lots within the recorded Plat and to the individual home locations in relation to the attached Street Tree Plan. All such trees shall be not less than 2” caliper. Exhibit C is fully incorporated by reference and included in the CCR of Lexington Green.

IN WITNESS WHEREOF, the Declarant has caused this Declaration to be properly executed by its duly authorized representative.

DECLARANT:

**LEXINGTON LAND DEVELOPMENT
COMPANY, LLC**

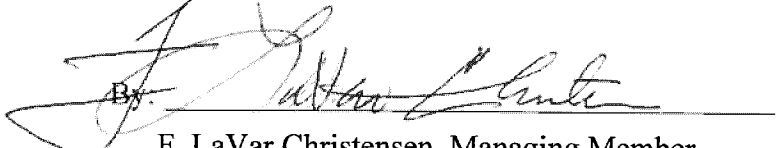
By: 
F. LaVar Christensen, Managing Member

STATE OF UTAH)
) ss.
COUNTY OF SALT LAKE)

I HEREBY CERTIFY that on the 10th day of August 2021 personally appeared F. LaVar Christensen, who acknowledged himself to be the Managing Member of **Lexington Land Development Company, LLC** and executed this Exhibit C to Declaration of Covenants and Restrictions on behalf of the said entity for the purposes therein contained and acknowledged the same to be the lawful act and deed of the aforesaid entity.

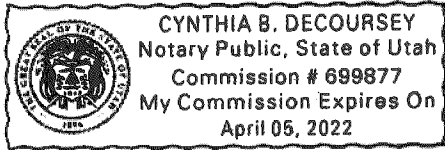

Notary Public: Cynthia B. DeCoursey
Residing at: Bluffdale, Utah

LEGAL DESCRIPTION

Lexington Green – Single Family Area

Beginning at a point on the Northerly Right-of-Way Line of Pony Express Parkway, said point being South 89°33'20" West 911.18 feet along the section line and North 00°26'40" West 90.00 feet from the South Quarter Corner of Section 22, Township 5 South, Range 1 West, Salt Lake Base and Meridian; and running

thence South 89°33'20" West 421.81 feet along the Northerly Right-of-Way Line of Pony Express Parkway;

thence North 00°18'08" East 1,029.96 feet to the Southerly Right-of-Way Line of Fairfield Road;

thence North 56°28'20" East 1,163.83 feet along the Southerly Right-of-Way Line of Fairfield Road;

thence Southeasterly 764.07 feet along the arc of a 4,907.50 foot radius curve to the left (center bears South 87°24'59" East and the chord bears South 01°52'36" East 763.30 feet with a central angle of 08°55'14");

thence North 89°55'31" West 481.75 feet;

thence Southwesterly 111.66 feet along the arc of a 229.50 foot radius curve to the right (center bears North 83°58'33" West and the chord bears South 19°57'46" West 110.57 feet with a central angle of 27°52'38");





thence Southwesterly 223.12 feet along the arc of a 380.50 foot radius curve to the left (center bears South 56°05'54" East and the chord bears South 17°06'10" West 219.94 feet with a central angle of 33°35'51");

thence South 00°18'15" West 428.63 feet;

thence South 06°20'43" East 73.40 feet;

thence South 00°18'14" West 91.54 feet to the point of beginning.

Contains 819,913 Square Feet or 18.823 Acres

-  Little Leaf Linden (*Tilia Cordata*)
-  Silver Linden (*Tilia Tomentosa*)
-  Armstrong Maple (*Acer freemanii*)
-  Thornless Honeylocust (*Gleditsia triacanthos var. inermis*)
-  Cimmarron Green Ash (*Fraxinus pennsylvanica "Cimmarron"*)

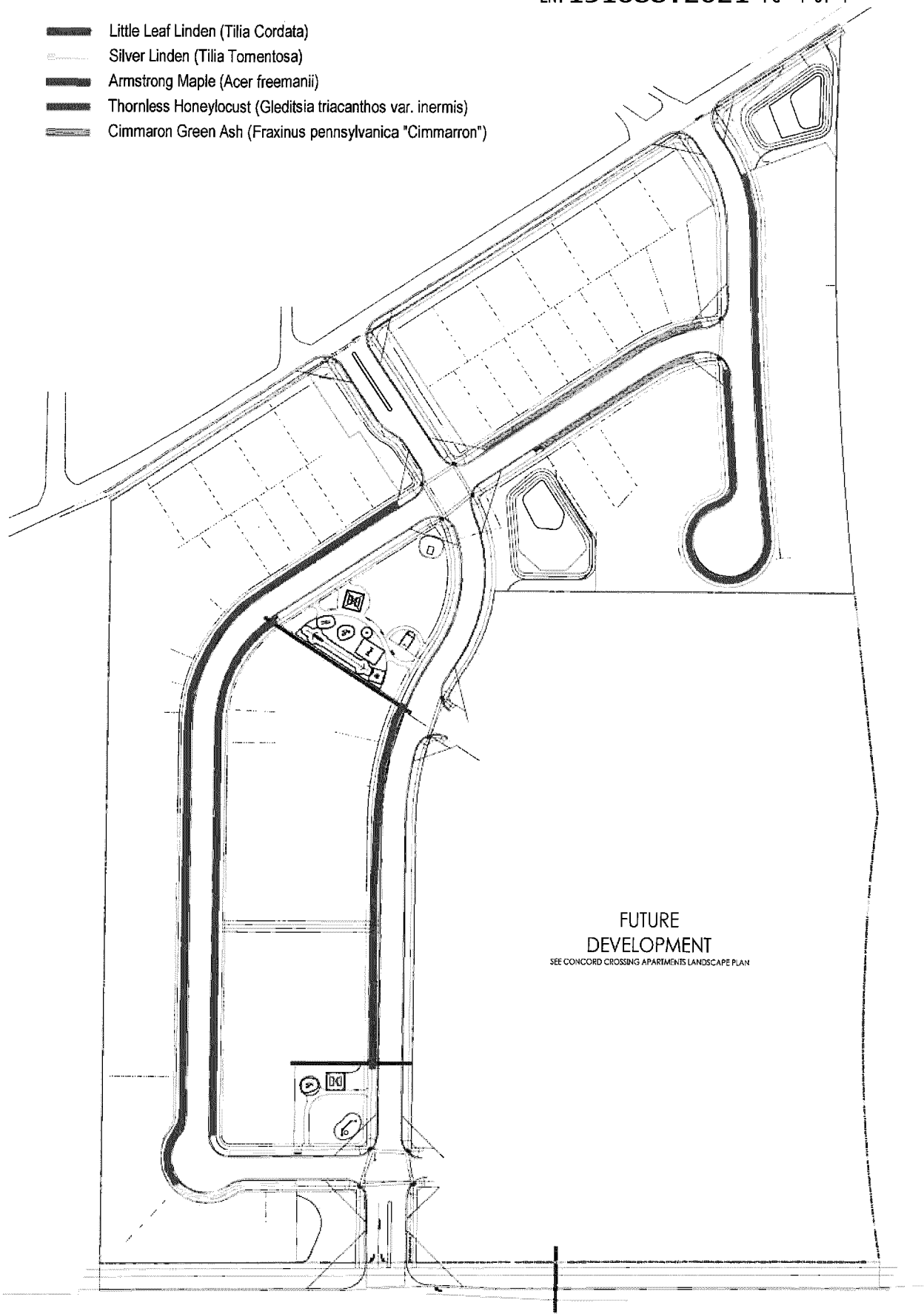

FUTURE
DEVELOPMENT
SEE CONCORD CROSSING APARTMENTS LANDSCAPE PLAN



May 03, 2021



Street Tree Plantings
Lexington Green Development, Saratoga Springs, Utah