

LEGEND

	FOUND SECTION CORNER		SEWER MANHOLE
	SECTION CORNER (NOT FOUND)		EXISTING FIRE HYDRANT
	FOUND BRASS CAP MONUMENT (NOT FOUND)		WATER MANHOLE
	SET REBAR AND CAP OR NAIL AND WASHER STAMPED "GILSON ENG."		POWER POLE
	FOUND REBAR AND CAP		TELEPHONE POLE
	SECTION LINE		TREE LINE
	BOUNDARY LINE		BUILDING
	CENTERLINE		CONCRETE
	CHAINLINK FENCE		ASPHALT
	WOOD OR WIRE FENCE		CONTOUR LINE
	EDGE OF ASPHALT		EDGE OF CONCRETE ADJOINING DEED LINES
	POWER LINE		
	WATER LINE		
	FIBER OPTICS		
	GAS LINE		

LEGAL DESCRIPTION PER TITLE REPORT

COMMENCING AT A POINT 20 RODS NORTH AND 34 RODS WEST OF THE SOUTHEAST CORNER OF LOT 7, BLOCK 23, BRIGHTON FARMINGTON PLAT SURVEY; THENCE NORTH 8 RODS; THENCE WEST 35 RODS, MORE OR LESS, TO A 4 ROD STREET; THENCE SOUTH 8 RODS; THENCE EAST 35 RODS, MORE OR LESS, TO THE PLACE OF BEGINNING, BEING IN THE NORTHEAST QUARTER OF SECTION 8, TOWNSHIP 1 SOUTH, RANGE 1 WEST, SALT LAKE MERIDIAN.

AS SURVEYED DESCRIPTION

A PARCEL OF LAND LOCATED IN THE NORTHEAST QUARTER OF SECTION 8, TOWNSHIP 1 SOUTH, RANGE 1 WEST, SALT LAKE BASE AND MERIDIAN. ALSO BEING LOCATED WITHIN THE BOUNDS OF SALT LAKE CITY UTAH AND BEING MORE PARTICULARLY DESCRIBED AS FOLLOWS:

BEGINNING AT A POINT ON THE EASTERLY RIGHT OF WAY LINE OF GLADIOLA STREET AS ESTABLISHED BY GLADIOLA STREET OFFICIAL SEGMENT MAP NO. 5 DATED JULY 25, 1989 AND RECORDED FEBRUARY 1993 WITH THE OFFICE OF THE SALT LAKE COUNTY RECORDER, SAID POINT BEING LOCATED NORTH 00°04'30" WEST ALONG THE MONUMENT LINE OF GLADIOLA STREET (BASIS OF BEARING) 361.67 FEET AND SOUTH 89°57'34" EAST 42.00 FEET FROM THE SALT LAKE CITY SURVEYORS MONUMENT AT THE INTERSECTION OF 900 SOUTH STREET AND GLADIOLA STREET AND RUNNING THENCE NORTH 00°04'30" WEST ALONG SAID EASTERLY RIGHT OF WAY LINE 132.00 FEET; THENCE SOUTH 89°57'34" EAST 571.87 FEET; THENCE SOUTH 00°04'30" EAST 132.00 FEET; THENCE NORTH 89°57'34" WEST 571.87 FEET TO THE POINT OF BEGINNING.

CONTAINS: 1.733 ACRES OR 75495 SQ. FT.
SURVEYOR'S CERTIFICATE

TO:
 J. THOMAS BOWEN,
 AMERICAN TITLE INSURANCE COMPANY:
 THIS IS TO CERTIFY THAT THIS MAP OR PLAT AND THE SURVEY ON WHICH IT IS BASED WERE MADE IN ACCORDANCE WITH THE "MINIMUM STANDARD DETAIL REQUIREMENTS FOR ALTA/ACSM LAND TITLE SURVEYS," JOINTLY ESTABLISHED AND ADOPTED BY ALTA AND NSPS IN 2005, PURSUANT TO THE ACCURACY STANDARDS AS ADOPTED BY ALTA AND NSPS AND EFFECT ON THE DATE OF THIS CERTIFICATION, UNDERSIGNED FURTHER CERTIFIES THAT IN MY PROFESSIONAL OPINION, AS A LAND SURVEYOR REGISTERED IN THE STATE OF UTAH, THE RELATIVE POSITIONAL ACCURACY OF THIS SURVEY DOES NOT EXCEED THAT WHICH IS SPECIFIED THEREIN.

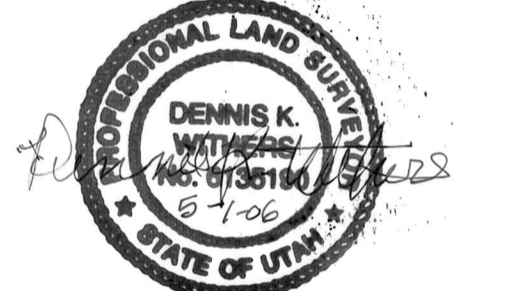

DENNIS K. WITHERS PLS
 NO. 6135190

THE 2005 MINIMUM STANDARD DETAIL REQUIREMENTS FOR ALTA/ACSM LAND TITLE SURVEYS ARE EFFECTIVE JANUARY 1, 2006. AS OF THAT DATE, ALL PREVIOUS VERSIONS OF THE MINIMUM STANDARD DETAIL REQUIREMENTS FOR ALTA/ACSM LAND TITLE SURVEYS ARE SUPERSEDED BY THESE 2005 STANDARDS

ADOPTED BY THE AMERICAN LAND TITLE ASSOCIATION ON OCTOBER 5, 2005 ADOPTED BY THE BOARD OF DIRECTORS, NATIONAL SOCIETY OF PROFESSIONAL SURVEYS ON OCTOBER 24, 2005
 AMERICAN LAND TITLE ASSOCIATION, 1828 L. N.W., SUITE 705, WASHINGTON, D.C. 20036.
 NATIONAL SOCIETY OF PROFESSIONAL SURVEYS, INC., MONTGOMERY VILLAGE AVENUE, SUITE 403, GAITHERSBURG, MD 20879

NARRATIVE

THE PURPOSE OF THIS SURVEY IS TO PERFORM AN ALTA/ACSM SURVEY ON THE ABOVE REFERENCED PARCEL PER THE CLIENTS REQUEST. THE BASIS OF BEARING FOR THIS SURVEY IS NORTH 00°04'30" WEST ALONG THE MONUMENT LINE OF GLADIOLA STREET FROM THE FOUND SALT LAKE CITY BRASS CAP MONUMENT AT THE INTERSECTION 900 SOUTH STREET AND GLADIOLA STREET TO THE FOUND SALT LAKE CITY BRASS CAP MONUMENT MARKING THE INTERSECTION OF 500 SOUTH STREET AND GLADIOLA STREET AS SHOWN HEREON.

THIS SURVEY DOUSE NOT CONSTITUTE A TITLE SEARCH BY THE SURVEYOR. ALL INFORMATION PERTAINING TO ADJOINING PROPERTIES AND EASEMENTS THAT MIGHT AFFECT THE QUALITY OF TITLE OF THE SUBJECT PARCEL SHOWN HEREON WAS OBTAINED FROM COMMITMENT NO.: 24842 PREPARED BY FIRST AMERICAN TITLE INSURANCE COMPANY. EFFECTIVE MAY 8, 2006 AT 8:00 AM. THE FOLLOWING COMMENTS CORRESPOND TO THE ONES NUMBERED IN THE ABOVE REFERENCE TITLE COMMITMENT.

- SCHEDULE B-2 EXCEPTION NO.:
- Ⓢ EASEMENT FOR THE BRIGHTON - NORTH CANAL AS DISCLOSED BY THAT CERTAIN RESOLUTION, DATED FEBRUARY 27, 1981, RECORDED MARCH 27, 1981, AS ENTRY NO. 3546750, IN BOOK 5227, AT PAGE 1403, SALT LAKE COUNTY RECORDER'S OFFICE. (NOT AFFECTING PARCEL)
 - Ⓢ EASEMENT TO USE DISTRIBUTION SYSTEMS, DATED MAY 22, 1986, WITH BRIGHTON AND NORTH POINT IRRIGATION COMPANY, A CORPORATION, AS GRANTOR IN FAVOR OF THE STATE OF UTAH, ACTING THROUGH THE BOARD OF WATER RESOURCES, GRANTEE, AN EASEMENT TO USE THE EXISTING WATER DISTRIBUTION SYSTEM OF CANALS, DITCHES, PIPELINES AND ALL APPURTENANT WORKS AND FACILITIES OF THE BRIGHTON AND NORTH POINT IRRIGATION COMPANY A PORTION OF THE SUBJECT PROPERTY. SAID EASEMENT RECORDED SEPTEMBER 26, 1986, AS ENTRY 4680089, IN BOOK 6067, AT PAGE 404, SALT LAKE COUNTY RECORDER'S OFFICE. (BLANKET EASEMENT)
 - Ⓢ AVIATION EASEMENT IN FAVOR OF SALT LAKE CITY CORPORATION FOR THE FREE AND UNRESTRICTED PASSAGE OF AIRCRAFT OF ANY AND ALL KINDS IN, THROUGH, ACROSS AND ABOUT THE AIRSPACE OVER THE LAND RECORDED FEBRUARY 24, 1995 AS ENTRY NO. 6028326 IN BOOK 7106 AT PAGE 1770 OF OFFICIAL RECORDS. (BLANKET EASEMENT OVER SUBJECT AND SURROUNDING PARCELS)

UTILITY COMPANY	CONTACT	CONTACT NUMBER	STATUS
COMCAST	GARY GOLDSTEIN	801-401-3041	N/A
ELECTRIC LIGHTWAVE	DON WATTSON	801-924-6615	N/A
QWEST	ARLENE COMSTOCK	Arlene.Comstock@QWest.com	SHOWN
MCI	MCI	972-729-6016	WAITING
UTAH POWER & LIGHT	KEVIN BURGHARDT	Kevin.Burghardt@PacifiCorp.com	SHOWN
QUESTAR GAS	RON EAVENSON	801-324-3870	SHOWN
AT&T	ROB WILLIAMSON	206-338-2816	WAITING
BROADWING COMMUNICATIONS	BLAIR	512-742-1428	WAITING
SALT LAKE CITY PUBLIC UTILITIES	NICK KRYGER	801-483-6834	SHOWN
SPRINT COMMUNICATIONS	NICK MULLER	303-789-4745	WAITING
XO COMMUNICATIONS	KIRK HANSEN	801-964-1063	WAITING

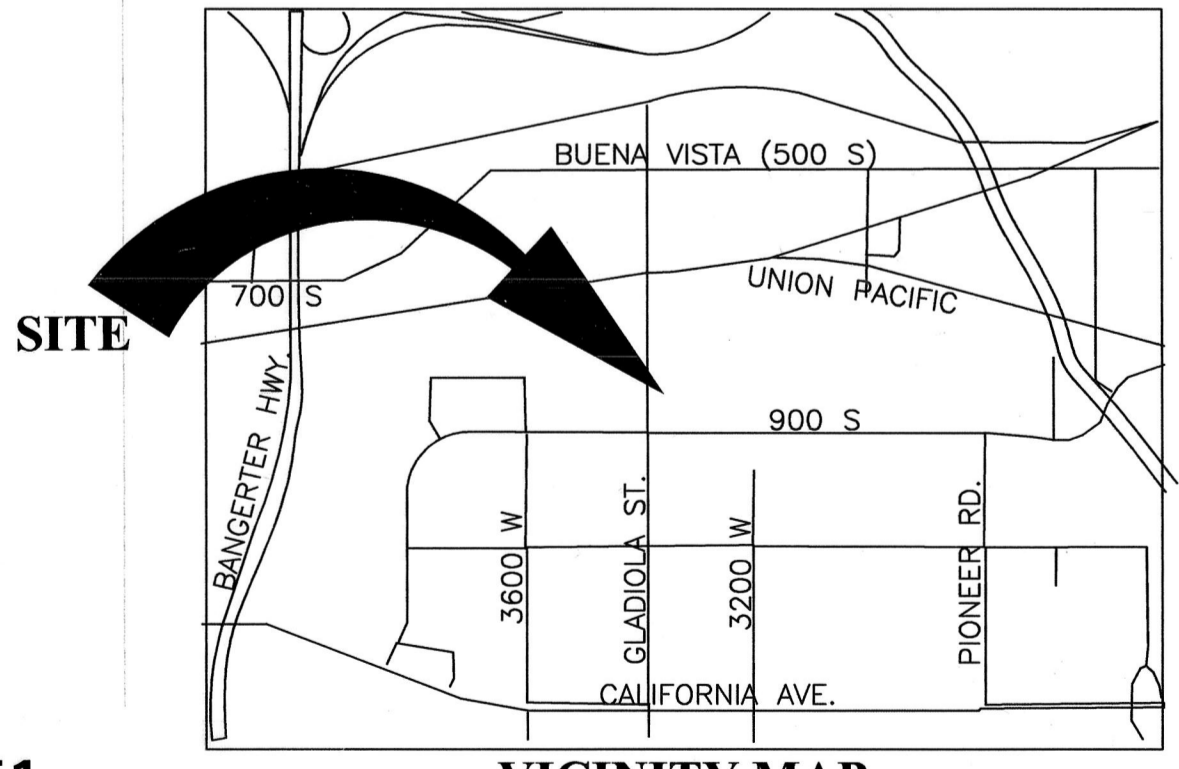

S2006-08-0751
Vaughn E. Butler, P.L.S.
 SALT LAKE COUNTY SURVEYOR

Draper Office:
 12401 South 450 East
 (801) 571-9414
 Fax: (801) 571-9449

Riverdale Office:
 5440 South 1700 West
 (801) 773-1191
 Fax: (801) 773-0091

www.gilsonengineering.com

J. THOMAS BOWEN
 935 E SOUTH UNION AVE.
 SUITE D 102
 MIDVALE UTAH

RICHARDS PARCEL
841 SOUTH GLADIOLA STREET
 SALT LAKE CITY, UTAH
 LOCATED IN THE NORTHEAST QUARTER OF SECTION 8, TOWNSHIP 1 SOUTH, RANGE 1 WEST, SALT LAKE BASE AND MERIDIAN

DATE: MAY 01, 2006
 EXBOW010.GWG
 DESIGNED/DRAWN BY: KW/KSH
 CHECKED: DKW/JFM

REV	DATE	BY	REVISIONS COMMENTS

0 1 BAR SCALE MEASURES 1" ON FULL SIZE SHEETS ADJUST ACCORDINGLY FOR REDUCED SIZE SHEETS

REV.
BOW.010.06
 ALTA/ACSM LAND TITLE SURVEY