

ENTRY NO. 01001369

08/22/2014 02:41:56 PM B: 2253 P: 1763

Quit Claim Deed PAGE 1/6
MARY ANN TRUSSELL, SUMMIT COUNTY RECORDER
FEE 77.00 BY GARY PACE



When recorded return to:

Jonathan R. Schutz
175 S. Main St., Suite 1330
Salt Lake City, UT 84111

PARCEL #: NS-116-E; NS-110; NS-604-C; NS-604-D-1; NS-604-H-2; NS-604-H-1; NS-604-H-2; NS-598; NS-594; NS-594-D; NS-594-B; NS-595-B; MCM-1; NS-595; NS-599; NS-599-B; NS-599-A; SHS-A-AM; SHS-1-AM; SHS-2-AM; NS-589; NS-585-F; NS-585-D; NS-585-C; NS-584-1; HRV-ARG-A; HRV-2; NS-584-5; NS-584; HRV-1; NS-581; SSM-3; SSM-2; SSM-1; LV-1; LV-4; LV-3; LV-2; NS-459-A; NS-459-5; NS-459-6; NS-459-3-A; NS-459-3; NS-459-1-A; NS-459-1-D; NS-459-1-C; NS-459-1; NS-453-2; NS-453-6; NS-453-4; NS-456; NS-455-A; NS-458; NS-462; NS-459-B; NS-434; NS-435; NS-436;

EASEMENT QUITCLAIM DEED

In consideration of less than ONE HUNDRED DOLLARS, **West Hoytsville Irrigation Company**, a Utah Non-profit corporation ("Grantor"), quitclaims, conveys and releases to the **North Summit Pressurized Irrigation Company**, a Utah non-profit corporation ("Grantee"), any and all interest Grantor possesses in its established easement for water conveyance facilities, allowing Grantee to own, maintain, repair, replace, remove, and carry water through a pipeline within the easement. The easement extends 15 feet to the east side and 15 feet to the west side of the centerline of the water conveyance facilities; the center line is described as follows:

SEE EXHIBIT A

Dated this 22 day of Aug, 2014.

WEST HOYTSVILLE IRRIGATION COMPANY

By Gary M Pace
Printed Name Gary M. Pace
Title: Pres

By _____
Printed Name _____
Title: _____

457

State of Utah)
) ss.
County of Summit)

01001369 Page 2 of 6 Summit County

The foregoing Easement was acknowledged and executed before me this 22nd day of August, 2014, by Gary M. Pace.

IN WITNESS WHEREOF, I have hereunto set my hand and affixed my official seal the day and year first above written.

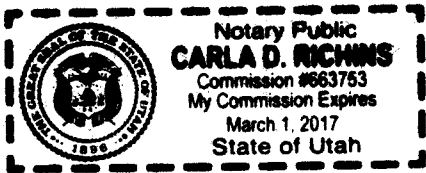

Carla D. Richins
Notary Public
Residing at: Summit County

State of Utah)
) ss.
County of Summit)

The foregoing Easement was acknowledged and executed before me this _____ day of _____, 2014, by _____.

IN WITNESS WHEREOF, I have hereunto set my hand and affixed my official seal the day and year first above written.

Notary Public
Residing at:

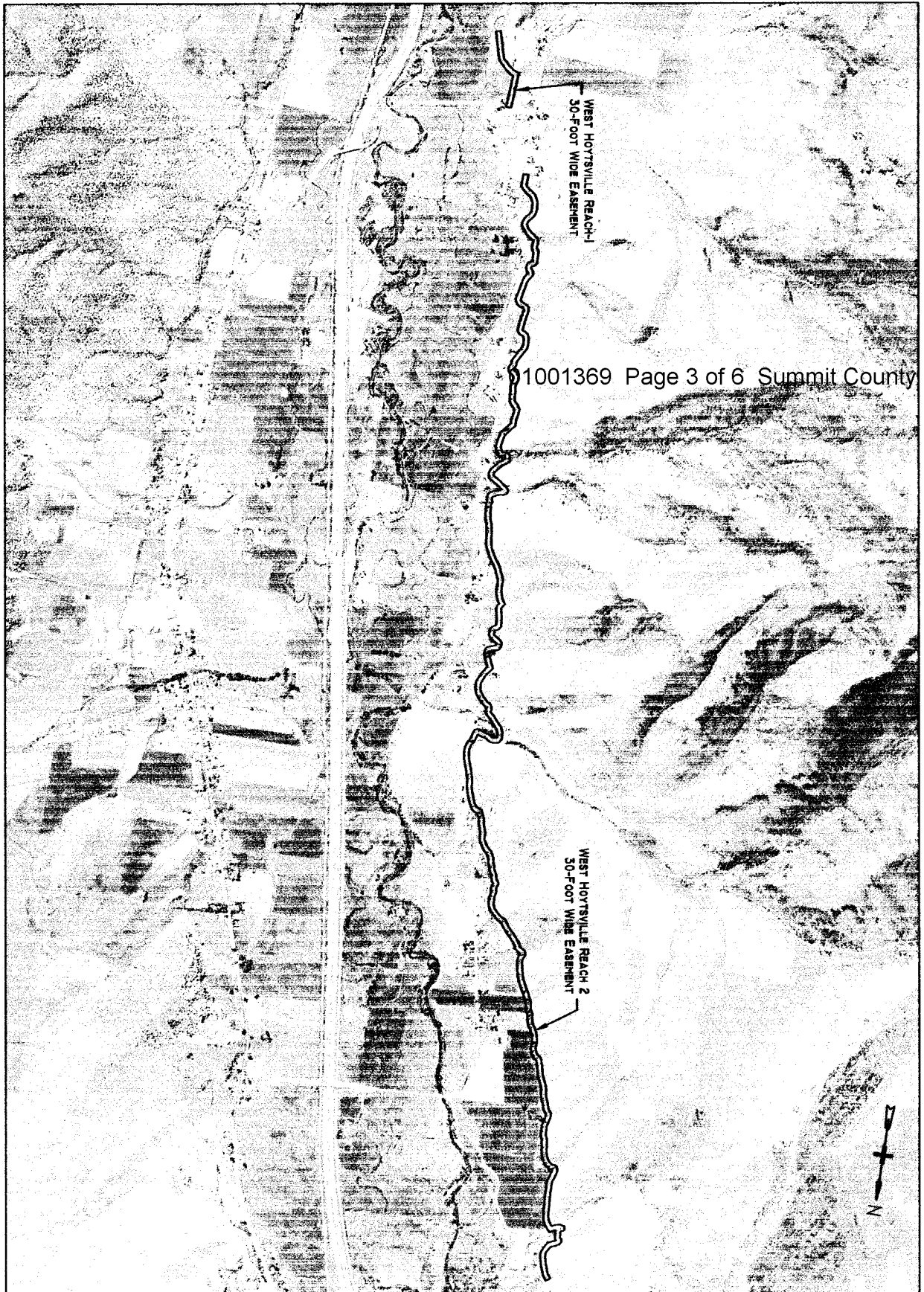

WEST HOYTSVILLE REACH 1
30-FOOT WIDE EASEMENT

WEST HOYTSVILLE REACH 2
30-FOOT WIDE EASEMENT

1001369 Page 3 of 6 Summit County



EXHIBIT A WEST HOYTSVILLE AND REACH I CANAL EASEMENTS	PROJECT LEADER: LAYNE JENSEN	NORTH SUMMIT PRESSURIZED IRRIGATION COMPANY NORTH SUMMIT PRESSURIZED IRRIGATION SYSTEM	 FRANSON CIVIL ENGINEERS
	DRAFTER/MAN: CONNIE ROBINSON		
	DATE: FEBRUARY 5, 2015		
	W Hoytsville & Reach 1.dwg INCLUDES: Reach 1 Water Control Structure - Design/Construct CL Features LAYOUT: W Hoytsville Canal Easement		

Exhibit A

Canal Centerline Easement – West Hoytsville Canal Reach 1

Legal Description along the West Hoytsville Reach 1 Canal Centerline for a 30-foot wide easement. Said easement being 15 feet from each side of canal centerline. Said Canal Reach crosses parcels NS-116-E, and NS-110. Said centerline more particularly described as follows:

Beginning at a point located S 00° 07' 23" W 1057.34 feet and 173.12 feet West from the northeast corner of Section 4, Township 1 North, Range 5 East, Salt Lake Base & Meridian; thence S 05° 54' 38" W 52.90 feet; thence S 53° 59' 36" W 34.57 feet; thence S 28° 36' 39" W 91.76 feet; thence S 03° 22' 09" E 49.43 feet; thence S 26° 51' 47" E 75.30 feet; thence S 04° 24' 06" E 30.27 feet; thence S 07° 37' 04" W 127.06 feet; thence S 12° 52' 12" W 60.00 feet; thence S 02° 12' 07" E 18.09 feet; thence S 61° 54' 59" E 18.30 feet; thence N 77° 51' 15" E 38.61 feet; thence S 66° 46' 51" E 57.04 feet; thence S 50° 11' 05" E 242.94 feet; thence S 29° 06' 15" E 83.85 feet; thence S 15° 31' 05" E 425.37 feet to end of West Hoytsville Reach 1 Canal Centerline.

Exhibit A

Canal Centerline Easement – West Hoytsville Canal Reach 2

Legal Description along the West Hoytsville Canal Centerline for a 30-foot wide easement. Said easement being 15 feet from each side of canal centerline. Said canal crosses Parcels: NS-604-C; NS-604-D-1; NS-604-H-2; NS-604-H-1; NS-604-H-2; NS-598; NS-594; NS-594-D; NS-594-B; NS-595-B; MCM-1; NS-595; NS-599; NS-599-B; NS-599-A; SHS-A-AM; SHS-1-AM; SHS-2-AM; NS-589; NS-585-F; NS-585-D; NS-585-C; NS-584-1; HRV-ARG-A; HRV-2; NS-584-5; NS-584; HRV-1; NS-581; SSM-3; SSM-2; SSM-1; LV-1; LV-4; LV-3; LV-2; NS-459-A; NS-459-5; NS-459-6; NS-459-3-A; NS-459-3; NS-459-1-A; NS-459-1-D; NS-459-1-C; NS-459-1; NS-453-2; NS-453-6; NS-453-4; NS-456; NS-455-A; NS-458; NS-462; NS-459-B; NS-434; NS-435; NS-436.

Said centerline more particularly described as follows:

Beginning at a point located N 01°12' 15" W 117.37 feet and 232.43 feet West from the southeast corner of Section 32, Township 2 North, Range 5 East, Salt Lake Base & Meridian; thence N 51° 54' 09" W 267.66 feet; thence N 28° 30' 51" W 122.84 feet; thence N 04° 08' 16" W 128.32 feet; thence N 14° 29' 45" E 73.81 feet; thence N 37° 00' 35" E 148.69 feet; thence N 10° 00' 56" E 53.24 feet; thence N 32° 59' 26" W 141.38 feet; thence N 50° 32' 42" W 168.31 feet; thence N 19° 11' 33" W 37.55 feet; thence N 02° 20' 20" E 75.62 feet; thence N 22° 15' 51" W 109.97 feet; thence N 02° 04' 20" W 130.33 feet; thence N 21° 48' 59" E 33.22 feet; thence N 60° 16' 26" E 74.63 feet; thence N 04° 11' 18" E 63.39 feet; thence N 44° 10' 01" W 73.09 feet; thence N 02° 17' 32" W 38.58 feet; thence N 35° 00' 45" E 131.79 feet; thence N 10° 42' 56" E 299.16 feet; thence N 17° 39' 46" W 71.20 feet; thence N 69° 23' 27" W 153.32 feet; thence N 05° 11' 53" W 51.09 feet; thence N 08° 56' 58" E 307.51 feet; thence N 12° 06' 13" W 44.16 feet; thence N 65° 28' 44" W 78.02 feet; thence N 35° 29' 01" W 69.29 feet; thence N 01° 00' 11" E 156.43 feet; thence N 29° 41' 12" E 240.62 feet; thence N 10° 18' 46" E 34.48 feet; thence N 01° 58' 35" W 44.74 feet; thence N 28° 45' 30" E 54.53 feet; thence N 04° 14' 24" W 41.75 feet; thence N 45° 30' 42" W 127.62 feet; thence N 00° 01' 31" W 51.66 feet; thence N 13° 00' 15" E 102.86 feet; thence N 07° 28' 15" W 225.50 feet; thence N 29° 04' 23" W 63.51 feet; thence N 45° 01' 19" W 78.53 feet; thence N 11° 04' 43" W 72.28 feet; thence N 10° 38' 00" E 116.81 feet; thence N 03° 14' 31" W 81.85 feet; thence N 25° 34' 38" E 39.32 feet; thence N 38° 24' 12" E 198.73 feet; thence N 09° 45' 35" E 200.27 feet; thence N 15°03' 57" W 71.28 feet; thence N 29° 22' 35" W 56.62 feet; thence N 76° 46' 09" W 53.90 feet; thence N 88° 21' 53" W 54.03 feet; thence N 33° 11' 55" W 47.91 feet; thence N 25° 57' 34" E 63.45 feet; thence N 52° 14' 44" E 78.07 feet; thence N 43° 50' 11" E 158.19 feet; thence N 07° 36' 02" E 93.34 feet; thence N 26° 34' 58" W 51.73 feet; thence N 68° 22' 14" W 104.58 feet; thence N 53° 17' 42" W 148.29 feet; thence N 36° 53' 27" W 46.27 feet; thence N 46° 52' 11" E 33.83 feet; thence N 74° 53' 13" E 118.28 feet; thence N 59° 13' 04" E 93.40 feet; thence N 13° 40' 52" E 58.72 feet; thence N 18° 26' 52" W 48.76 feet; thence N 05° 26' 39" E 65.06 feet; thence N 06° 34' 16" W 215.75 feet; thence N 22° 44' 20" W 119.77 feet; thence N 07° 47' 13" W 250.56 feet; thence N 07° 17' 55" W 146.65 feet; thence N 29° 32' 14" W 473.45 feet; thence N 03° 29' 03" W 190.85 feet; thence N 16° 01' 55" W 165.04 feet; thence N 39° 57' 11" W 51.14 feet; thence N 14° 28' 51" W 31.06 feet; thence N 29° 43' 22" E 86.36 feet; thence N 14° 16' 13" W 222.10 feet; thence N 03° 35' 13" E 66.42 feet; thence N 55° 11' 39" E 75.67 feet; thence N 35° 24' 56" E 45.24 feet; thence N 01° 03' 43" W 52.40 feet; thence N 44° 27' 16" W 69.32 feet; thence N 62° 43' 42" W 86.33 feet; thence N

34° 35' 36" W 42.69 feet; thence N 10° 12' 42" E 49.29 feet; thence N 56° 01' 26" E 50.35 feet; thence N 71° 43' 57" E 98.04 feet; thence N 37° 12' 21" E 35.33 feet; thence N 03° 46' 01" W 73.89 feet; thence N 24° 58' 05" W 154.11 feet; thence N 21° 03' 09" E 27.03 feet; thence N 40° 41' 13" E 73.51 feet; thence N 29° 28' 21" E 123.80 feet; thence 15° 03' 16" E 89.67 feet; thence N 08° 10' 56" W 103.90 feet; thence N 25° 32' 35" W 82.80 feet; thence N 44° 42' 07" W 122.85 feet; thence N 51° 05' 38" W 129.76 feet; thence N 06° 35' 13" E 76.18 feet; thence N 42° 33' 50" W 244.81 feet; thence N 35° 16' 31" W 122.06 feet; thence N 13° 52' 48" W 80.95 feet; thence N 09° 52' 25" E 45.30 feet; thence N 56° 35' 43" E 58.15 feet; thence S 86° 11' 20" E 72.98 feet; thence S 59° 57' 02" E 85.25 feet; thence S 72° 12' 39" E 111.15 feet; thence S 88° 14' 23" E 57.15 feet; thence N 54° 30' 38" E 34.78 feet; thence N 15° 27' 48" E 123.81 feet; thence N 28° 02' 46" E 91.25 feet; thence N 06° 26' 01" E 111.22 feet; thence N 10° 22' 00" W 147.17 feet; thence N 21° 21' 44" W 250.72 feet; thence N 10° 59' 20" W 106.24 feet; thence N 14° 19' 31" W 232.95 feet; thence N 26° 27' 33" W 164.46 feet; thence N 52° 01' 52" W 75.43 feet; thence N 64° 18' 26" W 59.86 feet; thence N 07° 38' 19" W 345.49 feet; thence N 01° 10' 12" E 76.29 feet; thence N 28° 39' 55" W 146.40 feet; thence N 45° 30' 12" W 131.04 feet; thence N 20° 06' 16" W 426.01 feet; thence N 35° 00' 45" W 57.02 feet; thence N 20° 20' 14" E 44.82 feet; thence N 01° 13' 42" W 217.98 feet; thence N 20° 45' 38" W 109.87 feet; thence N 47° 04' 55" W 153.16 feet; thence N 55° 58' 26" W 110.11 feet; thence N 40° 02' 15" W 487.59 feet; thence N 54° 06' 07" W 91.04 feet; thence N 13° 30' 21" W 40.02 feet; thence N 14° 47' 37" E 115.92 feet; thence N 14° 00' 57" W 267.76 feet; thence N 27° 31' 52" W 304.57 feet; thence N 19° 56' 30" W 726.42 feet; thence N 01° 50' 56" W 144.84 feet; thence N 29° 39' 26" W 103.89 feet; thence N 55° 57' 06" W 73.80 feet; thence N 18° 34' 41" W 792.34 feet; thence N 29° 51' 53" W 109.49 feet; thence N 05° 19' 39" E 84.42 feet; thence N 13° 51' 33" E 133.16 feet; thence N 11° 10' 24" W 470.09 feet; thence N 31° 34' 02" W 134.01 feet; thence N 66° 40' 55" W 86.52 feet; thence N 78° 41' 54" W 39.72 feet; thence N 21° 03' 08" W 43.37 feet; thence N 16° 32' 48" E 207.86 feet; thence N 04° 06' 58" W 543.87 feet; thence N 21° 36' 25" W 130.30 feet; thence N 40° 56' 10" W 96.93 feet; thence S 62° 59' 13" W 107.48 feet; thence S 78° 19' 10" W 57.87 feet; thence N 54° 16' 01" W 30.09 feet; thence N 41° 12' 28" E 31.15 feet; thence N 53° 26' 52" E 37.71 feet; thence N 02° 59' 20" W 112.43 feet; thence N 40° 45' 14" W 46.40 feet; thence N 06° 54' 58" E 32.46 feet; thence N 57° 22' 31" E 74.25 feet; thence N 63° 09' 20" E 84.32 feet; thence N 29° 31' 00" E 148.90 feet; thence N 03° 13' 37" W 69.43 feet; thence N 19° 08' 09" W 283.16 feet; thence N 39° 31' 48" W 101.85 feet to end of West Hoytsville Canal Centerline.

01001369 Page 6 of 6 Summit County