

WHEN RECORDED, RETURN TO: SALT LAKE COUNTY
PLANNING & DEVELOPMENT SERVICES

10366338
03/06/2008 03:17 PM \$0.00
Book - 9579 Pg - 835-837
GARY W. OTT
RECORDER, SALT LAKE COUNTY, UTAH
SL CO PLANNING & DEVELOPMENT
BY: EPM, DEPUTY - WI 3 P.

AFFIDAVIT

This document is made and executed this 6th day of March 2008. For the record, and the purpose of this affidavit, this document will clarify street nomenclature for properties shown on Exhibits "A" & "B".

Historically, "Millcreek Canyon Road", as shown on Exhibit "A", begins at Wasatch Blvd., thence travels Southeasterly to the 4-way stop intersection (thence begins the entrance to Millcreek Canyon State Park). Here, the street name "Millcreek Canyon Road" continues east. Over time during the development of the neighborhood in this area, the street name "Millcreek" (dropping "Canyon") has typically been used in both the location and mailing addresses of residents along this stretch of road. Therefore, we are making the street name change official; "Millcreek" will replace Millcreek Canyon". All street signs will be replaced to reflect "Millcreek" Rd.

Exhibit "B": Subdivisions that were recorded with "Millcreek Canyon Road", are listed here and are also referenced for the sole purpose of making the street name change official.

This change has been approved by the Public Works Administration, Planning and Development Services Division, through designated officers in the Salt Lake County Public Works Department, and complies with Title 18, Chapter 28, and Salt Lake County Code of Ordinances, 1987.

This section of properties falls in the Northwest Quarter of Section 36, Township 1 South, Range 1 East, Salt Lake Base & Meridian.

See Exhibit "A" and Exhibit "B"

In witness whereof, I swear that the above change is correct and cause the same to be duly executed this 6th day of March 2008.



Simon Ginn
Director, Planning & Development Services

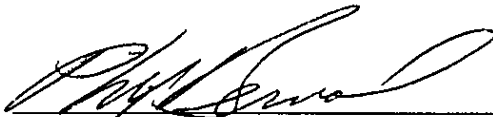

Philip V. Bernal
Associate Public Works Director



Dana M. Christensen
Engineering Review Specialist

STATE OF UTAH)
 : ss
COUNTY OF SALT LAKE)

On this 6th day of March 2008 personally appeared before me, Simon Ginn and Dana M. Christensen, signer of the foregoing instrument who duly acknowledged to me that they executed the same.

Residing in Salt Lake County
Commission expires: 10/19/2011



NOTARY PUBLIC

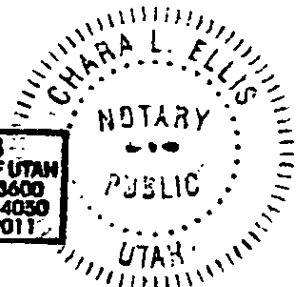
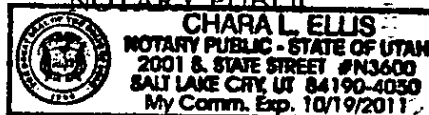

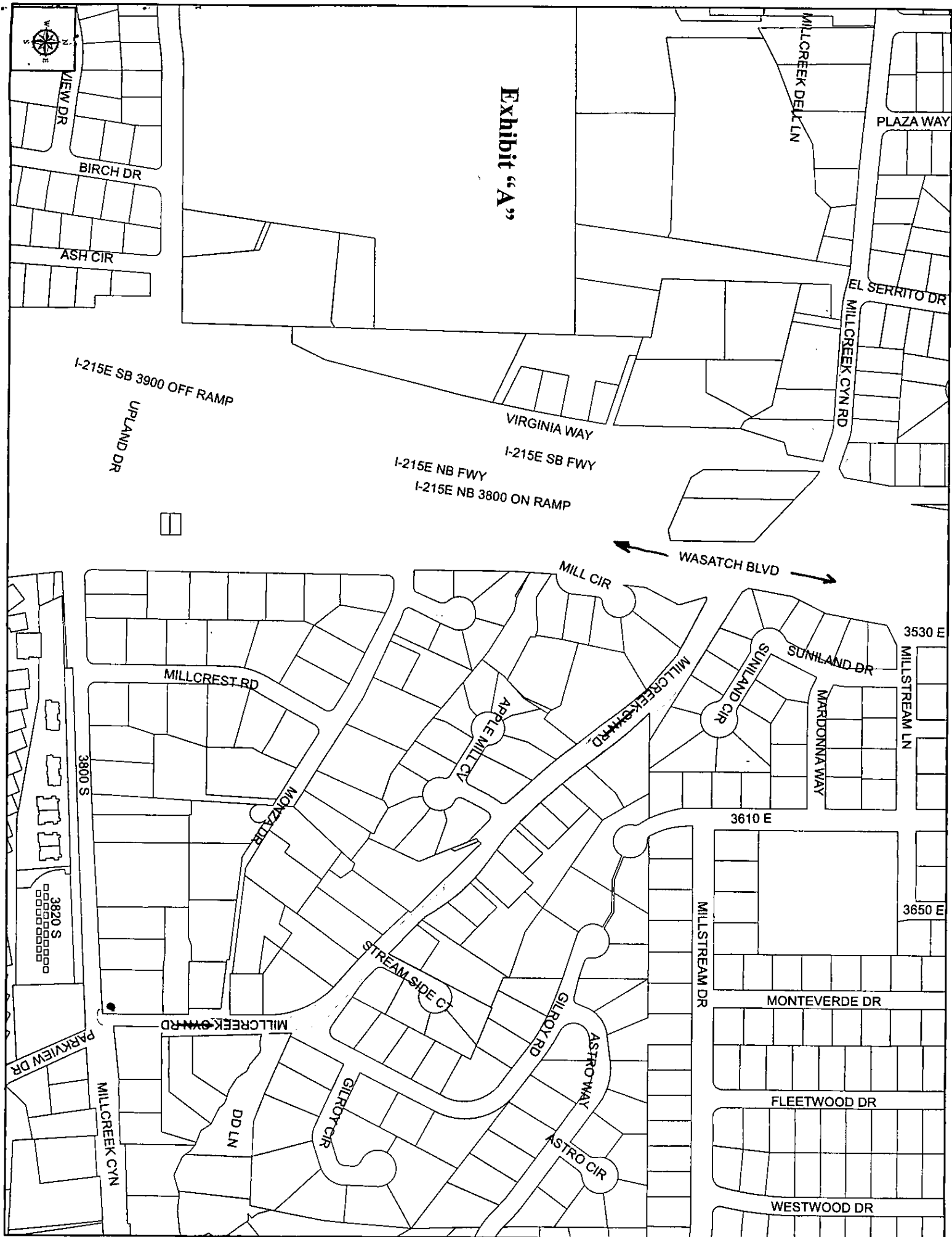

Exhibit "B"

Subdivisions recorded with "Millcreek Canyon Rd."

Taylor Estates Phase I Recorded Information *Millcreek Canyon Road changes to "Millcreek" Rd.*
Entry: 5099413 Book/Page: 91-7 105

Woods at Creekside Recorded Information *Millcreek Canyon Road changes to "Millcreek" Rd.*
Entry: 4781880 Book/Page: 89-5 46

Country Mill estates Recorded Information *Millcreek Canyon Road changes to "Millcreek" Rd.*
Entry: 5070727 Book/Page: 91-5 66

Taylor Estates Recorded Information *Millcreek Canyon Road changes to "Millcreek" Rd.*
Entry: 3057879 Book/Page: 78-1 37

(Note: There are no properties within these said subdivisions, addressed off of Millcreek Canyon Rd.) Where applicable, all are already using "Millcreek" Rd.