

**WHEN RECORDED RETURN TO:**

Christopher P. Gamvroulas  
IVORY DEVELOPMENT, LLC  
978 East Woodoak Lane  
Salt Lake City, Utah 84117  
(801) 268-0700

27.29.253.005

12219199  
2/8/2016 4:52:00 PM \$62.00  
Book - 10401 Pg - 5888-5906  
Gary W. Ott  
Recorder, Salt Lake County, UT  
COTTONWOOD TITLE  
BY: eCASH, DEPUTY - EF 19 P.

**DECLARATION  
OF  
COVENANTS, CONDITIONS AND RESTRICTIONS,  
AND RESERVATIONS OF EASEMENTS  
FOR  
AUTUMNWOOD ESTATES PHASE 1 SUBDIVISION**

This Declaration of Covenants, Conditions and Restrictions, and Reservations of Easements for Autumnwood Estates Phase 1 subdivision (the "Declaration") is executed by Ivory Development, LLC, a Utah limited liability company, of 978 East Woodoak Lane, Salt Lake City, Utah 84117 (the "Declarant"), with reference to the following:

**RECITALS**

- A. Declarant is the owner of certain real property located in Salt Lake County, Utah described more particularly on Exhibit "A" attached hereto and incorporated herein by this reference (the "Property").
- B. Declarant has subdivided the Property into a subdivision consisting or to consist of seventeen (17) Lots.
- C. The Property is an area of unique, natural beauty featuring distinctive terrain.
- D. Declarant desires to provide a general plan for the development of all of the Property and for the establishment of covenants, conditions, and restrictions to enhance and protect the value and attractiveness of this uniquely attractive residential property, all in accordance with the provisions of this Declaration.
- E. The development of the Property and the construction of the improvements thereon have been, or is to be, performed in accordance with the plans contained in the Final Plat recorded or to be recorded concurrently herewith.
- F. Declarant intends to sell to various purchasers the fee title to the individual Lots contained in the Subdivision.
- G. The Declarant desires by filing this Declaration of Covenants, Conditions and Restrictions to submit Autumnwood Estates Phase 1 and all improvements now or hereafter constructed thereon to the terms, covenants, conditions, and restrictions set forth below which shall constitute equitable servitudes and shall run with the land.
- H. It is not anticipated that there will be common areas or facilities, private roads or a homeowners association in this Subdivision.

## **COVENANTS, CONDITIONS AND RESTRICTIONS**

NOW, THEREFORE, for the reasons recited above, the Declarant hereby covenants, agrees, and declares that the Property shall be subject to the following covenants, conditions, and restrictions:

1. **Definitions.** The following definitions shall apply to this Declaration:
  - a. "Accessory Building" shall mean and refer to any structure which is not the preliminary structure, contains at least one-hundred and twenty (120) square feet, requires a building permit, is not a shed, shack, or other out-building (for which a building permit is not required), and qualifies as such under the totality of the circumstances.
  - b. "Builder" shall mean Declarant, an Owner, or a contractor who obtains a construction or occupancy permits for one or more Buildings or Homes.
  - c. "Building" shall mean an edifice or structure designed to stand more or less permanently.
  - d. "City" shall mean the City of Riverton, a municipal corporation, located within Salt Lake County, Utah.
  - e. "County" shall mean Salt Lake County, Utah.
  - f. "Entry" shall mean the entry way into the Project.
  - g. "Final Plat" shall mean the recorded "Plat Map of the Autumnwood Estates Phase 1 subdivision" on file in the office of the County Recorder of Salt Lake County, as amended or supplemented from time to time.
  - h. "Home" shall mean and refer to the home, dwelling, residence, living unit, or separate physical part of a Lot intended for independent occupancy and use. Mechanical equipment and appurtenances located within any one Home, or located without said Home but designated and designed to serve only that Home, such as appliances, electrical receptacles and outlets, air conditioning compressors, furnaces, water heaters, apparatus, systems or equipment, fixtures and the like, shall be considered part of the Home. All pipes, wires, conduits, or other utility lines or installations constituting a part of the Home or serving only the Unit, and any structural members, parts, components, or any other property of any kind, including fixtures or appliances within any Home shall be deemed to be part of the Home.
  - i. "Lot" shall mean the subdivided and recorded lot within Property, and where the context so requires any Building or Home constructed thereon.
  - j. "Lot Number" shall mean the number and/or letter used to identify a particular Lot.
  - k. "Owner" shall mean the record owner, whether one or more persons or entities, of a fee simple title to any Lot, excluding those having such interest merely as security for the performance of an obligation.
  - l. "Plans and Specifications" shall mean and refer to any and all documents designed to guide or control the construction of an Improvement, or alterations, modifications, changes, additions and the like thereto, including without limitation, all documents indicating the size, shape, configuration, and/or materials to be incorporated; all site plans, excavation and grading plans, elevation drawings, floor plans,

techniques, samples of exterior colors, plans for utility services, and all other documentation or information relevant to the improvement or proposal in question.

m. "Project" shall mean the Autumnwood Estates Phase 1 Subdivision.

n. "Property" shall mean all of real property and real property interest comprising the Subdivision.

o. "Single Family" shall mean and refer to a "single family" as that term is defined by City ordinance. In the absence of a City ordinance the term shall mean one of the following: (1) a single person, or (2) a group of natural persons related to each other by blood or legally related to each other by marriage or adoption, or (3) a group of not more than three (3) unrelated persons who maintain a common household, to be distinguished from a group occupying a boarding house, club, fraternity, or hotel. A Single Family may include an additional natural person or persons approved in writing by the Board of Directors, such as a caretaker or domestic help.

p. "Subdivision" shall mean Autumnwood Estates Phase 1 subdivision according to the Final Plat.

2. Description, Legal Status, and Residential Nature of the Project. The Final Plat shows the Lot Number of each Lot in the Project and its location. All Lots shall be capable of being independently owned, encumbered, and conveyed, subject to all easements and encumbrances of record. It is intended that there will be seventeen (17) Lots in the Project, numbered 101-117, inclusive. This is a residential subdivision and only single family residences are allowed. This refers both to the residents of each Home and the architectural style of each Home.

3. Area of Application. This Declaration shall apply to all of the Property.

4. Right to Expand Application. The Declarant shall have the unilateral right to expand the application of this Declaration to other property by written amendment to this Declaration duly recorded, and without additional Owner approval required.

5. Easements. Declarant hereby reserves to itself and grants:

a. Common Easement. A perpetual right-of-way and non-exclusive easement over, across, and through the Project for use in common by the Declarant and Owners, subject to all of the terms, covenants, conditions and restrictions set forth herein.

b. Private Easement. A perpetual private non-exclusive easement for the exclusive use and benefit of the Declarant and Owners.

c. Declarant's Easement. An exclusive easement to the Declarant, for itself and its affiliates and assignees, to make such use of the Project as may be necessary or convenient to perform the duties and functions hereunder, including, by way of illustration but not limitation, the construction of the improvements, Lots, and Homes in the Project.

d. Construction Easements. A temporary construction easement to the Declarant, for itself and its affiliates and assignees, over, under, across, and through the Project for the purpose of doing all things that are reasonably necessary as a part of constructing any new improvements for the Project including all physical improvements as well as all Lots and Homes. The Owners do hereby acknowledge and agree that there will be construction activities, traffic, noises, odors, and vibrations which may temporarily disrupt their

quiet enjoyment of their Lots and Homes until all improvements are complete, and such Owners do hereby waive any right to object to such construction activity; provided, however, Declarant shall endeavor to use reasonable efforts to minimize the adverse impact of such construction activities on the Owners, Lots, and Homes. Declarant's construction activities pursuant to the easement granted hereunder shall not be deemed to be a violation of the Use Restrictions.

e. Locations of Facilities Easements. A non-exclusive easement to the Declarant, for itself and its affiliates and assignees, to construct, operate, maintain, repair, and replace all types of telecommunication facilities, including but not limited to, roof antennas, within suitable locations for such facilities (the "Locations of Facilities") within the Project. Declarant further reserves a right of access to the Locations of Facilities over, across, under, and through the Project in order to access the Locations of Facilities to exercise the rights established herein. Declarant reserves the perpetual right to transfer by easement, license agreement, or other conveyance the rights reserved hereunder to one or more telecommunication facilities providers. Declarant may exercise all of such rights unilaterally and without the consent of any Owner.

f. Property Subject to the Easement. Declarant hereby declares that the Property shall be held, sold, conveyed, transferred, constructed, operated, maintained, leased, and occupied subject to the easements and rights of way set forth herein (collectively the "Easement Area"). In the event of any sale, conveyance, or transfer of the Property to a third party, no further actions or agreements shall be necessary to effectuate such easements and said easements shall remain effective against and for the Property for the term hereof. Such easements and rights of way shall be appurtenant to and shall pass with the title to every Lot.

g. Easement for Emergency Vehicles and City/County Services. An easement and right of way for access, ingress and egress, to the City/County for any and all Emergency and Service Vehicles.

h. Non-Exclusive Utility Easement. A non-exclusive easement to the Declarant, and its affiliates and assignees, over, across, through, and under the Property for ingress to, egress from, and installation, replacement, repair, and maintenance of all utility and service lines and systems, including, without limitation, water, sewer, gas, telephone, electricity, and cable communication that service the Property or any portion thereof as well as any such lines and systems which service property owned by the Declarant.

i. Duty to Maintain Integrity of Established Drainage Pattern. Within these easements and rights of way, no structure, planting, or other materials shall be placed or permitted to remain which may damage or interfere with the installation and maintenance of utilities, or which may change the direction of flow of drainage channels in, on or about the easements and rights of way, or which may obstruct or retard the flow of water through the drainage channels in the easements and rights of way. The easement and right of way area of each Lot and all improvements within said area shall be maintained continuously by the Owner, excepting those improvements for which a public authority or utility company is expressly responsible. For purposes of this subsection, the term "established drainage pattern" shall mean the drainage pattern, facilities, and improvements in existence at the time a Lot is conveyed to a home purchaser by the Declarant, its successor or assign. No Owner shall interfere or attempt to interfere with the land drain system or the established drainage pattern established by the Declarant and City or their successors or assigns. Each Owner shall be responsible to develop, improve, and landscape his or her Lot in a manner consistent with the land drain system and the established drainage pattern, and so as not to detract from, interfere with, or impair the land drain system or the established drainage pattern on any other Lot within the Project. No changes to the land drain system or the established drainage pattern on any Lot shall be permitted without the prior written consent of the City.

j. Mutual Benefits and Burdens. The mutual benefits and burdens of the easements and rights of way granted herein and as depicted on the Final Plat include:

(1) Easement. A non-exclusive easement over, to, from, under, across and through the Easement Area by emergency and service vehicles.

(2) No Barriers. No Owner or Owners shall permit or suffer to be constructed or placed upon any portion of the Easement Area any gate, fence, wall, barricade or other obstruction, whether temporary or permanent in nature, which would unreasonably limit or impair reasonable access by emergency and service vehicles.

(3) No Construction. No Owner shall construct any building, fence or other structure of whatsoever nature or allow any use of their respective portions of the Property if such construction or use would impair the use of the Easement Area or drainage patterns or channels established by the Declarant, or violate any law, ordinance, or regulation.

k. Damage or Waste. Each Owner shall be strictly liable for any loss, damage, or claim caused to person or property in the Project caused by his negligence or carelessness, or that of his or her family members, tenants, renters, lessees, residents, occupants, guests, visitors, invitees, or permittees of his or her Lot or Home.

l. Encroachments. If any part of a Lot or Home encroaches or shall hereafter encroach upon an adjoining Lot or Home, then an easement for such encroachment and for the maintenance of the same shall and does exist. Such easements shall extend for whatever period the encroachment exists. Such encroachments shall not be considered to be encumbrances on the affected Lots or Homes. Encroachments referred to herein include, but are not limited to, encroachments caused by error in the original construction of any improvement constructed or to be constructed within the Project, by error in the Final Plat, by settling, rising or shifting of the earth, or by changes in position caused by repair or reconstruction of the Project or any part thereof.

m. Reservation of Rights. The deeds or other documents of conveyances for any Lot or Home within the Project hereafter made, whether by Declarant or otherwise, shall be construed to grant and reserve such easements and/or licenses as are provided herein, even though no specific reference to such easements appears in any such conveyance.

n. Entry Monument. If an Owner purchases a Lot which includes a common improvement, including by way of illustration but not limitation an Entry, Entry Monument, planter, planter box, planter strip, perimeter fence, wall, street light, exterior lighting or other landscaping treatment of any kind, shall, at his sole expense, maintain such common elements in good condition, and may not improve his property or place any plant, hedge, tree, bush, shrub or object, natural or artificial, behind, to the side or in front of such improvement or feature or so as to impair, obstruct, block or impede the view or purpose of the Entry, Entry Monument or other improvement, planter box, landscaping strip, or any such special landscaping feature. In particular Lots 101 and 117 are affected by this language.

6. Zoning. All land use and buildings shall be in compliance with all zoning and land use ordinances as well as all regulations of the municipalities and agencies governing the Subdivision land use and buildings.

7. Minimum Requirements for Homes. No Home shall be constructed or altered unless it meets the following minimum requirements:

- a. Only single family residential Homes are allowed.
- b. The height of any Home shall not exceed two stories above ground.
- c. Slab on grade Homes are permitted.
- d. Basements are permitted.
- e. Garages shall provide for not less than two (2) motor vehicles.
- f. The Home exteriors, in their entirety, must consist of maintenance free stucco, and masonry, and fiber cement. No aluminum or vinyl is permitted.
- g. Any detached accessory building must conform in design and materials with the primary residential Home
- h. No fence or similar structure shall be placed in any front yard. No fence or similar structure shall be placed in any side or rear yard in excess of six (6) feet. Wood fencing and chain link fencing are strictly prohibited.

8. **Preliminary Plans.** The Declarant may require, as a minimum, the following additional items:

- a. Plot plan to scale of entire site with buildings located and elevation of floors shown above or below a designated point on the street.
- b. Floor plans of each floor level to scale.
- c. Elevations to scale of all sides of the Home.
- d. One major section through Home.
- e. A perspective (optional).
- f. Specifications of all outside materials to be used on the exterior of the Home.

9. **Final Plans and Specifications and Working Drawings.** The Declarant may also require, as a minimum, the following:

- a. Plot plans to scale showing the entire site, building, garages, walks, drives, fence, carriage lights, and retaining walls with elevations of the existing and finished grade and contours including those at the outside corners of the buildings and at adjacent property lines and street fronts, and elevations of floors from a designated point on the street.
- b. Detailed floor plans.
- c. Detailed elevations, indicating all materials and showing existing and finished grades.
- d. Detailed sections, cross and longitudinal.
- e. Details of cornices, porches, windows, doors, garages, garden walls, steps, patios, fences, carriage lights, etc. Specifications shall give a complete description of materials to be used with

supplements, addenda, or riders noting the colors of all materials to be used on the exterior of the Home.

f. All Lot landscaping, grading, and drainage plans must be approved by the Declarant. All landscaping must be installed or completed strictly in accordance with the approved plans and so as to comply with and not impair all applicable ordinances and flood control requirements.

1. All Lot landscaping must be completed within nine (9) months of the date of completion of the date of closing on the sale of the Lot.

2. Landscaping shall include, by way of illustration but not limitation, the planting of a lawn and/or other appropriate ground cover, planting beds and flower beds, appropriate bushes and shrubs, and the planting of trees in accordance with the Street Tree Planting Plan.

3. The Declarant will provide the City with a bond for landscaping for Lots on which it builds Homes whenever possible. In the event that such a bond is provided, it shall be refunded, upon the buyer's completion of the City's landscaping requirements, inspection, and approval to the Owner.

4. By accepting a deed or other document of conveyance to a Lot, the Owner hereby agrees, acknowledges, and consents that if the Declarant is required by the City to install front yard landscaping prior to receiving a final inspection on the Lot, the Owner further agrees that the landscaping installed by Declarant is in lieu of, abrogates and cancels any 2,000 sq. ft. of sod promised on any promotional materials, including by way of illustration but not limitation, the Purchase Price Addendum and the Ivory Homes Catalogue of Homes.

5. The Owner is responsible for the initial planting of trees at his sole expense.

6. Trees, lawns, shrubs, or other plantings placed on a Lot shall be properly nurtured, maintained, and replaced by the Owner and at his or her sole expense.

7. Any weeds or diseased or dead lawn, trees, ground cover, bushes, or shrubs shall be removed and replaced by the Owner and at his or her sole expense.

8. The Owner is responsible for all replacement trees at his sole expense. Replacement trees must also satisfy the requirements of the Street Tree Planting Plan.

9. The landscaping of a Lot may not adversely affect the value or use of any other property or detract from the original design scheme and appearance of the subdivision.

10. No concrete, cement or masonry products, pavers, brick, stone, cobblestone, tile, terrazzo, slabs, slate, rocks, pebbles, gravel, permeable pavements and so forth or other artificial or impermeable surfaces (collectively "controlled surfaces") may be installed or constructed as landscaping in the front, side or rear yards of a Lot without the express prior written consent of the Declarant.

11. Front, side, or rear yards constructed primarily or substantially of controlled surfaces are prohibited.

12. Solar energy collector panels, wind turbines, geothermal products and other energy conservation equipment or attendant hardware may not be constructed or installed on a Home or within the Project without the express prior written approval of the Declarant.

13. Should any Owner fail to comply with the provisions of this paragraph, the Declarant shall have the right to seek an order from a court of proper jurisdiction requiring specific

performance to comply with the provisions hereof or to recover damages, or both, and shall also have the authority but not the obligation to complete the landscaping or restore the property to its original condition without being guilty of a trespass, and require the Lot Owner to pay the cost of labor and materials.

14. The costs and expenses incurred, including a reasonable attorney's fee, whether or not a lawsuit is filed, shall be considered the personal obligation of the Lot Owner and shall constitute a lien on the interest of the Owner in such property, enforceable at law or equity, until payment is made.

10. Accessory Buildings. Accessory Buildings are considered conditional uses. There is no right to construct or install an Accessory Building on a Lot. Written approval by the Declarant is required. Each application to construct or install an Accessory Building will be evaluated separately by the Declarant, subject to the following guidelines: (1) Any detached Accessory Building must conform in design and construction materials with the primary residential Home, and (2) The maximum height of an Accessory Building shall be 20 feet. Tin sheds are not allowed. If there is a dispute of any kind whatsoever, including whether a structure is an Accessory Building, the decision of the Declarant shall in all instances be final, conclusive, and binding

11. Approval. The Declarant is responsible to review and approve all architectural plans and specifications at this Project. In the event that the Declarant fails to approve any application within thirty (30) days after submission of all information and materials reasonably requested, the application shall be considered "denied."

12. No Waiver of Future Approvals. The approval of the Declarant of any proposals or plans and specifications or drawings for any work done or proposed, or in connection with any other matter requiring the approval and consent of Declarant, shall not be deemed to constitute a waiver of any right to withhold approval or consent as to any similar proposals, plans and specifications, drawings or matters whatever subsequently or additionally submitted for approval or consent.

13. Variance. The Declarant may authorize variances from compliance with any of the architectural guidelines when circumstances such as topography, natural obstructions, hardship, aesthetic, or environmental considerations require, but only in accordance with it's duly adopted rules and regulations, and prior written consent of the City Board of Adjustment. Such variances may only be granted, however, when unique circumstances dictate and no variance shall (a) be effective unless in writing, (b) be contrary to the restrictions set forth in the body of this Declaration, or (c) estop the Declarant from denying a variance in other circumstances. For purposes of this Section, the inability to obtain approval of any governmental agency, the issuance of any permit, or the terms of financing shall not be considered a hardship warranting a variance.

14. Limitation of Liability. Neither the Declarant nor any of its employees, agents, representatives, or consultants shall be responsible in any way for any defects in any plans or specifications submitted, revised or approved in accordance with the provisions of this Declaration, nor for any structural or other defects in any work done according to such plans and specifications. By accepting a deed or other document of conveyance to a Lot, each Owner agrees to and shall defend, indemnify, save and hold the Declarant and its employees, agents, representatives, or consultants harmless from any and all loss, damage, or liability he or she may suffer, including defense costs and attorney fees, as a result of any claims, demands, actions, costs, expenses, awards or judgments arising out of their review or approval of architectural designs, plans, and specifications.

15. Enforcement of Architectural Guidelines. Any construction, alteration, or other work done in violation of this Declaration shall be considered to be nonconforming. Upon written request from the Declarant an Owner shall, at his or her own cost, and expense remove such non-conforming construction,



alteration, or other work and shall restore the land to substantially the same condition as existed prior to the non-conforming construction, alteration, or other work. Should an Owner fail to remove and restore as required hereunder, the Declarant shall have the right to enter the property, remove the violation, and restore the property to substantially the same condition as existed prior to the construction, alteration, or other work, without being deemed to be a trespasser.

16. **Builders and Contractors.** Any Builder, contractor, subcontractor, agent, employee, or other invitee of an Owner who fails to comply with the terms and provisions of this Declaration may be excluded by the Declarant from the Project, subject to the notice and the opportunity to be heard. In the event of sanctions after notice and hearing, neither the Declarant nor its employees, agents, representatives, or consultants shall be held liable to any person for exercising the rights granted by this Section.

17. **Ivory Homes Catalogue.** Any and every home design, plan, or specification contained within the Ivory Homes Catalogue shall be considered approved and qualify for construction, and no other consent shall be required, provided the home elevations meet and the home otherwise satisfies all of the architectural control requirements of the City's ordinance for planned residential developments. Any and all deviations from the Ivory Homes Catalogue, including by way of illustration but not limitation, design, construction materials, and coloration must be expressly approved in writing by the Declarant: The approval of the Ivory Homes Sales staff and/or construction personnel is insufficient.

18. **Slope and Drainage Control.** No structure, plant, improvement, or other material may be placed or permitted to remain, or other activities undertaken which may damage or interfere with established Lot ratios, create erosion or sliding problems, or which may change the direction or flow of drainage channels, or obstruct or retard the flow of water through the channels. The slope control area of each Lot and all improvements therein shall be maintained continuously by the Owner of the Lot, excepting those improvements for which a public authority or utility company is expressly responsible. It shall be the responsibility of the Owner to see that his or her Lot strictly conforms to the grading and drainage plan established by the Declarant, Salt Lake County, and Riverton City.

19. **Use Restrictions and Nature of the Project.** The Property is subject to the following initial use restrictions, which shall govern both the architecture and the activities within the Project:

a. **Single Family Residence.** No Lot shall be used except for residential purposes and no more than one (1) single family may reside in a Home as that term is defined by local ordinance.

b. **Business Use and Home Occupation Guidelines.** No resident may operate a commercial trade or business in or from his or her Lot with employees of any kind or with customers who are not residents of the Project, or which create or maintain a nuisance. No commercial trade or business may store any inventory over 250 cubic feet, and it must be contained within the Lot. No commercial trade or business may be conducted in or from a Lot unless (1) the business activity conforms to all home occupation and zoning requirements governing the Project; (2) the operator has a city issued business license; and (3) the business does not create a nuisance.

c. **Motor Vehicles.** No motor vehicle or trailer, including but not limited to any car, automobile, truck, van, or any other transportation device of any kind may be parked or stationed in such a manner so as to block access to any driveway or Home or to create an obstacle or potentially dangerous condition. Motor vehicles shall be parked in the garage or driveway. No resident shall repair or restore any vehicle of any kind in, on or about any Lot, except for emergency repairs, and then only to the extent necessary to enable movement thereof to a proper repair facility. No garage may be altered in such a manner that the number of motor vehicles which may reasonably be parked therein after the alteration is less than the number

of motor vehicles that could have been reasonably parked in the garage as originally designed and constructed.

All garages shall be used primarily for the parking and storage of vehicles. Parking on the street overnight is prohibited. Except for purposes of loading or unloading passengers or supplies, for a period of time not to exceed twenty-four (24) hours, all recreational, commercial, and oversized vehicles must be stored in the garage or on a parking pad; provided, however that (a) the motor vehicle is in good running condition, (b) the motor vehicle or trailer is properly licensed and registered, (c) the parking pad is located in the rear yard, which means behind the geometric plane of the front of the house, and (d) a parking pad fence has been installed in accordance with the approved plans. Eighteen wheeled semi-trailers or other similar transportation devices are not allowed. No temporary carport or canopy may be installed in the front, side, or rear of the Lot.

d. Trash and Garbage Pick-Up. No Lot shall be used as a dumping ground. All trash, garbage, debris, rubbish, or other waste shall be kept in a sealed, sanitary bag or container, and stored out of sight except for a twenty-four (24) hour period on pick-up days.

e. Aerials, Antennas, and Satellite Systems. All exterior aerials, antenna and satellite dishes (collectively "antenna") must be installed and positioned in accordance with FCC guidelines, rules and regulations, as they may be amended or supplemented from time to time.

f. Animals and Pets. Large animals as that term is defined by City ordinance are not allowed. No pets, animals, livestock, or poultry of any kind may be commercially bred in the Subdivision. Animal limitations are in accordance with the West Haven City Animal Ordinance. In the event there is not city ordinance, up to two (2) domestic pets as that term is defined by city ordinance per Lot are allowed; provided, however, pets must be properly licensed and registered. Pets may not create a nuisance or violate City ordinance.

g. Laws. Nothing shall be done or kept in, on or about any Lot or any part thereof, which would be a violation of any statute, rule, ordinance, regulation, permit or other validly imposed requirement of any governmental body.

h. Damage or Waste. Each Owner shall repair any damage he or she or any other residents, guests, or invitees of his or her Lot may cause to another Owner, Lot, or Home, and promptly restore the property to its original condition.

i. Signs. No signs, billboards, or advertising structures or devices of any kind may be built, installed or displayed on the Property or any Lot except for a single sign with a maximum size of 2' x 2' for specific purpose of advertising the sale of a Home; provided, however, this restriction does not apply to and is not binding upon the Declarant, who may use whatever signs it deems appropriate to market its Lots. "For Rent" or "For Lease" signs on a Lot or showing from a Home are strictly prohibited.

j. Zoning. All land use and buildings shall be in compliance with all zoning and land use ordinances as well as all regulations of the municipalities and agencies governing the Project land use and buildings.

k. Nuisances. No noxious or offensive activity shall be carried on, in or about the Property, nor shall anything be done or permitted thereon which may be or may become an annoyance, disturbance, bother, or nuisance to the neighborhood, or which might interfere with the right of other residents to the quiet and peaceful enjoyment of their property. A violation of any use restriction set forth herein shall be considered a nuisance.

l. Temporary Structures. No structure of a temporary nature or character, including but

not limited to any trailer, motor home, mobile home, shack, shed, tent, garage, barn, or other out-building shall be constructed, installed, or placed on any Lot at any time, including but not limited to use as a residence.

20. **Leases.** No Owner shall be permitted to lease his or her Home for an initial term of less than six (6) months. Daily or weekly rentals are expressly prohibited. No Owner may lease individual rooms to separate Persons or less than the entire Home. "For Rent" or "For Lease" signs are prohibited. Other than as stated in this Section, there is no restriction on the right of any Owner to lease or otherwise grant occupancy rights to his or her Home.

21. **View Impairment.** The Declarant does not guarantee or represent that any view over and across any property, including any Lot or Building will be preserved without impairment. Any express or implied easements for view purposes or for the passage of light and air are hereby expressly disclaimed.

22. **Common Utilities.** The Declarant may provide water and power utility services to the Entry and other common elements at its expense (the "Common Utility Service"); provided, however, it may elect to provide such Common Utility Services through a meter or meters on an individual Lot or Lots and, if so, each such Owner agrees, by accepting a deed or other document of conveyance to such Lot, to provide, and not terminate, delay, or interrupt, and pay for those Common Utility Services.

23. **Declarant's Sales Program.** Anything to the contrary notwithstanding, for so long as Declarant continues to own a Lot in the Subdivision the following provisions shall be deemed to be in full force and effect. No Owner or occupant shall interfere or attempt to interfere with the completion of improvements, promotion and/or sale of Lots owned by Declarant or Homes constructed thereon. Declarant shall have the right to maintain one (1) or more sales offices and one (1) or more model Homes at any one time. Such office and/or models may be one or more of the Homes owned by the Declarant, one or more separate structures or facilities placed on the Property for the purpose of aiding Declarant's sales effort, or any combination of the foregoing. Declarant shall have the right to maintain a reasonable number of promotional, advertising and/or directional signs, banners or similar devices at any place or places on the Property. Declarant shall have the right from time to time to locate or relocate any of its sales offices, models, signs, banners, or similar devices. Declarant shall have the right to remove from the Project any signs, banners, or similar devices and any separate structure or facility which was placed on the Property for the purpose of aiding Declarant's sales effort. All of the rights of Declarant under this Declaration may be assigned or transferred either by operation of law or through a voluntary conveyance, transfer, or assignment. Any Mortgage covering all Lots or Buildings in the Project, title to which is vested in Declarant shall, at any given point in time and whether or not such Mortgage does so by its terms, automatically cover, encumber, and include all of the then unexercised or then unused rights, powers, authority, privileges, protections, and controls which are accorded to Declarant (in its capacity as Declarant) herein.

24. **Interpretation.** To the extent Utah law is consistent with this Declaration, such provisions shall supplement the terms hereof and are incorporated herein. The captions which precede the Articles and Sections of this Declaration are for convenience only and shall in no way affect the manner in which any provision hereof is construed. Whenever the context so requires, the singular shall include the plural, the plural shall include the singular, the whole shall include any part thereof, and any gender shall include both other genders. The term *shall* is mandatory and the term *may* is permissive. The invalidity or unenforceability of any portion of this Declaration shall not affect the validity or enforceability of the remainder hereof.

25. **Covenants to Run with Land.** This Declaration and all the provisions hereof shall constitute covenants to run with the land or equitable servitudes, as the case may be, and shall be binding upon and shall inure to the benefit of the Declarant, all other signatories hereto, all parties who hereafter acquire any interest in

a Lot, the Subdivision or the Property, and their respective grantees, transferees, heirs, devisees, personal representative, successors, and assigns. Each Owner or occupant of a Lot shall comply with, and all interests in all Lots shall be subject to, the terms of this Declaration and the provisions of any rules, regulations, agreements, instruments, supplements, amendments, and determinations contemplated by this Declaration. By acquiring any interest in a Lot in the Project, the party acquiring such interest consents to, and agrees to be bound by, each and every provision of this Declaration.

26. Enforcement and Right to Recover Attorneys Fees. Should the Declarant or an aggrieved Owner be required to take action to enforce or construe the Declaration or to pursue any remedy provided hereunder or by applicable law, including a claim for injunctive relief or damages, whether such remedy is pursued by filing suit or otherwise, the prevailing party shall be entitled to recover his reasonable attorneys fees, costs and expenses which may arise or accrue, regardless of whether a lawsuit is filed.

27. Limitation of Liability. This Declaration of covenants, conditions and restrictions is established for the benefit of the Property and the Owners. Any damage, loss, claim or liability which might arise due to any decision, act, or failure to act of Declarant or its agents, representatives, and employees shall be exempt from any civil claim or action, including an action for negligence, brought by any person owning or having an interest in any Lot.

28. Amendments. This Declaration may be amended by the Declarant at any time and for any reason without any other approval required. When all of the Lots have been sold, then this Declaration may be amended by the affirmative written approval of two-thirds (2/3) of the Owners and shall be valid immediately upon recording of the document amending the Declaration in the office of the County Recorder of Salt Lake County, Utah; provided, however, so long as the Declarant shall own at least one (1) Lot in the Subdivision, no amendment shall be valid or enforceable without Declarant's express prior written consent.

29. Duration. The covenants and restrictions of this Declaration shall endure for a term of twenty (20) years from the date this Declaration is recorded, after which time said covenants shall be automatically extended for successive periods of ten (10) years on its anniversary date unless terminated by the unanimous consent of the Owners on said date.

30. Effective Date. The effective date of this Declaration is the date it is recorded in the Office of the County Recorder.

Dated the 14 day of August, 2015.

DECLARANT:  
IVORY DEVELOPMENT, LLC

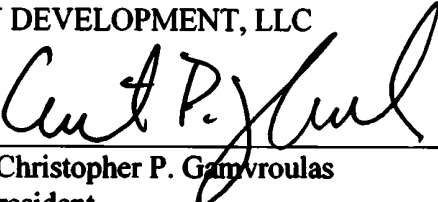
By:   
Name: Christopher P. Gamvroulas  
Title: President

ACKNOWLEDGEMENT

STATE OF UTAH            )  
  :SS.  
COUNTY OF SALT LAKE )

The foregoing instrument was acknowledged before me the 14<sup>th</sup> day of August, 2015 by Christopher P. Gamvroulas, who is the President of Ivory Development, LLC, a Utah limited liability company, and said Christopher P. Gamvroulas duly acknowledged to me that he executed the same pursuant to a Resolution of Members and/or its Articles of Organization and Operating Agreement.

  
NOTARY PUBLIC



**EXHIBIT "A"**  
**LEGAL DESCRIPTION**

The Property referred to in the foregoing document is located in Salt Lake County, Utah and is described more particularly as follows:

A portion of the NE1/4 of Section 29, Township 3 South, Range 1 West, Salt Lake Base & Meridian, located in Riverton, Utah, more particularly described as follows:

Beginning at the intersection of the northerly line of that Real Property described in Deed Book 9183 Page 1085 of the Official Records of Salt Lake County, and the easterly line of 3600 West Street located N0°06'35"W along the ¼ Section line 212.00 feet and N89°53'25"E 33.00 feet from the Center ¼ Corner of Section 29, T3S, R1W, S.L.B.& M.; thence N0°06'35"W parallel with, and 33.00 feet easterly of the ¼ Section line 430.77 feet to the south line of Plat 12, VICTORIAN STATION Subdivision, according to the Official Plat thereof on file in the Office of the Salt Lake County Recorder; thence East along said Plat 800.36 feet; thence South 160.83 feet; thence S21°42'01"W 58.12 feet; thence South 141.89 feet; thence West 51.75 feet; thence South 286.71 feet to the south line of the NE1/4 of Section 29; thence N89°57'17"W along the ¼ Section line 405.89 feet to the southeast corner of said Deed Book 9183 Page 1085; thence N0°06'35"W along said deed 212.96 (record: 212.00 feet) to the northeast corner of said deed; thence S89°53'25"W along said deed 320.00 feet to the point of beginning.

Contains: 9.68+/- acres

**EXHIBIT "B"**  
**STREET TREE GUIDELINES**

1. The following Plant List identifies the kinds of Street Trees which may be planted. No substitutions are allowed without the express prior written consent of the Declarant or Architectural Review Committee.

2. Approved Street Tree Plant List:

<u>STREET</u>	<u>COMMON NAME</u>	<u>BOTANICAL NAME</u>
12125 South Street	Cleveland Pear	Pyrus calleryana 'Cleveland Select (2" Cal.)
3510 West Street	Bechtel Crabapple	Malus Ioensis Plena (2" Caliper)

3. GENERAL REQUIREMENTS

- A. STREET TREES initially are to be planted by the homeowner in compliance with this plan.
- B. STREET TREES are to be planted in the park strip in front of each lot. They are to be centered between the back of curb and the edge of the sidewalk.
- C. Two (2) Street Trees are to be planted per lot.
- D. Corner lots shall have two (2) Street Trees on each street fronting the lot—or a total of four (4) Street Trees Minimum. In most cases, this will be two different varieties of trees. Consult the Street Tree Plan carefully.
- E. Lots on cul-de sacs have a narrower frontage and may not, in all cases, accommodate two Street Trees. Follow the guidelines in paragraph 01.6 below and provide Street Trees at the proper and appropriate spacing.
- F. STREET TREES shall be spaced at approximately forty (40) feet on center, but no less than thirty (30) feet from a street tree in front of an adjoining lot.
- G. STREET TREES shall be planted twenty (20) feet from any street intersection. This is to be measured from the point of intersection between the street curb and the sidewalk.
- H. STREET TREES shall be a minimum two inch (2") caliper in size when planted. (Caliper is the diameter of the trunk measured twelve (12) inches above the top of the root ball.)
- I. Any damaged or diseased STREET TREES are to be replaced by the homeowner at his sole cost and expense.

**EXHIBIT "A"**  
**LEGAL DESCRIPTION**

The Property referred to in the foregoing document is located in Salt Lake County, Utah and is described more particularly as follows:

A portion of the NE1/4 of Section 29, Township 3 South, Range 1 West, Salt Lake Base & Meridian, located in Riverton, Utah, more particularly described as follows:

Beginning at the intersection of the northerly line of that Real Property described in Deed Book 9183 Page 1085 of the Official Records of Salt Lake County, and the easterly line of 3600 West Street located N0°06'35"W along the ¼ Section line 212.00 feet and N89°53'25"E 33.00 feet from the Center ¼ Corner of Section 29, T3S, R1W, S.L.B.& M.; thence N0°06'35"W parallel with, and 33.00 feet easterly of the ¼ Section line 430.77 feet to the south line of Plat 12, VICTORIAN STATION Subdivision, according to the Official Plat thereof on file in the Office of the Salt Lake County Recorder; thence East along said Plat 800.36 feet; thence South 160.83 feet; thence S21°42'01"W 58.12 feet; thence South 141.89 feet; thence West 51.75 feet; thence South 286.71 feet to the south line of the NE1/4 of Section 29; thence N89°57'17"W along the ¼ Section line 405.89 feet to the southeast corner of said Deed Book 9183 Page 1085; thence N0°06'35"W along said deed 212.96 (record: 212.00 feet) to the northeast corner of said deed; thence S89°53'25"W along said deed 320.00 feet to the point of beginning.

Contains: 9.68+/- acres



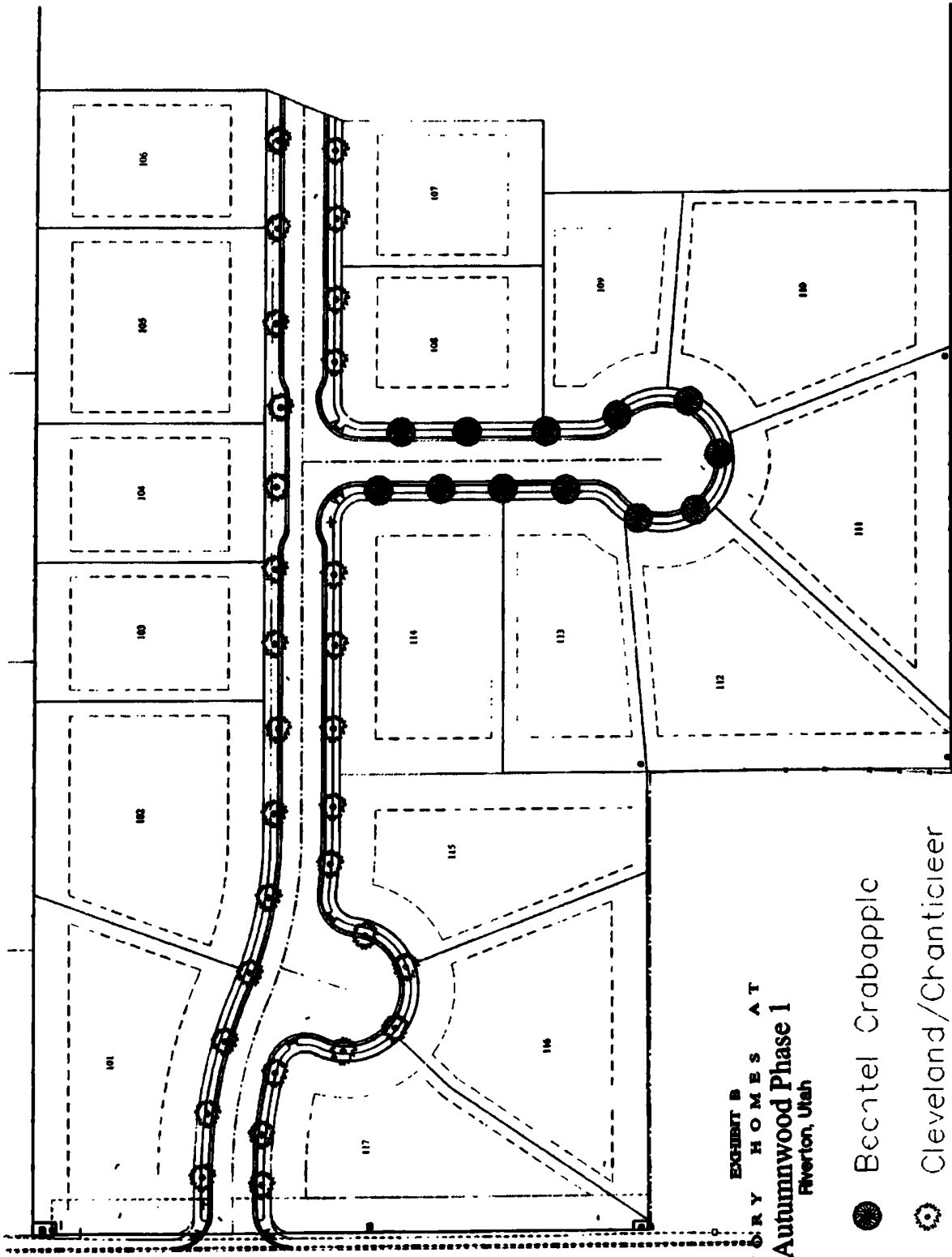
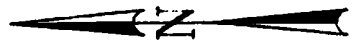

EXHIBIT B  
 I V E R Y H O M E S A T  
 Autumnwood Phase 1  
 Riverton, Utah

- Beech/Red Crabapple
- ⊗ Cleveland/Chanticleer Flowering Pear



**EXHIBIT "C"**  
**WATER-SIDE LANDSCAPING GUIDELINES**

**Refer to Attached Sheet entitled "Water-Wise Landscaping" for details.**

# IVORY HOMES

## WATER-WISE LANDSCAPING

PLANTING LIST

Autumn 1988

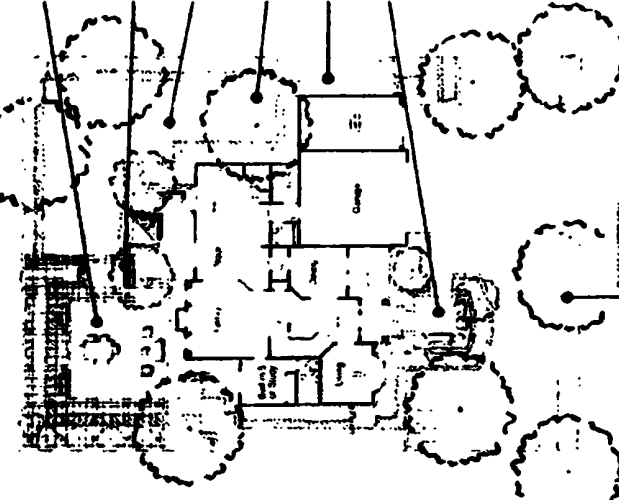

**STREET TREES** CAN CONTRIBUTE LOT OF NEIGHBORHOOD AMBIENCE, BUT THEY ALSO SHADE AND COOL PARKWAYS. THIS CAN HELP REDUCE AMBIENT TEMPERATURES AND HELP PROTECT COOLING COSTS. PLANTING AND CARING FOR STREET TREES IS AN IMPORTANT ELEMENT IN IMPROVING YOUR COMMUNITY'S LONG-TERM SUSTAINABILITY.

**INSTALLATION** YOUR COMMUNITY MAY HAVE STREET TREES THAT HAVE BEEN INSTALLED IN OTHER CITIES. YOU MAY BE EXPECTED TO PROVIDE AND PLANT THE STREET TREES IN EITHER CASE. YOUR STREET TREES WILL BE PART OF AN OVERALL COMMUNITY STREET TREE PLAN. CHECK THE COVENANTS ON OTHER MATERIALS YOU RECEIVED AND MAKE SURE THAT YOU PLANT REQUIRED STREET TREES IN ACCORDANCE WITH THE PLAN PROVIDED.

**MAINTENANCE** YOU HAVE AN IMPORTANT RESPONSIBILITY TO PROPERLY MAINTAIN YOUR STREET TREES. IF ONE TREE OR OTHER TREES IN YOUR AREA ARE DAMAGED OR FALLING, PLEASE REPORT THEM TO THE CITY. BE CAREFUL THAT OBSTRUCTIVE WATER IS PROVIDED TO YOUR STREET TREES. MAKE SURE THAT THEY WILL BE HEALTHY AND AS NECESSARY FOR PLANT PROTECTION OR LINDAS, BUT DON'T OVERWATER TO DAMAGE THE NATURAL SHOOTS OF THE TREE. STAKING IS NOT NORMALLY NECESSARY, BUT IF YOUR TREE IS NOT GROWING STRAIGHT, IT MAY BE IMPORTANT TO STAKE IT. STAKING SHOULD BE REMOVED ANNUALLY. CONSULT WITH YOUR LOCAL NURSERYMAN FOR RECOMMENDATIONS.

**WATER-WISE LANDSCAPE IDEAS**

GENEROUS PAVED PATIOS AND TERRACES PROVIDE NOT ONLY OUTDOOR LIVING SPACES AND ENTERTAINMENT OPPORTUNITIES, BUT THEY REDUCE THE AMOUNT OF WATERING IN YOUR YARD. REMEMBER, IT'S IMPORTANT TO SHADE THESE PAVED SURFACES.

AN IRRON, TRELLIS, OR ROOFED GARDEN STRUCTURE CAN HELP DEFINE SPACES IN YOUR YARD AND HELP TO REDUCE EVAPORATION.

REFLECT THE AMOUNT OF LAWN TO THAT NECESSARY FOR OUTDOOR ACTIVITIES. A GOOD GOAL FOR THE FRONT YARD IS A MAXIMUM OF 60 TO 70 PERCENT OF THE TOTAL PLANTED AREA.

PLANT SHADE TREES TO MAXIMIZE THEIR EFFECT ON SOLAR MODIFICATION IN THE HOT AFTERNOON WIND. CONSIDER NEEDS FOR BOTH THE YARD AND THE HOUSE.

CONSIDER MAKING UTILITY AREAS, IRON, OR SHEDS IN YOUR YARD AS HARD SURFACE PAVEMENT OR GRAVEL SURFACE TO REDUCE WATER USE.

CONSIDER USING ADDITIONAL PAVEMENTS IN THE FRONT YARD. THEY CAN PROVIDE AN INVITING PARKY SPACE THAT WILL ALSO REDUCE THE AREA REQUIRING IRRIGATION.

SPACE PLANTS ADEQUATELY TO PROVIDE A MATURITY COVERAGE AND SHADE FOR THE SOIL.

A WOOD BANK BUILT IN NEWLY PLANTED BEDS CAN HELP CONDITION SOIL AND REDUCE EVAPORATION FROM THE SOIL SURFACE.

CONSIDER ALTERNATE SURFACES IN PLAY AREAS SUCH AS SAND OR WOOD CHIPS. MADE ESPECIALLY FOR PLAY AREAS.



### IDEAS FOR IRRIGATION SYSTEMS

AN AUTOMATIC IRRIGATION SYSTEM, WHEN PROPERLY MAINTAINED AND MONITORED, CAN REDUCE WATER WASTE.

MAKE SURE THAT LAWN AREAS AND SHRUB BEDS ARE ON SEPARATE WATER VALVES. SHRUBS USE MUCH LESS WATER THAN LAWN, SO SHOULD BE WATERED LESS. SEPARATING THE VALVES AND MONITORING WATER NEEDS WILL SAVE WATER.

WHEN TYPING OUT YOUR SYSTEM, ALSO CONSIDER MICRO-IRRIGATION. TIME-NOTED EAST SIDE OF YOUR HOUSE WILL BE IN SHADE LONGER THAN THE SOUTH AND WEST SIDES.

DRIP IRRIGATION SYSTEMS CAN BE EFFECTIVE IN SHRUB BEDS AND WILL HELP CONSERVE WATER.

WATER YOUR YARD DURING EARLY-MORNING HOURS TO HELP MINIMIZE EVAPORATION.

### PALM STRIPS

ADD AN AS THE ORIGINALITY TO THE NEIGHBORHOOD. YOU CAN USE THEM TO PROTECT SOIL FROM BEING DRY BY NOT AND SUBSIDIZED BY ANNEALISTS. PALS ARE BEST FOR DRY OR TO QUICKLY SOILS ARE NOT THE BEST CHOICE FOR PALM STRIPS. A GOOD ALTERNATIVE IS TO PLANT YOUR PALM STRIP WITH A SINGLE GROUND COVER. SOME GOOD CHOICES FOR PALM STRIPS INCLUDE:

- *ALUGA REPENS (CARET BLOSSOM)*, *SHRUB DARK GREEN*, AND *IRIGALIA WITH PURPLE FLOWERS IN Y-MAIL*
- *CARATHI WITH TOMATOES IN STABLE*, *SHORT BLUE-GREEN* WITH *WHITE FLOWERS IN LATE SPRING*
- *SODUM SPERULUM (DRAGON'S SILVER) IN SPRING*
- *BROWN-GREEN* WITH *RED FLOWERS IN SPRING*
- *THOMAS SARDIOLA (GOLDEN) OF THE MONTH*, *SHORT SOFT GREEN* WITH *LATE SPRING FLOWERS IN SUMMER* AND *FINE* WITH *ORANGE PERI PERI*
- *FRONT WITH PURPLE FLOWERS IN SPRING*
- *GRAVEL* AND *ROCK* ARE DISCOURAGED BECAUSE THEY ADD TO THE PROBLEM OF HEAT RADIATION. RADIANT HEAT HOW EVER USE PASTRY TO PROVIDE PEDESTRIAN ACCESS

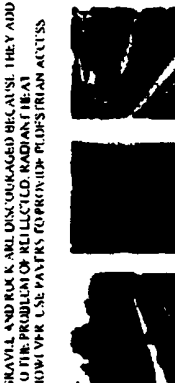

## SUGGESTED PLANT LIST

### WATER-WISE PLANTS

THESE PLANTS ARE WISE CHOICES FOR WATER-WISE LANDSCAPING. THEY REQUIRE LESS WATER THAN MOST PLANTS AND ARE SUITABLE FOR YOUR CLIMATE. THEY CAN BE USED IN MANY AREAS OF YOUR YARD, INCLUDING PATIOS, TERRACES, AND PATHWAYS. THEY CAN ALSO BE USED TO SHADE THESE AREAS AND HELP CONSERVE WATER.

- SHRUBS**
- FLORAL TREES**
- SHRUB TREES**
- SMALL TREES**
- GRASSES**
- PERENNIALS**
- ANNUALS**
- HERBACEOUS PERENNIALS**
- WILDFLOWERS**

### TABLES

PLANT NAME	PLANT TYPE
Aster	Perennial
Cornflower	Annual
Black-eyed Susan	Perennial
Coneflower	Perennial
Daylily	Perennial
Delphinium	Perennial
Drumstick	Annual
Flax	Perennial
Goldenrod	Perennial
Hydrangea	Shrub
Lupine	Perennial
Marigold	Annual
Peony	Perennial
Rose	Shrub
Sage	Herbaceous Perennial
Verbena	Perennial
Zinnia	Annual

### GROUNDCOVERS

- ALLIUM*
- ARTEMISIA*
- ASCLEPIAS*
- BEAUCARPUS*
- BERBERIS*
- CASCABELLO*
- CELANDE*
- CELEBRIS*
- CELEBRIS*
- CELEBRIS*
- CELEBRIS*
- CELEBRIS*
- CELEBRIS*
- CELEBRIS*
- CELEBRIS*
- CELEBRIS*
- CELEBRIS*
- CELEBRIS*
- CELEBRIS*
- CELEBRIS*
- CELEBRIS*
- CELEBRIS*

