

71#2

WHEN RECORDED  
RETURN TO: Big  
Cottonwood Cove P.U.D.  
4968 S Holladay Pines Ct.  
Holladay, UT 84117

13128292  
11/20/2019 09:43 AM \$42.00  
Book - 10862 Pg - 2906-2909  
RASHELLE HOBBS  
RECORDER, SALT LAKE COUNTY, UTAH  
COTTONWOOD COVE PUD  
4968 S. HOLLADAY PINES CT.  
HOLLADAY UT 84117  
BY: DSA, DEPUTY - WI 4 P.

AMENDMENT TO: DECLARATION OF  
COVENANTS, CONDITIONS AND  
RESTRICTIONS FOR BIG  
COTTONWOOD COVE HOA

Add and amend the following Article to Section 6 – Owner’s Maintenance Obligations:

6.5. Lot owners are responsible to protect and maintain the lot retention ponds and filtration sumps on their respective lots and infiltration sumps in the water ways (gutter) adjacent to their respective lots as shown on Exhibit D.

6.6 The Homeowners Association has the authority to enforce the maintenance and protection of these retention ponds and infiltration sumps.

Add and amend the following Article to Section 8.2 - Remedies:

(e) The following fines will be enforced by the HOA Declarant or Board members for failure of Members to perform certain duties or for the violation of articles found in these Declarations. The first infraction or violation will be charged at \$100. The second violation - \$150, 3<sup>rd</sup> violation \$200 and will continue at a rate of \$100 from there. Interest will also be charged on unpaid balances after 30 days of delinquency at a rate of 18% per annum.

The foregoing instrument was executed as of the date stated above.

JAR Real Estate Development a dba for Rice Asset Mgmt  
LLC

By: Anita Rice  
Anita Rice,  
Manager

State of Utah )

:SS

County of Salt Lake )

The foregoing instrument was acknowledged before me on the 20<sup>th</sup> day of November, 2019, by Anita Rice, a Manager of JAR Real Estate Development, dba for Rice Asset Mgmt LLC.

Angela Byers Notary Public Residing at: SLC UT

Angela E Byers

My Commission Expires:

11/11/2023

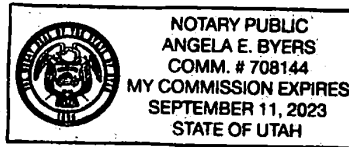

**GENERAL NOTES:**

1. THE CONTRACTOR SHALL BE RESPONSIBLE FOR THE CONSTRUCTION OF ALL DRAINAGE STRUCTURES AND SHALL BE RESPONSIBLE FOR THE PROTECTION OF ALL EXISTING UTILITIES AND STRUCTURES. THE CONTRACTOR SHALL BE RESPONSIBLE FOR THE PROTECTION OF ALL EXISTING UTILITIES AND STRUCTURES. THE CONTRACTOR SHALL BE RESPONSIBLE FOR THE PROTECTION OF ALL EXISTING UTILITIES AND STRUCTURES.

2. THE CONTRACTOR SHALL BE RESPONSIBLE FOR THE CONSTRUCTION OF ALL DRAINAGE STRUCTURES AND SHALL BE RESPONSIBLE FOR THE PROTECTION OF ALL EXISTING UTILITIES AND STRUCTURES. THE CONTRACTOR SHALL BE RESPONSIBLE FOR THE PROTECTION OF ALL EXISTING UTILITIES AND STRUCTURES. THE CONTRACTOR SHALL BE RESPONSIBLE FOR THE PROTECTION OF ALL EXISTING UTILITIES AND STRUCTURES.

**HOPE SLUMP DATA**

| SLUMP NO. | SLUMP   | STONE   | STONE | STONE  | STONE | VOLUME |
|-----------|---------|---------|-------|--------|-------|--------|
| 1         | 4428.81 | 4428.81 | 3.00  | 116.52 |       |        |
| 2         | 4428.92 | 4428.92 | 3.00  | 154.52 |       |        |
| 3         | 4428.92 | 4428.92 | 3.00  | 154.52 |       |        |
| 4         | 4428.92 | 4428.92 | 3.00  | 154.52 |       |        |
| 5         | 4428.92 | 4428.92 | 3.00  | 154.52 |       |        |
| 6         | 4428.92 | 4428.92 | 3.00  | 154.52 |       |        |
| 7         | 4428.92 | 4428.92 | 3.00  | 154.52 |       |        |
| 8         | 4428.92 | 4428.92 | 3.00  | 154.52 |       |        |
| 9         | 4428.92 | 4428.92 | 3.00  | 154.52 |       |        |
| 10        | 4428.92 | 4428.92 | 3.00  | 154.52 |       |        |

**NOTE:**

1. THE CONTRACTOR SHALL BE RESPONSIBLE FOR THE CONSTRUCTION OF ALL DRAINAGE STRUCTURES AND SHALL BE RESPONSIBLE FOR THE PROTECTION OF ALL EXISTING UTILITIES AND STRUCTURES. THE CONTRACTOR SHALL BE RESPONSIBLE FOR THE PROTECTION OF ALL EXISTING UTILITIES AND STRUCTURES. THE CONTRACTOR SHALL BE RESPONSIBLE FOR THE PROTECTION OF ALL EXISTING UTILITIES AND STRUCTURES.

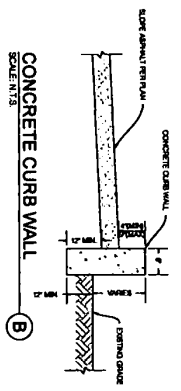

**GRADING AND DRAINAGE KEY NOTES REFERENCE**

| NO. | DESCRIPTION        | DETAIL  |
|-----|--------------------|---------|
| 1   | 1" HOPE SLUMP      | 2001.02 |
| 2   | CONCRETE CURB WALL | 2001.02 |
| 3   | CONCRETE CURB WALL | 2001.02 |
| 4   | CONCRETE CURB WALL | 2001.02 |

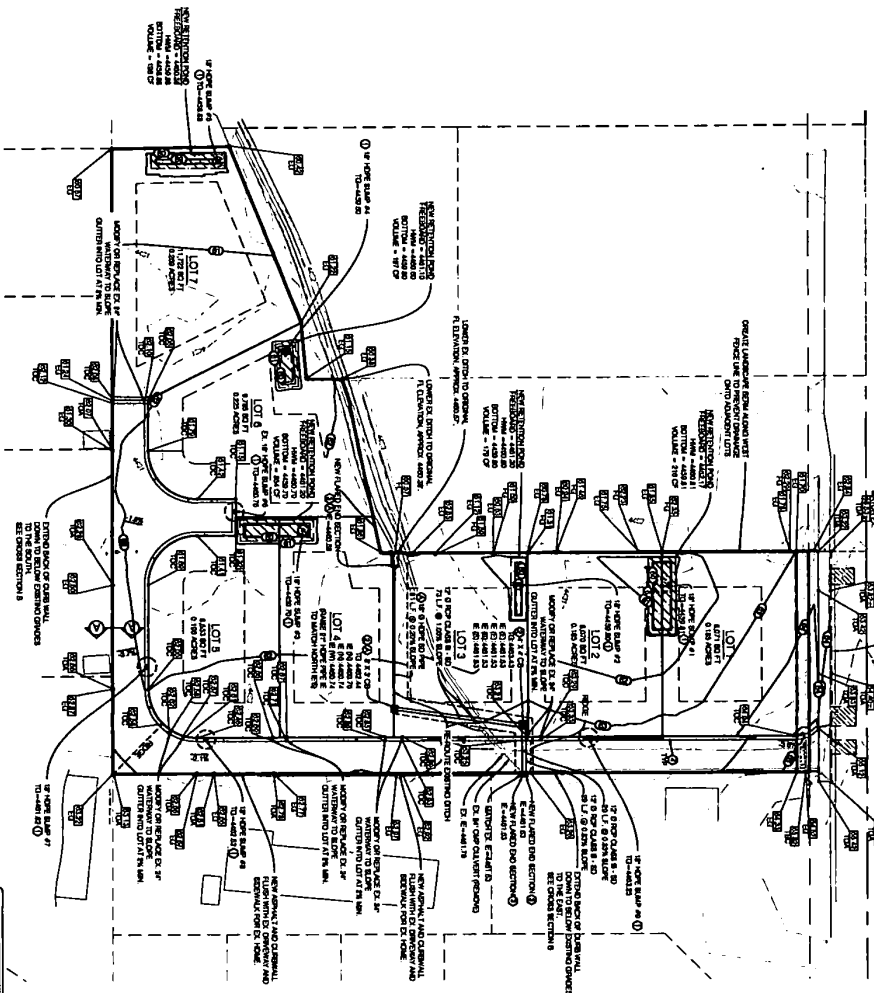

**NOTE:**

1. THE CONTRACTOR SHALL BE RESPONSIBLE FOR THE CONSTRUCTION OF ALL DRAINAGE STRUCTURES AND SHALL BE RESPONSIBLE FOR THE PROTECTION OF ALL EXISTING UTILITIES AND STRUCTURES. THE CONTRACTOR SHALL BE RESPONSIBLE FOR THE PROTECTION OF ALL EXISTING UTILITIES AND STRUCTURES. THE CONTRACTOR SHALL BE RESPONSIBLE FOR THE PROTECTION OF ALL EXISTING UTILITIES AND STRUCTURES.

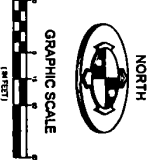

**CALL BEFORE YOU DIG**  
IS THE WAY TO SAFETY  
1-800-485-1111  
www.callbeforeyoudig.com

**BIG COTTONWOOD COVE**  
2150 E. & 2160 E. 6200 S.  
HOLLADAY, UT 84121



**BENCHMARK ENGINEERING & LAND SURVEYING**  
2150 E. 6200 S. HOLLADAY, UT 84121  
PHONE: 801-225-8888  
WWW.BENCHMARKSURVEYING.COM



| NO. | DATE     | DESCRIPTION          |
|-----|----------|----------------------|
| 1   | 11/11/11 | PRELIMINARY          |
| 2   | 11/11/11 | REVISED PER COMMENTS |
| 3   | 11/11/11 | REVISED PER COMMENTS |
| 4   | 11/11/11 | REVISED PER COMMENTS |
| 5   | 11/11/11 | REVISED PER COMMENTS |
| 6   | 11/11/11 | REVISED PER COMMENTS |
| 7   | 11/11/11 | REVISED PER COMMENTS |
| 8   | 11/11/11 | REVISED PER COMMENTS |
| 9   | 11/11/11 | REVISED PER COMMENTS |
| 10  | 11/11/11 | REVISED PER COMMENTS |



*DocQuery*  
**Subdivision Details**

**Subdivision • BIG COTTONWOOD COVE SUB**

**Entry Number • 12693747      Book • 2018P      Page • 009      Date • 1/8/2018**

**Dedication Type • SUBDIVISION      City • HOLLADAY**

| Parcel Number  | Lot/Unit | Value | Block/Bldg | Value | Non Standard   | Property Location | Jurisdiction | ZipCode |
|----------------|----------|-------|------------|-------|----------------|-------------------|--------------|---------|
| 22221040260000 | LOT      | 1     |            |       |                | 6210 S LINDSAY LN | HOLLADAY     | 84121   |
| 22221040270000 | LOT      | 2     |            |       |                | 6214 S LINDSAY LN | HOLLADAY     | 84121   |
| 22221040280000 | LOT      | 3     |            |       |                | 6218 S LINDSAY LN | HOLLADAY     | 84121   |
| 22221040290000 | LOT      | 4     |            |       |                | 6222 S LINDSAY LN | HOLLADAY     | 84121   |
| 22221040300000 | LOT      | 5     |            |       |                | 2155 E LINDSAY LN | HOLLADAY     | 84121   |
| 22221040320000 | LOT      | 7     |            |       |                | 2141 E LINDSAY LN | HOLLADAY     | 84121   |
| 22221040330000 | LOT      | 6     |            |       |                | 2147 E LINDSAY LN | HOLLADAY     | 84121   |
| 22221260254001 |          |       |            |       | COMMON AREA    | 6212 S LINDSAY LN | HOLLADAY     | 84121   |
| 22221260254001 |          |       |            |       | PRIVATE STREET | 6212 S LINDSAY LN | HOLLADAY     | 84121   |
| 22221260254002 |          |       |            |       | COMMON AREA    | 2157 E LINDSAY LN | HOLLADAY     | 84121   |
| 22221260254002 |          |       |            |       | PRIVATE STREET | 2157 E LINDSAY LN | HOLLADAY     | 84121   |