

CERTIFICATION

STATE OF UTAH,
City and County of Salt Lake,

13924370 B: 11324 P: 2720 Total Pages: 2
04/01/2022 02:00 PM By: dhummel Fees: \$0.00
CERTIF - CERTIFICATE
Rashelle Hobbs, Recorder, Salt Lake County, Utah
Return To: SL CITY RECORDER
PO BOX 145465 SALT LAKE CITY, UT 84114



I, Mais Stewart, Deputy City Recorder of Salt Lake City, Utah, do hereby certify that this document is a full, true and correct copy of Ordinance 070 of 2021 closing and vacating a portion of an alley situated adjacent to properties located at the Amended Plat of Whitaker Subdivision of Lots 18 and 19, Block 16A, 5Acre Plat A. Big Field Survey located between lots 1-55 running from 1300 East Street and the Salt Lake & Jordan Canal), pursuant to Petition No. PLNPCM2021-00413.
Passed by City Council action of Salt Lake City, Utah on December 7, 2021.

IN WITNESS WHEREOF, I have hereunto set my hand and affixed the corporate seal of said City, this 25th day of March 2022.

Deputy City Recorder, Salt Lake City, Utah

This ordinance affects the following parcels, and each is vested in 1/2 of the adjoining vacated alley along the centerline of the vacated alley pursuant to the attached map and legal description:

Parcel No:	Address:	Parcel No:	Address:
16-17-276-001	1208 E. Kensington Ave.	16-17-276-002	1212 E. Kensington Ave.
16-17-276-003	1216 E. Kensington Ave.	16-17-276-004	1220 E. Kensington Ave.
16-17-276-005	1224 E. Kensington Ave.	16-17-276-006	1230 E. Kensington Ave.
16-17-276-007	1236 E. Kensington Ave.	16-17-276-008	1244 E. Kensington Ave.
16-17-276-009	1250 E. Kensington Ave.	16-17-276-010	1256 E. Kensington Ave.
16-17-276-011	1266 E. Kensington Ave.	16-17-276-012	1276 E. Kensington Ave.
16-17-276-013	1280 E. Kensington Ave.	16-17-276-027	1542 S. 1300 E.
16-17-276-014	1199 E. Bryan Ave.	16-17-276-015	1211 E. Bryan Ave.
16-17-276-016	1213 E. Bryan Ave.	16-17-276-017	1219 E. Bryan Ave.
16-17-276-018	1225 E. Bryan Ave.	16-17-276-019	1229 E. Bryan Ave.
16-17-276-031	1233 E. Bryan Ave.	16-17-276-032	1241 E. Bryan Ave.
16-17-276-021	1247 E. Bryan Ave.	16-17-276-022	1253 E. Bryan Ave.
16-17-276-023	1259 E. Bryan Ave.	16-17-276-024	1265 E. Bryan Ave.
16-17-276-025	1273 E. Bryan Ave.	16-17-276-028	1550 S. 1300 E.

Map of alleyway vacation:

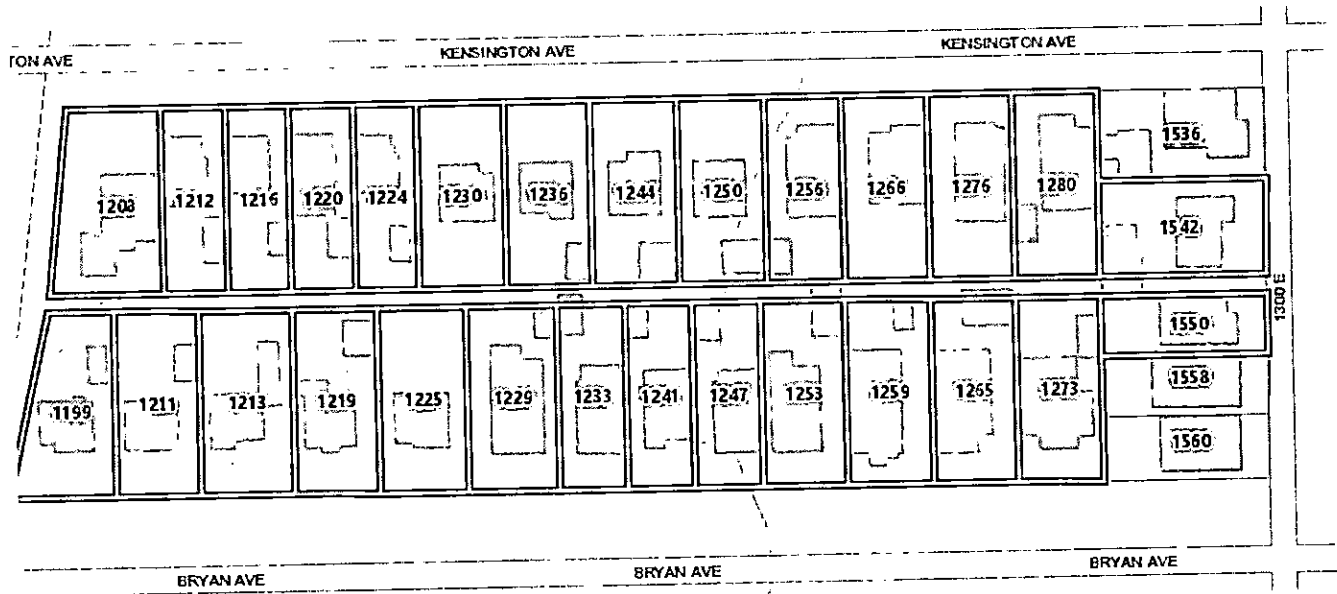

Legal description of the unnamed, city-owned alley to be vacated:

AN 11.00 FOOT WIDE ALLEY TO BE VACATED WITHIN BLOCK 2 OF WHITAKER SUBDIVISION AMENDED, SALT LAKE CITY, SALT LAKE COUNTY, UTAH MORE PARTICULARLY DESCRIBED AS FOLLOWS;

COMMENCING AT THE MONUMENT IN THE INTERSECTION OF KENSINGTON AVENUE & 1300 EAST STREET (POC); THENCE S89°56'37"W ALONG THE MONUMENT LINE IN KENSINGTON AVENUE (BASIS OF BEARINGS) A DISTANCE OF 6.55 FEET AND S00°10'33"W A DISTANCE OF 29.18 FEET TO THE NORTHEAST CORNER OF BLOCK 2, WHITAKER SUBDIVISION AMENDED, AND CONTINUING S00°10'33"W ALONG THE EAST LINE OF BLOCK 2 (ALSO THE EAST LINE OF LOT 55) A DISTANCE OF 105.19 FEET TO THE SOUTHEAST CORNER OF SAID LOT 55 TO THE POINT OF BEGINNING (POB).

THENCE N89°55'03"W ALONG THE SOUTH LINES OF LOTS 29-55 A DISTANCE OF 715.62 FEET TO THE SOUTHWEST CORNER OF LOT 29;

THENCE S06°32'02"W A DISTANCE OF 3.96 FEET;

THENCE S13°00'36"W A DISTANCE OF 7.25 FEET TO THE NORTHWEST CORNER OF LOT 28 OF SAID BLOCK;

THENCE S89°55'03"E ALONG THE NORTH LINES OF LOTS 1-28 A DISTANCE OF 717.67 FEET TO THE NORTHEAST CORNER OF LOT 1 AND A POINT ON THE EAST LINE OF SAID BLOCK 2;

THENCE N00°10'33"E ALONG THE EAST LINE OF BLOCK 2 A DISTANCE OF 11.00 FEET TO THE POINT OF BEGINNING.

CONTAINS 0.18 ACRES.