

FINAL LOCAL ENTITY PLAT
HH PUBLIC INFRASTRUCTURE DISTRICT # 2
 APART OF ROYAL HOLLADAY HILLS BLOCK F HOLLADAY HILLS SUBDIVISION #2
 LOCATED WITHIN, SALT LAKE COUNTY UTAH. A PART OF THE NORTHWEST QUARTER
 OF SECTION 10, TOWNSHIP 2 SOUTH, RANGE 1 EAST, SALT LAKE BASE & MERIDIAN.
 CITY OF HOLLADAY, UTAH. RMU ZONE

SURVEYOR'S CERTIFICATE
 I, Shane Johanson, do hereby certify that I am a Professional Land Surveyor in the State of Utah and that I hold License No. 7075114. I do hereby certify that a Final Local Entity Plat, in accordance with Section 17-23-20 of Utah State Code, was made by me, or under my direction, and shown hereon is a true and correct representation of said Final Local Entity Plat. I further certify that by authority of the Owners, I have prepared this plat for the purpose of depicting those properties within Salt Lake County to be annexed into Holladay City.

BOUNDARY DESCRIPTION
 A parcel of land that is described as Block F Royal Holladay Hills Subdivision #2, platted, and recorded as Entry #13700581, in Book 2021P, on Page 171, in the office of the Salt Lake County Recorder. Said parcel of land is also located in the Northwest quarter of Section 9 and in the Northwest quarter of Section 10, Township 2 South, Range 1 East, Salt Lake Base and Meridian.
 More Particular described as follows: Beginning at the point that is the Westerly Corner of Block F Royal Holladay Hills Subdivision #2, recorded June 25, 2021, as Entry Number 13700581, said point lies North 00°03' 51" West a distance of 451.53 feet and West 607.32 feet from the East Quarter Corner of Section 9 Township 2 South, Range 1 East, Salt Lake Base and Meridian.
 Thence running around the perimeter of said Block F of said Royal Holladay Subdivision # 2 the following courses Thence N 48° 41' 17" E a distance of 531.98 feet, Thence S 41° 18' 43" E a distance of 97.21 feet, Thence S 02° 20' 32" W a distance of 650.20 feet, Thence N 87° 03' 34" W a distance of 37.20 feet to the beginning of a non-tangential curve, Said curve bears to the right through a central angle of 23° 04' 22", having a radius of 56.00 feet along the arc a distance of 22.55, and whose long chord bears S 49° 52' 46" W a distance of 22.40 feet, Thence S 61° 24' 57" W a distance of 45.21 feet, Thence N 56° 10' 59" W a distance of 13.95 feet, Thence N 39° 48' 39" W a distance of 517.95 feet to the point of beginning.
 Containing 198,133 Square Feet or 4.55 Acres

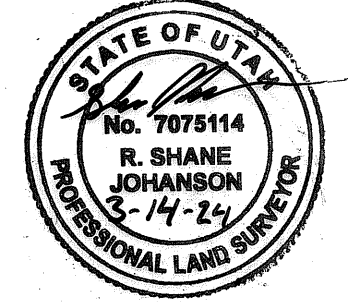

Date: March 14, 2024
 R. Shane Johanson
 P.L.S. 7075114

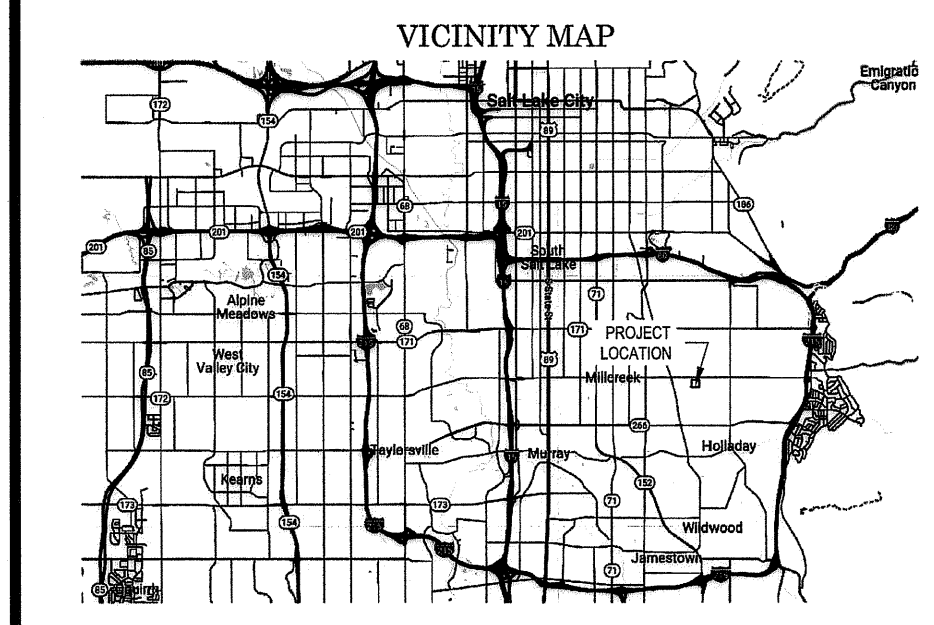

ENTITY PLAT NOTES:
 1. THIS IS A PLAT FOR IMPROVEMENT DISTRICT BOUNDARIES AND SERVICES AREA(S). SEE ROYAL HOLLADAY HILLS PLAT FOR ADDITIONAL INFORMATION DIMENSIONS, NOTES, AND CALCULATIONS. RECORDED 06-25-2021 ENTRY # 13700581.

FINAL LOCAL ENTITY PLAT
HH PUBLIC INFRASTRUCTURE DISTRICT # 2
 APART OF ROYAL HOLLADAY HILLS BLOCK F HOLLADAY HILLS SUBDIVISION #2
 LOCATED WITHIN, SALT LAKE COUNTY UTAH. A PART OF THE NORTHWEST QUARTER
 OF SECTION 10, TOWNSHIP 2 SOUTH, RANGE 1 EAST, SALT LAKE BASE & MERIDIAN.
 CITY OF HOLLADAY, UTAH. RMU ZONE

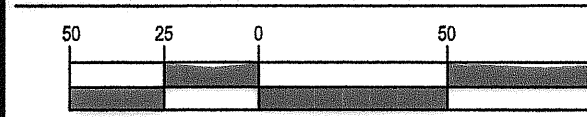

JOHANSON SURVEYING
 PROFESSIONAL LAND SURVEYORS
 SURVEYING ENGINEERS REGISTERED PLANNING
 KMW DEVELOPMENT, DEVELOPER
 KMW Development LLC, a Utah limited liability company, 2333 E. Parleys Way Suite 300 Salt Lake City, UT, 84109
 PREPARED: 3/11/2024

- LEGEND**
- ◆ SECTIONAL CORNER
 - ⊕ STREET MONUMENT
 - ⊕ REBAR & CAP TO BE SET LS 7075114 R.S. JOHANSON
 - REPRESENTS PROPERTY LINE
 - - - TYP. P.U.E. & PRIVATE UTILITY & EGRESS/INGRESS EASE
 - ▨ POWER BASE
 - ▨ PID AREA AS PER PLAT

SALT LAKE COUNTY SURVEYOR
 APPROVED THIS 15 DAY OF March, 2024, BY THE SALT LAKE COUNTY SURVEYOR AS A FINAL LOCAL ENTITY PLAT, PURSUANT TO SECTION 17-23-20 OF UTAH STATE CODE.
 [Signature] for 3/15/24
 Salt Lake County Surveyor Date

ACCEPTANCE LEGISLATIVE BODY
 Approved and accepted this 15 day of March, A.D. 2024. By the Holladay City.
 [Signature] City Manager
 [Signature] City Recorder

Salt Lake County Recorder
 Recorded # 14248077
 State of Utah, County of Salt Lake, recorded and filed at the request of City of Holladay
 Date 03/04/2024 Time 10:16 AM Book 2024P Page 141
 No Fee Fee \$ Mike Zeiger Deputy Salt Lake County Recorder

Number _____
 Account _____
 Sheet _____
 of _____ Sheets