

This map is provided solely for the purpose of assisting in locating the property and Cottonwood Title Insurance Agency, Inc. assumes no liability for variation, if any, with any actual survey.

15-103

# TERRACE HEIGHTS ADDITION

I, Simon F. Machie, U.S. Deputy Mineral Surveyor, hereby certify that the annexed map is a correct plat of the NW 1/4 SW 1/4 of Section 14, T.15. R.1. E. - S.21. N. as the same has been subdivided by Mr. John C. Kaffa, Salt Lake City Utah, Simon F. Machie, Nov 8<sup>th</sup> 1889.

North West 1/4 of South West 1/4 Sec. 14. T.15. R.1. E.  
Scale 50ft = 1 in

Approved November 13<sup>th</sup> 1889  
M. Bartlett  
Probate Judge.

Filed January 11<sup>th</sup> 1890 at 12 m.  
By J. C. Kaffa  
Recorder Salt Lake County Utah.

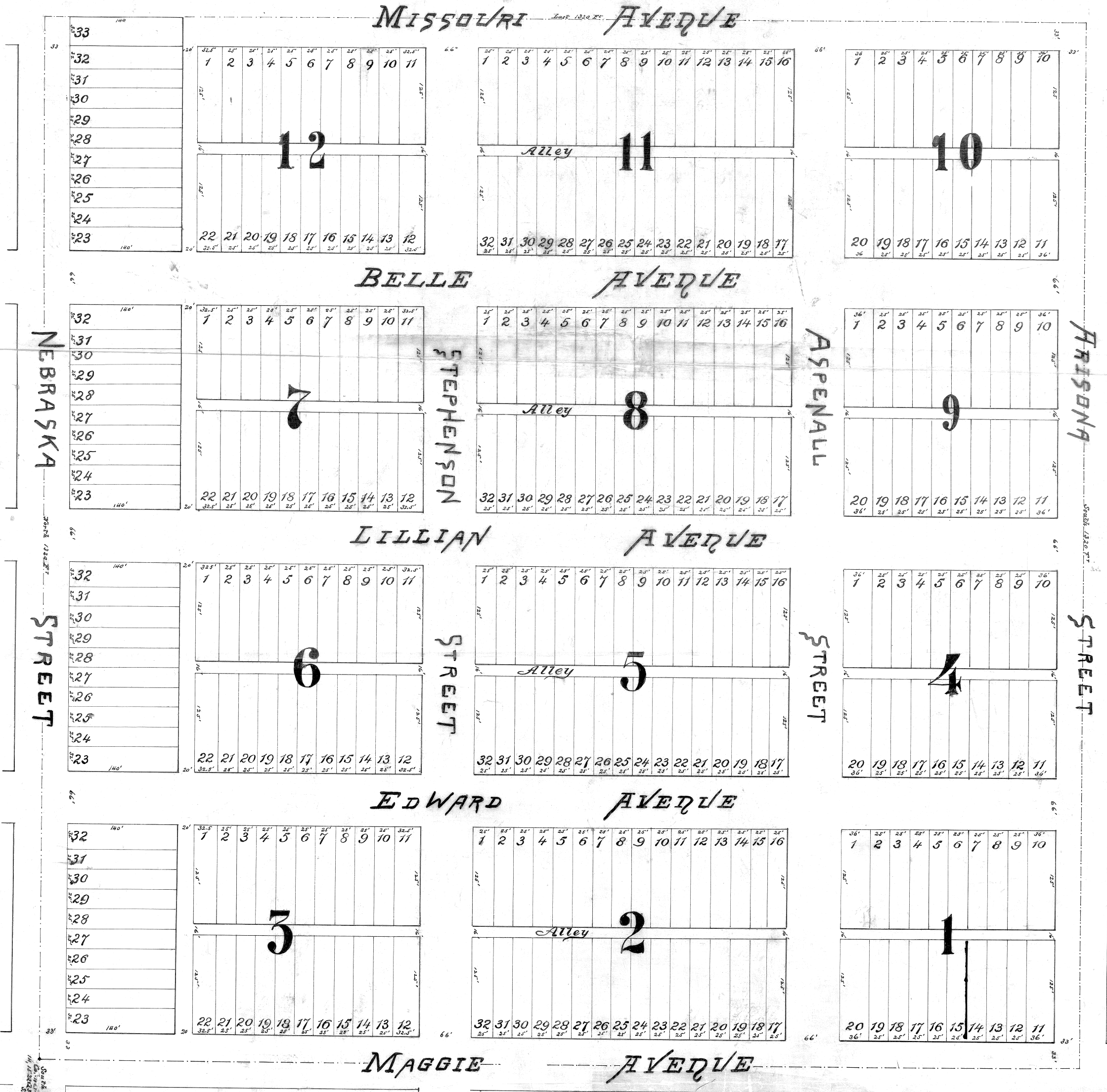

Original Filed  
in Office of  
T. A. R. 1889

D.M.