

DOC # 20210070570

Warranty Deed Page 1 of 2  
Gary Christensen Washington County Recorder  
11/01/2021 03:12:15 PM Fee \$ 40.00  
By MCARTHUR STAN



**WHEN RECORDED RETURN TO:**

Stan McArthur  
535 E. Veyo Resort Rd  
Veyo, Utah 84782

**WARRANTY DEED**

Stanley Elgin McArthur and Teresa Lynn McArthur, Trustees of the Stanley And Teresa McArthur Revocable Trust dated February 23, 2018, grantor(s), of St. George, County of Washington, State of Utah, hereby CONVEYS AND WARRANTS to

Stanley Elgin McArthur and Teresa Lynn McArthur, Trustees of the Stanley And Teresa McArthur Revocable Trust dated February 23, 2018, grantee(s) of Veyo, County of Washington, State of Utah, for the sum of TEN DOLLARS AND OTHER GOOD AND VALUABLE CONSIDERATION the following described tract of land in Washington County, State of UTAH:

See Exhibit "A" attached hereto for the legal description.

Tax Parcel No.: 7158-H-1-NW and 7158-B-NW (portion)

TOGETHER WITH all improvements and appurtenances thereunto belonging, and being SUBJECT TO easements, rights of way, restrictions, and reservations of record and those enforceable in law and equity.

WITNESS the hand(s) of said grantor(s), this 1 of Nov., A. D. 2021.

Stanley And Teresa McArthur Revocable Trust dated February 23, 2018

Stanley Elgin McArthur  
Stanley Elgin McArthur, Trustee

Teresa Lynn McArthur  
Teresa Lynn McArthur, Trustee

**NOTARY**

STATE OF Utah )

County of Washington ) ss

On the 1 day of Nov., A. D. 2021, personally appeared before me, Stanley Elgin McArthur and Teresa Lynn McArthur, Trustees of the Stanley And Teresa McArthur Revocable Trust dated February 23, 2018, the signer(s) of the within instrument, who duly acknowledged to me that they executed the same.

Deb Wanlass  
Notary Public

My Commission Expires:  
Residing at:

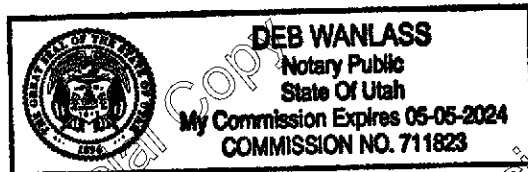



1453 S Dixie Drive, Suite 150

St. George, UT 84770

435-986-0100

Exhibit "A"

**COMBINED PROPERTY  
LEGAL DESCRIPTION**

BEGINNING AT A POINT S 89°57'00" E 2638.74 FEET ALONG THE SOUTH LINE OF SECTION 6, TOWNSHIP 40 SOUTH RANGE 16 WEST, SALT LAKE BASE AND MERIDIAN, AND N 0°17'15" E 1323.84 FEET ALONG THE EAST LINE OF SAID SECTION 6, FROM THE SOUTH QUARTER CORNER OF SAID SECTION 6, AND RUNNING THENCE S 89°57'12" W 831.00 FEET; THENCE N 0°17'15" E 526.82 FEET; THENCE S 89°42'45" E 830.98 FEET, TO A POINT ON THE SAID EAST LINE OF SECTION 6; THENCE S 0°17'15" W 521.97 FEET ALONG SAID LINE, TO THE POINT OF BEGINNING.

CONTAINS 435,761 SQ FT OR 10.00 ACRES MORE OR LESS

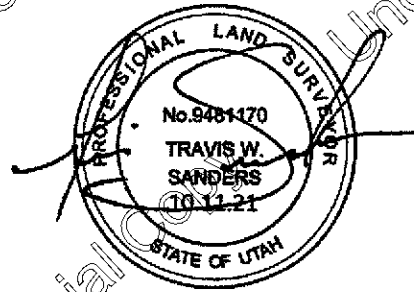

TWS  
21065.008

T.M. SEM