



**WHEN RECORDED RETURN TO:**

Washington City Recorder  
111 North 100 East  
Washington, Utah 84780

**Tax I.D. No:** W- SOL-1 - 28 - CC

**ACCESSORY DWELLING UNIT DEED RESTRICTION**

WHEREAS, in reliance upon the recording of this Deed Restriction, which is effective upon the date and time of its recording, a permit for an accessory dwelling unit was issued by Washington City to CW THE SOLIS LLC, (the Owner) who is the current owner of the herein described parcel of land (the "Parcel") which is located at 1526 N. Highland Pkwy, and identified by the Washington County Recorder with the following Parcel ID #: W-SOL-1-28-CC and further described as follows:

See "Exhibit A - Site Plan for the Parcel"

THEREFORE, The Owner declares this Deed Restriction and agrees to strictly adhere to the regulations governing attached, detached, and internal accessory dwelling units within Washington City as set forth in the Washington City Code and Utah Code. The Owner also agrees to the complete and absolute prohibition of use of the accessory dwelling as a nightly rental, short-term rental, or vacation rental.

THE RECORDING OF THIS DEED RESTRICTION is recorded against the property at the discretion of Washington City and the Owner of the property, and shall be deemed to run with the land and with the property and shall be binding on all successors, and assigns.

IN THE WITNESS WHEREOF, the undersigned has set his/her hand this 25 day of August, 2023.

By: [Signature]  
Printed Name: Chris Winter  
Representative of Cole West Home  
STATE OF UTAH )

COUNTY OF WASHINGTON )

On this 25 day of August 2023, before me personally appeared, Chris Winter whose identity is personally known to or proved to me on the basis of satisfactory evidence, and who, being by me duly sworn (or affirmed), did say that he/she is the owner of the property described, and did duly acknowledge to me that the forgoing document was entered into and signed by him/her.

[Signature]  
NOTARY PUBLIC  
Residing at: Washington, Utah

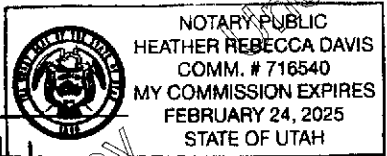

8/24/23, 12:46 PM

Account View

**Account 1168287**

Location	Owner	Value	
<b>Account Number</b> 1168287	<b>Name</b> CW THE SOLIS LLC	<b>Market (2023)</b>	\$105,000
<b>Parcel Number</b> W-SOL-1-28-CC	610 N 800 W	<b>Taxable</b>	\$105,000
<b>Tax District</b> 41 - Washington Coral Canyon SID	CENTERVILLE, UT 84014-1482	<b>Tax Area:</b> 41	<b>Tax Rate:</b> 0.007928
<b>Acres</b> 0.21		<b>Type</b>	<b>Actual</b> <b>Assessed</b> <b>Acres</b>
<b>Situs</b> 0, 0		Non	
<b>Legal Subdivision:</b> SOLIS AT CORAL CANYON 1 (W) Lot 28		Primary	\$105,000 \$105,000 0.210
<b>Parent Accounts</b> 1151643		Land	
<b>Parent Parcels</b> W-4-2-7-100-CC			
<b>Child Accounts</b>			
<b>Child Parcels</b>			
<b>Sibling Accounts</b>			
<b>Sibling Parcels</b>			

Transfers

Entry Number	Recording Date
<u>20220031035</u>	<u>06/14/2022 03:04:09 PM</u>
<u>20220047410</u>	<u>06/21/2022 03:00:32 PM</u>

Tax

Images

Tax Year	Taxes
*2023	\$832.44
2022	No Tax Values

• [GIS](#)

\* Estimated

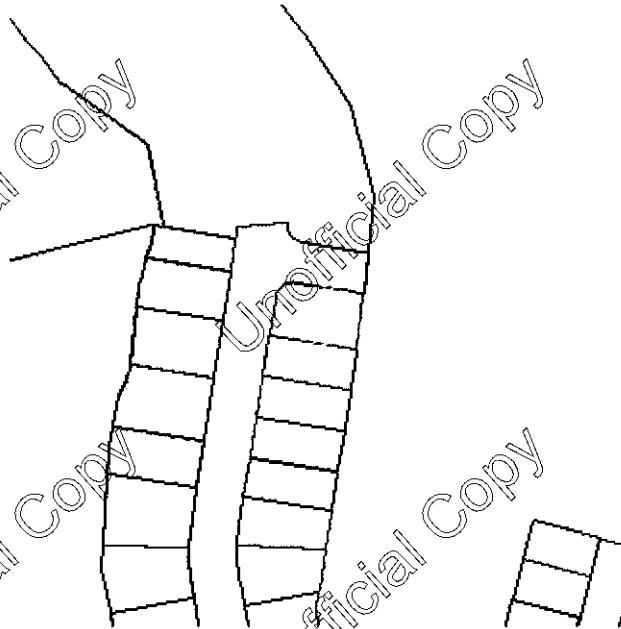

**COLE WEST HOME**

2650 N. Cord Canyon Blvd.  
Suite 200  
Henderson, NV, 89002  
D: 702.575.2001

**Cole West Home**  
Sole #28  
1828 N Highland Drive  
Washington, UT 84789

**SELECTION SHEET 3** as of  
**CHANGE ORDER: 3**

Confirm all selections prior to installation with most current Selection Sheet

PLANS	Revised
ELEVATIONS	Revised
DATE	8/1/2023
SHEET NAME - NUMBER	
Site Plan	
<b>A008</b>	
PROJECT NO.	

SITE INFORMATION	
GENERAL SITE NOTES	
A. ALL NOTES AND DETAILS NOT SHOWN TO BE CONSIDERED PART OF THIS CONTRACT.	
B. ALL WORK SHALL BE DONE IN ACCORDANCE WITH THE SPECIFICATIONS AND DETAILS SHOWN ON THESE PLANS.	
C. ALL MATERIALS AND WORKMANSHIP SHALL BE SUBJECT TO INSPECTION AND APPROVAL BY THE LOCAL AUTHORITY.	
D. ALL WORK SHALL BE DONE IN ACCORDANCE WITH THE LOCAL AUTHORITY'S REQUIREMENTS AND REGULATIONS.	
E. ALL WORK SHALL BE DONE IN ACCORDANCE WITH THE LOCAL AUTHORITY'S REQUIREMENTS AND REGULATIONS.	
F. ALL WORK SHALL BE DONE IN ACCORDANCE WITH THE LOCAL AUTHORITY'S REQUIREMENTS AND REGULATIONS.	
G. ALL WORK SHALL BE DONE IN ACCORDANCE WITH THE LOCAL AUTHORITY'S REQUIREMENTS AND REGULATIONS.	
H. ALL WORK SHALL BE DONE IN ACCORDANCE WITH THE LOCAL AUTHORITY'S REQUIREMENTS AND REGULATIONS.	
I. ALL WORK SHALL BE DONE IN ACCORDANCE WITH THE LOCAL AUTHORITY'S REQUIREMENTS AND REGULATIONS.	
J. ALL WORK SHALL BE DONE IN ACCORDANCE WITH THE LOCAL AUTHORITY'S REQUIREMENTS AND REGULATIONS.	

