

SURVEYOR AFFIDAVIT

This affidavit has been prepared to correct an error in the Boundary Description of a recorded subdivision plat.

Robbin J. Mullen P.L.S., being duly sworn upon oath deposes that he is a citizen of the United States of America, and a Professional Land Surveyor licensed to practice in the State of Utah and holds license No. 368356 and is fully competent to make this Affidavit and he is familiar with the aforesaid plat.

Whereas in reference to the Boundary Description found on the plat of Martha's Vineyard Subdivision, Entry No. 109289:2009 and Map # 13133, as recorded in the official records of the Utah County Recorder's office the tie to the section corner is labeled N.00°19'26"W. 140.02 FEET AND WEST 1676.97 FEET the tie should be changed to read N.00°19'26"W. 141.13 FEET AND WEST 1676.96 FEET.

Dated the 5th day of January 2010

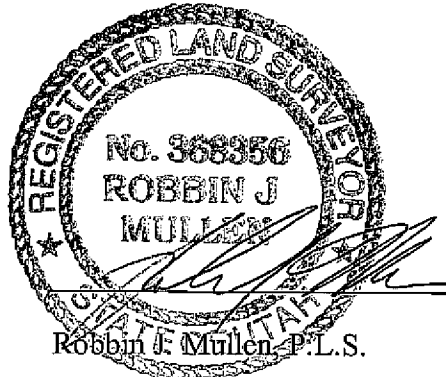
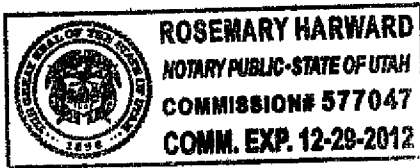

State of Utah)

:ss

County of Utah)

On the 5th day of ~~February~~ ^{January} 2010, personally appeared before me Robbin J Mullen, who being by me duly sworn did say that he is a Professional Land Surveyor licensed to practice in the State of Utah holding License No. 368356.

A handwritten signature in cursive script, which appears to read "Rosemary Harward". The signature is written over a horizontal line.

Notary Public

A PARCEL OF LAND LYING IN THE NE 1/4 OF SECTION 28, TOWNSHIP 5 SOUTH, RANGE 2 EAST, SALT LAKE BASE AND MERIDIAN, UTAH COUNTY, UTAH, MORE PARTICULARLY DESCRIBED AS FOLLOWS.

COMMENCING AT A POINT WHICH IS N00°19'26"W ALONG THE SECTION LINE 141.13 FEET AND WEST 1676.96 FEET FROM THE EAST QUARTER CORNER OF SAID SECTION 28 TO THE POINT OF BEGINNING:

THENCE S.74°32'00" W. 216.71 FEET; THENCE N.35°30'00"W. 25.12 FEET TO THE SOUTHEAST LINE OF LOT 1, ADAM'S COVE SUBDIVISION, PLAT A; THENCE ALONG SAID LOT 1 THE FOLLOWING 3 COURSES: S.48°56'44"W. 182.61 FEET; THENCE N.46°05'51"W. 115.76 FEET; THENCE N.49°07'24"E. 184.10 FEET TO A POINT OF CURVATURE OF A 52.00 FOOT RADIUS NON-TANGENT CURVE TO THE RIGHT; THENCE NORTHWESTERLY ALONG THE ARC OF SAID CURVE 16.94 FEET, SAID CURVE HAVING A CENTRAL ANGLE OF 18°40'00" SUBTENDED BY A CHORD THAT BEARS N.58°50'20"W. 16.87 FEET; THENCE N.31°47'21"W. 95.25 FEET; THENCE N.76°41'55"E. 234.03 FEET; THENCE N.76°08'30"E. 98.30 FEET; THENCE S.12°31'34"E. 215.69 FEET TO THE REAL POINT OF BEGINNING, CONTAINING 1.89 ACRES OF LAND.