

RECORDING INFORMATION ONLY  
  
**3952655**

**RIGHT-OF-WAY EASEMENT**

The Undersigned Grantor (and each and all of them if more than one) for and in consideration of TEN dollars (\$ 10.00 ) and other good and valuable consideration in hand paid by the Grantee, the receipt whereof is hereby acknowledged, hereby grants, bargains and conveys unto The Mountain States Telephone and Telegraph Company, A Colorado corporation, 931 14th Street, Denver, Colorado, 80202, Grantee, its successors, assigns, lessees, licensees and agents a Right-of-Way Easement and the right to construct, operate, maintain and remove such communication and other facilities, from time to time, as said Grantee may require upon, over, under and across the following described land which the Grantor owns or in which the Grantor has any interest, to wit:

A six foot easement being three feet on each side of buried telephone facilities as shown of Exhibit "A" and a description as shown on Exhibit "B" attached hereto and made a part hereof:

*Joe*  
REC OF DEED  
JUN 11 9 17 AM '84  
MOUNTAIN STATES TELEPHONE & TELEGRAPH CO.  
SALT LAKE COUNTY, UTAH  
KATHLEEN G. NIXON  
RECORDER  
SALT LAKE COUNTY, UTAH

situate in County of SALT LAKE, State of Utah, TOGETHER with the right of ingress and egress over and across the lands of the Grantor to and from the above-described property, the right to clear and keep cleared all trees and other obstructions as may be necessary.

The Grantor reserves the right to occupy, use, and cultivate said property for all purposes not inconsistent with the rights herein granted.

Signed and delivered this 9th day of May, A.D., 19 84

At Salt Lake City, Utah Grantor Stangl Construction  
By: *[Signature]*

STATE OF UTAH )  
COUNTY OF SALT LAKE ) ss.

On the 9th day of May, 19 84, personally appeared before me, F. C. Stangl, the signer of the above instrument, who duly acknowledged to me that (he) or (she) executed the same.

WITNESS my hand and official seal this 9th day of May, 19 84

1/8/87  
My commission expires  
Salt Lake City, Utah *[Signature]*  
Notary Public Residing in \_\_\_\_\_ Notary Public

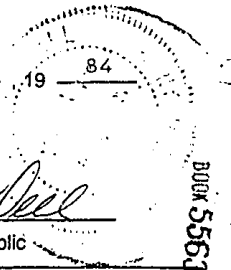

|                                |                                      |          |           |  |  |  |  |  |  |  |
|--------------------------------|--------------------------------------|----------|-----------|--|--|--|--|--|--|--|
| R/W NUMBER<br><b>RW070418</b>  | QUARTER SECTION<br><b>NE</b>         |          |           |  |  |  |  |  |  | REMARKS  |
| EXCHANGE CODE                  | AGENT                                | SECTION  |           |  |  |  |  |  |  |  |
| JOB NO.                        | MGJ                                  | TOWNSHIP | <b>22</b> |  |  |  |  |  |  |  |
| <b>U-4-6748</b>                | <b>45CR</b>                          | RANGE    | <b>1S</b> |  |  |  |  |  |  |  |
| RR NAME, GOV. AGENCY           |                                      |          | <b>1W</b> |  |  |  |  |  |  |  |
| GEO. LOCATION<br><b>674000</b> | PRINCIPAL MERIDIAN<br><b>S&amp;M</b> |          |           |  |  |  |  |  |  | MAIL TO: THE MOUNTAIN STATES TELEPHONE & TELEGRAPH CO.<br>250 BELL PLAZA ROOM 510A<br>P.O. BOX 30960<br>SALT LAKE CITY, UTAH 84125 |

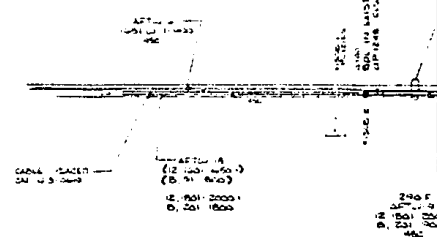
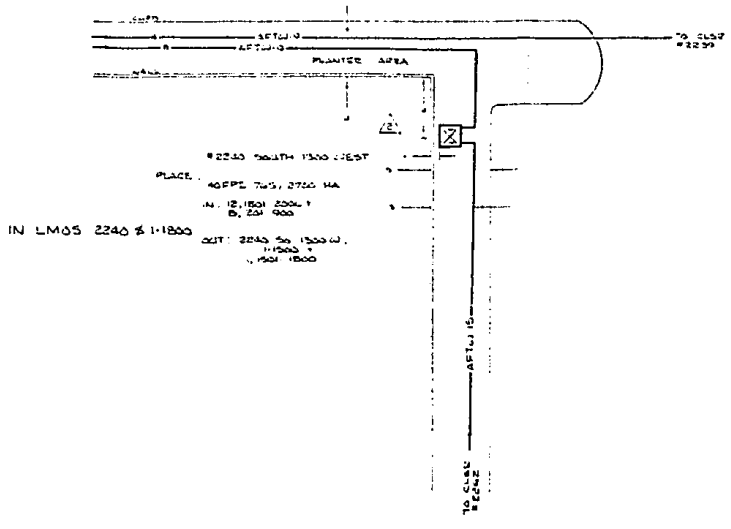

GENERAL NOTES

- 1. CABLE TO BE BURIED 24" DEEP.
- 2. BEFORE DIGGING CONTACT BLUE STAKES AT 552 5000 FOR LOCATION OF OTHER UTILITIES.
- 3. ALL CABLE 46C ACCOUNT CODE UNLESS NOTED

BOOK 5563 PAGE 1153

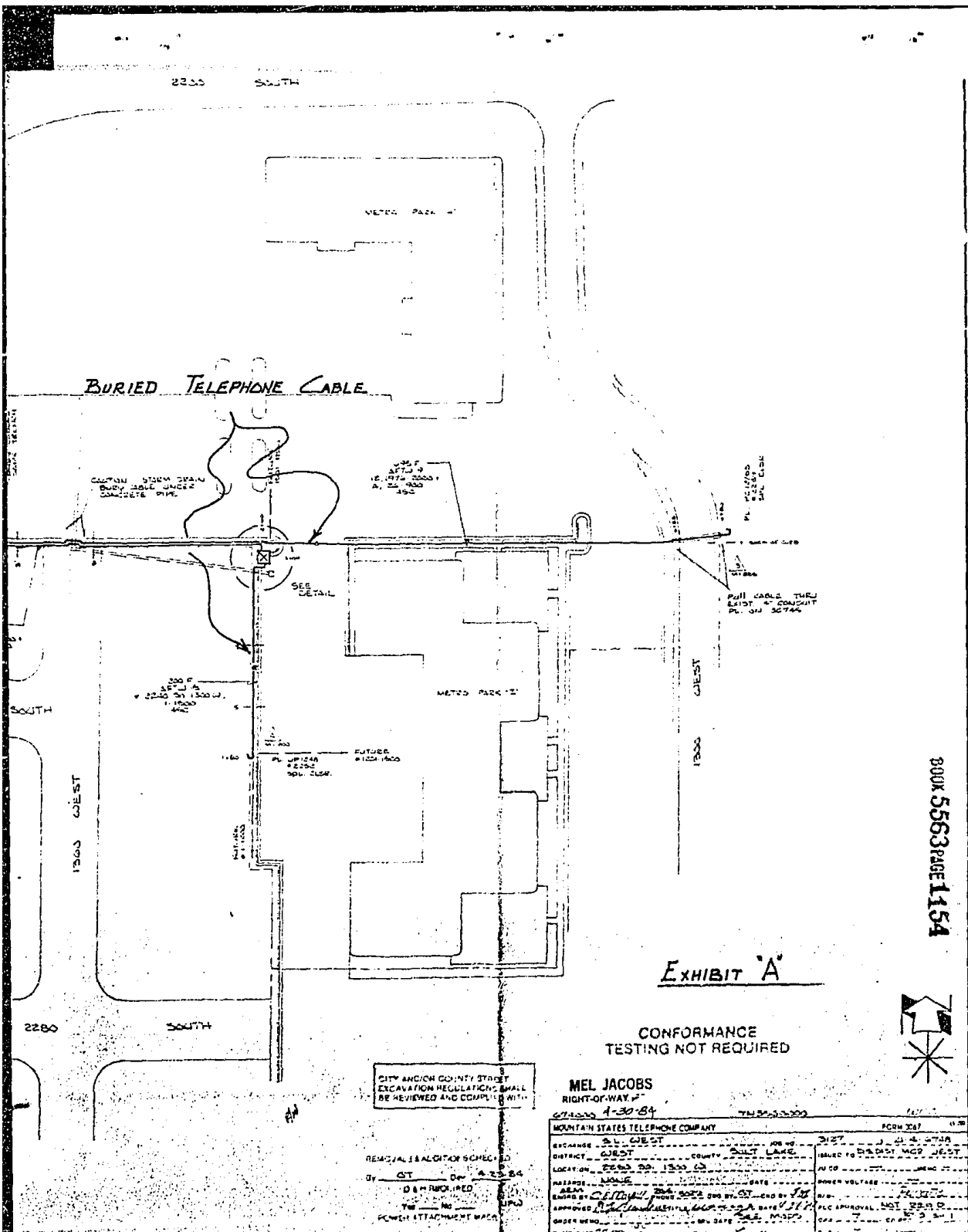

BOOK 5563 PAGE 1154

**EXHIBIT 'A'**

CONFORMANCE TESTING NOT REQUIRED



CITY AND/OR COUNTY STREET EXCAVATION REGULATIONS SHALL BE REVIEWED AND COMPLIED WITH.

MEL JACOBS  
RIGHT-OF-WAY

REMOVAL IS ALCOR OF SCHEDULED BY  
 BY CT ON A 23 84  
 IS NOT REQUIRED  
 POWER ATTACHMENT WASH

|                                   |                |                             |
|-----------------------------------|----------------|-----------------------------|
| MOUNTAIN STATES TELEPHONE COMPANY |                | FORM 247                    |
| EXCHANGE                          | 2335 WEST      | 2335                        |
| DISTRICT                          | WEST           | ISSUED TO DISTRICT MGR WEST |
| LOCATION                          | 2280 TO 1500 W | IN TO                       |
| RELEASE                           | NONE           | POWER VOLTAGE               |
| AREA                              |                | APPROVED                    |
| APPROVED BY                       | MEL JACOBS     | PLC APPROVAL NSI 2335       |
| ORDER NO.                         |                | DATE                        |

EXHIBIT "B"

Commencing at a point which is North 89°55' East 3.00 feet from the Northwest corner of Lot 1-A, Redwood Gardens, Plat "A", a subdivision in the Northeast Quarter of Section 22, Township 1 South, Range 1 West, Salt Lake Base & Meridian; said point being South 0°02'35" West 1157.74 feet along the Quarter section line and North 89°55' East 56.34 feet from the North Quarter corner of said Section 22, and running thence North 0°04'26" East 159.20 feet; thence North 17°19'09" East 52.11 feet, more or less, to the Southerly highway right of way line and non-access line for the 21st South Freeway (Project No. F-018-1); thence North 88°31'22" East along said right of way line 351.15 feet; thence along a 2914.79 foot radius curve to the left 229.25 feet (chord = North 86°38'46" East 229.19 feet); thence continuing along said curve 392.56 feet (chord = 89°32'04" East 392.26 feet); thence North 76°40'34" East 407.08 feet; thence along a 1095.92 foot radius curve to the right 202.11 feet (chord = North 82°02'35" East 201.83 feet); thence North 87°51'52" East 1408.58 feet; thence North 89°11'55" East 790.30 feet; thence North 79°07'15" East 130.68 feet to the west right of way line of the Jordan River; thence South 41°54'55" East along said right of way line 1557.10 feet to the North line of 2320 South Street; thence South 89°55' West along said line 2428.79 feet to a point North 89°55' East 153.00 feet from the Southeast corner of Lot 117 of said Redwood Gardens Plat "A", thence North 0°05' West 112.00 feet; thence South 89°55' West 143.00 feet; thence North 0°05' West 274.00 feet; thence South 89°55' West 22.00 feet to the Southeast corner of Lot 111 of said subdivision; thence along said subdivision boundry North 0°05' West 240.80 feet; thence South 89°55' West 133.00 feet; thence North 0°05' West 33.20 feet; thence South 89°55' West 1124.00 feet; thence North 75°00' West 121.29 feet; thence North 60°05' West 68.51 feet; thence South 29°55' West 75.99 feet; thence South 89°55' West 156.60 feet to the westerly line of 1580 West Street; thence Northwesterly along a 90 foot radius curve to the right 24.72 feet (chord = North 19°17'10" West 24.64 feet); thence South 80°30' West 142.32 feet to the Northeast corner of said Lot 1-A; thence South 89°55' West 575.54 feet to the point of beginning,

Also, commencing at the Northeast corner of Lot 1-A Redwood Gardens Plat "A", located in part of the Northwest Quarter of the Northeast Quarter of Section 22, Township 1 South, Range 1 West, Salt Lake Base & Meridian; thence running South 0°05' West 225 feet; thence West 278.84 feet; thence North 225 feet; thence East 278.84 feet to the point of beginning.

BOOK 5563 PAGE 1155