



WHEN RECORDED, PLEASE RETURN TO:

Brian Knowlton
LANDROCK LC
70 North Main #106
Bountiful, UT 84010

ENT 47512:2011 PG 1 of 3
JEFFERY SMITH
UTAH COUNTY RECORDER
2011 Jun 30 12:15 PM FEE 53.00 BY SW
RECORDED FOR LANDROCK LC

FOURTH AMENDMENT TO THE CONDOMINIUM DECLARATION

FOR

RIVERBEND Phase 1

On July 2, 2007 the Condominium Declaration for Riverbend Phase 1 (the "Declaration") was recorded with the Utah County Recorder as Entry No. 95901 in Book No. 2007 at Pages 1 through 43.

Pursuant to Section 19 of the Declaration and in accordance with Section 57-8 of the Utah Code Annotated, Declarant (Landrock L.C.) hereby amends the Declaration.

Declarant hereby elects to convert Unit 37 into Common space as shown on attachment A

Exhibit B to the First Amendment to the Condominium declaration for Riverbend Phase 1 and 2 is amended as attached:

IN WITNESS WHEREOF, the Declarant has hereunto caused its name to be signed by the signature of its duly authorized agent this 20 day of June, 2011.

LANDROCK L.C.

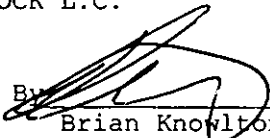
By 
Brian Knowlton, Member

STATE OF UTAH)
) ss.
COUNTY OF Davis)

The foregoing instrument was acknowledged before me this 20 day of June 2011, by Brian Knowlton, Managing Member Landrock L.C.

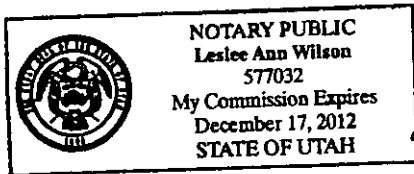

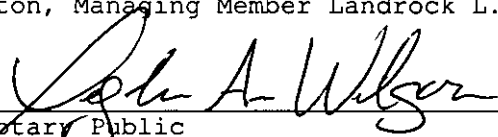
Notary Public
Residing at: S.N. Main Bountiful
My Commission Expires: 12/17/12

Attachment A
To Fourth Amendment
Condominium Declaration for Riverbend Phase 1 and 2

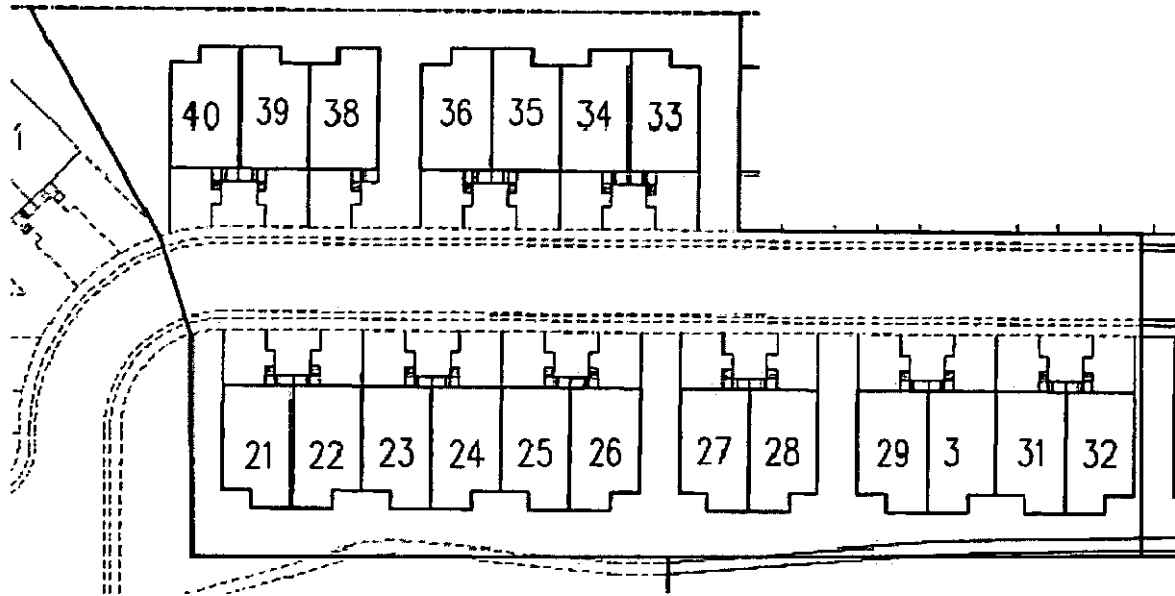

EXHIBIT B
TO
FOURTH AMENDMENT
CONDOMINIUM DECLARATION FOR RIVERBEND PHASE 1 AND 2

SHARES OF COMMON EXPENSES

<u>Unit</u>	<u>Address</u>	<u>Share of common expenses</u>
1	78 East River Bend Road (1155 N.)	2.5640%
2	76 East River Bend Road (1155 N.)	2.5640%
3	1151 North 80 East	2.5640%
4	1147 North 80 East	2.5640%
5	1133 North 80 East	2.5640%
6	1129 North 80 East	2.5640%
7	77 East River Veiw Drive (1125 N.)	2.5640%
8	79 East River Veiw Drive (1125 N.)	2.5640%
9	87 East River Veiw Drive (1125 N.)	2.5640%
10	91 East River Veiw Drive (1125 N.)	2.5640%
11	93 East River Veiw Drive (1125 N.)	2.5640%
12	99 East River Veiw Drive (1125 N.)	2.5640%
13	103 East River Veiw Drive (1125 N.)	2.5640%
14	107 East River Veiw Drive (1125 N.)	2.5640%
15	108 East River Veiw Drive (1125 N.)	2.5640%
16	106 East River Veiw Drive (1125 N.)	2.5640%
17	102 East River Veiw Drive (1125 N.)	2.5640%
18	98 East River Veiw Drive (1125 N.)	2.5640%
19	94 East River Veiw Drive (1125 N.)	2.5640%
20	88 East River Veiw Drive (1125 N.)	2.5640%
21	89 East River Bend Road (1155 N.)	2.5640%
22	97 East River Bend Road (1155 N.)	2.5640%
23	101 East River Bend Road (1155 N.)	2.5640%
24	109 East River Bend Road (1155 N.)	2.5640%
25	111 East River Bend Road (1155 N.)	2.5640%
26	113 East River Bend Road (1155 N.)	2.5640%
27	117 East River Bend Road (1155 N.)	2.5640%
28	121 East River Bend Road (1155 N.)	2.5640%
29	127 East River Bend Road (1155 N.)	2.5640%
30	129 East River Bend Road (1155 N.)	2.5640%
31	133 East River Bend Road (1155 N.)	2.5640%
32	137 East River Bend Road (1155 N.)	2.5640%
33	118 East River Bend Road (1155 N.)	2.5640%
34	114 East River Bend Road (1155 N.)	2.5640%
35	112 East River Bend Road (1155 N.)	2.5640%
36	104 East River Bend Road (1155 N.)	2.5640%
38	96 East River Bend Road (1155 N.)	2.5640%
39	92 East River Bend Road (1155 N.)	2.5640%
40	86 East River Bend Road (1155 N.)	2.5640%