

**Acknowledgment and
Notice of Acknowledgment
of Acceptance of R.S. 2477
Right-of-Way Grant**

00555388

Notice B: 1094 P: 245 Fee \$0.00
Patsy Cutler, Iron County Recorder Page 1 of 7
06/28/2007 08:59:51 AM By GOVERNOR OF THE STATE OF UTAH

THE STATE OF UTAH

TO ALL WHOM THESE PRESENTS SHALL COME, Greeting:

Know ye, This is an Acknowledgment and Notice of Acknowledgment made under Utah Code § 72-5-309 through 310 inclusive that the grant of the United States of America of “the right of way for the construction of highways over public lands, not reserved for public uses” under United States Revised Statutes 2477 (43 U.S.C. § 932 (repealed October 21, 1976, with proviso recognizing the validity of rights-of-way already established)) was accepted for and on behalf of the State of Utah and its political subdivision Iron County as it pertains to the highway located in Iron County known as NADA (RR)/LUND ROAD; County Road Number: 39; State Geographic Information Database (SGID) Road Identification Number: RD110039. Total road length is 13.87 miles more or less.

The reasons for this acknowledgment are as follows (indicated by an “X” in one or more blocks and any supplemental comment):

- The road was laid out or erected for public use over public lands not reserved for public uses prior to the earlier of (a) the October 21, 1976 repeal of R.S. 2477 or (b) the date the servient estate was reserved for public uses;
- By reason of its continuous use as a public highway over public lands not reserved for public uses for a period of at least ten years prior to the earlier of (a) the October 21, 1976 repeal of R.S. 2477 or (b) the date the servient estate was reserved for public uses;
- Other (explain).

A printed copy of a map showing the location of the road in said county is appended hereto as “Attachment 1.” A printed copy of photos of the road is appended hereto as “Attachment 2.” A printed copy of a description of the beginning and ending points of the entire road together with a list of Townships, Ranges and Sections that may be traversed by the road in said county is appended hereto as “Attachment 3.” A printed copy of the Road Centerline Description Cover Page(s) is appended hereto as “Attachment 4.” The Appendices referenced in “Attachment 4” that contain the actual road centerline descriptions are incorporated herein by reference.

A printed copy of this Acknowledgment and Notice of Acknowledgment, together with its Attachments and Appendices, may be viewed and/or obtained at the office of the Utah State Archives.

An electronic copy of this Acknowledgment and Notice of Acknowledgment, together with its Attachments and Appendices referenced in the Attachments, may be viewed and/or downloaded as read-only PDF (Portable

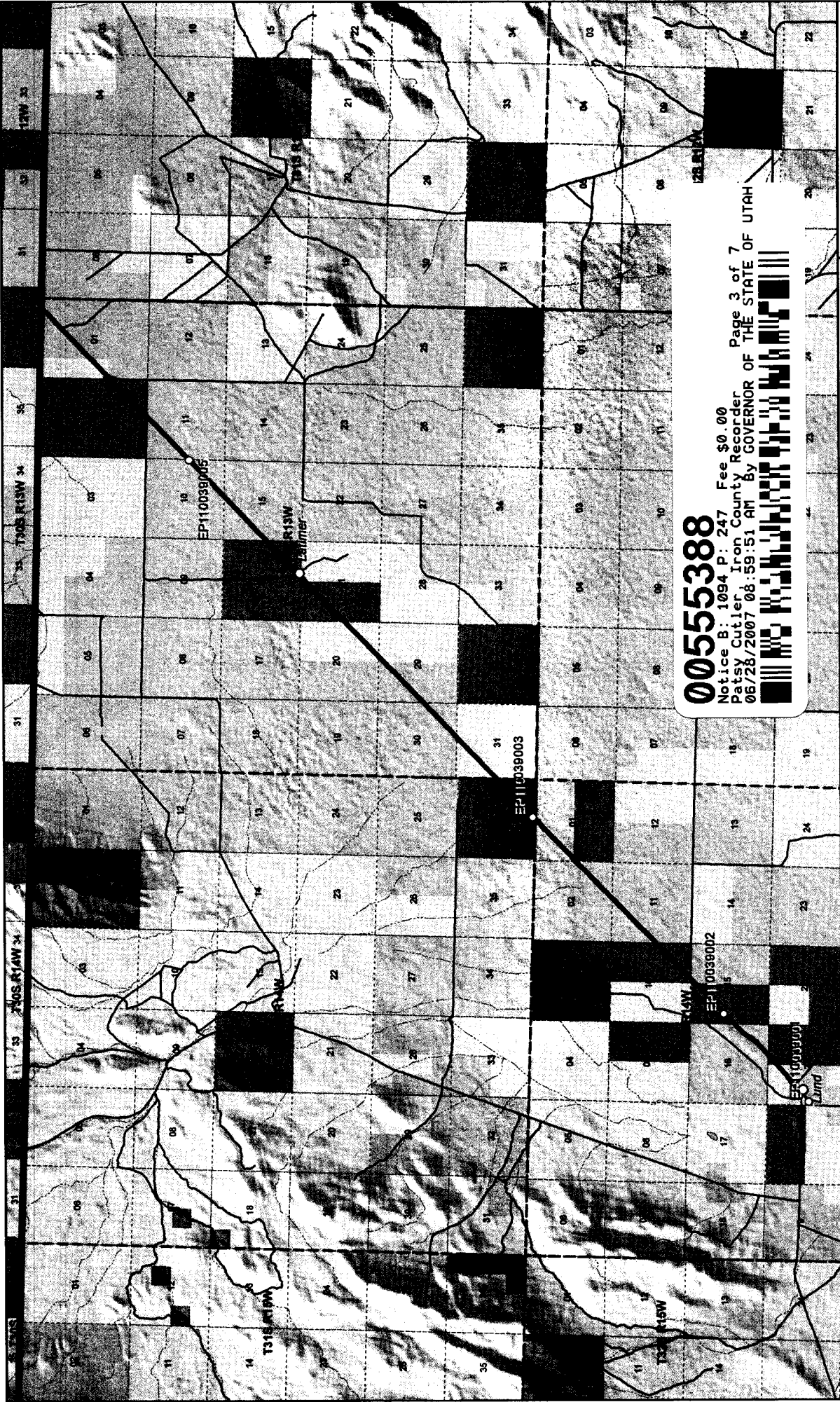

00555388
 Notice B: 1094 P: 247 Fee \$0.00
 Patsy Cutler Iron County Recorder
 06/28/2007 08:59:51 AM By GOVERNOR OF THE STATE OF UTAH



1:106,570
1 inch equals 1.7 miles

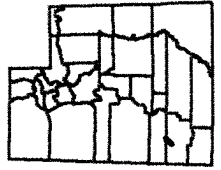

NADA (RR)/LUND ROAD - Iron County
SGID RD_ID RD110039

Land Ownership Categories

- BLM
- Private
- SITLA, State Trust Land
- USFS, National Forest
- State Parks and Recreation
- Tribal, Indian Reservation
- NPS, National Park

Transportation Network

- NADA (RR)/LUND ROAD
- Other Roads
- Title V, Issued Or Under Consideration By BLM Of County
- Photo Event Point

Section = 1 Mile



Map prepared by the State of Utah
 Automated Geographic Reference Center
 Room 5130 State Office Building
 Salt Lake City, Utah 84114
 Apr 17, 2007

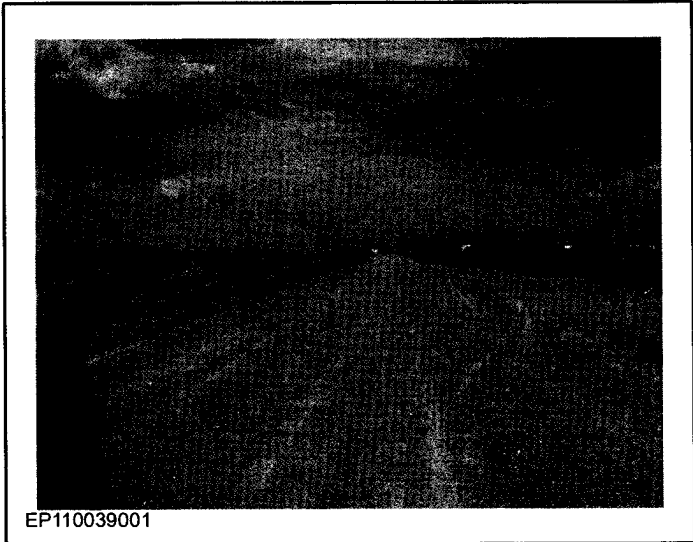

EP110039001

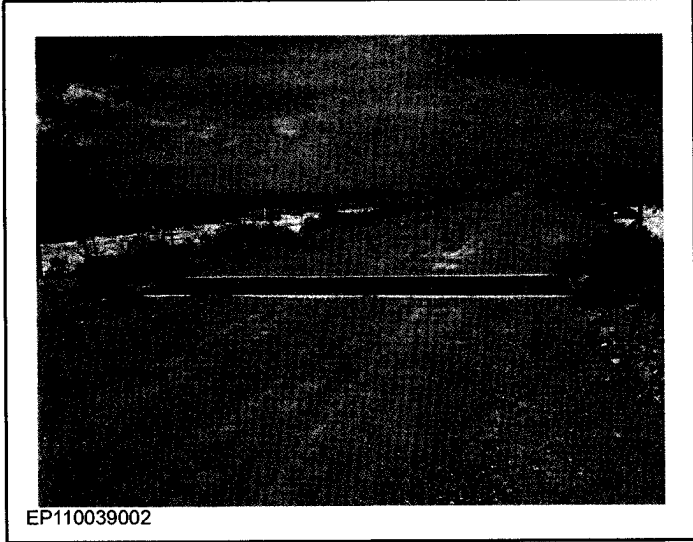

EP110039002

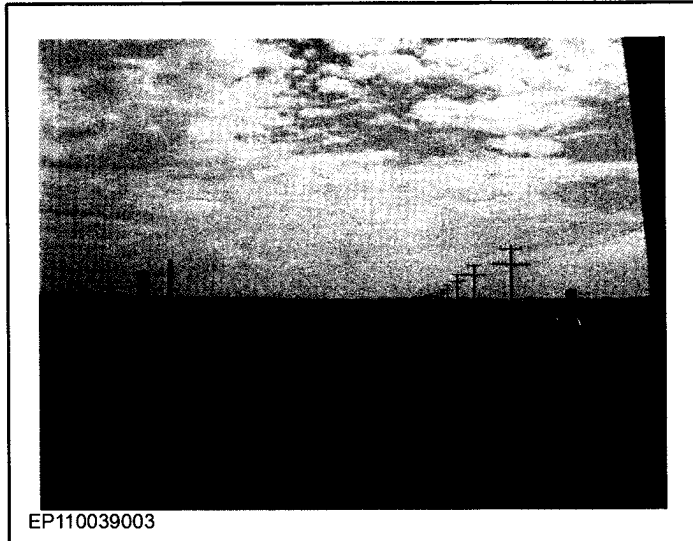

EP110039003



EP110039005

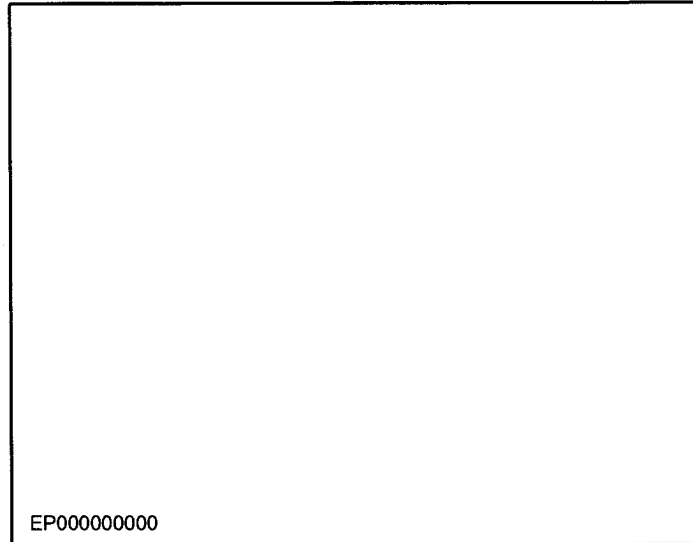

EP000000000

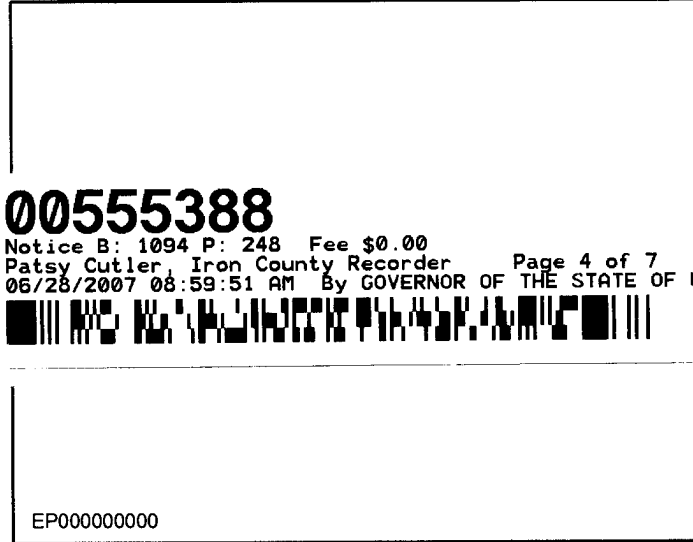

EP000000000

00555388

Notice B: 1094 P: 248 Fee \$0.00 Page 4 of 7
Patsy Cutler, Iron County Recorder
06/28/2007 08:59:51 AM By GOVERNOR OF THE STATE OF UTAH



**NADA (RR)/LUND ROAD - Iron County
SGID RD_ID RD110039**

Map prepared by the State of Utah
Automated Geographic Reference Center
Room 5130 State Office Building
Salt Lake City, Utah 84114
April 17, 2007



Attachment 3

Beginning & Ending Points and Township, Range, and Section References For:

Popular Name: NADA (RR)/LUND ROAD

County: Iron

County Road Number: 39

State Geographic Information Database (SGID) Road Identification Number: RD110039.

Total Road Length: 13.87 miles more or less.

Beginning at a point on the road centerline located at 38 degrees 00 minutes 20.91 seconds North Latitude and -113 degrees 26 minutes 02.58 seconds West Longitude, which can be converted to mapping accuracy State Plane Utah South Zone NAD 83 feet coordinates of X = 1,083,200.5 feet and Y = 10,335,872.7 feet based on the US Survey Foot conversion.

Ending at a point on the road centerline located at 38 degrees 08 minutes 55.65 seconds North Latitude and -113 degrees 15 minutes 19.68 seconds West Longitude, which can be converted to mapping accuracy State Plane Utah South Zone NAD 83 feet coordinates of X = 1,135,622.7 feet and Y = 10,386,916.3 feet based on the US Survey Foot conversion.

This road may traverse:

Township 30 South Range 13 West, Section(s) 36, Salt Lake Base & Meridian

Township 31 South Range 13 West, Section(s) 1,2,10,11,15,16,20,21,29,30,31, Salt Lake Base & Meridian

Township 31 South Range 14 West, Section(s) 36, Salt Lake Base & Meridian

Township 32 South Range 14 West, Section(s) 1,2,10,11,15,16,21, Salt Lake Base & Meridian

See Attachment 1 above for a cartographic depiction of the course of this road.

00555388

Notice B: 1094 P: 249 Fee \$0.00
Patsy Cutler, Iron County Recorder Page 5 of 7
06/28/2007 08:59:51 AM By GOVERNOR OF THE STATE OF UTAH



00555388

Notice B: 1094 P: 250 Fee \$0.00
Patsy Cutler, Iron County Recorder Page 6 of 7
06/28/2007 08:59:51 AM By GOVERNOR OF THE STATE OF UTAH



Attachment 4

Road Centerline Description Cover Page(s)

Popular Name: NADA (RR)/LUND ROAD

County: Iron

County Road Number: 39

State Geographic Information Database (SGID) Road Identification Number: RD110039.

Total Road Length: 13.87 miles more or less.

Centerline Descriptions Of Road-Segments That Cross Over Federally Owned Land, Derived From Global Positioning System Data And Cross-checked against USGS Digital Orthophoto Quadrangles Compiled By The Utah Automated Geographic Reference Center And Entered Into The State Geographic Information Database (SGID).

Road-Segments Listed by SGID Road Identification Number (RD ID)	Road-Segment Numbers	Believed Ownership Of Servient Estate	Approximate Segment Length	See Attached Appendix
RD110039	001	PVT	0.33 Miles	(not shown)
RD110039	002	BLM	0.19 Miles	A
RD110039	003	ST	0.18 Miles	(not shown)
RD110039	004	PVT	0.58 Miles	(not shown)
RD110039	005	ST	0.71 Miles	(not shown)
RD110039	006	PVT	0.09 Miles	(not shown)
RD110039	007	ST	0.63 Miles	(not shown)
RD110039	008	PVT	1.43 Miles	(not shown)
RD110039	009	ST	0.05 Miles	(not shown)
RD110039	010	PVT	0.69 Miles	(not shown)
RD110039	011	ST	0.71 Miles	(not shown)
RD110039	012	BLM	0.74 Miles	B
RD110039	013	PVT	1.31 Miles	(not shown)
RD110039	014	BLM	0.71 Miles	C
RD110039	015	ST	0.71 Miles	(not shown)
RD110039	016	BLM	0.08 Miles	D
RD110039	017	ST	0.63 Miles	(not shown)
RD110039	018	PVT	2.19 Miles	(not shown)
RD110039	019	ST	0.66 Miles	(not shown)
RD110039	020	PVT	0.05 Miles	(not shown)
RD110039	021	BLM	0.31 Miles	E
RD110039	022	PVT	0.89 Miles	(not shown)
		Total Road Length	13.87	

* Indicates that a Title V permit will be requested, is in process, or has been issued.

† Indicates that road-segments crossing Forest Service land are under consideration by the state and county as of the date of this Acknowledgment and Notice of Acknowledgment.

00555388

Notice B: 1094 P: 251 Fee \$0.00
Patsy Cutler, Iron County Recorder Page 7 of 7
06/28/2007 08:59:51 AM By GOVERNOR OF THE STATE OF UTAH

