

When Recorded Return To:
Focus Engineering and Surveying, LLC
ATTN: Justin D. Lundberg
6949 South High Tech Drive, Suite 200
Midvale, UT 84047

Entry #: 557935

10/21/2021 11:16 AM AFFIDAVIT

Page: 1 of 2

FEE: \$80.00 BY: COTTONWOOD TITLE INSURANCE AGENCY
Jerry Houghton, Tooele County, Recorder

149022 · DMP

SURVEYOR'S AFFIDAVIT

I, Evan J. Wood, being a duly licensed Professional Land Surveyor in the State of Utah, holding Certificate No. 183395, do hereby swear:

That Subdivision Plat's were prepared by Focus Engineering and Surveying, and certified by Spencer W. Llewelyn, Dennis P. Carlisle, & Evan J. Wood said Subdivision being, **WILD HORSE RANCH SUBDIVISION PHASES 1-7 & CASTLE ROCK DRIVE DEDICATION PLAT** recorded in the Office of the Tooele County Recorder's Office.

- WILD HORSE RANCH SUBDIVISION 1 ENTRY NO. 427785 4/22/2016
- WILD HORSE RANCH SUBDIVISION 2 ENTRY NO. 427786 4/22/2016
- WILD HORSE RANCH SUBDIVISION 3 ENTRY NO. 470064 6/28/2018
- WILD HORSE RANCH SUBDIVISION 4 ENTRY NO. 474287 9/18/2018
- WILD HORSE RANCH SUBDIVISION 5 ENTRY NO. 474288 9/18/2018
- WILD HORSE RANCH SUBDIVISION 6 ENTRY NO. 539141 3/24/2021
- WILD HORSE RANCH SUBDIVISION 7 ENTRY NO. 541303 4/14/2021
- CASTLE ROCK DRIVE DEDICATION PLAT ENTRY NO. _____
DATE: _____

Said Plat contains the following errors and omissions:

- The Measured distance on the Basis of Bearing shows as 2,633.71 Feet.
- The Corrected Measured distance is 2,634.24 Feet.

The North 1/4 Corner of Section 16, T2S, R4W Salt Lake Base & Meridian was found to be located in the correct position according to the Recorded Plat. All centerline monuments and boundary corners were set according to the measurements from the North 1/4 Corner of said Section 16. The Northwest Corner of Section 16 was found to be located S89°42'06"W 0.53 feet from the Measured distance shown on said plat.

When Recorded Return To:
Focus Engineering and Surveying, LLC
ATTN: Justin D. Lundberg
6949 South High Tech Drive, Suite 200
Midvale, UT 84047

To re-establish and perpetuate the relationship of the section monuments and the Subdivision as platted, and located on the ground; hold the North 1/4 corner of said Section 16 and use the distance on the plat of 2633.71 feet along the Section line to establish the position of the Northwest corner of said Section 16 used to establish the location of said WILD HORSE RANCH SUBDIVISION PHASE 7.

Further sayeth Affiant naught.

Evan J. Wood
Evan J. Wood PLLC
Focus Engineering & Surveying, LLC
6949 South High Tech Drive, Suit 200
Midvale, Utah 84047

OCT. 19, 2021
Date

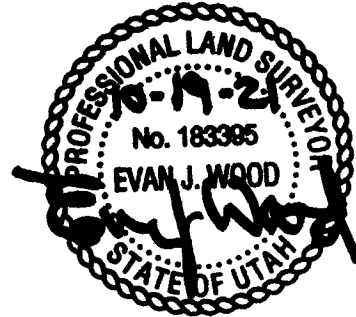

STATE OF UTAH

} S.S.

COUNTY OF SALT LAKE

On the *19* day of *October* A.D., 20*21*, personally appeared before me, the undersigned Notary Public, in and for the County of Salt Lake in said State of Utah, Evan J. Wood who duly acknowledged to me that he is a Professional Land Surveyor in the State of Utah and that he did sign the forgoing instrument.

Dovetta Flowers
A Notary Public Commissioned in Utah
Residing in Salt Lake County

