



# NOTICE OF LOCATION

## Placer Mining Claim

ENT 60567:2022 PG 1 of 1  
ANDREA ALLEN  
UTAH COUNTY RECORDER  
2022 May 17 3:30 pm FEE 40.00 BY TH  
RECORDED FOR HINKINS, BRYSON

NOTICE IS HEREBY GIVEN: The undersigned located the Toga 9 Placer Mining Claim in accordance with laws and regulations of the United States and the State of Utah.

DATE OF LOCATION: May 15, 2022

1/4	Section	Township	Range	Meridian	County	Mining District
NE	10	6S	1W	SLB&M	Utah	Lake Mountains

Placer Claim is approximately 1320 feet in the E to W and 660 feet in the N to S direction and contains 20 acres, more or less.

Discovery monument is located approximately 1450 feet North South and 1400 feet East West from the NE corner of Section 10 Township 6S Range 1W SLB&M, at which point Notice of Location was duly posted.

Aliquot part description and sketch:

N1/2 SW1/4 NE1/4

CLAIMANT NAME AND MAILING ADDRESS:

Petram LLC  
1830 West Highway 112  
Tooele, UT 84074

NOTARY:

State of Utah, County of Utah  
Subscribed and sworn before me on the 17 day of May, 2022, by Bryson Hinkins.

*Jeanne Bowen*  
Notary Signature

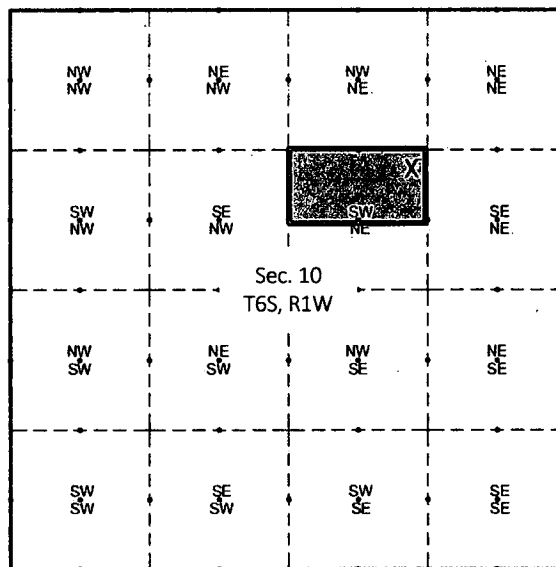
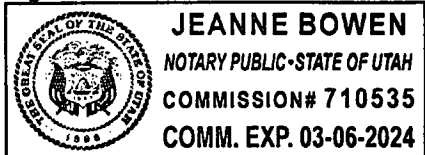

X Monument Location  
Claim Boundary Area

0' 660' 1320'

SIGNATURE: Bryson Hinkins  
Bryson Hinkins  
Authorized Agent for Petram LLC

DATE: 5/17/2022