



ENT 68288:2022 PG 1 of 2
ANDREA ALLEN
UTAH COUNTY RECORDER
2022 Jun 07 4:12 pm FEE 0.00 BY CS
RECORDED FOR PAYSON CITY CORPORATION

NOTICE OF ADDRESS CHANGES

PAYSON CITY, UTAH

Notice is hereby given and all are advised that through this recorded document the following addresses have been changed as indicated in this notice. These changes are effective immediately.

Parcel #

30:029:0044

Legal Description

COM N 1564.23 FT & W 1545.09 FT FR SE COR. SEC. 9, T9S, R2E, SLB&M.; N 0 DEG 24' 46" E 295 FT; N 89 DEG 38' 10" W 217.8 FT; N 0 DEG 24' 46" E 83.54 FT; ALONG A CURVE TO R (CHORD BEARS: N 45 DEG 19' 49" E 22.6 FT, RADIUS = 16 FT); S 89 DEG 45' 9" E 337.86 FT; ALONG A CURVE TO R (CHORD BEARS: S 44 DEG 46' 4" E 22.62 FT, RADIUS = 16 FT); S 0 DEG 13' 0" W 363.22 FT; ALONG A CURVE TO R (CHORD BEARS: S 45 DEG 17' 25" W 22.66 FT, RADIUS = 16 FT); N 89 DEG 38' 10" W 137.31 FT TO BEG. AREA 1.870 AC.

Old Address

987 EAST 200 NORTH UNIT #101-108
273 NORTH 1000 EAST UNIT #201-208
980 EAST 300 NORTH UNIT #301-308
940 EAST 300 NORTH UNIT #401-408

New Address

252 NORTH 900 EAST BLDG 4 UNIT # 401-408
252 NORTH 900 EAST BLDG 5 UNIT # 501-506
252 NORTH 900 EAST BLDG 6 UNIT # 601-608
252 NORTH 900 EAST BLDG 7 UNIT # 701-708

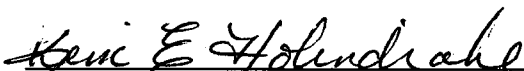

Kim E. Holindrake, MMC
City Recorder
Payson City



300 N

W 1000 E

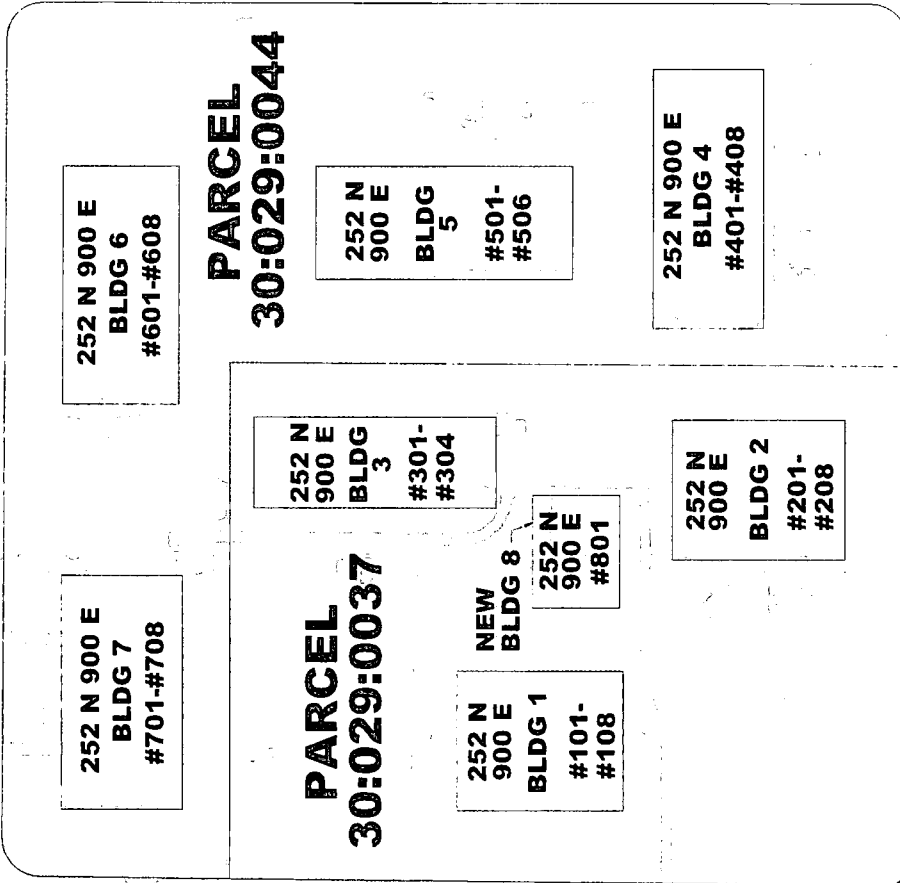

200 N

W 900 E

252 N 900 E
BLDG 6
#601-#608

**PARCEL
30:029:0044**

252 N
900 E
BLDG
5
#501-
#506

252 N 900 E
BLDG 4
#401-#408

252 N 900 E
BLDG 7
#701-#708

252 N
900 E
BLDG
3
#301-
#304

**PARCEL
30:029:0037**

252 N
900 E
BLDG 1
#101-
#108

NEW
BLDG 8
252 N
900 E
#801

252 N
900 E
BLDG 2
#201-
#208